

## ADAPTABLE LABORATORY FURNITURE SOLUTIONS

### Sigma Fusion™

The Solution to Change...

The objective to a winning laboratory design is to create the ideal workplace for today, while incorporating adaptability to respond to the changes of the future. Sigma Fusion™ system represents a new balance of adaptability and design.

Sigma Fusion™ incorporates a slim line core assembly with cantilevered work surfaces that allows height adjustment for individual workstations to meet the requirements of a large variety of users, equipment, and processes.

An integrated raised distribution system provides quick and easy access to services while providing superior flexibility by keeping the work surface open to accommodate equipment and procedures.

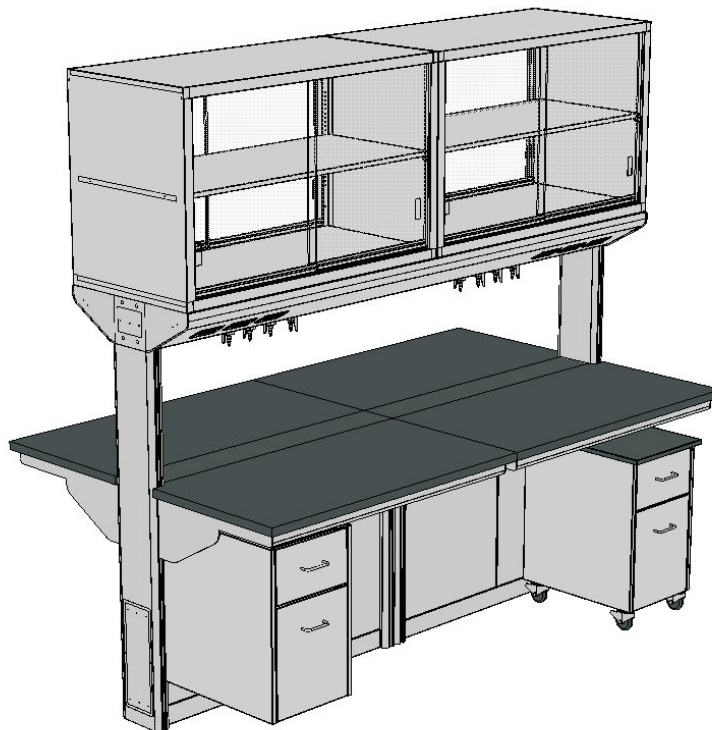

**For additional information and help in planning to meet your requirements contact  
Mott Manufacturing.**

452 Hardy Road, Brantford, Ontario, Canada N3T 5L8  
Tel: (519) 752-7825 Fax: (519) 752-2895  
[www.mott.ca](http://www.mott.ca)

## FLEXIBLE LABORATORY SIGMA FUSION™ SYSTEMS

### Modular Support Structure Design

Each core system is fabricated from prime quality furniture grade cold rolled steel.

Support systems are a core and panel style support structure.

Core structures must be anchored to suitable floors.

Modular components are suitable for island configurations.

Core assemblies have removable panels on front and back sides with access panels on both ends.

### Modular Support Structure Features

Core systems support work surfaces, under counter suspended cabinets and overhead storage components.

The core system allows plumbing, electrical and other services to be installed using commonly available mounting systems.

Suspended cabinets can be supported using hook shaped rails attached near the front and rear of the cantilevered work surface. Cabinets can be added at any time and it is possible to remove and relocate a fully loaded cabinet to any position between legs without disturbing the counter top.

Cover panels can be fastened with a positive friction catch which snaps into place. The panel does not require adhesives to be attached. Panels are half width and it is possible to remove panels without removing suspended cabinets.

Overhead storage cabinets are mounted above the raised distribution system.

The vertical height of table work surfaces can be adjusted in 1" increments without the use of special tools.

### Materials

Fusion™ Post.....	16 gauge with Sigma Barrier™ coating
Fusion™ Post Panel.....	20 gauge
Fusion™ Core Base.....	18 gauge
Fusion™ Interior Core.....	16 gauge
Fusion™ Cover Panel.....	18 gauge
Fusion™ Carrier End Cap.....	11 gauge

**SIGMA FUSION™**

**Parts List**

- 1) Fusion Post (Sigma Barrier™ coating and powder coated), complete with levelers
  - 2) Fusion Counter Support
  - 3) Fusion Core Base
  - 4) Fusion Post (Sigma Barrier™ coating and Powder coated), complete with levelers
  - 5) Fusion Overhead Service Carrier Assembly
  - 6) Fusion Cover Panel
  - 7) Fusion Interior Core (Sigma Barrier™ coating and Powder coated)
  - 8) Fusion Post Panel
  - 9) Fusion Carrier End Cap
- Note: Drawing of Island Single Core Assembly

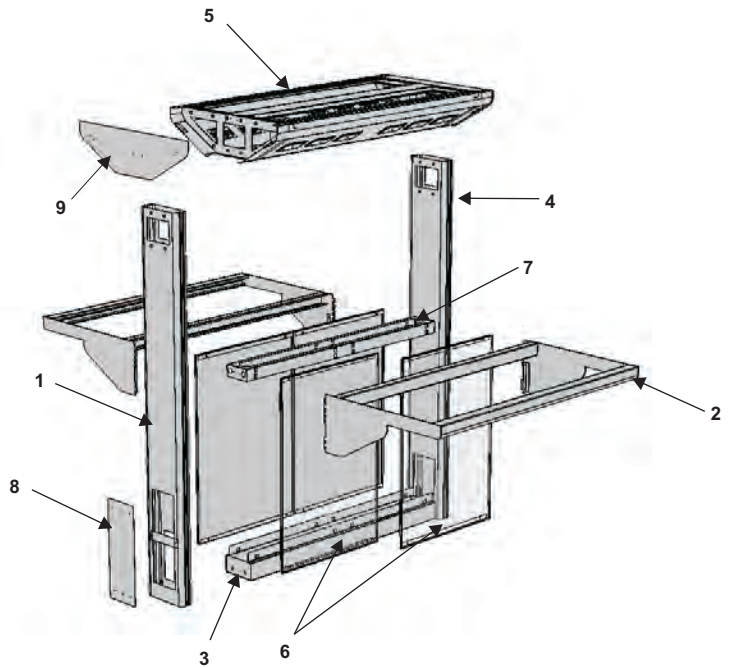

**Load Ratings**

**Load Maximums**

Maximum load ratings are live loads and include loads applied to top of work surface, including total weight of work surface, suspended cabinetry and other accessories. These capacities should be used as guidelines only. Please contact Mott Manufacturing for specific load requirements. Maximum load ratings are based on the load being evenly balanced on both sides. Individual component or assembly load ratings should not be exceeded for any surface.

**Maximum Load Ratings**

**Modular Support Structure**

- Top of Core..... 180lbs
- Cantilevered Work surface..... 400lbs

**Cabinets**

- Suspended Base Cabinets..... 300lbs
- Upper Cabinets..... 300lbs

**Total Island Core Assembly**

- Island Core..... 1760lbs

Includes two work surfaces at 400lbs each, and any combination of suspended base cabinets and upper cabinets (at their rated loads). Loads must be balanced both sides.

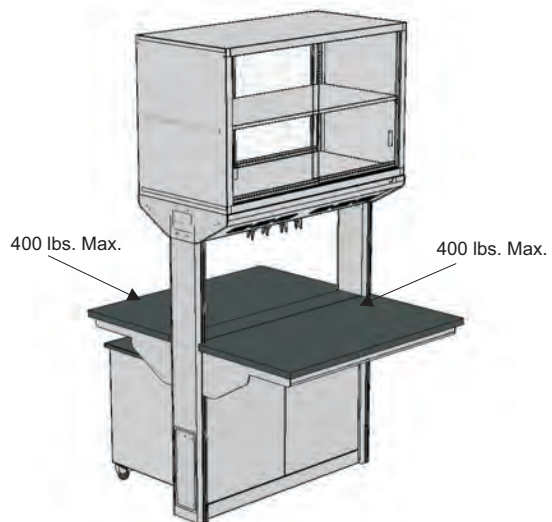

Island Single Core Assembly

*SIGMA FUSION - RAISED DISTRIBUTION SYSTEM*

**Sigma Fusion™ - Raised Distribution System**

The raised distribution system can house utilities such as piping, electric, data, light fixtures. Provides quick and easy access to services while providing superior flexibility, by keeping the work surface open to accommodate equipment and procedures.

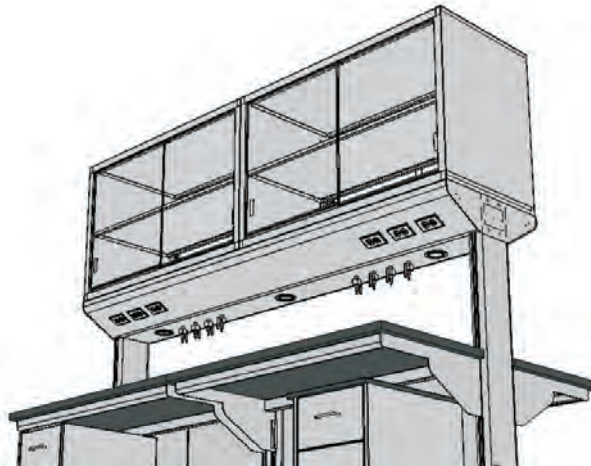

**Raised Distribution System Views**

**Typical Bottom Views**

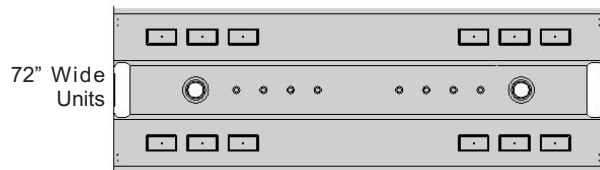
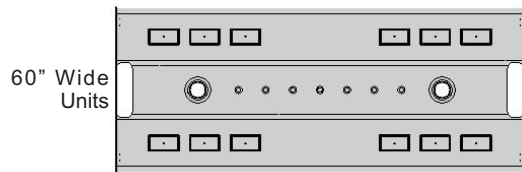

**Side View with Fusion™ Carrier End Cap**

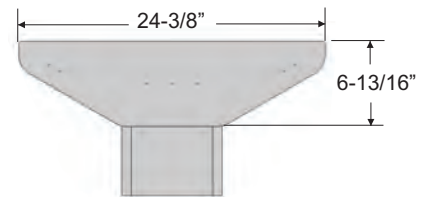

- ← Electrical cutout with cover plate
- ← Recessed light
- ← Service fixture hole

Typical Bottom Views for 132" & 144" Wide Units available upon request.

**SIGMA FUSION™**

**Island Single Core Assembly**



Width	Item Number
48"	CAS1048
60"	CAS1060
72"	CAS1072

- Island Single Core assembly is 62" high by 8" deep and comes complete with cantilevered table frames, height adjustable in 1" increments (work surface not included).
- Overall depth of core is 54" deep with 23" deep table frame (does not include work surface).
- Complete with hanging rails to suspend lower cabinets.
- To order suspended base cabinets, mobile cabinets and wall cabinets refer to the catalog sections.
- Shipped assembled.
- Wall cabinets (single or double sided) must be ordered with option code "FM" to mount on Sigma Fusion™ (special mounting provisions must be made).

Typical Sigma Fusion™ work top for Island Single Core Assembly.

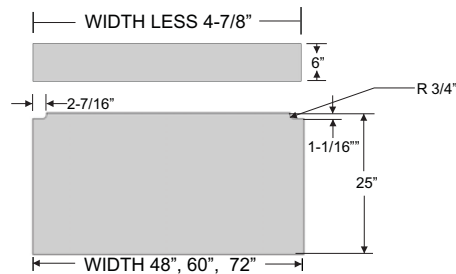

**Island Double Core Assembly**

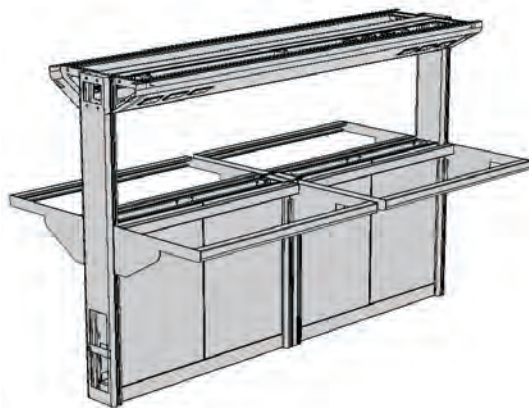

Width	Item Number
96"	CAS2048
108"	CAS2054
120"	CAS2060
132"	CAS2066
144"	CAS2072

- Island Double Core assembly is 62" high by 8" deep and comes complete with cantilevered table frames, height adjustable in 1" increments (work surface not included).
- Complete with hanging rails to suspend lower cabinets.
- To order suspended base cabinets, mobile cabinets and wall cabinets refer to the catalog sections.
- Overall depth of core is 54" deep with 23" deep table frame (does not include work surface).
- Shipped assembled.
- Wall cabinets (single or double sided) must be ordered with option code "FM" to mount on Sigma Fusion™ (special mounting provisions must be made).

Typical Sigma Fusion™ work top for Island Double Core Assembly.

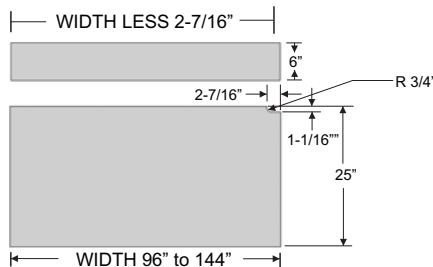

## SIGMA FUSION™ COMPONENTS

### Fusion™ Post Cover Panel



<b>Item Number</b>
--------------------

CSM0001
---------

- Single cover panel used to cover exposed end of Sigma Fusion™ post.
- Cover slides on for easy installation.

### Fusion™ Carrier End Cap



<b>Item Number</b>
--------------------

CSM1001
---------

- Single end cover cap used to enclose uncovered ends of Sigma Fusion™ overhead service carrier assembly.
- Suitable for Sigma Fusion™ only.

### Fusion™ Connector Plate

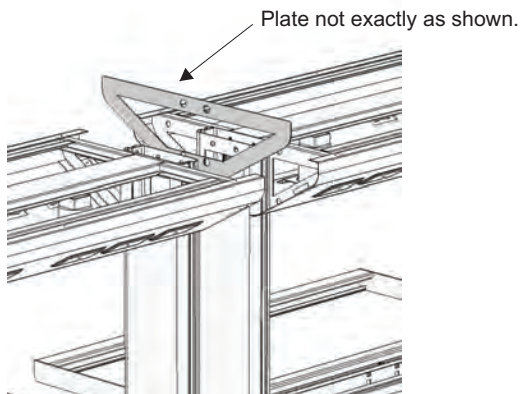

<b>Item Number</b>
--------------------

CSM2001
---------

- Plate used to join Sigma Fusion™ assemblies end to end.
- Mounting hardware not included.
- Suitable for Sigma Fusion™ only.
- Drawing not exactly as shown