

**STEEL CASEWORK  
SUSPENDED CABINETS**

**Open Units**

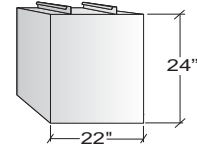

**Note:** Add Option Code 15 to order a finished back on these units.

Width	Item Number
15"	1950000
18"	1150000
24"	1250000
30"	1350000
36"	1450000
42"	1850000
48"	1550000
513mm	1650000
1000mm	1750000

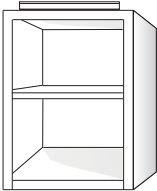

**Full Door Units**

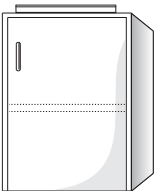

up to 24" wide

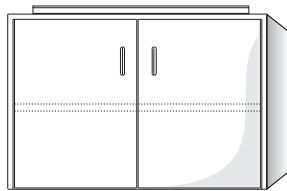

30" and wider

Width	Right Hinged	Left Hinged	# of Doors
15"	1950011	1950211	1
18"	1150011	1150211	1
24"	1250011	1250211	1
30"	1350011	-	2
36"	1450011	-	2
42"	1850011	-	2
48"	1550011	-	2
513mm	1650011	1650211	1
1000mm	1750011	-	2

**Door/Drawer Units**

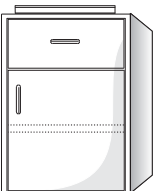

up to 24" wide

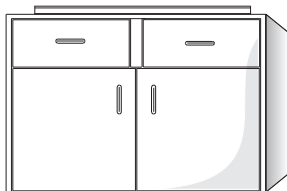

30" and wider

Width	Right Hinged	Left Hinged	# of Doors
15"	1950022	1950222	1
18"	1150022	1150222	1
24"	1250022	1250222	1
30"	1350022	-	2
36"	1450022	-	2
42"	1850022	-	2
48"	1550022	-	2
513mm	1650022	1650222	1
1000mm	1750022	-	2

- Cabinets up to 24" wide receive one shelf.
- Cabinets 25" and wider do not have a shelf.

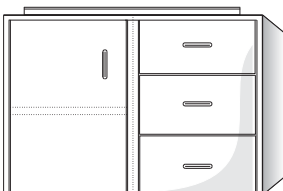

Width	Left Hand	Right Hand
30"	1350014	1350041
36"	1450014	1450041
42"	1850014	1850041
48"	1550014	1550041
1000mm	1750014	1750041

- Left hand Door/Drawer Unit shown.
- Right hand Door/Drawer Units are reverse of what is shown.

**STEEL CASEWORK  
SUSPENDED CABINETS**

**Drawer Units**

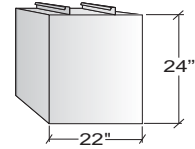

**Note:** Add Option Code 15 to order a finished back on these units.



up to 24" wide



30" and wider

Width	Item Number
15"	1950044
18"	1150044
24"	1250044
30"	1350044
36"	1450044
42"	1850044
48"	1550044
513mm	1650044
1000mm	1750044



up to 24" wide



30" and wider

Width	Item Number
15"	1950055
18"	1150055
24"	1250055
30"	1350055
36"	1450055
42"	1850055
48"	1550055
513mm	1650055
1000mm	1750055



up to 24" wide



30" and wider

Width	Item Number
15"	1950066
18"	1150066
24"	1250066
30"	1350066
36"	1450066
42"	1850066
48"	1550066
513mm	1650066
1000mm	1750066

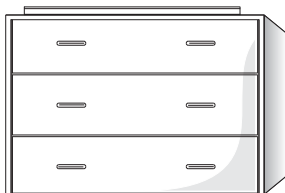

Width	Item Number
30"	1350097
36"	1450097
42"	1850097
48"	1550097
1000mm	1750097

**STEEL CASEWORK  
SUSPENDED CABINETS**

**Drawer Units**

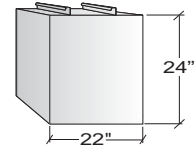

**Note:** Add Option Code 15 to order a finished back on these units.

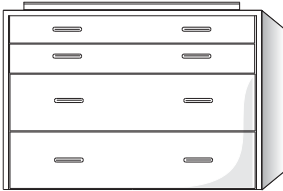

Width	Item Number
30"	1350098
36"	1450098
42"	1850098
48"	1550098
1000mm	1750098

**File Drawer Units**



up to 24" wide



30" and wider

Width	Item Number
15"	1950122
18"	1150122
24"	1250122
30"	1350122
36"	1450122
42"	1850122
48"	1550122
513mm	1650122
1000mm	1750122



up to 24" wide



30" and wider

Width	Item Number
15"	1950177
18"	1150177
24"	1250177
30"	1350177
36"	1450177
42"	1850177
48"	1550177
513mm	1650177
1000mm	1750177



up to 24" wide



30" and wider

Width	Item Number
15"	1950188
18"	1150188
24"	1250188
30"	1350188
36"	1450188
42"	1850188
48"	1550188
513mm	1650188
1000mm	1750188

**STEEL CASEWORK  
SUSPENDED CABINETS**

**Sliding Door Units**

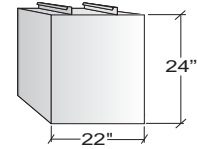

**Note:** Add Option Code 15 to order a finished back on these units.

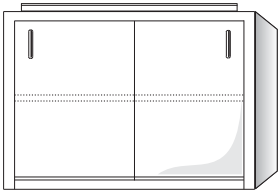

Width	Item Number
30"	1350711
36"	1450711
42"	1850711
48"	1550711
1000mm	1750711

**Sink Units**

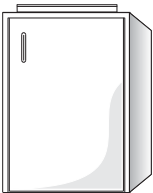

up to 24" wide

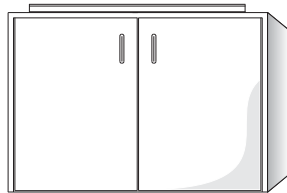

30" and wider

Width	Right Hinged	Left Hinged	# of Doors
15"	1953011	1953211	1
18"	1153011	1153211	1
24"	1253011	1253211	1
30"	1353011	-	2
36"	1453011	-	2
42"	1853011	-	2
48"	1553011	-	2
513mm	1653011	1653211	1
1000mm	1753011	-	2

**Acid Storage Units**

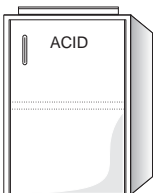

up to 24" wide

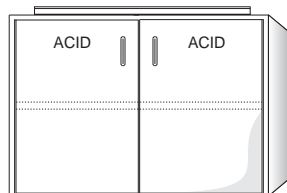

30" and wider

Width	Right Hinged	Left Hinged	# of Doors
15"	1951011	1951211	1
18"	1151011	1151211	1
24"	1251011	1251211	1
30"	1351011	-	2
36"	1451011	-	2
42"	1851011	-	2
48"	1551011	-	2
513mm	1651011	1651211	1
1000mm	1751011	-	2

- Acid Storage Units have a FRP liner.

**Solvent Storage Units**

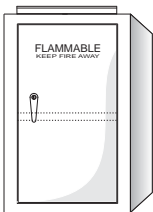

up to 24" wide

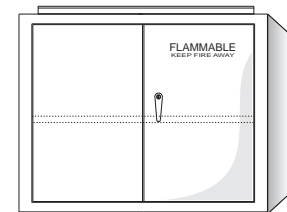

30" and wider

Width	Right Hinged	Left Hinged	# of Doors
15"	1952211	1952311	1
18"	1152211	1152311	1
24"	1252211	1252311	1
30"	1352211	-	2
36"	1452211	-	2
42"	1852211	-	2
48"	1552211	-	2
513mm	1652211	1652311	1
1000mm	1752211	-	2

- Solvent Units are not insulated.
- Add Option code 83 to order Self Closing/Latching doors.
- Add Option Code "FL" to order self closing/latching doors with a fusible link.
- Solvent Units are designed to meet OSHA and NFPA 30 standards.

**STEEL CASEWORK  
SUSPENDED CABINETS**

**Open Units**

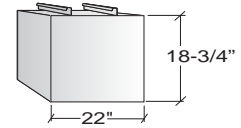

**Note:** Add Option Code 15 to order a finished back on these units.

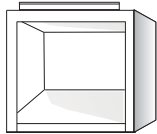

Width	Item Number
15"	1960000
18"	1160000
24"	1260000
30"	1360000
36"	1460000
42"	1860000
48"	1560000
513mm	1660000
1000mm	1760000

**Full Door Unit**

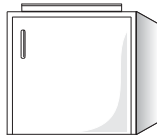

up to 24" wide

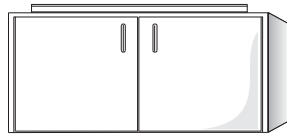

30" and wider

Width	Right Hinged	Left Hinged	# of Doors
15"	1960011	1960211	1
18"	1160011	1160211	1
24"	1260011	1260211	1
30"	1360011	-	2
36"	1460011	-	2
42"	1860011	-	2
48"	1560011	-	2
513mm	1660011	1660211	1
1000mm	1760011	-	2

**Door/Drawer Units**

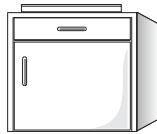

up to 24" wide

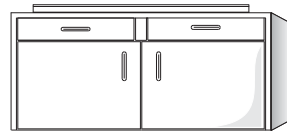

30" and wider

Width	Right Hinged	Left Hinged	# of Doors
15"	1960022	1960222	1
18"	1160022	1160222	1
24"	1260022	1260222	1
30"	1360022	-	2
36"	1460022	-	2
42"	1860022	-	2
48"	1560022	-	2
513mm	1660022	1660222	1
1000mm	1760022	-	2

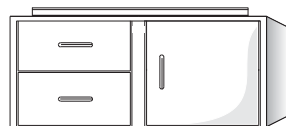

Width	Item Number
30"	1360041
36"	1460041
42"	1860041
48"	1560041
1000mm	1760041

**STEEL CASEWORK  
SUSPENDED CABINETS**

**Drawer Units**

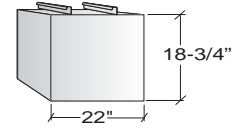

**Note:** Add Option Code 15 to order a finished back on these units.

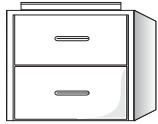

up to 24" wide



30" and wider

Width	Item Number
15"	1960044
18"	1160044
24"	1260044
30"	1360044
36"	1460044
42"	1860044
48"	1560044
513mm	1660044
1000mm	1760044

**File Drawer Units**

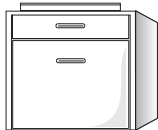

up to 24" wide



30" and wider

Width	Item Number
15"	1960177
18"	1160177
24"	1260177
30"	1360177
36"	1460177
42"	1860177
48"	1560177
513mm	1660177
1000mm	1760177

**Sink Units**

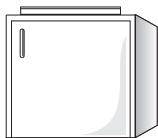

up to 24" wide

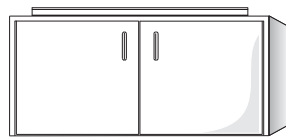

30" and wider

Width	Right Hinged	Left Hinged	# of Doors
15"	1963011	1963211	1
18"	1163011	1163211	1
24"	1263011	1263211	1
30"	1363011	-	2
36"	1463011	-	2
42"	1863011	-	2
48"	1563011	-	2
513mm	1663011	1663211	1
1000mm	1763011	-	2