

PRO BENCH - VERTICAL SASH

This general purpose fume hood is designed to meet most laboratory Constant Air Volume (CAV) or Variable Air Volume (VAV) requirements and supplied with an automatic compensating upper by-pass. For VAV, use option S2 for a restricted by-pass plate. Designed to mount on a 30" deep counter top. The Pro bench mounted fume hood is supplied with the following standard features:



Counterbalance Systems - Chain and sprocket system delivers the easiest and most reliable sash operation available with an exceptionally long life span. High quality stainless steel cable system provides economical and reliable operation; tested to 100,000 cycles with no failure.

Stainless Steel Airfoil - Aerodynamic raised design allows air to enter the fume hood even when the sash is closed ensuring efficient fume exhaust. Notches in both corners allow electrical wiring or tubing into the fume hood while still permitting full closure of the sash.

Sash Design - 6mm laminated safety glass is provided with a stainless steel handle and side runners, optional tempered glass or polycarbonate available for special applications. Hood has a vertical sash. 30" viewing height.

Stainless Steel Type 316 Exhaust Collar - Round collar with radiused corners allows for direct connection to exhaust duct to reduce duct transition costs, minimize static pressure losses and exhaust noise levels.

Electrical - Two UL/CSA approved duplex receptacles provided for 120 volt service, one on each corner post. UL/CSA approved fluorescent light fixture and switch provided. T5 fluorescent or LED lighting are available options.

Plumbing - Both corner posts are pre-punched to accept a maximum of five plumbing fittings per post. Factory pre-plumbing is available as well as plumbing fixtures from a variety of manufacturers to meet most plumbing needs.

Access Panels - Interior gasketed access panels provide convenient access and prevent fume leakage outside the hood chamber. Exterior side panels are also removable for ease of access to plumbing and electrical service fixtures.

Agency Approvals - UL 1805 Classified, CSA certified to UL 61010 and tested in accordance with ASHRAE 110. Test results available upon request.

Vertical Raising Sash (Cable Sash System)					
Width	FRP	PVC	Epoxy	316 S/S Sq. Cor	316 S/S Rad. Cor
36"	7121000	7123000	7126000	7124000	7125000
48"	7221000	7223000	7226000	7224000	7225000
60"	7321000	7323000	7326000	7324000	7325000
72"	7421000	7423000	7426000	7424000	7425000
96"	7521000	7523000	7526000	7524000	7525000
1000mm	7B21000	7B23000	7B26000	7B24000	7B25000
1513mm	7C21000	7C23000	7C26000	7C24000	7C25000
2000mm	7D21000	7D23000	7D26000	7D24000	7D25000

Vertical Raising Sash (Chain & Sprocket Sash System)					
Width	FRP	PVC	Epoxy	316 S/S Sq. Cor	316 S/S Rad. Cor
36"	7121040	7123040	7126040	7124040	7125040
48"	7221040	7223040	7226040	7224040	7225040
60"	7321040	7323040	7326040	7324040	7325040
72"	7421040	7423040	7426040	7424040	7425040
96"	7521040	7523040	7526040	7524040	7525040
1000mm	7B21040	7B23040	7B26040	7B24040	7B25040
1513mm	7C21040	7C23040	7C26040	7C24040	7C25040
2000mm	7D21040	7D23040	7D26040	7D24040	7D25040

PRO BENCH - VERTICAL SASH

Exhaust Parameters

Hood Size	Duct Dia.	100 FPM 18" Max Sash Opening		100 FPM 28-1/2" Max* Sash Opening		80 FPM 18" Max Sash Opening		80 FPM 28-1/2" Max* Sash Opening	
		CFM	SP	CFM	SP	CFM	SP	CFM	SP
36"	10"	350	0.04	543	0.10	280	0.03	434	0.05
48"	10"	508	0.09	789	0.20	407	0.06	630	0.15
60"	12"	667	0.07	1035	0.20	533	0.05	830	0.15
72"	12"	825	0.11	1280	0.25	660	0.07	1025	0.20
96"	2@10"	1142	0.11	1772	0.25	913	0.07	1418	0.20
1000mm	10"	395	0.05	612	0.15	316	0.04	490	0.10
1513mm	12"	660	0.07	1025	0.20	528	0.05	820	0.15
2000mm	12"	914	0.14	1419	0.30	731	0.09	1135	0.20

* 28-1/2" max sash opening is recommended for set-up and tear down only.

Typical Roof Details

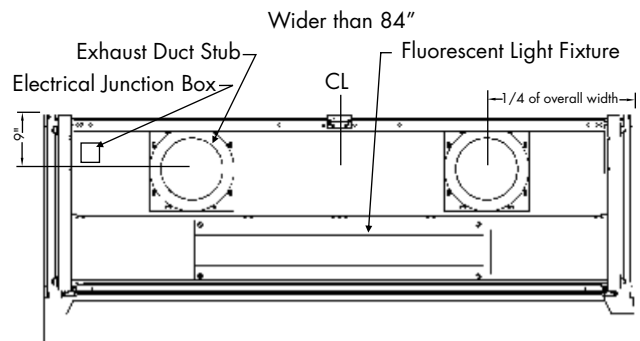
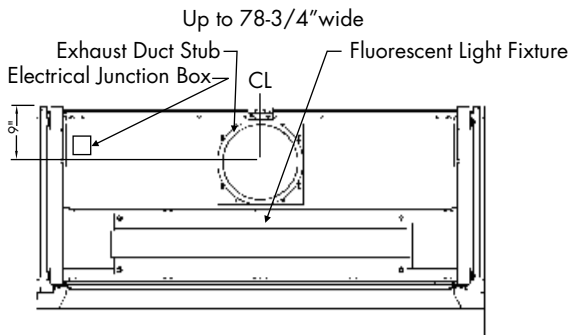

Side Section Details

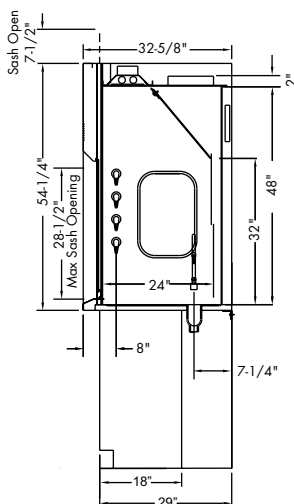

PRO RESTRICTED BY-PASS BENCH - VERTICAL SASH

This general purpose fume hood is designed to meet most laboratory Variable Air Volume (VAV) requirements and supplied with a restricted upper by-pass. Designed to mount on a 30" deep counter top. The Pro bench mounted fume hood is supplied with the following standard features:



Counterbalance System - Chain and sprocket system delivers the easiest and most reliable sash operation available with an exceptionally long life span. High quality stainless steel cable system provides economical and reliable operation; tested to 100,000 cycles with no failure.

Stainless Steel Airfoil - Aerodynamic raised design allows air to enter the fume hood even when the sash is closed ensuring efficient fume exhaust. Notches in both corners allow electrical wiring or tubing into the fume hood while still permitting full closure of the sash.

Sash Design - 6mm laminated safety glass is provided with a stainless steel handle and side runners, optional tempered glass or polycarbonate available for special applications. Hoods are supplied with a vertical rising sash. 30" viewing height.

Stainless Steel Type 316 Exhaust Collar - Round collar with radiused corners allows for direct connection to exhaust duct to reduce duct transition costs, minimize static pressure losses and exhaust noise levels.

Electrical - Two UL/CSA approved duplex receptacles provided for 120 volt service, one on each corner post. UL/CSA approved fluorescent light fixture and switch provided. T5 fluorescent or LED lighting are available options.

Plumbing - Both corner posts are pre-punched to accept a maximum of five plumbing fittings per post. Factory pre-plumbing is available as well as plumbing fixtures from a variety of manufacturers to meet most plumbing needs.

Access Panels - Interior gasketed access panels provide convenient access and prevent fume leakage outside the hood chamber. Exterior side panels are also removable for ease of access to plumbing and electrical service fixtures.

Agency Approvals - UL 1805 Classified, CSA certified to UL 61010 and tested in accordance with ASHRAE 110. Test results available upon request.

Vertical Raising Sash (Cable Sash System)					
Width	FRP	PVC	Epoxy	316 S/S Sq. Cor	316 S/S Rad. Cor
36"	7121000-S2	7123000-S2	7126000-S2	7124000-S2	7125000-S2
48"	7221000-S2	7223000-S2	7226000-S2	7224000-S2	7225000-S2
60"	7321000-S2	7323000-S2	7326000-S2	7324000-S2	7325000-S2
72"	7421000-S2	7423000-S2	7426000-S2	7424000-S2	7425000-S2
96"	7521000-S2	7523000-S2	7526000-S2	7524000-S2	7525000-S2
1000mm	7B21000-S2	7B23000-S2	7B26000-S2	7B24000-S2	7B25000-S2
1513mm	7C21000-S2	7C23000-S2	7C26000-S2	7C24000-S2	7C25000-S2
2000mm	7D21000-S2	7D23000-S2	7D26000-S2	7D24000-S2	7D25000-S2

Vertical Raising Sash (Chain & Sprocket Sash System)					
Width	FRP	PVC	Epoxy	316 S/S Sq. Cor	316 S/S Rad. Cor
36"	7121040-S2	7123040-S2	7126040-S2	7124040-S2	7125040-S2
48"	7221040-S2	7223040-S2	7226040-S2	7224040-S2	7225040-S2
60"	7321040-S2	7323040-S2	7326040-S2	7324040-S2	7325040-S2
72"	7421040-S2	7423040-S2	7426040-S2	7424040-S2	7425040-S2
96"	7521040-S2	7523040-S2	7526040-S2	7524040-S2	7525040-S2
1000mm	7B21040-S2	7B23040-S2	7B26040-S2	7B24040-S2	7B25040-S2
1513mm	7C21040-S2	7C23040-S2	7C26040-S2	7C24040-S2	7C25040-S2
2000mm	7D21040-S2	7D23040-S2	7D26040-S2	7D24040-S2	7D25040-S2

PRO RESTRICTED BY-PASS BENCH - VERTICAL SASH

Exhaust Parameters

Hood Size	Duct Dia.	100 FPM 18" Max Sash Opening		100 FPM 28-1/2" Max*		80 FPM 18" Max Sash Opening		80 FPM 28-1/2" Max*	
		CFM	SP	CFM	SP	CFM	SP	CFM	SP
36"	10"	350	0.04	543	0.10	280	0.03	434	0.05
48"	10"	508	0.09	789	0.20	407	0.06	630	0.15
60"	12"	667	0.07	1035	0.20	533	0.05	830	0.15
72"	12"	825	0.11	1280	0.25	660	0.07	1025	0.20
96"	2@10"	1142	0.11	1772	0.25	913	0.07	1418	0.20
1000mm	10"	395	0.05	612	0.15	316	0.04	490	0.10
1513mm	12"	660	0.07	1025	0.20	528	0.05	820	0.15
2000mm	12"	914	0.14	1419	0.30	731	0.09	1135	0.20

* 28-1/2" max sash opening is recommended for set-up and tear down only.

Typical Roof Details

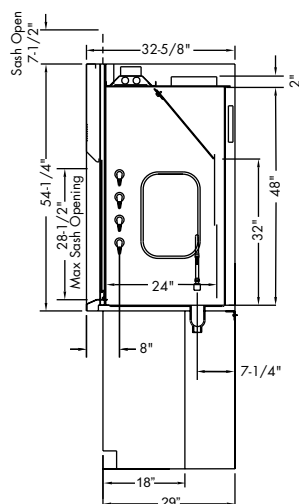
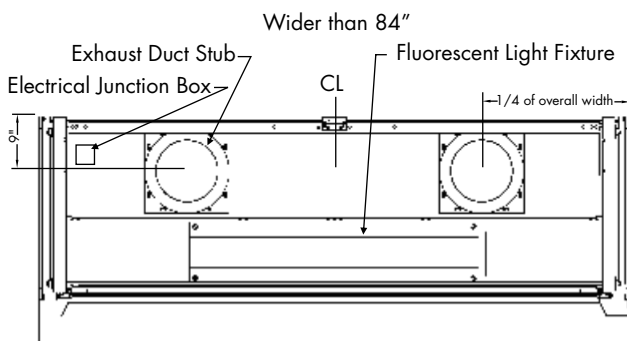
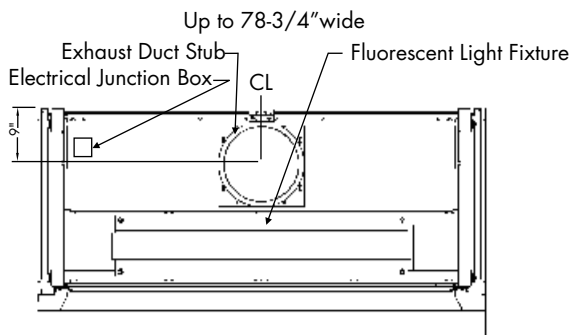

PRO RESTRICTED BY-PASS BENCH WITH VISION PANEL - VERTICAL SASH

This general purpose fume hood is designed to meet most laboratory Variable Air Volume (VAV) requirements and supplied with a restricted upper by-pass. Designed to mount on a 30" deep counter top. The Pro bench mounted fume hood is supplied with the following standard features:



Counterbalance Systems - Chain and sprocket system delivers the easiest and most reliable sash operation available with an exceptionally long life span. High quality stainless steel cable system provides economical and reliable operation; tested to 100,000 cycles with no failure.

Stainless Steel Airfoil - Aerodynamic raised design allows air to enter the fume hood even when the sash is closed ensuring efficient fume exhaust. Notches in both corners allow electrical wiring or tubing into the fume hood while still permitting full closure of the sash.

Full Viewing Area - Provides a clear and unobstructed side to side view of fume hood interior. Rear mounted fixed tinted visor included. 44" viewing height.

Sash Design - 6mm laminated safety glass is provided with a stainless steel handle and side runners, optional tempered glass or polycarbonate available for special applications. Hood has a vertical sash.

Stainless Steel Type 316 Exhaust Collar - Round collar with radiused corners allows for direct connection to exhaust duct to reduce duct transition costs, minimize static pressure losses and exhaust noise levels.

Electrical - Two UL/CSA approved duplex receptacles provided for 120 volt service, one on each corner post. UL/CSA approved fluorescent light fixture and switch provided. T5 fluorescent or LED lighting are available options.

Plumbing - Both corner posts are pre-punched to accept a maximum of five plumbing fittings per post. Factory pre-plumbing is available as well as plumbing fixtures from a variety of manufacturers to meet most plumbing needs.

Access Panels - Interior gasketed access panels provide convenient access and prevent fume leakage outside the hood chamber. Exterior side panels are also removable for ease of access to plumbing and electrical service fixtures.

Agency Approvals - UL 1805 Classified, CSA certified to UL 61010 and tested in accordance with ASHRAE 110. Test results available upon request.

Vertical Raising Sash (Cable Sash System)

Width	FRP	PVC	Epoxy	316 S/S Sq. Cor
36"	7151000	7153000	7156000	7154000
48"	7251000	7253000	7256000	7254000
60"	7351000	7353000	7356000	7354000
72"	7451000	7453000	7456000	7454000
96"	7551000	7553000	7556000	7554000
1000mm	7B51000	7B53000	7B56000	7B54000
1513mm	7C51000	7C53000	7C56000	7C54000
2000mm	7D51000	7D53000	7D56000	7D54000

Vertical Raising Sash (Chain & Sprocket Sash System)

Width	FRP	PVC	Epoxy	316 S/S Sq. Cor	316 S/S Rad. Cor
36"	7151040	7153040	7156040	7154040	7155040
48"	7251040	7253040	7256040	7254040	7255040
60"	7351040	7353040	7356040	7354040	7355040
72"	7451040	7453040	7456040	7454040	7455040
96"	7551040	7553040	7556040	7554040	7555040
1000mm	7B51040	7B53040	7B56040	7B54040	7B55040
1513mm	7C51040	7C53040	7C56040	7C54040	7C55040
2000mm	7D51040	7D53040	7D56040	7D54040	7D55040

PRO RESTRICTED BY-PASS BENCH WITH VISION PANEL - VERTICAL SASH

Exhaust Parameters

Hood Size	Duct Dia.	100 FPM 18" Max Sash Opening		100 FPM 28-1/2" Max* Sash Opening		80 FPM 18" Max Sash Opening		80 FPM 28-1/2" Max* Sash Opening	
		CFM	SP	CFM	SP	CFM	SP	CFM	SP
36"	10"	350	0.04	543	0.10	280	0.03	434	0.05
48"	10"	508	0.09	789	0.20	407	0.06	630	0.15
60"	12"	667	0.07	1035	0.20	533	0.05	830	0.15
72"	12"	825	0.11	1280	0.25	660	0.07	1025	0.20
96"	2@10"	1142	0.11	1772	0.25	913	0.07	1418	0.20
1000mm	10"	395	0.05	612	0.15	316	0.04	490	0.10
1513mm	12"	660	0.07	1025	0.20	528	0.05	820	0.15
2000mm	12"	914	0.14	1419	0.30	731	0.09	1135	0.20

* 28-1/2" max sash opening is recommended for set-up and tear down only.

Typical Roof Details

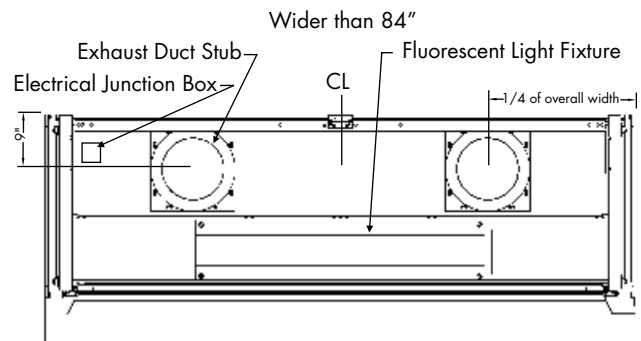
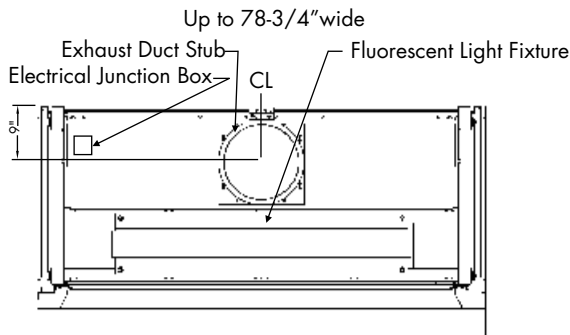

Side Section Details

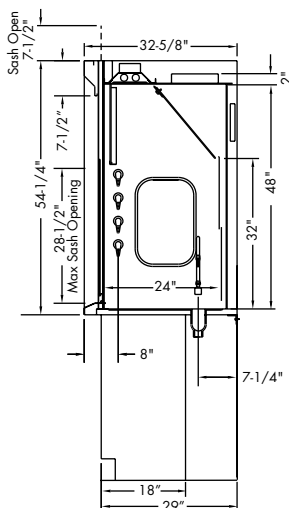

PRO BENCH - COMBINATION SASH

This general purpose fume hood is designed to meet most laboratory Constant Air Volume (CAV) or Variable Air Volume (VAV) requirements and supplied with a restricted upper by-pass. Designed to mount on a 30" deep counter top. The Pro bench mounted fume hood is supplied with the following standard features:



Counterbalance System - Chain and sprocket system delivers the easiest and most reliable sash operation available with an exceptionally long life span. High quality stainless steel cable system provides economical and reliable operation; tested to 100,000 cycles with no failure.

Stainless Steel Airfoil - Aerodynamic raised design allows air to enter the fume hood even when the sash is closed ensuring efficient fume exhaust. Notches in both corners allow electrical wiring or tubing into the fume hood while still permitting full closure of the sash.

Sash Design - 6mm laminated safety glass is provided with a stainless steel handle and side runners, optional tempered glass or polycarbonate available for special applications. Hoods are supplied with a combination vertical rising and horizontal sliding sashes. 30" viewing height.

Stainless Steel Type 316 Exhaust Collar - Round collar with radiused corners allows for direct connection to exhaust duct to reduce duct transition costs, minimize static pressure losses and exhaust noise levels.

Electrical - Two UL/CSA approved duplex receptacles provided for 120 volt service, one on each corner post. UL/CSA approved fluorescent light fixture and switch provided. T5 fluorescent or LED lighting are available options.

Plumbing - Both corner posts are pre-punched to accept a maximum of five plumbing fittings per post. Factory pre-plumbing is available as well as plumbing fixtures from a variety of manufacturers to meet most plumbing needs.

Access Panels - Interior gasketed access panels provide convenient access and prevent fume leakage outside the hood chamber. Exterior side panels are also removable for ease of access to plumbing and electrical service fixtures.

Agency Approvals - UL 1805 Classified, CSA certified to UL 61010 and tested in accordance with ASHRAE 110. Test results available upon request.

Combination Sash (Cable Sash System)						Horizontal Glass Panels			
Width	FRP	PVC	Epoxy	316 S/S Sq. Cor	316 S/S Rad. Cor	Panel Width	Width Opening	Height Opening	# of Panels
48"	7221010	7223010	7226010	7224010	7225010	9-3/4"	16"	28"	4
60"	7321010	7323010	7326010	7324010	7325010	12-3/4"	22"	28"	4
72"	7421010	7423010	7426010	7424010	7425010	15-3/4"	28"	28"	4
96"	7521010	7523010	7526010	7524010	7525010	14-13/16"	38-7/8"	28"	6
1513mm	7C21010	7C23010	7C26010	7C24010	7C25010	12-5/8"	21-13/16"	28"	4
2000mm	7D21010	7D23010	7D26010	7D24010	7D25010	11-15/16"	30-1/4"	28"	6

Combination Sash (Chain & Sprocket Sash System)						Horizontal Glass Panels			
Width	FRP	PVC	Epoxy	316 S/S Sq. Cor	316 S/S Rad. Cor	Panel Width	Width Opening	Height Opening	# of Panels
48"	7221050	7223050	7226050	7224050	7225050	9-3/4"	16"	28"	4
60"	7321050	7323050	7326050	7324050	7325050	12-3/4"	22"	28"	4
72"	7421050	7423050	7426050	7424050	7425050	15-3/4"	28"	28"	4
96"	7521050	7523050	7526050	7524050	7525050	14-13/16"	38-7/8"	28"	6
1513mm	7C21050	7C23050	7C26050	7C24050	7C25050	12-5/8"	21-13/16"	28"	4
2000mm	7D21050	7D23050	7D26050	7D24050	7D25050	11-15/16"	30-1/4"	28"	6

PRO BENCH - COMBINATION SASH

Exhaust Parameters

Hood Size	Duct Dia.	100 FPM 18" Max Sash Opening		100 FPM 1 1/2" Sliding Door Open		80 FPM 18" Max Sash Opening		80 FPM 1 1/2" Sliding Door Open	
		CFM	SP	CFM	SP	CFM	SP	CFM	SP
48"	10"	508	0.09	394	0.05	407	0.06	315	0.05
60"	12"	667	0.07	517	0.05	533	0.05	414	0.05
72"	12"	825	0.11	640	0.10	660	0.07	512	0.05
96"	2@10"	1142	0.11	886	0.10	913	0.07	709	0.05
1513mm	12"	660	0.07	513	0.10	528	0.05	410	0.05
2000mm	12"	914	0.14	709	0.10	731	0.09	567	0.05

Typical Roof Details

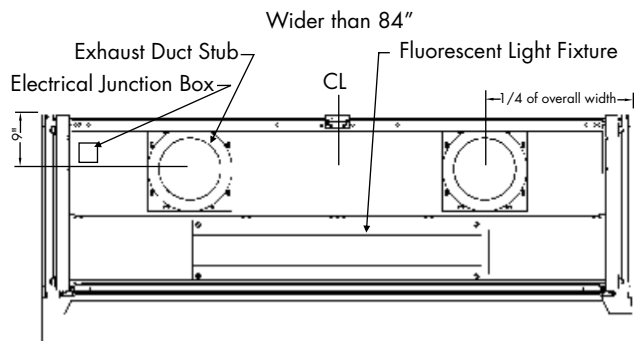
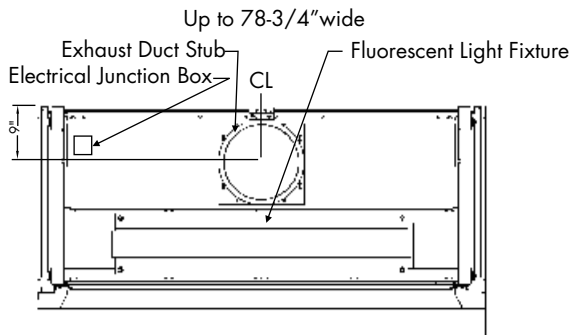

Side Section Details

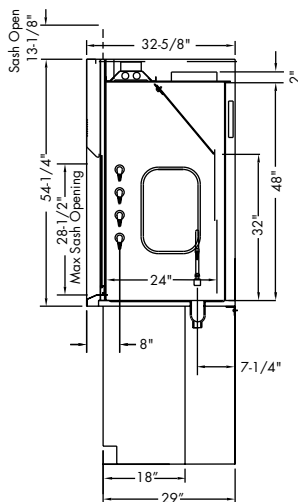

PRO CONSTANT VOLUME BENCH - SPLIT SASH/POSTLESS

This general purpose fume hood is designed to meet most laboratory Constant Air Volume (CAV) or Variable Air Volume (VAV) requirements and supplied with an automatic compensating upper by-pass. For VAV, use option S2 for a restricted by-pass plate. Designed to mount on a 30" deep counter top. The Pro bench mounted fume hood is supplied with the following standard features:

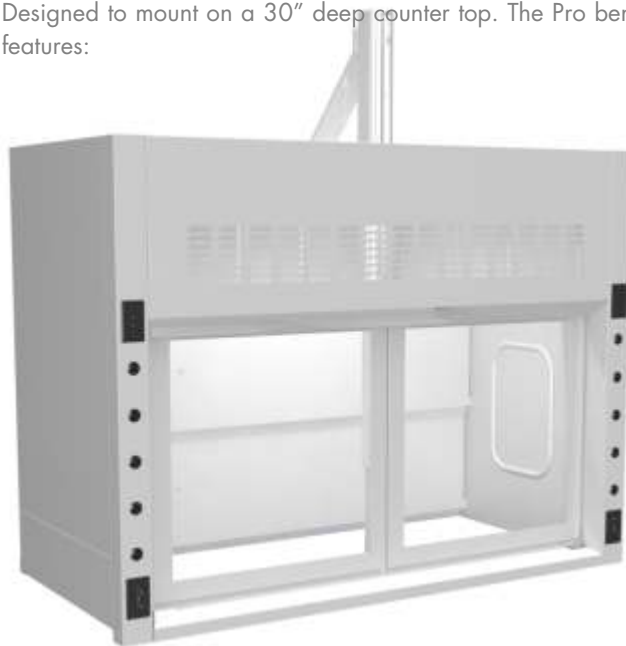

Counterbalance Systems - Chain and sprocket system delivers the easiest and most reliable sash operation available with an exceptionally long life span. High quality stainless steel cable system provides economical and reliable operation; tested to 100,000 cycles with no failure.

Stainless Steel Airfoil - Aerodynamic raised design allows air to enter the fume hood even when the sash is closed ensuring efficient fume exhaust. Notches in both corners allow electrical wiring or tubing into the fume hood while still permitting full closure of the sash.

Sash Design - 6mm laminated safety glass is provided with a stainless steel handle and side runners, optional tempered glass or polycarbonate available for special applications. Hood is supplied with two independently operated vertical rising sashes. 30" viewing height.

Stainless Steel Type 316 Exhaust Collar - Round collar with radiused corners allows for direct connection to exhaust duct to reduce duct transition costs, minimize static pressure losses and exhaust noise levels.

Electrical - Two UL/CSA approved duplex receptacles provided for 120 volt service, one on each corner post. UL/CSA approved fluorescent light fixture and switch provided. T5 fluorescent or LED lighting are available options.

Plumbing - Both corner posts are pre-punched to accept a maximum of five plumbing fittings per post. Factory pre-plumbing is available as well as plumbing fixtures from a variety of manufacturers to meet most plumbing needs.

Access Panels - Interior gasketed access panels provide convenient access and prevent fume leakage outside the hood chamber. Exterior side panels are also removable for ease of access to plumbing and electrical service fixtures.

Agency Approvals - UL 1805 Classified, CSA certified to UL 61010 and tested in accordance with ASHRAE 110. Test results available upon request.

Vertical Raising Split Postless Sash (Cable Sash System)

Width	FRP	PVC	Epoxy	316 S/S Sq. Cor	316 S/S Rad. Cor
72"	7421030	7423030	7426030	7424030	7425030
96"	7521030	7523030	7526030	7524030	7525030
120"	7621030	7623030	7626030	7624030	7625030
144"	7H21030	7H23030	7H26030	7H24030	7H25030
2000mm	7D21030	7D23030	7D26030	7D24030	7D25030

Vertical Raising Split Postless Sash (Chain & Sprocket Sash System)

Width	FRP	PVC	Epoxy	316 S/S Sq. Cor	316 S/S Rad. Cor
96"	7521080	7523080	7526080	7524080	7525080
120"	7621080	7623080	7626080	7624080	7625080
144"	7H21080	7H23080	7H26080	7H24080	7H25080
2000mm	7D21080	7D23080	7D26080	7D24080	7D25080

PRO CONSTANT VOLUME BENCH - SPLIT SASH/POSTLESS

Exhaust Parameters

Hood Size	Duct Dia.	100 FPM 18" Max Sash Opening		100 FPM 28-1/2" Max* Sash Opening		80 FPM 18" Max Sash Opening		80 FPM 28-1/2" Max* Sash Opening	
		CFM	SP	CFM	SP	CFM	SP	CFM	SP
72"	2@10"	825	0.06	1280	0.15	660	0.05	1025	0.10
96"	2@10"	1142	0.11	1772	0.25	913	0.07	1418	0.20
120"	2@10"	1458	0.09	2264	0.20	1167	0.06	1811	0.15
140"	2@10"	1775	0.13	2755	0.30	1420	0.08	2205	0.20
2000mm	2@10"	914	0.07	1419	0.17	731	0.05	1135	0.11

* 28-1/2" max sash opening is recommended for set-up and tear down only.

Typical Roof Details

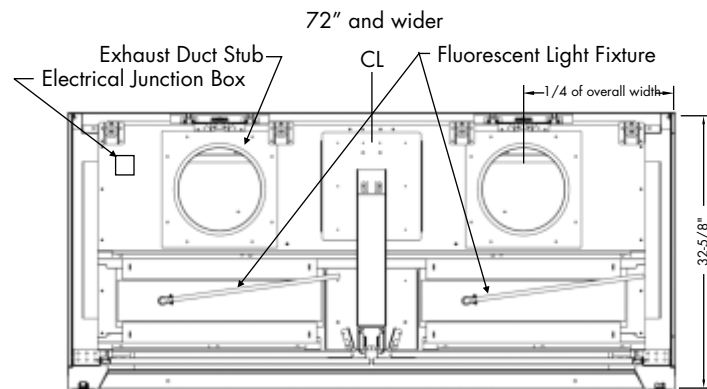

Side Section Details

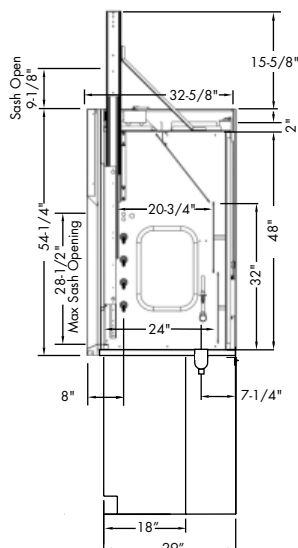

PRO LOW VOLUME BENCH - COMBINATION SASH

This low flow hood is designed to be used on a Low Constant Volume (LCV) system and supplied with restricted upper by-pass. Designed to mount on a 30" deep counter top. The Pro bench mounted fume hood is supplied with the following standard features all which reduces air (energy) consumption by approximately 75%:



Counterbalance System - Chain and sprocket system delivers the easiest and most reliable sash operation available with an exceptionally long life span. High quality stainless steel cable system provides economical and reliable operation; tested to 100,000 cycles with no failure.

Stainless Steel Airfoil - Aerodynamic raised design allows air to enter the fume hood even when the sash is closed ensuring efficient fume exhaust. Notches in both corners allow electrical wiring or tubing into the fume hood while still permitting full closure of the sash.

Sash Design - 6mm laminated safety glass is provided with a stainless steel handle and side runners, optional tempered glass or polycarbonate available for special applications. Hoods are supplied with a combination vertical rising and horizontal sliding sashes with keyed lock down mechanism. Laminated safety glass shield integral to the sash. 30" viewing height.

Stainless Steel Type 316 Exhaust Collar - Round collar with radiused corners allows for direct connection to exhaust duct to minimize static pressure losses and exhaust noise levels.

Electrical - Two UL/CSA approved duplex receptacles provided for 120 volt service, one on each corner post. UL/CSA approved fluorescent light fixture and switch provided. T5 fluorescent or LED lighting are available options.

Plumbing - Both corner posts are pre-punched to accept a maximum of five plumbing fittings per post. Factory pre-plumbing is available as well as plumbing fixtures from a variety of manufacturers to meet most plumbing needs.

Access Panels - Interior gasketed access panels provide convenient access and prevent fume leakage outside the hood chamber. Exterior side panels are also removable for ease of access to plumbing and electrical service fixtures.

Agency Approvals - UL 1805 Classified, CSA certified to UL 61010 and tested in accordance with ASHRAE 110. Test results available upon request.

Combination Sash (Cable Sash System)						Horizontal Glass Panels			
Width	FRP	PVC	Epoxy	316 S/S Sq. Cor	316 S/S Rad. Cor	Panel Width	Width Opening	Height Opening	# of Panels
48"	7221010-LV	7223010-LV	7226010-LV	7224010-LV	7225010-LV	9-3/4"	16"	17"	4
60"	7321010-LV	7323010-LV	7326010-LV	7324010-LV	7325010-LV	12-3/4"	22"	17"	4
72"	7421010-LV	7423010-LV	7426010-LV	7424010-LV	7425010-LV	15-3/4"	28"	17"	4
96"	7521010-LV	7523010-LV	7526010-LV	7524010-LV	7525010-LV	14-13/16"	38-7/8"	17"	6
1513mm	7C21010-LV	7C23010-LV	7C26010-LV	7C24010-LV	7C25010-LV	12-5/8"	21-13/16"	17"	4
2000mm	7D21010-LV	7D23010-LV	7D26010-LV	7D24010-LV	7D25010-LV	11-15/16"	30-1/4"	17"	6

Combination Sash (Chain & Sprocket Sash System)						Horizontal Glass Panels			
Width	FRP	PVC	Epoxy	316 S/S Sq. Cor	316 S/S Rad. Cor	Panel Width	Width Opening	Height Opening	# of Panels
48"	7221050-LV	7223050-LV	7226050-LV	7224050-LV	7225050-LV	9-3/4"	16"	17"	4
60"	7321050-LV	7323050-LV	7326050-LV	7324050-LV	7325050-LV	12-3/4"	22"	17"	4
72"	7421050-LV	7423050-LV	7426050-LV	7424050-LV	7425050-LV	15-3/4"	28"	17"	4
96"	7521050-LV	7523050-LV	7526050-LV	7524050-LV	7525050-LV	14-13/16"	38-7/8"	17"	6
1513mm	7C21050-LV	7C23050-LV	7C26050-LV	7C24050-LV	7C25050-LV	12-5/8"	21-13/16"	17"	4
2000mm	7D21050-LV	7D23050-LV	7D26050-LV	7D24050-LV	7D25050-LV	11-15/16"	30-1/4"	17"	6

PRO LOW VOLUME BENCH - COMBINATION SASH

Exhaust Parameters

Hood Size	Duct Dia.	100 FPM Working Position Sash (Locked Down)	
		CFM	SP
48"	10"	190	0.02
60"	12"	260	0.02
72"	12"	330	0.02
96"	2@10"	472	0.02
1000mm	10"	160	0.02
1513mm	12"	266	0.02
2000mm	12"	369	0.02

Note: Face velocities as low as 80 FPM will provide containment. However, NFPA minimum volume will not be met, therefore 100 FPM data only is provided.

Typical Roof Details

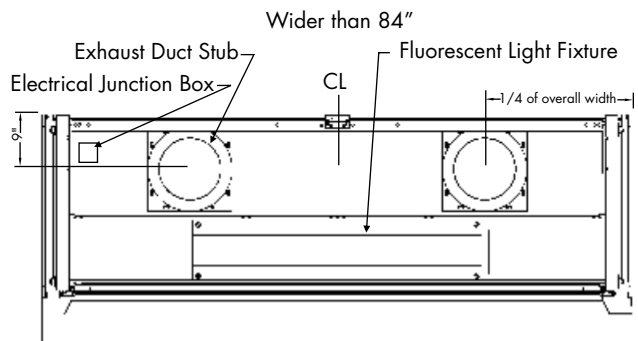
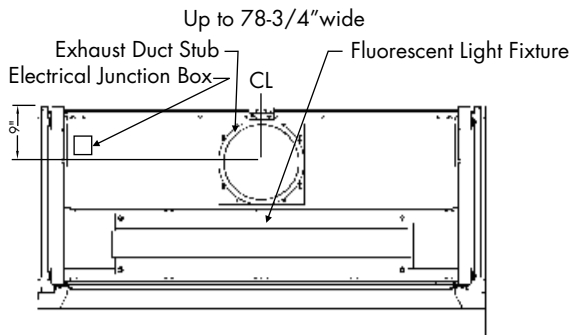

Side Section Details

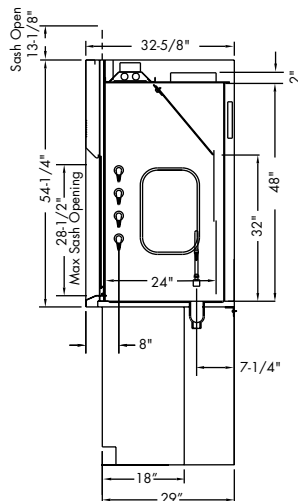

PRO DEMONSTRATION BENCH - VERTICAL SASH

Designed to permit demonstration and observation from both sides and meets most laboratory Constant Air Volume (CAV) or Variable Air Volume (VAV) requirements and supplied with a restricted upper by-pass. Can be used either free standing or positioned within a wall between a classroom and a prep room. Mounts on a 30" deep counter top. The Pro bench mounted fume hood is supplied with the following standard features:



Counterbalance System - High quality stainless steel cable system provides economical and reliable operation; tested to 100,000 cycles with no failure.

Stainless Steel Airfoil - Aerodynamic raised design allows air to enter the fume hood even when the sash is closed ensuring efficient fume exhaust. Notches in both corners allow electrical wiring or tubing into the fume hood while still permitting full closure of the sash.

Sash Design - 6mm laminated safety glass is provided with a stainless steel handle and side runners, optional tempered glass or polycarbonate available for special applications. Hoods are supplied with two vertical rising sashes. 30" viewing height.

Stainless Steel Type 316 Exhaust Collar - Round collar with radiused corners allows for direct connection to exhaust duct to reduce duct transition costs, minimize static pressure losses and exhaust noise levels.

Electrical - Four UL/CSA approved duplex receptacles provided for 120 volt service, one on each corner post. UL/CSA approved fluorescent light fixture and three-way light switch on both sides of hood provided. T5 fluorescent or LED lighting are available options.

Plumbing - Two corner posts pre-punched to accept a maximum of 5 plumbing fittings per post, at one end, opposite end reserved for counter weights. Factory pre-plumbing is available as well as plumbing fixtures from a variety of manufacturers to meet most plumbing needs.

Access Panels - Interior gasketed access panel is on the same side wall as the plumbing and provides convenient access and prevent fume leakage outside the hood chamber. Exterior side panels are also removable for ease of access to plumbing and electrical service fixtures.

Agency Approvals - UL 1805 Classified, CSA certified to UL 61010 and tested in accordance with ASHRAE 110. Test results available upon request.

Note: Special airflow consideration required when installing between two rooms - Please contact Mott Manufacturing for more information. If alarm is required, mounting is recommended on end with plumbing.

Vertical Raising Sash (Cable Sash System)	
Width	FRP
36"	7121002
48"	7221002
60"	7321002
72"	7421002
96"	7521002
1000mm	7B21002
1513mm	7C21002
2000mm	7D21002

PRO DEMONSTRATION BENCH - VERTICAL SASH

Exhaust Parameters

Hood Size	Duct Dia.	100 FPM 18" Max Sash Opening		100 FPM 28-1/2" Max Sash Opening		80 FPM 18" Max Sash Opening		80 FPM 28-1/2" Max Sash Opening	
		CFM	SP	CFM	SP	CFM	SP	CFM	SP
36"	10"	350	0.04	543	0.10	280	0.03	434	0.05
48"	10"	508	0.09	789	0.20	407	0.06	630	0.15
60"	12"	667	0.07	1035	0.20	533	0.05	830	0.15
72"	12"	825	0.11	1280	0.25	660	0.07	1025	0.20
96"	2@10"	1142	0.11	1772	0.25	913	0.07	1418	0.20
1000mm	10"	395	0.05	612	0.15	316	0.04	490	0.10
1513mm	12"	660	0.07	1025	0.20	528	0.05	820	0.15
2000mm	12"	914	0.14	1419	0.30	731	0.09	1135	0.20

Note: Only one sash is open in CFM calculations. Special airflow consideration required when installing between two rooms, contact Mott for more information.

Typical Roof Details

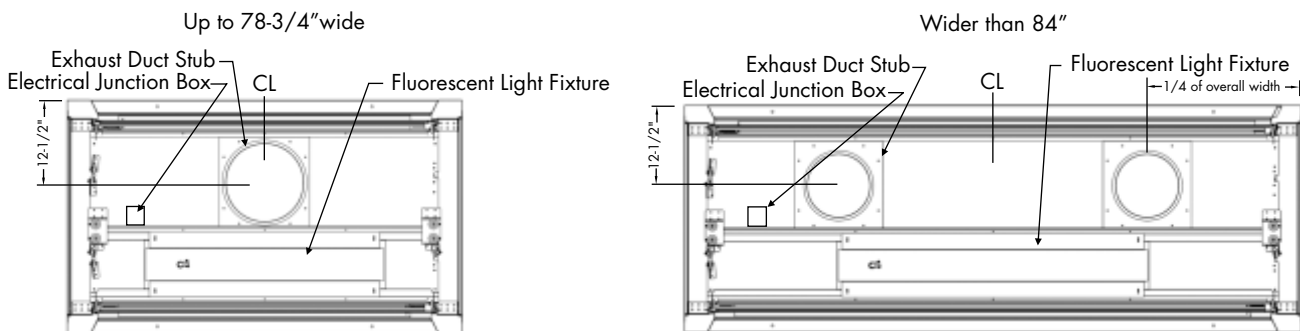

Side Section Details

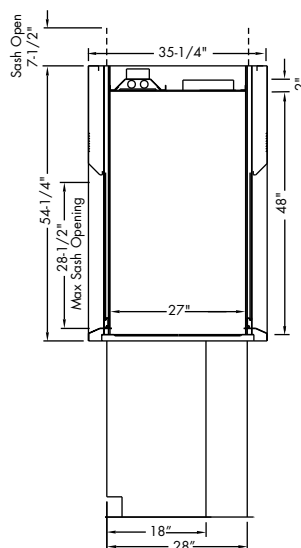

Work Surface Details

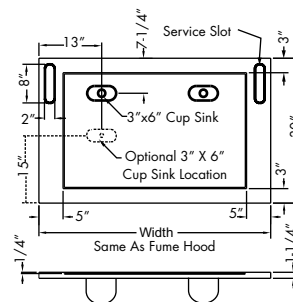

Typical fume hood work top showing optional cup sinks located for 18" deep cabinets.

Optional cup sink location if sink cabinet is located below fume hood.

Cup sink location suits a gooseneck only.

Options

S8 - Sash Interlock - Allows only one sash to be opened at a time.

S9 - Sash Key Lock On Both Doors - Sash stop with key to lock sash in place.

W1 - End Window - One end only. Note services must be work surface mounted.

PRO PERCHLORIC ACID BENCH - VERTICAL SASH

Designed to meet the stringent requirements of perchloric acid applications and suitable for Constant Air Volume (CAV) requirements only and supplied with an automatic compensating upper by-pass. Complete with 30" deep seamlessly welded counter top and trough of the same material as liner. The Pro bench mounted fume hood is supplied with the following standard features:



Counterbalance System - Chain and sprocket system delivers the easiest and most reliable sash operation available with an exceptionally long life span. High quality stainless steel cable system provides economical and reliable operation; tested to 100,000 cycles with no failure.

Stainless Steel Airfoil - Aerodynamic raised design allows air to enter the fume hood even when the sash is closed ensuring efficient fume exhaust. Notches in both corners allow electrical wiring or tubing into the fume hood while still permitting full closure of the sash.

Sash Design - 6mm laminated safety glass is provided with a stainless steel handle and side runners, optional tempered glass or polycarbonate available for special applications. Hoods are supplied with a vertical rising sash. 30" viewing height.

Baffle System - Baffle is removable.

Chemical Resistant Liner - Type 316 stainless steel liner suitable for straight perchloric acid only. For other acids, PVC is available. Contact Mott for chemical resistance details.

Stainless Steel Type 316 Exhaust Collar - Round collar with radiused corners allows for direct connection to exhaust duct to minimize static pressure losses and exhaust noise levels.

Electrical - Two UL/CSA approved duplex receptacles provided for 120 volt service, one on each corner post. UL/CSA approved fluorescent light fixture and switch provided. T5 fluorescent or LED lighting are available options.

Plumbing - Both corner posts are pre-punched to accept a maximum of five plumbing fittings per post. Factory pre-plumbing is available as well as plumbing fixtures from a variety of manufacturers to meet most plumbing needs.

Water Wash Down System - Pre plumbed internal wash down system with rear spray bar, control valve to match plumbing, trough and drain.

Access Panels - Exterior side panels are removable for ease of access to plumbing and electrical service fixtures.

Agency Approvals - UL 1805 Classified, CSA certified to UL 61010 and tested in accordance with ASHRAE 110. Test results available upon request.

Notes: Perchloric acid hood must be connected to a dedicated exhaust system designed specifically for perchloric acid use.

Vertical Raising Sash (Cable Sash System)			Vertical Raising Sash (Chain & Sprocket Sash System)		
Width	316 S/S Rad. Cor	PVC Rad. Cor.	Width	316 S/S Sq. Cor	PVC Rad. Cor
36"	7127000	7129000	36"	7127040	7129040
48"	7227000	7229000	48"	7227040	7229040
60"	7327000	7329000	60"	7327040	7329040
72"	7427000	7429000	72"	7427040	7429040
96"	7527000	7529000	96"	7527040	7529040
1000mm	7B27000	7B29000	1000mm	7B27040	7B29040
1513mm	7C27000	7C29000	1513mm	7C27040	7C29040
2000mm	7D27000	7D29000	2000mm	7D27040	7D29040

PRO PERCHLORIC ACID BENCH - VERTICAL SASH

Exhaust Parameters

Hood Size	Duct Dia.	100 FPM 18" Max Sash Opening		100 FPM 28-1/2" Max*		80 FPM 18" Max Sash Opening		80 FPM 28-1/2" Max*	
		CFM	SP	CFM	SP	CFM	SP	CFM	SP
36"	10"	350	0.04	543	0.10	280	0.03	434	0.05
48"	10"	508	0.09	789	0.20	407	0.06	630	0.15
60"	12"	667	0.07	1035	0.20	533	0.05	830	0.15
72"	12"	825	0.11	1280	0.25	660	0.07	1025	0.20
96"	2@10"	1142	0.11	1772	0.25	913	0.07	1418	0.20
1000mm	10"	395	0.05	612	0.15	316	0.04	490	0.10
1513mm	12"	660	0.07	1025	0.20	528	0.05	820	0.15
2000mm	12"	914	0.14	1419	0.30	731	0.09	1135	0.20

* 28-1/2" max sash opening is recommended for set-up and tear down only.

Typical Roof Details

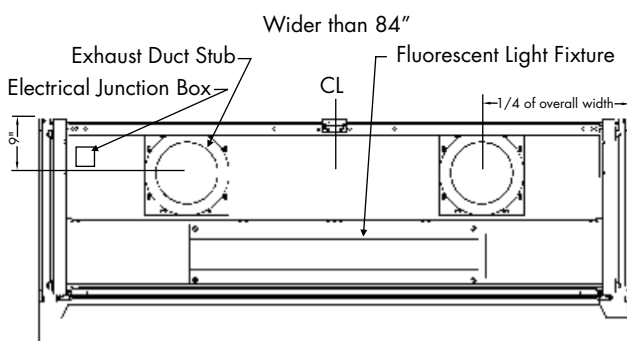
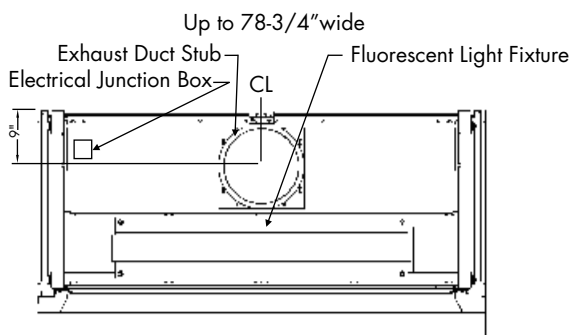

Side Section Details

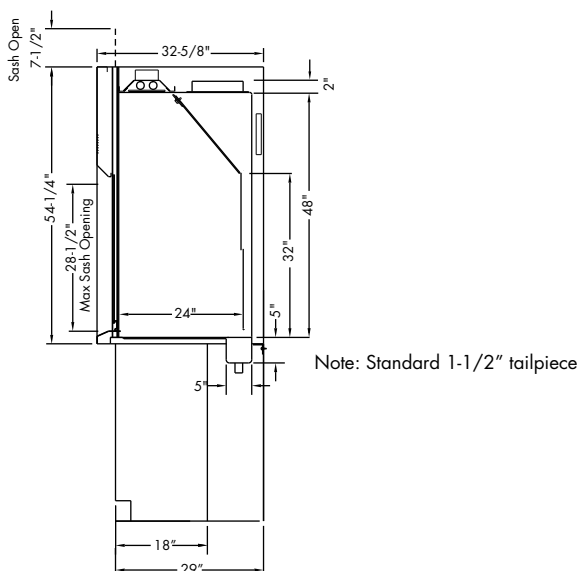

PRO RADIOISOTOPE BENCH - VERTICAL SASH

Designed to meet the stringent requirements of radioisotope applications and meet most laboratory Constant Air Volume (CAV) or Variable Air Volume (VAV) requirements and supplied with an automatic compensating upper by-pass. For VAV, use option S2 for restricted by-pass plate. Complete with 30" deep seamlessly welded stainless steel counter top. The Pro bench mounted fume hood is supplied with the following standard features:



Counterbalance Systems - Chain and sprocket system delivers the easiest and most reliable sash operation available with an exceptionally long life span. High quality stainless steel cable system provides economical and reliable operation; tested to 100,000 cycles with no failure.

Stainless Steel Airfoil - Aerodynamic raised design allows air to enter the fume hood even when the sash is closed ensuring efficient fume exhaust. Notches in both corners allow electrical wiring or tubing into the fume hood while still permitting full closure of the sash.

Sash Design - 6mm laminated safety glass is provided with a stainless steel handle and side runners, optional tempered glass or polycarbonate available for special applications. Hoods are supplied with a vertical rising sash. 30" viewing height.

Chemical Resistant Liner - Type 316 stainless steel liner suitable for radioisotope applications. All weld joints ground smooth and polished.

Stainless Steel Type 316 Exhaust Collar - Round collar with radiused corners allows for direct connection to exhaust duct to minimize static pressure losses and exhaust noise levels.

Electrical - Two UL/CSA approved duplex receptacles provided for 120 volt service, one on each corner post. UL/CSA approved fluorescent light fixture and switch provided. T5 fluorescent or LED lighting are available options.

Plumbing - Both corner posts are pre-punched to accept a maximum of five plumbing fittings per post. Factory pre-plumbing is available as well as plumbing fixtures from a variety of manufacturers to meet most plumbing needs.

Access Panels - Exterior side panels are also removable for ease of access to plumbing and electrical service fixtures.

Agency Approvals - UL 1805 Classified, CSA certified to UL 61010 and tested in accordance with ASHRAE 110. Test results available upon request.

Notes: Integral type 316 stainless steel work surface reinforced with hat channel construction.

Vertical Raising Sash (Cable Sash System)

Width 316 S/S Rad. Cor

36" 7128000

48" 7228000

60" 7328000

72" 7428000

96" 7528000

1000mm 7B28000

1513mm 7C28000

2000mm 7D28000

Vertical Raising Sash (Chain & Sprocket Sash System)

Width 316 S/S Rad. Cor

36" 7128040

48" 7228040

60" 7328040

72" 7428040

96" 7528040

1000mm 7B28040

1513mm 7C28040

2000mm 7D28040

PRO RADIOISOTOPE BENCH - VERTICAL SASH

Exhaust Parameters

Hood Size	Duct Dia.	100 FPM 18" Max Sash Opening		100 FPM 28-1/2" Max* Sash Opening		80 FPM 18" Max Sash Opening		80 FPM 28-1/2" Max* Sash Opening	
		CFM	SP	CFM	SP	CFM	SP	CFM	SP
36"	10"	350	0.04	543	0.10	280	0.03	434	0.05
48"	10"	508	0.09	789	0.20	407	0.06	630	0.15
60"	12"	667	0.07	1035	0.20	533	0.05	830	0.15
72"	12"	825	0.11	1280	0.25	660	0.07	1025	0.20
96"	2@10"	1142	0.11	1772	0.25	913	0.07	1418	0.20
1000mm	10"	395	0.05	612	0.15	316	0.04	490	0.10
1513mm	12"	660	0.07	1025	0.20	528	0.05	820	0.15
2000mm	12"	914	0.14	1419	0.30	731	0.09	1135	0.20

* 28-1/2" max sash opening is recommended for set-up and tear down only.

Typical Roof Details

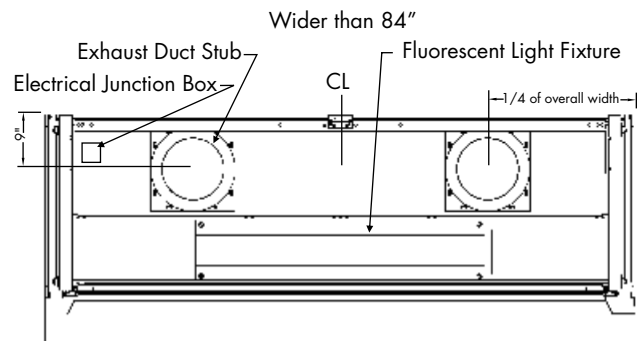
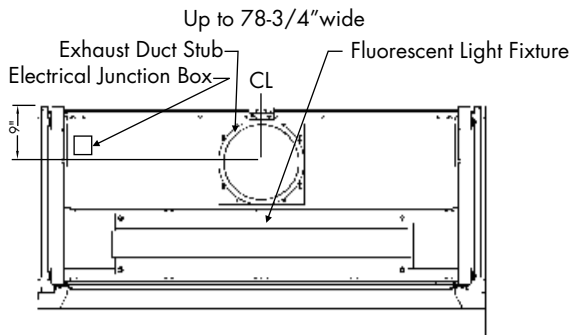

Side Section Details

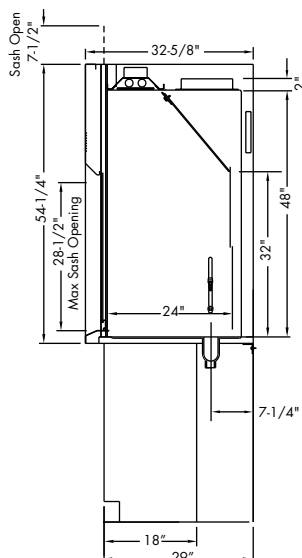

32-5/8" DEEP FULLY ACCESSIBLE - COMBINATION SASH

This fume hood is designed to be accessed from standing and sitting positions. This hood is designed to meet most laboratory Constant Air Volume (CAV) or Variable Air Volume (VAV) requirements and supplied with an automatic compensating upper by-pass. For VAV, use option S2 for restricted by-pass plate. To meet ADA requirements, the hood is designed to mount on a 28-3/4" high unit below the hood. The Pro bench mounted fume hood is supplied with the following standard features:



Counterbalance Systems - Chain and sprocket system delivers the easiest and most reliable sash operation available with an exceptionally long life span. High quality stainless steel cable system provides economical and reliable operation; tested to 100,000 cycles with no failure.

Stainless Steel Airfoil - Aerodynamic design allows air to enter the hood even when the sash is closed ensuring efficient fume exhaust.

Flush Sill Airfoil - Flush with the work surface to provide easy access to the hood interior. Spill trough is designed to provide secondary containment in the event a spill escapes the primary containment work top. Air foil is hinged for easy cleaning and allows for cord or hose pass-through.

Stainless Steel Type 316 Exhaust Collar - Round collar with radiused corners allows for direct connection to exhaust duct to reduce duct transition costs, minimize static pressure losses and exhaust noise levels.

Sash Design - 6mm laminated safety glass is provided with a stainless steel handle and side runners, optional tempered glass or polycarbonate available for special applications. Hoods are supplied with a combination vertical rising and horizontal sliding sashes and a front mounted safety glass shield.

Sash Safety - Sash stops are provided at 18" and 0" to shield the operator while improving fume containment and reducing energy consumption. 37-1/2" viewing height.

Electrical - One combination light switch/electrical receptacle on one post, the other post receives one duplex receptacle, both for 120 volt service and UL/CSA approved. UL/CSA approved fluorescent light fixture provided. T5 fluorescent or LED lighting are available options.

Plumbing - Corner posts are pre-punched to accept plumbing fittings as shown in the image above. Factory pre-plumbing is available as well as plumbing fixtures from a variety of manufacturers to meet most plumbing needs.

Access Panels - Interior gasketed access panels provide convenient access and prevent fume leakage outside the hood chamber. Exterior side panels are also removable for ease of access to plumbing and electrical service fixtures.

Agency Approvals - UL 1805 Classified, CSA certified to UL 61010 and tested in accordance with ASHRAE 110. Test results available upon request.

Combination Sash (Cable Sash System)						Horizontal Glass Panels			
Width	FRP	PVC	Epoxy	316 S/S Sq. Cor	316 S/S Rad. Cor	Panel Width	Width Opening	Height Opening	# of Panels
48"	7241010	7243010	7246010	7244010	7245010	9-3/4"	16"	27"	4
60"	7341010	7343010	7346010	7344010	7345010	12-3/4"	22"	27"	4
72"	7441010	7443010	7446010	7444010	7445010	15-3/4"	28"	27"	4
96"	7541010	7543010	7546010	7544010	7545010	14-13/16"	38-7/8"	27"	6
1513mm	7C41010	7C43010	7C46010	7C44010	7C45010	12-5/8"	21-13/16"	27"	4
2000mm	7D41010	7D43010	7D46010	7D44010	7D45010	11-15/16"	30-1/4"	27"	6

Combination Sash (Chain & Sprocket Sash System)						Horizontal Glass Panels			
Width	FRP	PVC	Epoxy	316 S/S Sq. Cor	316 S/S Rad. Cor	Panel Width	Width Opening	Height Opening	# of Panels
48"	7241050	7243050	7246050	7244050	7245050	9-3/4"	16"	27"	4
60"	7341050	7343050	7346050	7344050	7345050	12-3/4"	22"	27"	4
72"	7441050	7443050	7446050	7444050	7445050	15-3/4"	28"	27"	4
96"	7541050	7543050	7546050	7544050	7545050	14-13/16"	38-7/8"	27"	6
1513mm	7C41050	7C43050	7C46050	7C44050	7C45050	12-5/8"	21-13/16"	27"	4
2000mm	7D41050	7D43050	7D46050	7D44050	7D45050	11-15/16"	30-1/4"	27"	6

32-5/8" DEEP FULLY ACCESSIBLE - COMBINATION SASH

Exhaust Parameters

Hood Size	Duct Dia.	100 FPM 18" Max Sash Opening		100 FPM 28-1/2" Max Sash Opening		80 FPM 18" Max Sash Opening		80 FPM 28-1/2" Max Sash Opening	
		CFM	SP	CFM	SP	CFM	SP	CFM	SP
48"	10"	508	0.09	789	0.20	407	0.06	630	0.15
60"	12"	667	0.07	1035	0.20	533	0.05	830	0.15
72"	12"	825	0.11	1280	0.25	660	0.07	1025	0.20
96"	2@10"	1142	0.11	1772	0.25	913	0.07	1418	0.20
1513mm	12"	660	0.07	1025	0.20	528	0.05	820	0.15
2000mm	12"	914	0.14	1419	0.30	731	0.09	1135	0.20

Typical Roof Details

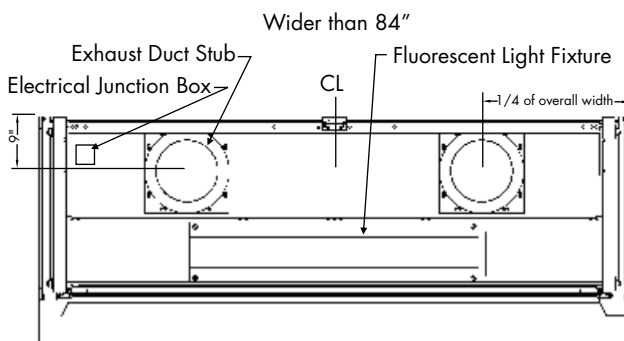
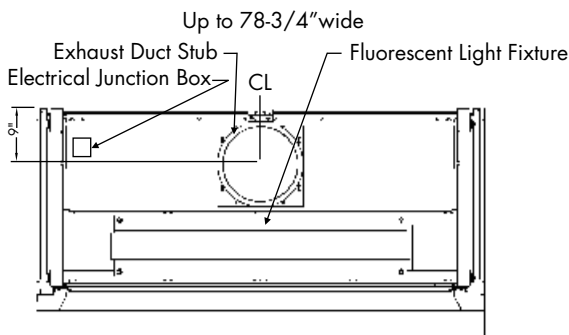

Side Section Details

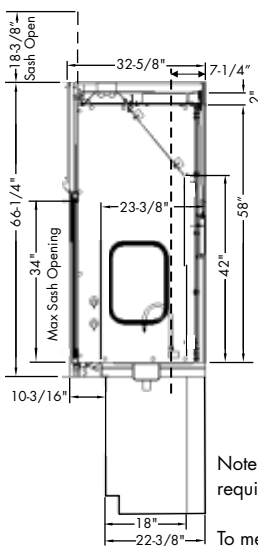

Work Surface Details

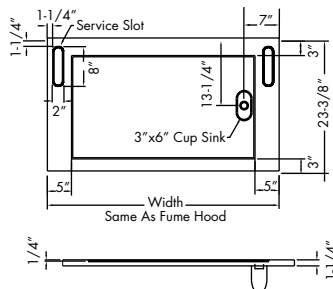

Cup sink location suits a rear mounted gooseneck only.

Note: Included with the hood is a 2" high spacer which is required between counter top and base cabinet.

To meet ADA requirements, unit underneath the hood must be 28-3/4" high and kneespace depth and width requirements must be met. Contact Mott for details.

39-1/4" DEEP HOPEC IV FULLY ACCESSIBLE - COMBINATION SASH

This fume hood is designed to be accessed from standing and sitting positions. This hood is designed to meet most laboratory Constant Air Volume (CAV) or Variable Air Volume (VAV) requirements and supplied with an automatic compensating upper by-pass. For VAV, use option S2 for restricted by-pass plate. To meet ADA requirements, the hood is designed to mount on a 28-3/4" high unit below the hood. The bench mounted fume hood is supplied with the following standard features:



Counterbalance Systems - Chain and sprocket system delivers the easiest and most reliable sash operation available with an exceptionally long life span. High quality stainless steel cable system provides economical and reliable operation; tested to 100,000 cycles with no failure.

Stainless Steel Airfoil - Aerodynamic design allows air to enter the hood even when the sash is closed ensuring efficient fume exhaust.

Flush Sill Airfoil - Flush with the work surface to provide easy access to the hood interior. Spill trough is designed to provide secondary containment in the event a spill escapes the primary containment work top. Air foil is hinged for easy cleaning and allows for cord and hose pass-through.

Stainless Steel Type 316 Exhaust Collar - Round collar with radiused corners allows for direct connection to exhaust duct to reduce duct transition costs, minimize static pressure losses and exhaust noise levels.

Sash Design - 6mm laminated safety glass is provided with a stainless steel handle and side runners, optional tempered glass or polycarbonate available for special applications. Hoods are supplied with a combination vertical rising and horizontal sliding sashes and a front mounted safety glass shield.

Sash Safety - Sash stops are provided at 18" and 0" to shield the operator while improving fume containment and reducing energy consumption. 37-1/2" viewing height.

Electrical - One combination light switch/electrical receptacle on one post, the other post receives one duplex receptacle, both for 120 volt service and UL/CSA approved. UL/CSA approved fluorescent light fixture provided. T5 fluorescent or LED lighting are available options.

Plumbing - Corner posts are pre-punched to accept plumbing fittings as shown in the image above. Factory pre-plumbing is available as well as plumbing fixtures from a variety of manufacturers to meet most plumbing needs.

Access Panels - Interior gasketed access panels provide convenient access and prevent fume leakage outside the hood chamber. Exterior side panels are also removable for ease of access to plumbing and electrical service fixtures.

Agency Approvals - UL 1805 Classified, CSA certified to UL 61010 and tested in accordance with ASHRAE 110. Test results available upon request.

Combination Sash (Cable Sash System)						Horizontal Glass Panels			
Width	FRP	PVC	Epoxy	316 S/S Sq. Cor	316 S/S Rad. Cor	Panel Width	Width Opening	Height Opening	# of Panels
48"	7291010	7293010	7296010	7294010	7295010	9-3/4"	16"	27"	4
60"	7391010	7393010	7396010	7394010	7395010	12-3/4"	22"	27"	4
72"	7491010	7493010	7496010	7494010	7495010	15-3/4"	28"	27"	4
96"	7591010	7593010	7596010	7594010	7595010	14-13/16"	38-7/8"	27"	6
1513mm	7C91010	7C93010	7C96010	7C94010	7C95010	12-5/8"	21-13/16"	27"	4
2000mm	7D91010	7D93010	7D96010	7D94010	7D95010	11-15/16"	30-1/4"	27"	6

Combination Sash (Chain & Sprocket Sash System)						Horizontal Glass Panels			
Width	FRP	PVC	Epoxy	316 S/S Sq. Cor	316 S/S Rad. Cor	Panel Width	Width Opening	Height Opening	# of Panels
48"	7291050	7293050	7296050	7294050	7295050	9-3/4"	16"	27"	4
60"	7391050	7393050	7396050	7394050	7395050	12-3/4"	22"	27"	4
72"	7491050	7493050	7496050	7494050	7495050	15-3/4"	28"	27"	4
96"	7591050	7593050	7596050	7594050	7595050	14-13/16"	38-7/8"	27"	6
1513mm	7C91050	7C93050	7C96050	7C94050	7C95050	12-5/8"	21-13/16"	27"	4
2000mm	7D91050	7D93050	7D96050	7D94050	7D95050	11-15/16"	30-1/4"	27"	6

39-1/4" DEEP HOPEC IV FULLY ACCESSIBLE - COMBINATION SASH

Exhaust Parameters

Hood Size	Duct Dia.	100 FPM 18" Max Sash Opening		100 FPM 28-1/2" Max Sash Opening		80 FPM 18" Max Sash Opening		80 FPM 28-1/2" Max Sash Opening	
		CFM	SP	CFM	SP	CFM	SP	CFM	SP
48"	10"	508	0.09	789	0.20	407	0.06	630	0.15
60"	12"	667	0.07	1035	0.20	533	0.05	830	0.15
72"	12"	825	0.11	1280	0.25	660	0.07	1025	0.20
96"	2@10"	1142	0.11	1772	0.25	913	0.07	1418	0.20
1513mm	12"	660	0.07	1025	0.20	528	0.05	820	0.15
2000mm	12"	914	0.14	1419	0.30	731	0.09	1135	0.20

Typical Roof Details

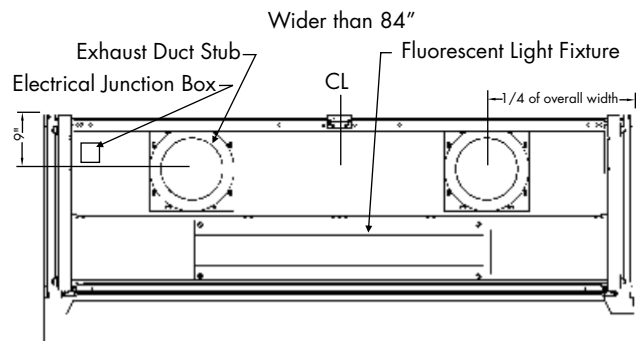
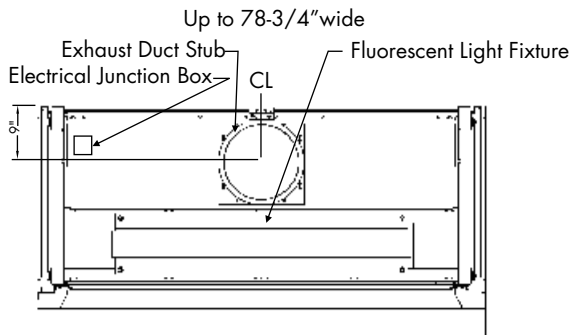

Side Section Details

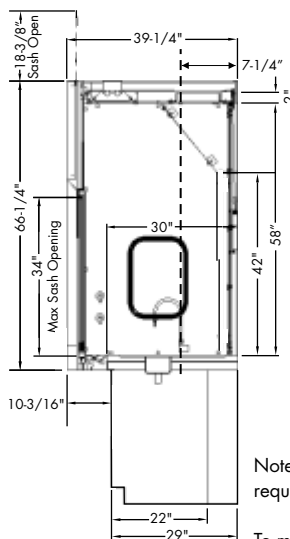

Work Surface Details

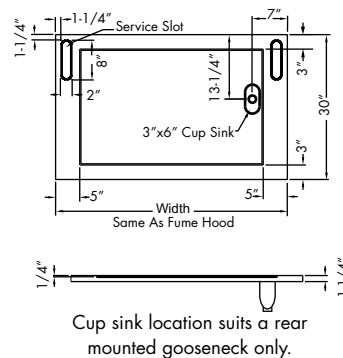

Note: Included with the hood is a 2" high spacer which is required between counter top and base cabinet.

To meet ADA requirements, unit underneath the hood must be 28-3/4" high and kneespace depth and width requirements must be met. Contact Mott for details.

PRO FLOOR MOUNTED - DUAL VERTICAL SASH

This general purpose fume hood is designed to meet most laboratory Constant Air Volume (CAV) and Variable Air Volume (VAV) requirements and supplied with a restricted upper by-pass. Designed to sit directly on the laboratory floor. The Pro floor mounted fume hood is supplied with the following standard features:



Chain Drive Sash - Chain and sprocket mechanism that delivers the easiest and most reliable sash operation available with an exceptionally long life span.

Sash Design - 6mm laminated safety glass is provided with a stainless steel handle and side runners, optional tempered glass or polycarbonate available for special applications. Hoods are supplied with dual vertical rising sashes. Floor mounted fume hoods are designed to operate with only one sash open. Sash closes within 1" off the floor.

Stainless Steel Type 316 Exhaust Collar - Round collar with radiused corners allows for direct connection to exhaust duct to reduce duct transition costs, minimize static pressure losses and exhaust noise levels.

Electrical - Two UL/CSA approved duplex receptacles provided for 120 volt service, one on each corner post. UL/CSA approved fluorescent light fixture and switch provided. T5 fluorescent or LED lighting are available options.

Plumbing - Both corner posts are pre-punched to accept a maximum of five plumbing fittings per post. Factory pre-plumbing is available as well as plumbing fixtures from a variety of manufacturers to meet most plumbing needs.

Access Panels - Interior gasketed access panels provide convenient access and prevent fume leakage outside the hood chamber. Exterior side panels are also removable for ease of access to plumbing and electrical service fixtures.

Agency Approvals - UL 1805 Classified, CSA certified to UL 61010 and tested in accordance with ASHRAE 110-2016. Test results available upon request.

Vertical Raising Sash (Chain & Sprocket Sash System)					
Width	FRP	PVC	Epoxy	316 S/S Sq. Cor	316 S/S Rad. Cor
36"	7121041	7123041	7126041	7124041	7125041
48"	7221041	7223041	7226041	7224041	7225041
60"	7321041	7323041	7326041	7324041	7325041
72"	7421041	7423041	7426041	7424041	7425041
96"	7521041	7523041	7526041	7524041	7525041
1000mm	7B21041	7B23041	7B26041	7B24041	7B25041
1513mm	7C21041	7C23041	7C26041	7C24041	7C25041
2000mm	7D21041	7D23041	7D26041	7D24041	7D25041

PRO FLOOR MOUNTED - DUAL VERTICAL SASH

Exhaust Parameters

Hood Size	Duct Dia.	100 FPM 18" Max, Upper Sash Opening		100 FPM 28-1/2" Max Sash Opening		80 FPM 18" Max, Upper Sash Opening		80 FPM 28-1/2" Max Sash Opening	
		CFM	SP	CFM	SP	CFM	SP	CFM	SP
36"	10"	350	0.04	543	0.10	280	0.03	434	0.05
48"	10"	508	0.09	789	0.20	407	0.06	630	0.15
60"	12"	667	0.07	1035	0.20	533	0.05	830	0.15
72"	12"	825	0.11	1280	0.25	660	0.07	1025	0.20
96"	2@10"	1142	0.11	1772	0.25	913	0.07	1418	0.20
1000mm	10"	395	0.05	612	0.15	316	0.04	490	0.10
1513mm	12"	660	0.07	1025	0.20	528	0.05	820	0.15
2000mm	12"	914	0.14	1419	0.30	731	0.09	1135	0.20

Typical Roof Details

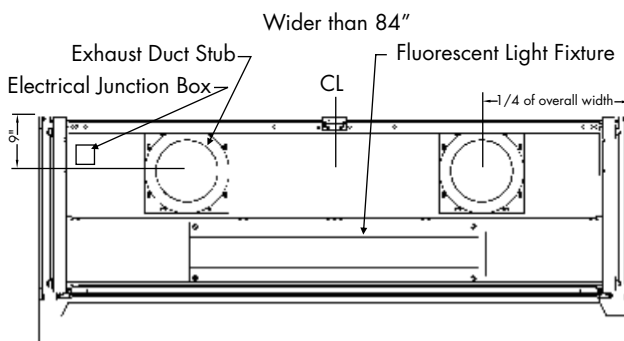
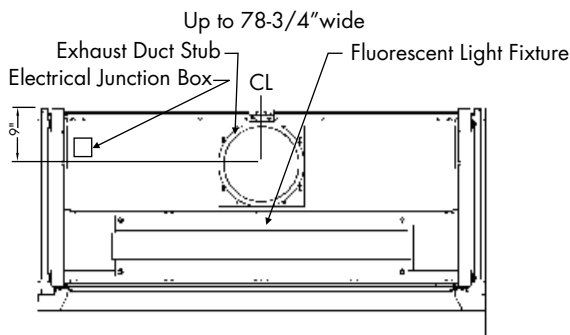

Side Section Details

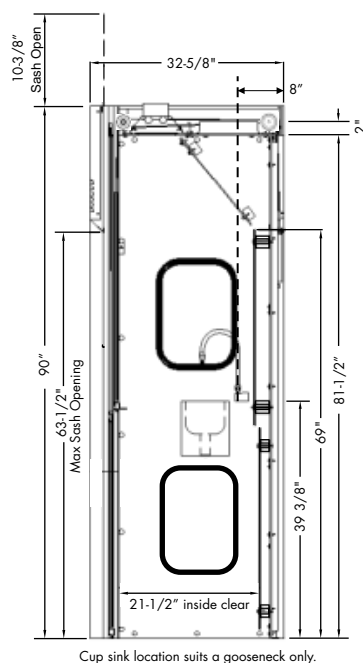

PRO FLOOR MOUNTED - DUAL VERTICAL SASH WITH UPPER COMBINATION SASH

This general purpose fume hood is designed to meet most laboratory Constant Air Volume (CAV) and Variable Air Volume (VAV) requirements and supplied with a restricted upper by-pass. Designed to sit directly on the laboratory floor. The Pro floor mounted fume hood is supplied with the following standard features:



Chain Drive Sash - Chain and sprocket mechanism that delivers the easiest and most reliable sash operation available with an exceptionally long life span.

Sash Design - 6mm laminated safety glass is provided with a stainless steel handle and side runners, optional tempered glass or polycarbonate available for special applications. Hoods are supplied with dual vertical rising sashes with upper combination sash. Floor mounted fume hoods are designed to operate with only one sash open. Sash closes within 1" off the floor.

Stainless Steel Type 316 Exhaust Collar - Round collar with radiused corners allows for direct connection to exhaust duct to reduce duct transition costs, minimize static pressure losses and exhaust noise levels.

Electrical - Two UL/CSA approved duplex receptacles provided for 120 volt service, one on each corner post. UL/CSA approved fluorescent light fixture and switch provided. T5 fluorescent or LED lighting are available options.

Plumbing - Both corner posts are pre-punched to accept a maximum of five plumbing fittings per post. Factory pre-plumbing is available as well as plumbing fixtures from a variety of manufacturers to meet most plumbing needs.

Access Panels - Interior gasketed access panels provide convenient access and prevent fume leakage outside the hood chamber. Exterior side panels are also removable for ease of access to plumbing and electrical service fixtures.

Agency Approvals - UL 1805 Classified, CSA certified to UL 61010 and tested in accordance with ASHRAE 110. Test results available upon request.

Vertical Sash With Upper Combination Sash (Chain & Sprocket Sash System)						Horizontal Glass Panels			
Width	FRP	PVC	Epoxy	316 S/S Sq. Cor	316 S/S Rad. Cor	Panel Width	Width Opening	Height Opening	# of Panels
48"	7221051	7223051	7226051	7224051	7225051	9-3/4"	16"	32-3/4"	4
60"	7321051	7323051	7326051	7324051	7325051	12-3/4"	22"	32-3/4"	4
72"	7421051	7423051	7426051	7424051	7425051	15-3/4"	28"	32-3/4"	4
96"	7521051	7523051	7526051	7524051	7525051	14-13/16"	38-7/8"	32-3/4"	6
1513mm	7C21051	7C23051	7C26051	7C24051	7C25051	12-5/8"	21-13/16"	32-3/4"	4
2000mm	7D21051	7D23051	7D26051	7D24051	7D25051	11-15/16"	30-1/4"	32-3/4"	6

PRO FLOOR MOUNTED - DUAL VERTICAL SASH WITH UPPER COMBINATION SASH

Exhaust Parameters

Hood Size	Duct Dia.	100 FPM 18" Max Sash Opening		100 FPM Upper Door Only ½ Open		80 FPM 18" Max Sash Opening		80 FPM Upper Door Only ½ Open	
		CFM	SP	CFM	SP	CFM	SP	CFM	SP
48"	10"	508	0.09	394	0.05	407	0.06	315	0.05
60"	12"	667	0.07	517	0.05	533	0.05	414	0.05
72"	12"	825	0.11	640	0.10	660	0.07	512	0.05
96"	2@10"	1142	0.11	886	0.10	913	0.07	709	0.05
1513mm	12"	660	0.07	513	0.10	528	0.05	410	0.05
2000mm	12"	914	0.14	709	0.10	731	0.09	567	0.05

Note: Exhaust parameters are based on lower sash door closed during active use.

Typical Roof Details

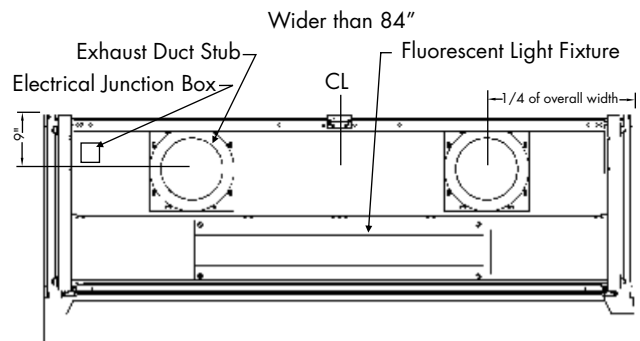
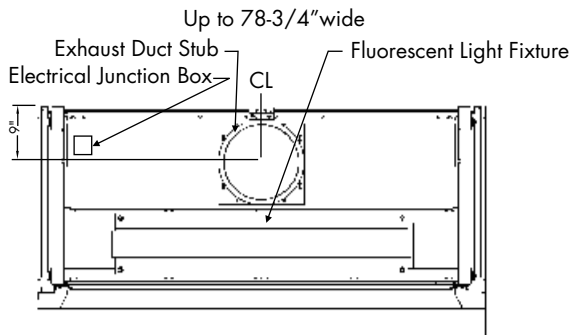

Side Section Details

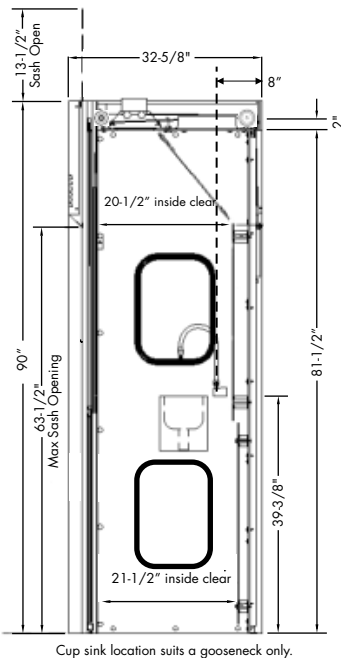

PRO FLOOR MOUNTED - HORIZONTAL SLIDING SASH

This general purpose fume hood is designed to meet most laboratory Constant Air Volume (CAV) and Variable Air Volume (VAV) requirements and supplied with a restricted upper by-pass. Designed to sit directly on the laboratory floor. The Pro floor mounted fume hood is supplied with the following standard features:



Sash Design - 6mm laminated safety glass is provided with a stainless steel handle and side runners, optional tempered glass or polycarbonate available for special applications. Hoods are supplied with horizontal sliding sashes. Floor mounted fume hoods are designed to operate with only one sash open.

Stainless Steel Type 316 Exhaust Collar - Round collar with radiused corners allows for direct connection to exhaust duct to reduce duct transition costs, minimize static pressure losses and exhaust noise levels.

Electrical - Two UL/CSA approved duplex receptacles provided for 120 volt service, one on each corner post. UL/CSA approved fluorescent light fixture and switch provided. T5 fluorescent or LED lighting are available options.

Plumbing - Both corner posts are pre-punched to accept a maximum of five plumbing fittings per post. Factory pre-plumbing is available as well as plumbing fixtures from a variety of manufacturers to meet most plumbing needs.

Access Panels - Interior gasketed access panels provide convenient access and prevent fume leakage outside the hood chamber. Exterior side panels are also removable for ease of access to plumbing and electrical service fixtures.

Agency Approvals - UL 1805 Classified, CSA certified to UL 61010 and tested in accordance with ASHRAE 110. Test results available upon request.

Stainless Steel Horizontal Sliding Sash						Horizontal Glass Panels			
Width	FRP	PVC	Epoxy	316 S/S Sq. Cor	316 S/S Rad. Cor	Panel Width	Width Opening	Height Opening	# of Panels
48"	7221021	7223021	7226021	7224021	7225021	9-3/4"	18-3/4"	68-1/8"	4
60"	7321021	7323021	7326021	7324021	7325021	12-3/4"	23-11/16"	68-1/8"	4
72"	7421021	7423021	7426021	7424021	7425021	15-3/4"	29-11/16"	68-1/8"	4
96"	7521021	7523021	7526021	7524021	7525021	14-13/16"	41-11/16"	68-1/8"	6
120"	7621021	7623021	7626021	7624021	7625021	19-1/4"	52-5/8"	68-1/8"	6
144"	7H21021	7H23021	7H26021	7H24021	7H25021	23-1/4"	64-5/8"	68-1/8"	6
1513mm	7C21021	7C23021	7C26021	7C24021	7C25021	12-5/8"	23-1/2"	68-1/8"	4
2000mm	7D21021	7D23021	7D26021	7D24021	7D25021	11-15/16"	33-1/16"	68-1/8"	6

PRO FLOOR MOUNTED - HORIZONTAL SLIDING SASH

Exhaust Parameters

Hood Size	Duct Dia.	100 FPM ½ Sliding Doors Open		80 FPM ½ Sliding Doors Open	
		CFM	SP	CFM	SP
48"	10"	849	0.25	680	0.20
60"	12"	1113	0.20	890	0.15
72"	12"	1378	0.35	1102	0.20
96"	2@10"	1907	0.35	1525	0.20
120"	2@10"	2436	0.25	1950	0.15
144"	2@10"	2965	0.35	2373	0.25
1513mm	12"	1104	0.20	884	0.15
2000mm	12"	1527	0.40	1221	0.25

Typical Roof Details

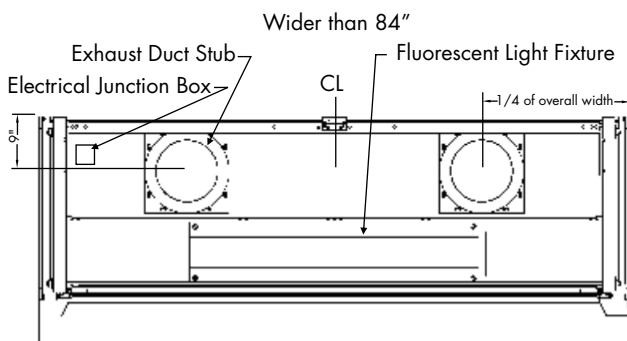
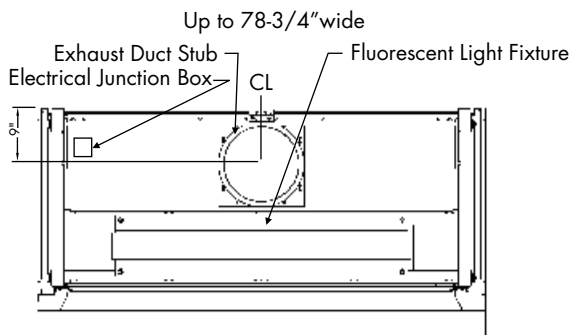

Side Section Details

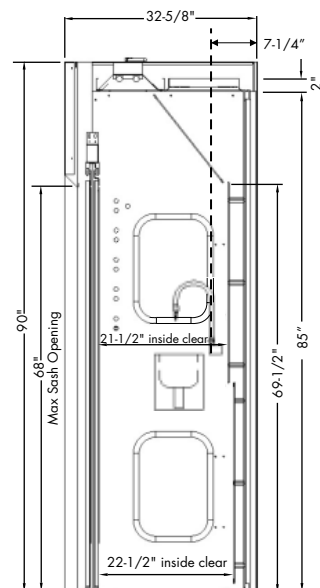

Cup sink location suits a gooseneck only.

PRO DISTILLATION FUME HOOD - DUAL VERTICAL SASH

This general purpose fume hood is designed to meet most laboratory Variable Air Volume (VAV) requirements and supplied with a restricted upper by-pass. Designed to mount on a 30" deep counter top. The Pro bench mounted fume hood is supplied with the following standard features:



Chain Drive Sash - Chain and sprocket mechanism that delivers the easiest and most reliable sash operation available with an exceptionally long life span.

Stainless Steel Airfoil - Aerodynamic raised design allows air to enter the fume hood even when the sash is closed ensuring efficient fume exhaust. Notches in both corners allow electrical wiring or tubing into the fume hood while still permitting full closure of the sash.

Sash Design - 6mm laminated safety glass is provided with a stainless steel handle and side runners, optional tempered glass or polycarbonate available for special applications. Hoods are supplied with dual vertical rising sashes. 58-1/2" viewing height.

Stainless Steel Type 316 Exhaust Collar - Round collar with radiused corners allows for direct connection to exhaust duct to reduce duct transition costs, minimize static pressure losses and exhaust noise levels.

Electrical - Two UL/CSA approved duplex receptacles provided for 120 volt service, one on each corner post. UL/CSA approved fluorescent light fixture and switch provided. T5 fluorescent or LED lighting are available options.

Plumbing - Both corner posts are pre-punched to accept a maximum of five plumbing fittings per post. Factory pre-plumbing is available as well as plumbing fixtures from a variety of manufacturers to meet most plumbing needs.

Access Panels - Interior gasketed access panels provide convenient access and prevent fume leakage outside the hood chamber. Exterior side panels are also removable for ease of access to plumbing and electrical service fixtures.

Agency Approvals - UL 1805 Classified, CSA certified to UL 61010 and tested in accordance with ASHRAE 110. Test results available upon request.

Vertical Raising Sash (Chain & Sprocket Sash System)					
Width	FRP	PVC	Epoxy	316 S/S Sq. Cor	316 S/S Rad. Cor
36"	7121044	7123044	7126044	7124044	7125044
48"	7221044	7223044	7226044	7224044	7225044
60"	7321044	7323044	7326044	7324044	7325044
72"	7421044	7423044	7426044	7424044	7425044
96"	7521044	7523044	7526044	7524044	7525044
1000mm	7B21044	7B23044	7B26044	7B24044	7B25044
1513mm	7C21044	7C23044	7C26044	7C24044	7C25044
2000mm	7D21044	7D23044	7D26044	7D24044	7D25044

PRO DISTILLATION FUME HOOD - DUAL VERTICAL SASH

Exhaust Parameters

Hood Size	Duct Dia.	100 FPM 18" Max, Upper Sash Opening		100 FPM 28-1/2" Max* Sash Opening		80 FPM 18" Max, Upper Sash Opening		80 FPM 28-1/2" Max* Sash Opening	
		CFM	SP	CFM	SP	CFM	SP	CFM	SP
36"	10"	350	0.04	543	0.10	280	0.03	434	0.05
48"	10"	508	0.09	789	0.20	407	0.06	630	0.15
60"	12"	667	0.07	1035	0.20	533	0.05	830	0.15
72"	12"	825	0.11	1280	0.25	660	0.07	1025	0.20
96"	2@10"	1142	0.11	1772	0.25	913	0.07	1418	0.20
1000mm	10"	395	0.05	612	0.15	316	0.04	490	0.10
1513mm	12"	660	0.07	1025	0.20	528	0.05	820	0.15
2000mm	12"	914	0.14	1419	0.30	731	0.09	1135	0.20

* 28-1/2" max sash opening is recommended for set-up and tear down only.

Typical Roof Details

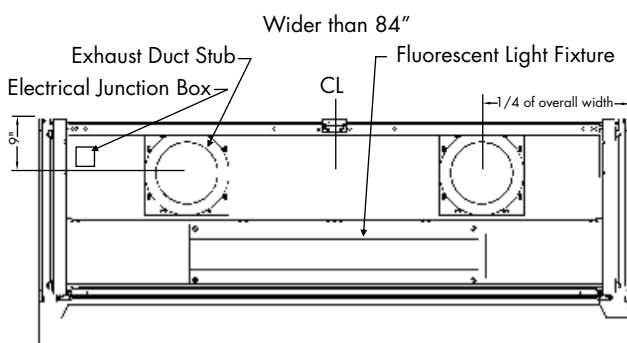
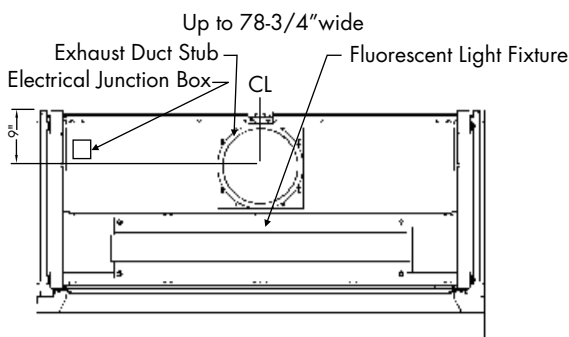

Side Section Details

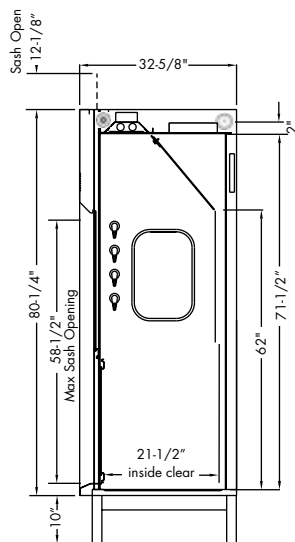

Distillation Table



Distillation Table

Width	Item Number
36"	DTF1036
48"	DTF1048
60"	DTF1060
72"	DTF1072
96"	DTF1096
1000mm	DTF100B
1513mm	DTF100C
2000mm	DTF100D

- Fully welded tables are 9-3/4" high x 29" deep with 2" square tube legs and supplied with leveling glides.
- Tables larger than 48" wide are supplied with six legs (note: 48" wide unit shown).
- Tables will support an 1800lb load.
- Comes with PVC boots and levelers.

SELECT VENTILATED WORK STATION - VERTICAL SASH

EXHAUST DEVICE

This cost effective ventilation work station is designed to meet the requirements of some school laboratory applications. Designed to mount on a 30" deep counter top. This hood is designed to meet most laboratory Constant Air Volume (CAV) or Variable Air Volume (VAV) requirements. For VAV, use option S2 for restricted by-pass plate. The Select bench mounted work station is supplied with the following standard features:



- Construction** - 2" wide thin wall construction.
- Counterbalance System** - High quality stainless steel cable system provides economical and reliable operation; tested to 100,000 cycles with no failure.
- Sash Design** - 6mm laminated safety glass is provided with a stainless steel handle and side runners. Hoods are provided with a vertical rising sash. Note, sash closes 1" of the counter top.
- Stainless Steel Type 316 Exhaust Collar** - Round collar with radiused corners allows for direct connection to exhaust duct to reduce duct transition costs, minimize static pressure losses and exhaust noise levels.
- Electrical** - UL/CSA approved fluorescent light fixture and switch provided.
- Access Panels** - Exterior side panels are removable.
- Note:** Unit is not UL or CSA approved.

Vertical Raising Sash	
Width	Part Number
36"	VWS0036
48"	VWS0048
60"	VWS0060
72"	VWS0072
96"	VWS0096
1000mm	VWS000B
1513mm	VWS000C

Side Section Details

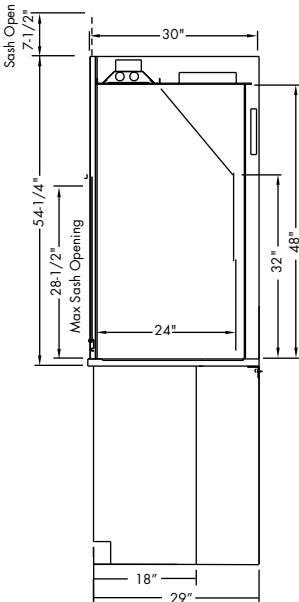

Exhaust Parameters

Hood Size	Duct Dia.	100 FPM 18" Max Sash Opening		100 FPM 28-1/2" Max* Sash Opening		80 FPM 18" Max Sash Opening		80 FPM 28-1/2" Max* Sash Opening	
		CFM	SP	CFM	SP	CFM	SP	CFM	SP
36"	10"	400	0.05	633	0.14	320	0.04	507	0.09
48"	10"	550	0.10	871	0.25	440	0.06	697	0.17
60"	12"	700	0.08	1109	0.20	560	0.05	887	0.13
72"	12"	850	0.12	1346	0.30	680	0.08	1077	0.19
96"	2@10"	1150	0.12	1821	0.28	920	0.07	1457	0.18
1000mm	10"	442	0.07	700	0.17	354	0.05	560	0.10
1513mm	12"	693	0.08	1099	0.20	555	0.05	879	0.13

* 28-1/2" max sash opening is recommended for set-up and tear down only.

Typical Roof Details

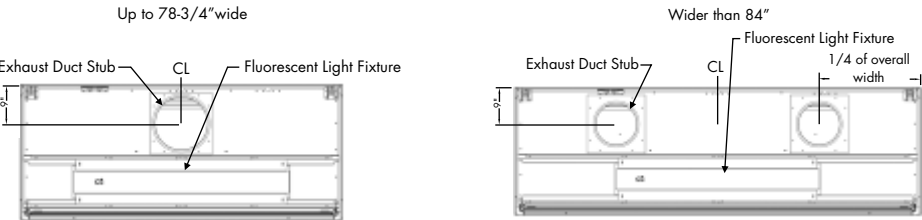

Work Surface Details

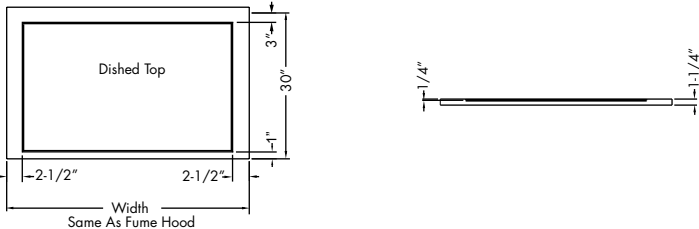

SPRAY BOOTH

EXHAUST DEVICE

This spray booth is designed for simple nontoxic exhaust operations. Designed to mount on a 24" deep counter top, the hood is designed to be used with a Constant Air Volume exhaust system and does not include a fan. The spray booth bench mounted unit is supplied with the following standard features:



Construction - Steel, thin wall construction with laboratory grade powder coating. Supplied with integrated steel bottom for easier cleaning. Air filter provided.

Steel Exhaust Collar - Round collar allows for direct connection to exhaust duct.

Electrical - UL/CSA approved fluorescent light fixture (24" wide unit supplied with incandescent light). To be field wired to remote switch.

Note: Unit is not UL or CSA approved.

Spray Booth

Width Part Number

24"	8101000
30"	8201000
36"	8301000
48"	8401000
60"	8501000

Exhaust Parameters

Hood Size	Duct Dia.	100 FPM 33" Max Opening	
		CFM	SP
24"	10"	505	0.05
30"	10"	642	0.80
36"	10"	780	0.80
48"	10"	1055	1.00
60"	10"	1330	1.00

Side Section Details

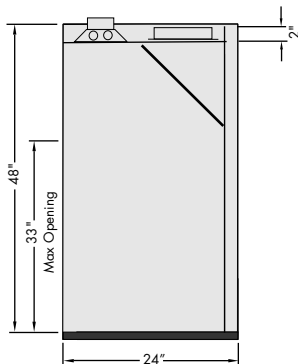

Typical Roof Details

