

## SAFEGUARD™ BENCH - VERTICAL SASH

The SafeGuard™ fume hood was developed to meet the challenging safety, energy conservation, and operational requirements of today's laboratory. Designed for 80-100 feet per minute face velocities, this hood is suitable for use in either Constant Air Volume (CAV) or Variable Air Volume (VAV) requirements with optional restricted by-pass panel. The SafeGuard™ bench mounted fume hood is supplied with the following standard features:



**Downflow Upper By-Pass** - In CAV configurations, air flows through the downwardly directed by-pass preventing contaminated air build up behind the closed sash.

**Chain Drive Sash** - Chain and sprocket mechanism that delivers the easiest and most reliable sash operation available with an exceptionally long life span.

**Exhaust System** - Optional restricted upper by-pass is required for VAV use.

**Fixed Baffle Area** - The baffle system needs no adjustment and improves airflow through the fume hood.

**Full Viewing Sash** - Provides a clear and unobstructed side to side view of fume hood interior, with a 34" high viewing area.

**Self-Lowering Sash System** - Sash latch temporarily secures the sash in the full open position for setup and tear down operations. When the sash is freed, it automatically returns to the 18" open operational position offering extra protection to the operator and helps reduce energy consumption. Below 18", sash is equally balanced.

**Flush Airfoil** - Low-profile, hinged, type 316 powder coated

stainless steel airfoil is flush with the work surface to provide ergonomic and unobstructed access to the interior. Power cords can be run through the sill to the electrical outlets on the hood posts.

**Spill Trough** - Designed to provide secondary containment in the event a spill escapes the primary containment work top.

**Electrical** - Two UL/CSA approved duplex receptacles provided for 120 volt service. UL/CSA approved LED light module and switch provided.

**Plumbing** - Front post is pre-punched to accept four fixtures per side. Factory pre-plumbing is available as well as plumbing fixtures from a variety of manufacturers to meet most plumbing needs.

**Access Panels** - Front and side panels are easily removed to access interior electrical or plumbing fixtures. Interior gasketed access panels provide convenient access and prevent fume leakage outside the hood chamber.

**Stainless Steel Exhaust Collar** - Wide round exhaust duct connection improves airflow distribution across the hood width.

**Approvals & ASHRAE** - UL 1805 Classified, CSA certified to UL 61010 and tested in accordance with ASHRAE 110. Test results available upon request.

### 32-5/8" Vertical Raising Sash (Chain & Sprocket Sash System)

Width	FRP	PVC	Epoxy	316 S/S Square Corners	316 S/S Radius Corners
48"	7271040	7273040	7276040	7274040	7275040
60"	7371040	7373040	7376040	7374040	7375040
72"	7471040	7473040	7476040	7474040	7475040
96"	7571040	7573040	7476040	7574040	7575040

### 38-5/8" Vertical Raising Sash (Chain & Sprocket Sash System)

Width	FRP	PVC	Epoxy	316 S/S Square Corners	316 S/S Radius Corners
48"	7271040-ED	7273040-ED	7276040-ED	7274040-ED	7275040-ED
60"	7371040-ED	7373040-ED	7376040-ED	7374040-ED	7375040-ED
72"	7471040-ED	7473040-ED	7476040-ED	7474040-ED	7475040-ED
96"	7571040-ED	7573040-ED	7476040-ED	7574040-ED	7575040-ED

## SAFEGUARD™ BENCH - VERTICAL SASH

### Exhaust Parameters

Hood Size	Duct Diameter	100 FPM 18" Max Sash Opening		80 FPM 18" Max Sash Opening	
		CFM	SP	CFM	SP
48"	10"	481	0.08	385	0.05
60"	12"	631	0.07	505	0.04
72"	12"	781	0.10	625	0.06
96"	2 @ 10"	1082	0.10	865	0.06

### Typical Roof Details

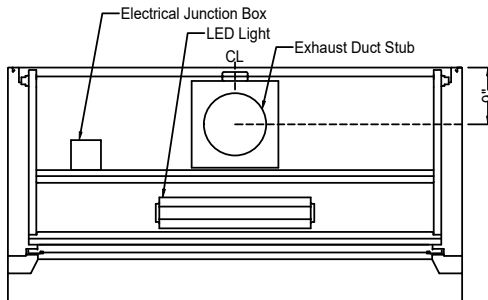

Single Collar Rough-In

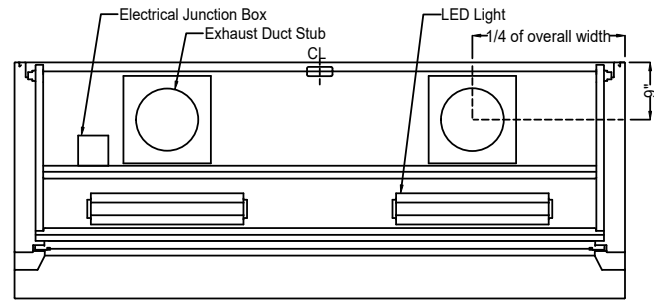

Dual Collar Rough-In

### Side Section Details

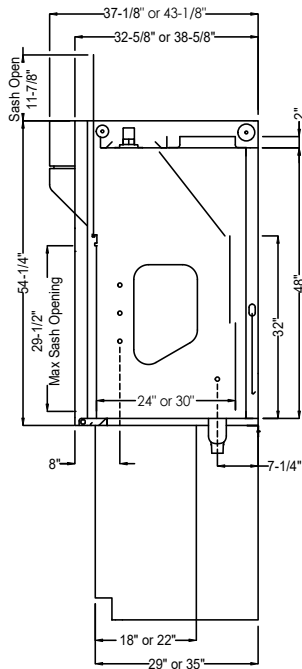

**SAFEGUARD™ BENCH - COMBINATION SASH**

The SafeGuard™ fume hood was developed to meet the challenging safety, energy conservation, and operational requirements of today's laboratory. Designed for 80-100 feet per minute face velocities, This hood is designed to meet most laboratory Constant Air Volume (CAV) or Variable Air Volume (VAV) requirements and includes restricted by-pass panel. The SafeGuard™ bench mounted fume hood is supplied with the following standard features:



**Restricted Upper By-Pass** - Combination sash fume hoods have a restricted by-pass as standard. Limited by-pass air flows through the downwardly directed by-pass preventing contaminated air build up behind the closed sash.

**Exhaust System** - Restricted upper by-pass allows use with both VAV and CAV exhaust systems.

**Chain Drive Sash** - Chain and sprocket mechanism that delivers the easiest and most reliable sash operation available with an exceptionally long life span.

**Combination Sash** - Top hung frameless combination sash operates smoothly while offering increased visibility with its reduced frame profile.

**Full Viewing Area** - Provides a clear and unobstructed side to side view of fume hood interior, with a 34" high viewing area. Rear mounted visor included.

**Self-Lowering Sash System** - Sash latch temporarily secures the sash in the full open position for setup and tear down operations. When the sash is freed, it automatically returns to the 18" open operational position which offers extra

protection to the operator and helps reduce energy consumption. Below 18" the sash is equally balanced.

**Fixed Baffle System** - The baffle system needs no adjustment and improves airflow through the fume hood.

**Flush Airfoil** - Low-profile, hinged, type 316 powder coated stainless steel airfoil is flush with the work surface to provide ergonomic and unobstructed access to the interior. Power cords can be run through the sill to the electrical outlets on the hood posts.

**Spill Trough** - Designed to provide secondary containment in the event a spill escapes the primary containment work top.

**Electrical** - Two UL/CSA approved duplex receptacles provided for 120 volt service. UL/CSA approved LED light module and switch provided.

**Plumbing** - Front post is pre-punched to accept four fixtures per side. Factory pre-plumbing is available as well as plumbing fixtures from a variety of manufacturers to meet most plumbing needs.

**Access Panels** - Front and side panels are easily removed to access interior electrical or plumbing fixtures. Interior gasketed access panels provide convenient access and prevent fume leakage outside the hood chamber.

**Stainless Steel Exhaust Collar** - Wide round exhaust duct connection improves airflow distribution across the hood width.

**Approvals & ASHRAE** - UL 1805 Classified, CSA certified to UL 61010 and tested in accordance with ASHRAE 110. Test results available upon request.

32-5/8" Deep Combination Sash (Chain & Sprocket Sash System)						Horizontal Glass Panels			
Width	FRP	PVC	Epoxy	316 S/S Square Corners	316 S/S Radius Corners	Panel Width	Width Opening	Height Opening	Number of Panels
48"	7271050	7273050	7276050	7274050	7275050	9-3/4"	16"	29"	4
60"	7371050	7373050	7376050	7374050	7375050	12-3/4"	22"	29"	4
72"	7471050	7473050	7476050	7474050	7475050	15-3/4"	28"	29"	4
96"	7571050	7573050	7576050	7574050	7575050	14-13/16"	38-7/8"	29"	6

38-5/8" Deep Combination Sash (Chain & Sprocket Sash System)						Horizontal Glass Panels			
Width	FRP	PVC	Epoxy	316 S/S Square Corners	316 S/S Radius Corners	Panel Width	Width Opening	Height Opening	Number of Panels
48"	7271050-ED	7273050-ED	7276050-ED	7274050-ED	7275050-ED	9-3/4"	16"	29"	4
60"	7371050-ED	7373050-ED	7376050-ED	7374050-ED	7375050-ED	12-3/4"	22"	29"	4
72"	7471050-ED	7473050-ED	7476050-ED	7474050-ED	7475050-ED	15-3/4"	28"	29"	4
96"	7571050-ED	7573050-ED	7576050-ED	7574050-ED	7575050-ED	14-13/16"	38-7/8"	29"	6

## SAFEGUARD™ BENCH - COMBINATION SASH

### Exhaust Parameters

Hood Size	Duct Diameter	100 FPM 18" Max Sash Opening		100 FPM Combo Sash Horizontal Only		80 FPM 18" Max Sash Opening		80 FPM Combo Sash Horizontal Only	
		CFM	SP	CFM	SP	CFM	SP	CFM	SP
48"	10"	481	0.08	376	0.05	385	0.05	305	0.03
60"	12"	631	0.07	495	0.04	505	0.04	400	0.03
72"	12"	781	0.10	613	0.06	625	0.06	495	0.04
96"	2 @ 10"	1082	0.10	856	0.06	865	0.06	685	0.04

\* 28-1/2" max sash opening is recommended for set-up and tear down only.

### Typical Roof Details

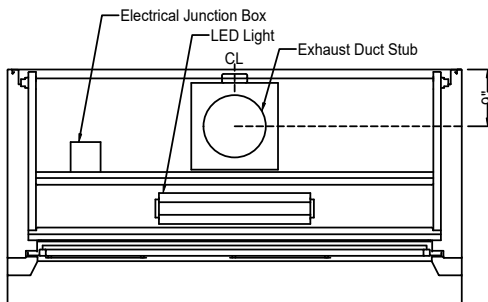

Single Collar Rough-In

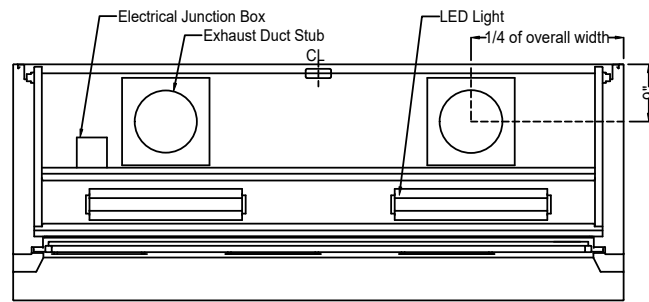

Dual Collar Rough-In

### Side Section Details

