

► Options Menu

Options Menu2-B – 2-C
--------------------	------------

► Technical Details

Cabinet Dimensions2-D
--------------------------	------

► Base Cabinets

Standing Height2-1 – 2-7
Sitting Height2-8 – 2-11
ADA Height2-12 – 2-13
Mobile Cabinets2-14 – 2-15

► Wall Cabinets

Wall Cabinets2-16 – 2-23
---------------------	--------------

► Tall Cabinets

Tall Cabinets2-24 – 2-29
---------------------	--------------

► Table Frames

Table Frames2-30 – 2-32
--------------------	--------------

► Aprons, Fillers and Trim

Support Legs2-33
Knee Space Panels2-34
Aprons2-35
Fillers - Base Cabinets2-36
Fillers - Wall Cabinets2-37
Fillers - Tall Cabinets2-38

► Shelving Systems

Fixed Reagent Rack2-39
Adjustable Reagent Rack2-40
Adjustable Reagent Rack - Double Sided2-41
Wall Mounted Shelving2-42

► Student Science Assemblies

How To Configure2-43
Science Student Workstations2-44 – 2-45
Science Instructor Assemblies2-46

▶ 1 - Drawer Suspension

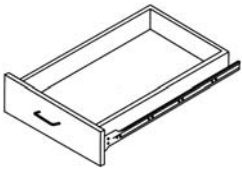

*3/4 Extension

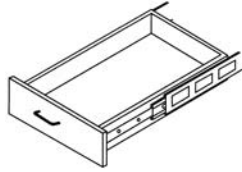

Full Extension
100 lb.

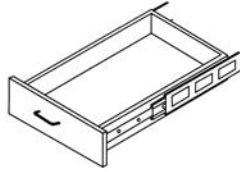

Full Extension
150 lb.

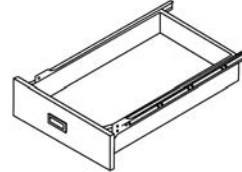

Metal Drawer
System

▶ 2 - Door and Drawer Pulls



4" Wire Pull

- *Brushed Chrome
- Black Painted
- Stainless Steel
- Polished Chrome
- Brushed Aluminum

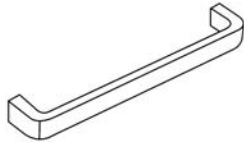

4" Bar Pull

- Brushed Aluminum

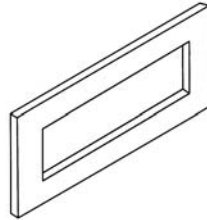

Recessed Pull

- Black Painted
- Polished Chrome

▶ 3 - Door Hinges

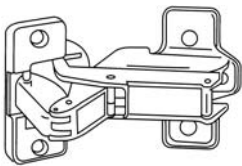

*Concealed
Self-Closing

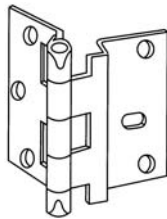

5 Knuckle

- Brushed Chrome
- Black Painted
- Stainless Steel

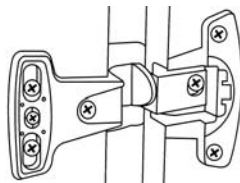

3 Knuckle

* Items marked are standard default.

► 4 - Lock Type

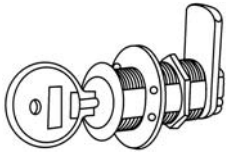

5 Disc Master

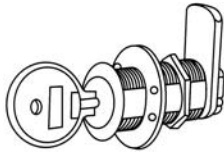

5 Pin Master

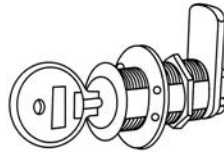

5 Pin Grandmaster

► 5 - Door Catches



*Roller Catch

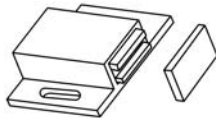

Magnetic Catch

None (Not required with concealed or 3 knuckle hinge)

► 6 - Shelf Clips



*Pin and Socket



Twin Pin Seismic

► 7 - Label Holders

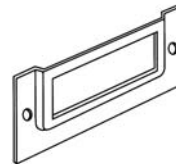

*None
 1 Per Door,
1 Per Drawer

► 8 - Glass

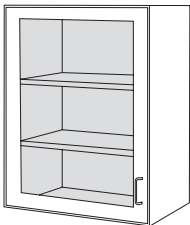

Float Glass

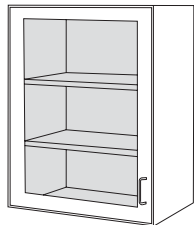

Laminated Safety Glass

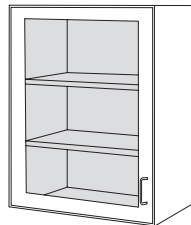

Tempered Safety Glass

► Base Cabinet Dimensions

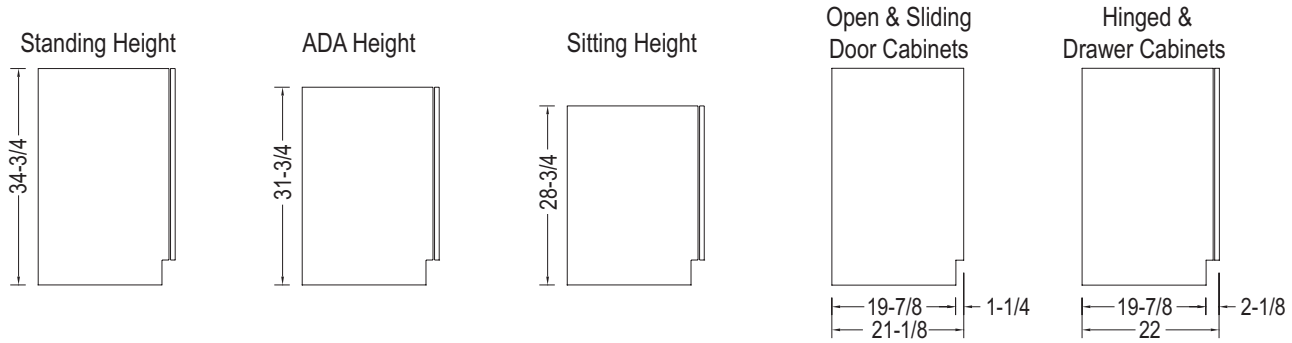

► Wall Cabinet Dimensions

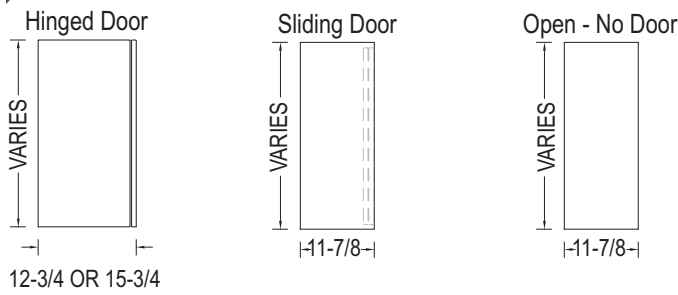

► Tall Cabinet Dimensions

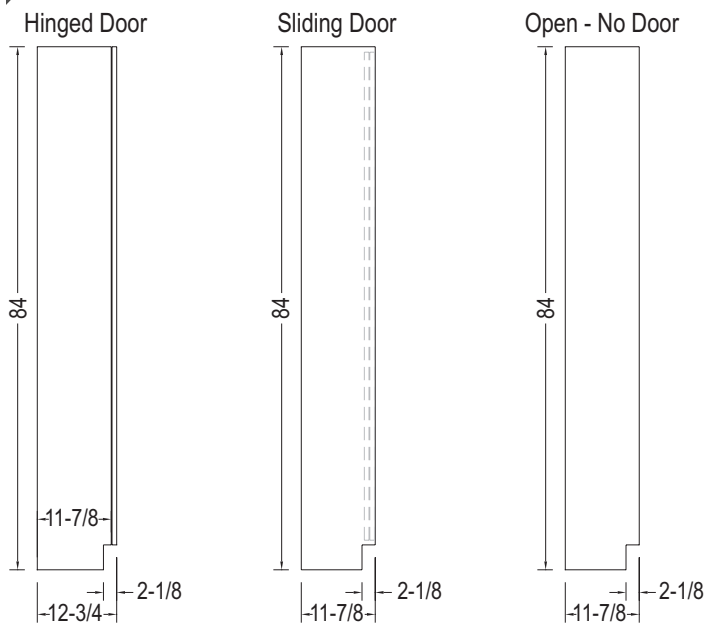

► Mobile Cabinet Dimensions

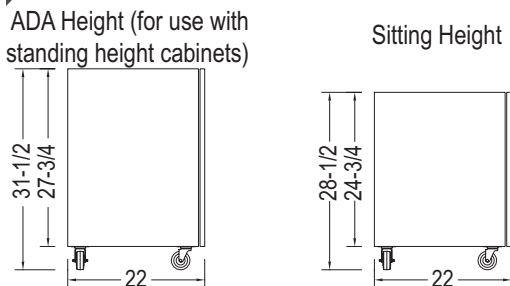

► Base Cabinets - Standing Height

Last two digits of catalog number indicate width.
Base cabinets are 22" deep unless otherwise noted.

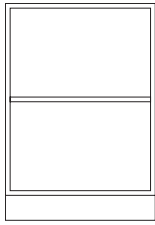
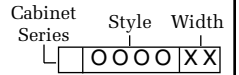
Cabinet Key:

1700-15	1700-18
1700-21	1700-24

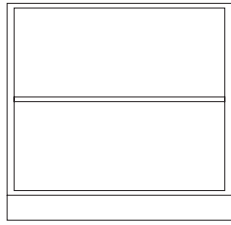

1700-30	1700-36
1700-42	1700-48

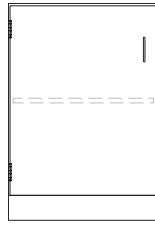

1500-15	1500-18
1500-21	1500-24

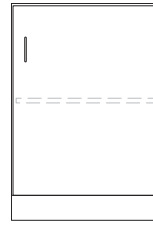

1600-15	1600-18
1600-21	1600-24

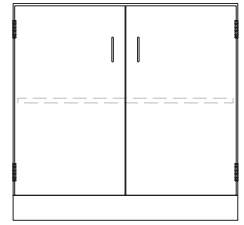

1400-30	1400-36
1400-42	1400-48

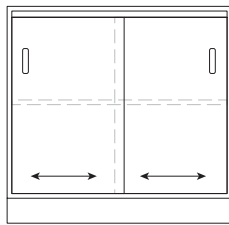

1703-30	1703-36
1703-42	1703-48

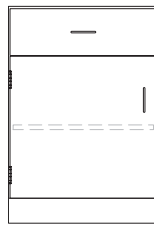

1511-15	1511-18
1511-21	1511-24

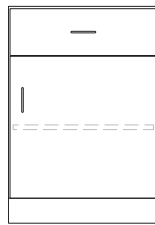

1611-15	1611-18
1611-21	1611-24

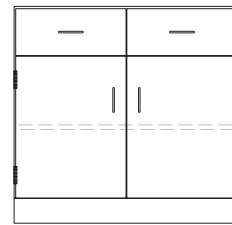

1411-30	1411-36
1411-42	1411-48

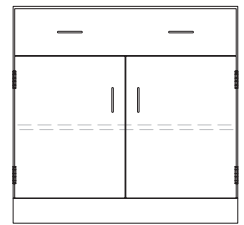

1311-30	1311-36
1311-42	1311-48

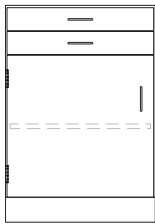

1522-15	1522-18
1522-21	1522-24

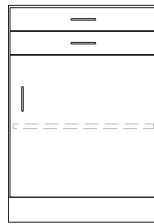

1622-15	1622-18
1622-21	1622-24

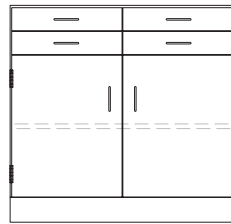

1422-30	1422-36
1422-42	1422-48

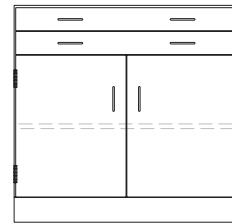

1322-30	1322-36
1322-42	1322-48

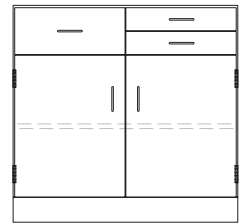

1412-30	1412-36
1412-42	1412-48

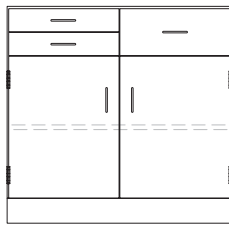

1421-30	1421-36
1421-42	1421-48

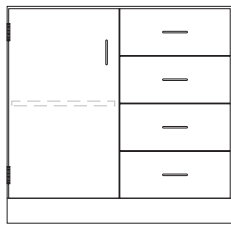

1404-30	1404-36
1404-42	1404-48

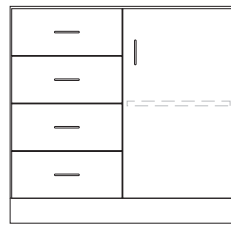

1440-30	1440-36
1440-42	1440-48

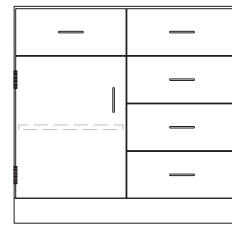

1414-30	1414-36
1414-42	1414-48

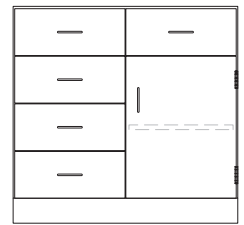

1441-30	1441-36
1441-42	1441-48

▶ Base Cabinets - Standing Height

Last two digits of catalog number indicate width.
 Base cabinets are 22" deep unless otherwise noted.

Cabinet Key:

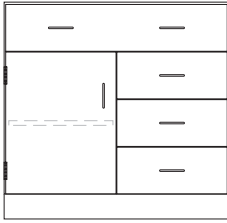
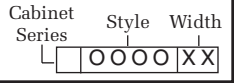

1314-30	1314-36
1314-42	1314-48

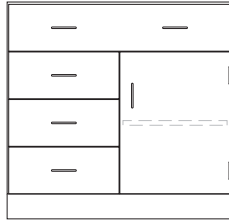

1341-30	1341-36
1341-42	1341-48

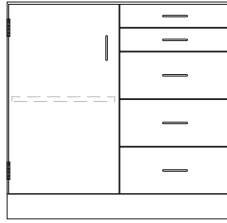

1405-30	1405-36
1405-42	1405-48

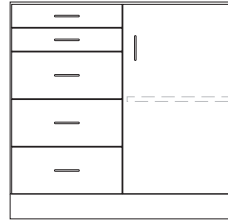

1450-30	1450-36
1450-42	1450-48

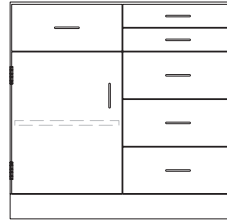

1415-30	1415-36
1415-42	1415-48

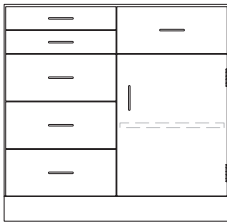

1451-30	1451-36
1451-42	1451-48

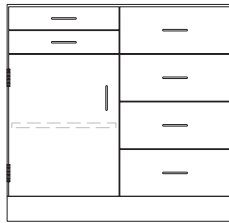

1424-30	1424-36
1424-42	1424-48

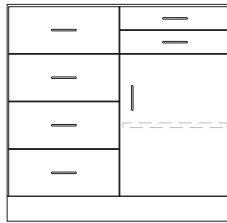

1442-30	1442-36
1442-42	1442-48

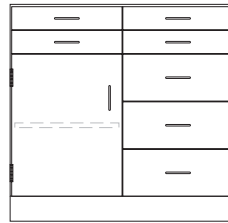

1425-30	1425-36
1425-42	1425-48

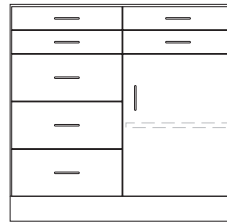

1452-30	1452-36
1452-42	1452-48

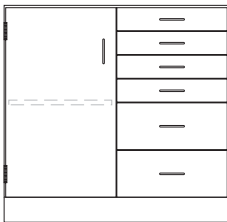

1406-30	1406-36
1406-42	1406-48

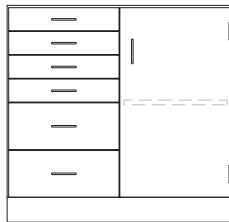

1460-30	1460-36
1460-42	1460-48

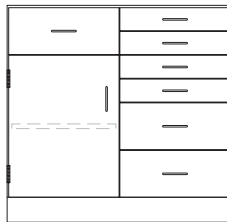

1416-30	1416-36
1416-42	1416-48

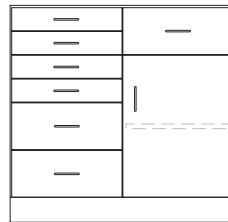

1461-30	1461-36
1461-42	1461-48

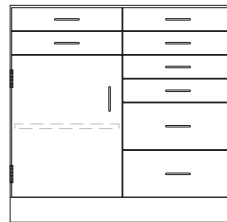

1426-30	1426-36
1426-42	1426-48

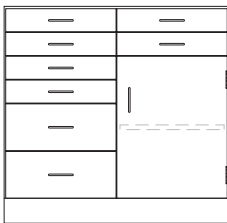

1462-30	1462-36
1462-42	1462-48

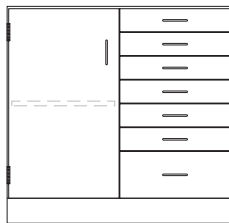

1407-30	1407-36
1407-42	1407-48

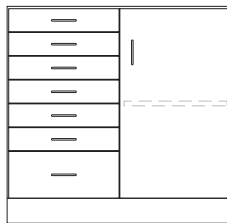

1470-30	1470-36
1470-42	1470-48

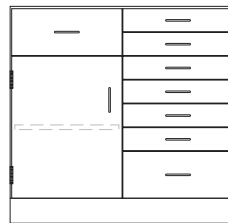

1417-30	1417-36
1417-42	1417-48

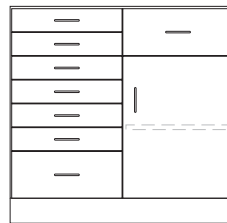

1471-30	1471-36
1471-42	1471-48

► Base Cabinets - Standing Height

Last two digits of catalog number indicate width.
Base cabinets are 22" deep unless otherwise noted.

Cabinet Key:		
Cabinet Series	Style	Width
□	○	XX

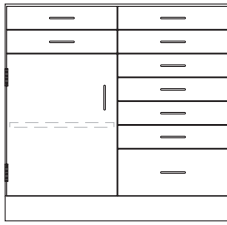

1427-30	1427-36
1427-42	1427-48

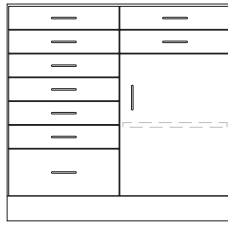

1472-30	1472-36
1472-42	1472-48

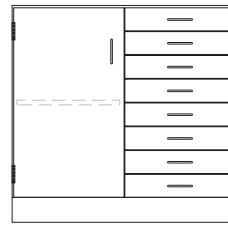

1408-30	1408-36
1408-42	1408-48

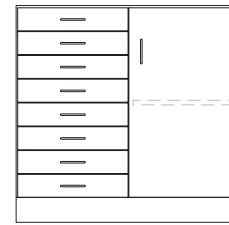

1480-30	1480-36
1480-42	1480-48

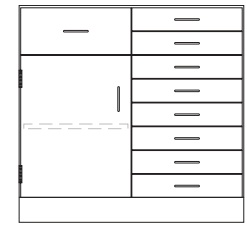

1418-30	1418-36
1418-42	1418-48

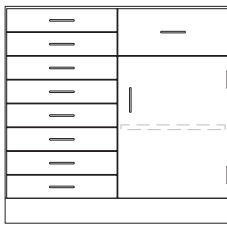

1481-30	1481-36
1481-42	1481-48

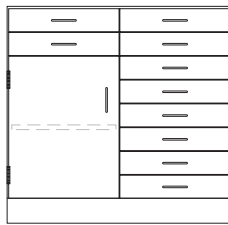

1428-30	1428-36
1428-42	1428-48

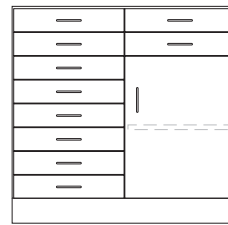

1482-30	1482-36
1482-42	1482-48

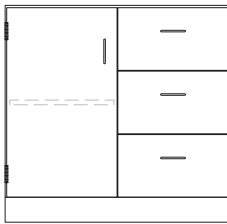

1403-30	1403-36
1403-42	1403-48

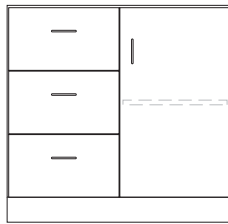

1430-30	1430-36
1430-42	1430-48

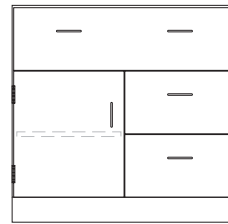

1313-30	1313-36
1313-42	1313-48

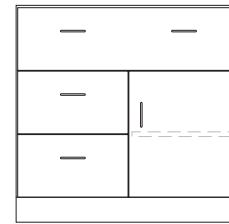

1331-30	1331-36
1331-42	1331-48

► Drawer Cabinets

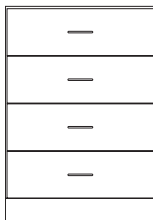

1044-15	1044-18
1044-21	1044-24



1044-30	1044-36
1044-42	1044-48

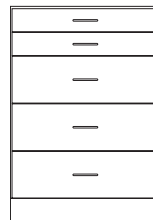

1055-15	1055-18
1055-21	1055-24

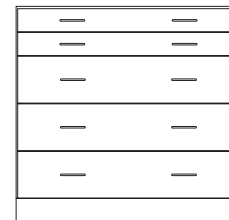

1055-30	1055-36
1055-42	1055-48

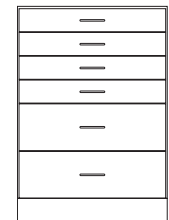

1066-15	1066-18
1066-21	1066-24

► Base Cabinets - Standing Height

Last two digits of catalog number indicate width.
 Base cabinets are 22" deep unless otherwise noted.

Cabinet Key:

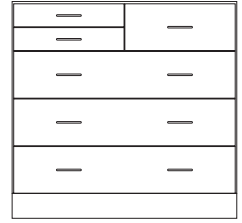
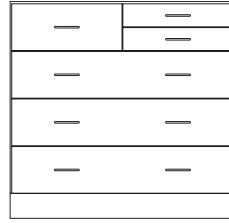
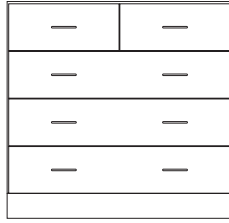
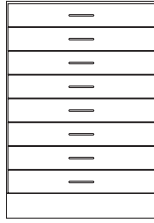
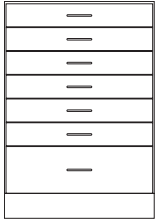
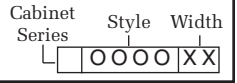

1077-15	1077-18
1077-21	1077-24

1088-15	1088-18
1088-21	1088-24

1144-30	1144-36
1144-42	1144-48

1145-30	1145-36
1145-42	1145-48

1154-30	1154-36
1154-42	1154-48

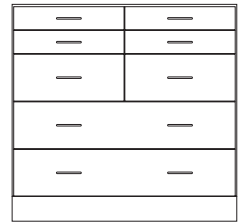
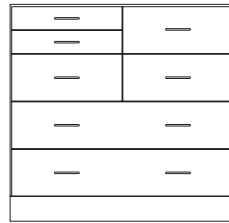
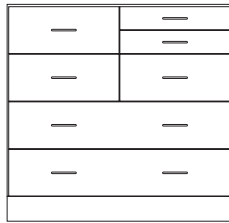
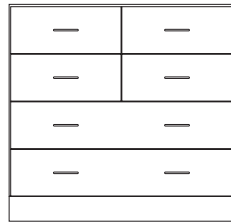
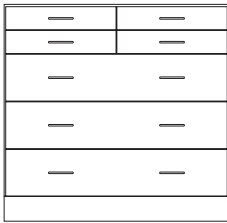

1155-30	1155-36
1155-42	1155-48

1244-30	1244-36
1244-42	1244-48

1245-30	1245-36
1245-42	1245-48

1254-30	1254-36
1254-42	1254-48

1255-30	1255-36
1255-42	1255-48

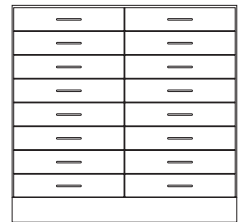
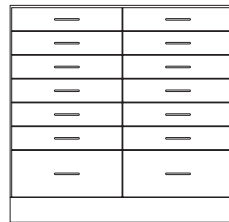
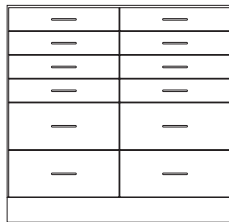
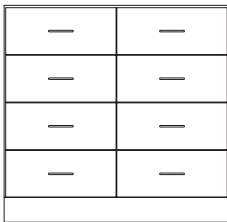

1444-30	1444-36
1444-42	1444-48

1455-30	1455-36
1455-42	1455-48

1466-30	1466-36
1466-42	1466-48

1477-30	1477-36
1477-42	1477-48

1488-30	1488-36
1488-42	1488-48

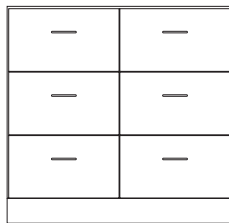
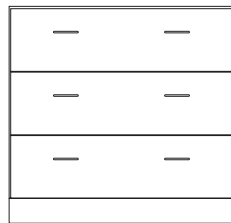
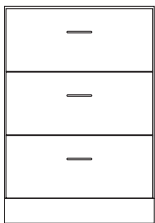

1033-15	1033-18
1033-21	1033-24

1033-30	1033-36
1033-42	1033-48

1433-30	1433-36
1433-42	1433-48

► Specialty Base Cabinets - Standing Height

Last two digits of catalog number indicate width.
Base cabinets are 22" deep unless otherwise noted.

Cabinet Key:	Cabinet Series	Style	Width
	□	○	XX

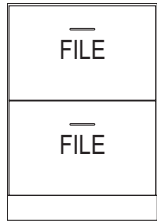

1901-15	1901-18
1901-21	1901-24

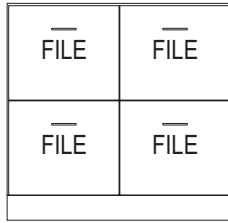

1902-30	1902-36
1902-42	1902-48

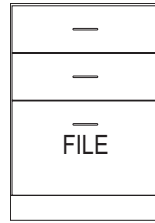

1921-15	1921-18
1921-21	1921-24

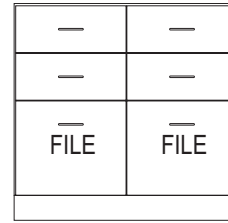

1922-30	1922-36
1922-42	1922-48

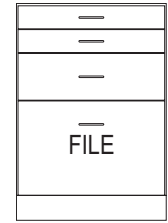

1931-15	1931-18
1931-21	1931-24

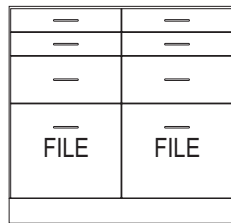

1932-30	1932-36
1932-42	1932-48

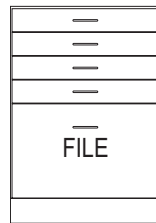

1941-15	1941-18
1941-21	1941-24

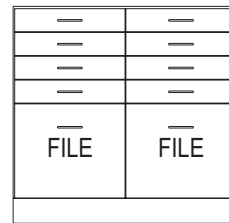

1942-30	1942-36
1942-42	1942-48

Waste Bin Cabinet

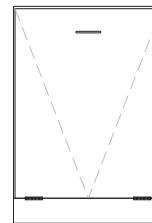

1951-15	1951-18
1951-21	1951-24

Tote Tray Cabinet

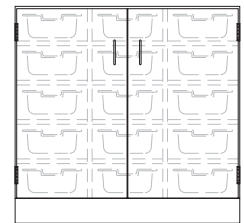

1971-36	1971-48
---------	---------

► Bookcases - 12" Deep

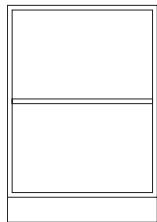

1973-15	1973-18
1973-21	1973-24

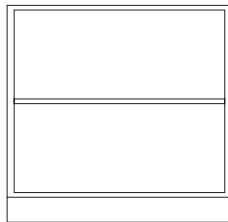

1973-30	1973-36
1973-42	1973-48

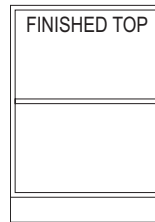

1972-15	1972-18
1972-21	1972-24

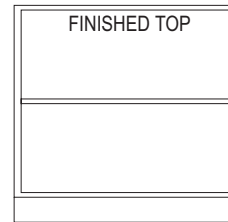

1972-30	1972-36
1972-42	1972-48

► Corner Cabinets

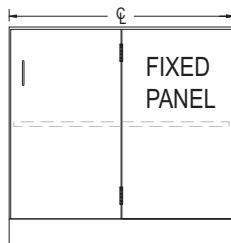

1732-30	1732-36
1732-42	1732-48

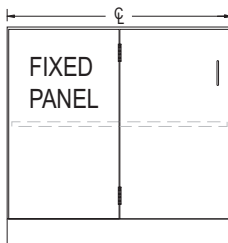

1721-30	1721-36
1721-42	1721-48

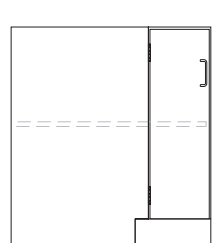

1741-32	
---------	--

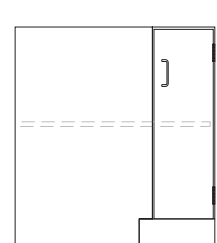

1742-32	
---------	--

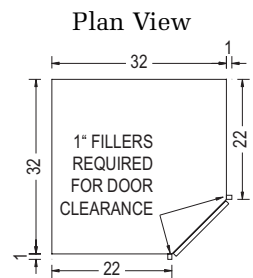

► Sink Base Cabinets - Standing Height

Last two digits of catalog number indicate width.
Base cabinets are 22" deep unless otherwise noted.

Cabinet Key:		Cabinet	Style	Width
	Series			
	L	O	O	X

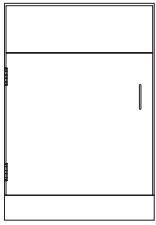

1714-15	1714-18
1714-21	1714-24

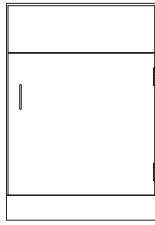

1715-15	1715-18
1715-21	1715-24

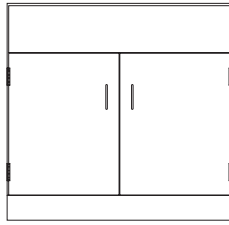

1716-30	1716-36
1716-42	1716-48

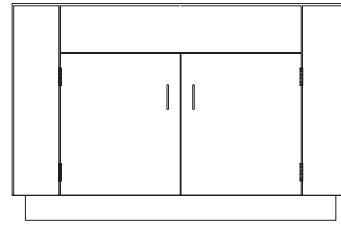

1716-52	1716-54
1716-58	

► Corner Sink Base Cabinets



1711-15	1711-18
1711-21	1711-24

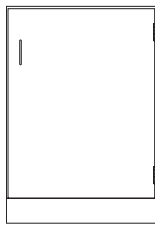

1712-15	1712-18
1712-21	1712-24

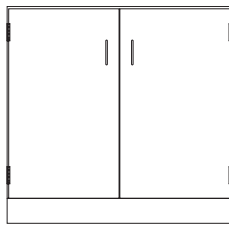

1713-30	1713-36
1713-42	1713-48

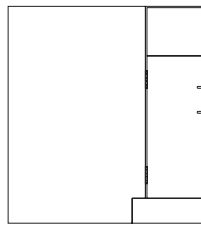

1754-32	

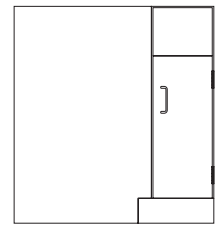

1755-32	

► Fume Hood Base Cabinets - 18" Deep

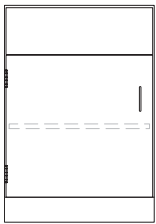

1874-12	1874-15
1874-18	1874-24

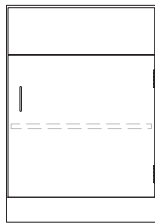

1875-12	1875-15
1875-18	1875-24

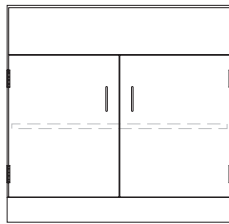

1876-30	1876-36
1876-42	1876-48

► Acid Storage Cabinets - 18" Deep



1891-18	1891-24



1892-18	1892-24

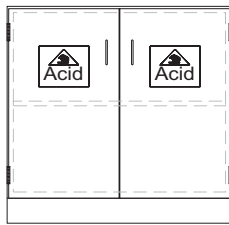

1893-30	1893-36
1893-42	1893-48

► Acid Storage Cabinets - 18" Deep

Cabinet Key:	Cabinet	Style	Width
	Series		
	L	OOOO	XX

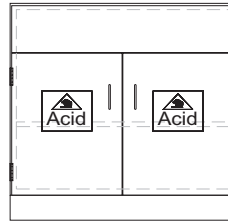
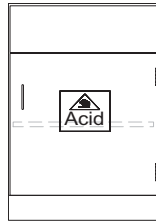
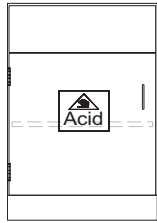

1894-18	1894-24
---------	---------

1895-18	1895-24
---------	---------

1896-30	1896-36
1896-42	1896-48

► Fume Hood Base Cabinets - 22" Deep

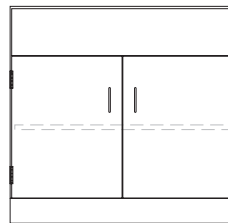
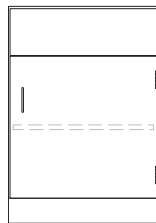
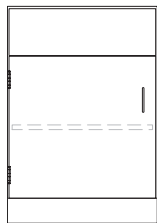

1774-12	1774-15
1774-18	1774-24

1775-12	1775-15
1775-18	1775-24

1776-30	1776-36
1776-42	1776-48

► Acid Storage Cabinets - 22" Deep

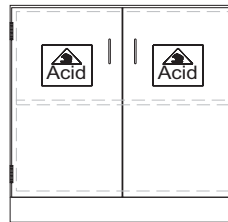
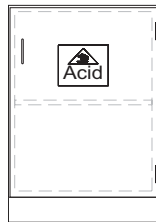

1791-18	1791-24
---------	---------

1792-18	1792-24
---------	---------

1793-30	1793-36
1793-42	1793-48

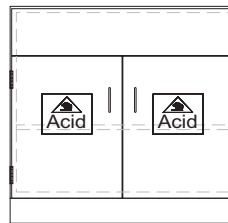
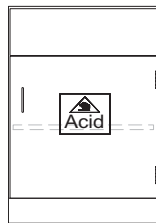
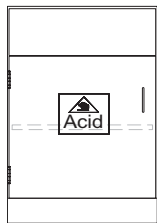

1794-18	1794-24
---------	---------

1795-18	1795-24
---------	---------

1796-30	1796-36
1796-42	1796-48

Base Cabinets - Sitting Height

Last two digits of catalog number indicate width.
Base cabinets are 22" deep unless otherwise noted.

Cabinet Key:

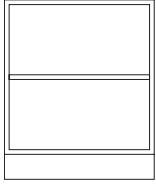
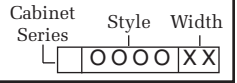

0700-15	0700-18
0700-21	0700-24

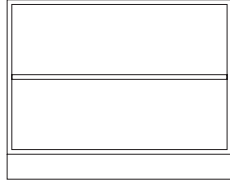

0700-30	0700-36
0700-42	0700-48

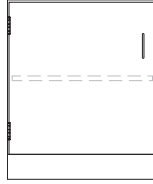

0500-15	0500-18
0500-21	0500-24

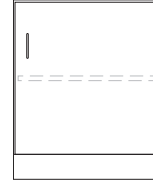

0600-15	0600-18
0600-21	0600-24

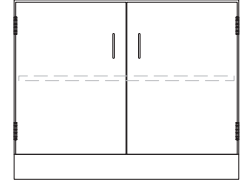

0400-30	0400-36
0400-42	0400-48

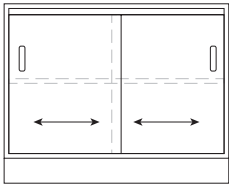

0703-30	0703-36
0703-42	0703-48

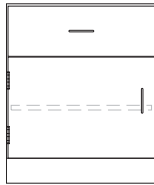

0511-30	0511-36
0511-42	0511-48

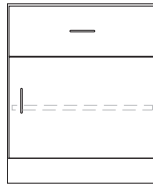

0611-15	0611-18
0611-21	0611-24

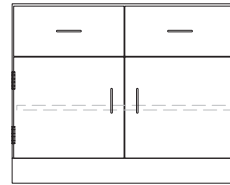

0411-30	0411-36
0411-42	0411-48

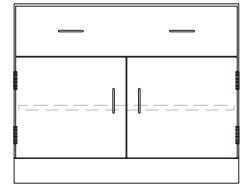

0311-30	0311-36
0311-42	0311-48

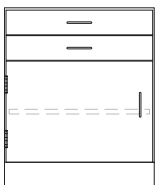

0522-15	0522-18
0522-21	0522-24

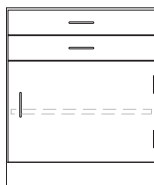

0622-15	0622-18
0622-21	0622-24

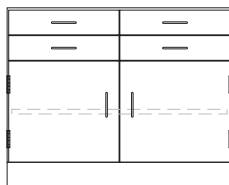

0422-30	0422-36
0422-42	0422-48

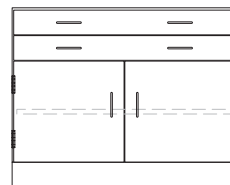

0322-30	0322-36
0322-42	0322-48

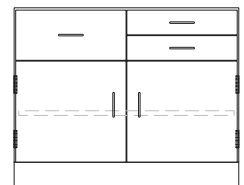

0412-30	0412-36
0412-42	0412-48

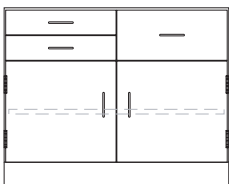

0421-30	0421-36
0421-42	0421-48

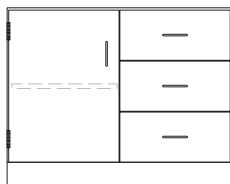

0403-30	0403-36
0403-42	0403-48

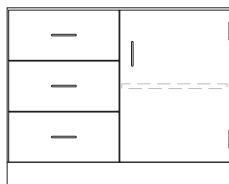

0430-30	0430-36
0430-42	0430-48

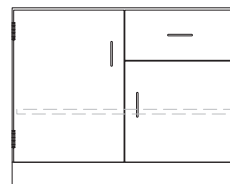

0401-30	0401-36
0401-42	0401-48

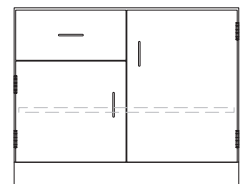

0410-30	0410-36
0410-42	0410-48

► Base Cabinets - Sitting Height

Last two digits of catalog number indicate width.
Base cabinets are 22" deep unless otherwise noted.

Cabinet Key:		Cabinet Series	Style	Width
		L	OOOO	XX

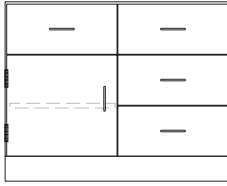

0413-30	0413-36
0413-42	0413-48

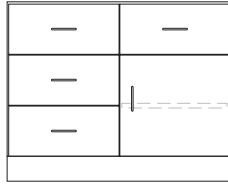

0431-30	0431-36
0431-42	0431-48

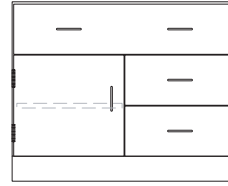

0313-30	0313-36
0313-42	0313-48

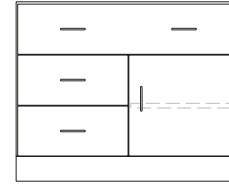

0331-30	0331-36
0331-42	0331-48

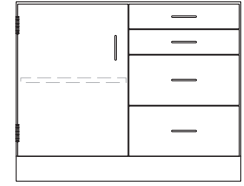

0404-30	0404-36
0404-42	0404-48

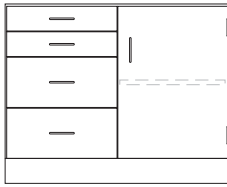

0440-30	0440-36
0440-42	0440-48

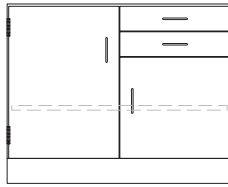

0402-30	0402-36
0402-42	0402-48

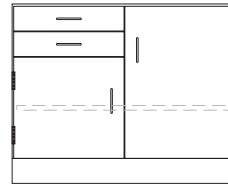

0420-30	0420-36
0420-42	0420-48

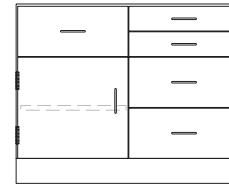

0414-30	0414-36
0414-42	0414-48

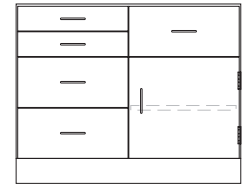

0441-30	0441-36
0441-42	0441-48

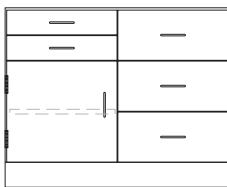

0423-30	0423-36
0423-42	0423-48

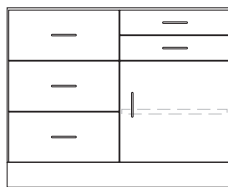

0432-30	0432-36
0432-42	0432-48

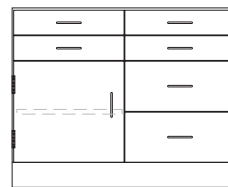

0424-30	0424-36
0424-42	0424-48

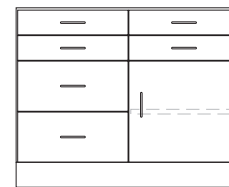

0442-30	0442-36
0442-42	0442-48

► Drawer Cabinets

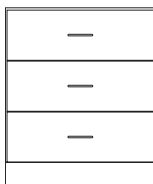

0033-15	0033-18
0033-21	0033-24

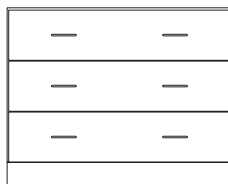

0033-30	0033-36
0033-42	0033-48

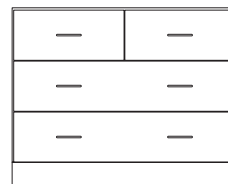

0133-30	0133-36
0133-42	0133-48

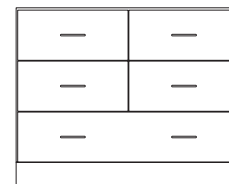

0233-30	0233-36
0233-42	0233-48

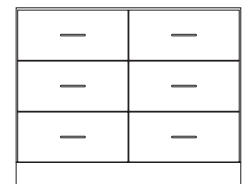

0433-30	0433-36
0433-42	0433-48

Base Cabinets - Sitting Height

Last two digits of catalog number indicate width.
Base cabinets are 22" deep unless otherwise noted.

Cabinet Key:

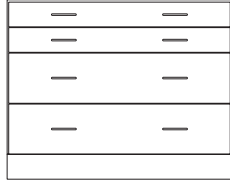
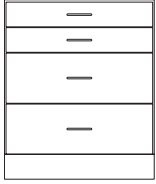
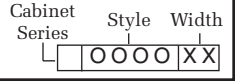

0044-15	0044-18
0044-21	0044-24

0044-30	0044-36
0044-42	0044-48

0144-30	0144-36
0144-42	0144-48

0134-30	0134-36
0134-42	0134-48

0143-30	0143-36
0143-42	0143-48

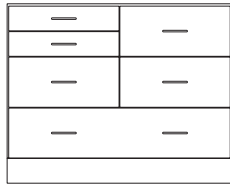

0234-30	0234-36
0234-42	0234-48

0243-30	0243-36
0243-42	0243-48

0434-30	0434-36
0434-42	0434-48

0443-30	0443-36
0443-42	0443-48

0444-30	0444-36
0444-42	0444-48

File Drawers

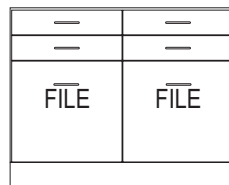
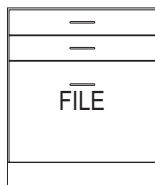
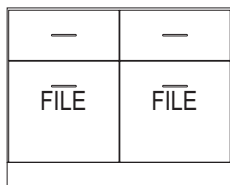
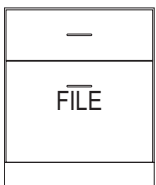

0911-15	0911-18
0911-21	0911-24

0912-30	0912-36
0912-42	0912-48

0921-15	0921-18
0921-21	0921-24

0922-30	0922-36
0922-42	0922-48

Corner Cabinets

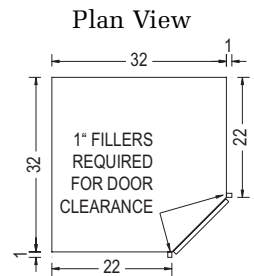
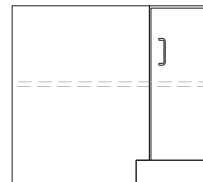
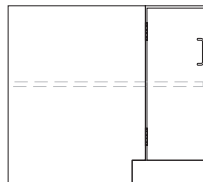
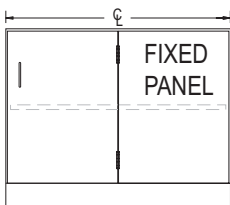
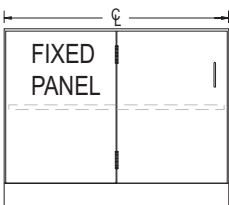

0721-30	0721-36
0721-42	0721-48

0732-30	0732-36
0732-42	0732-48

0741-32	
---------	--

0742-32	
---------	--

► Sink Base Cabinets - Sitting Height

Last two digits of catalog number indicate width.
Base cabinets are 22" deep unless otherwise noted.

Cabinet Key:		
Cabinet Series	Style	Width
L	0000	XX

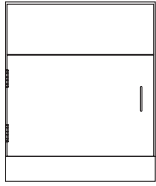

0714-15	0714-18
0714-21	0714-24

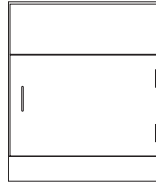

0715-15	0715-18
0715-21	0715-24

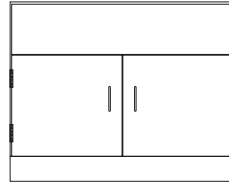

0716-30	0716-36
0716-42	0716-48

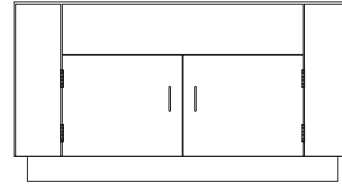

0716-52	0716-54
0716-58	

► Fume Hood Base Cabinets

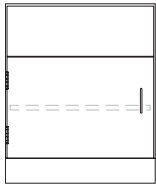

0774-15	0774-18
0774-24	

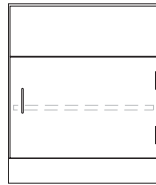

0775-15	0775-18
0775-24	

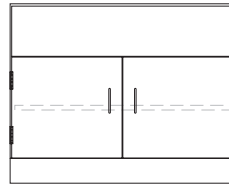

0776-30	0776-36
0776-42	0776-48

► Acid Storage Cabinets



0791-15	0791-18
0791-24	

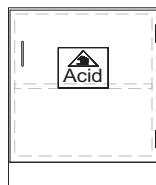

0792-15	0792-18
0792-24	

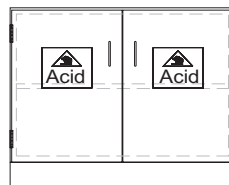

0793-30	0793-36
0793-42	0793-48

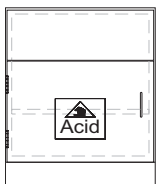

0794-15	0794-18
0794-24	

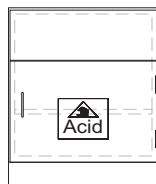

0795-15	0795-18
0795-24	

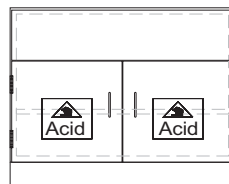

0796-30	0796-36
0796-42	0796-48

Base Cabinets - ADA Height

Last two digits of catalog number indicate width.
Base cabinets are 22" deep unless otherwise noted.

Cabinet Key:

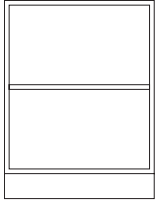
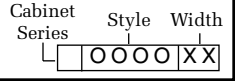

6700-15	6700-18
6700-21	6700-24

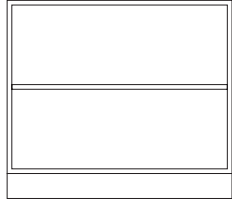

6700-30	6700-36
6700-42	6700-48

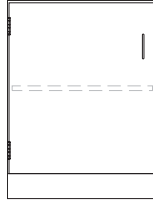

6500-15	6500-18
6500-21	6500-24

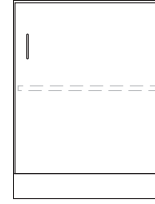

6600-15	6600-18
6600-21	6600-24

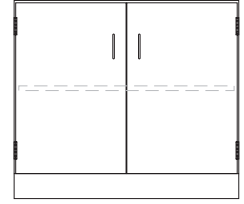

6400-30	6400-36
6400-42	6400-48

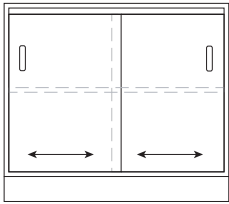

6703-30	6703-36
6703-42	6703-48

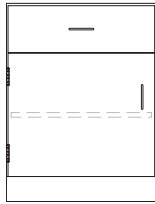

6511-15	6511-18
6511-21	6511-24

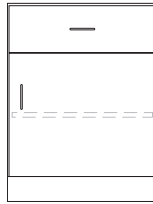

6611-15	6611-18
6611-21	6611-24

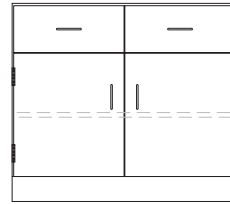

6411-30	6411-36
6411-42	6411-48

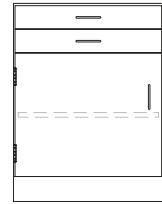

6522-15	6522-18
6522-21	6522-24

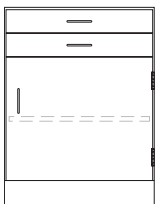

6622-15	6622-18
6622-21	6622-24

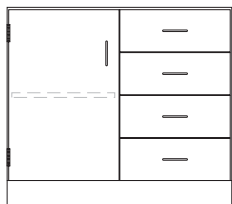

6404-30	6404-36
6404-42	6404-48

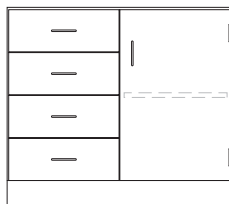

6440-30	6440-36
6440-42	6440-48

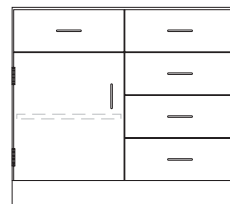

6414-30	6414-36
6414-42	6414-48

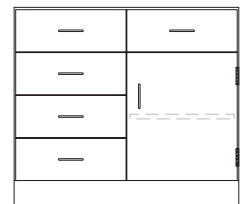

6441-30	6441-36
6441-42	6441-48

Drawer Cabinets

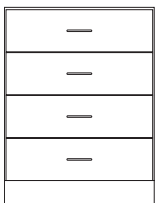

6044-15	6044-18
6044-21	6044-24



6044-30	6044-36
6044-42	6044-48

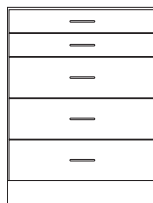

6055-15	6055-18
6055-21	6055-24

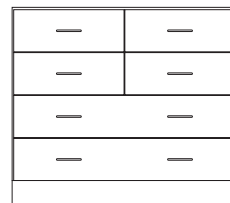

6244-30	6244-36
6244-42	6244-48

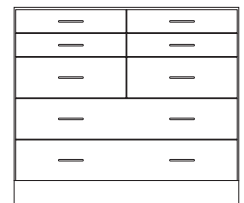

6255-30	6255-36
6255-42	6255-48

▶ Base Cabinets - ADA Height

Last two digits of catalog number indicate width.
Base cabinets are 22" deep unless otherwise noted.

Cabinet Key:		
Cabinet Series	Style	Width
L	OOOO	XX



6444-30	6444-36
6444-42	6444-48

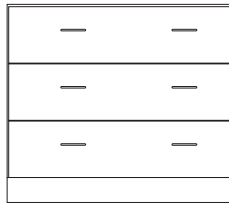

6033-30	6033-36
6033-42	6033-48

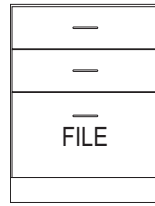

6921-15	6921-18
6921-21	6921-24

▶ Sink Base Cabinets



6710-30	6710-36
6710-42	6710-48

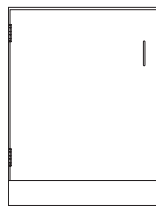

6711-15	6711-18
6711-21	6711-24

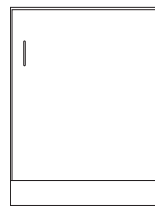

6712-15	6712-18
6712-21	6712-24

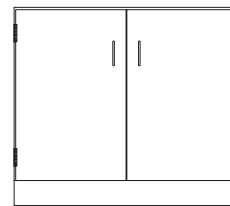

6713-30	6713-36
6713-42	6713-48

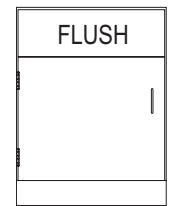

6714-15	6714-18
6714-21	6714-24

▶ Acid Storage Cabinets

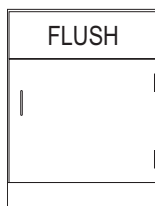

6715-15	6715-18
6715-21	6715-24

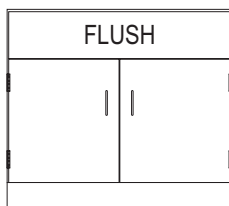

6716-30	6716-36
6716-42	6716-48

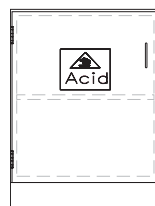

6791-15	6791-18
6791-21	6791-24

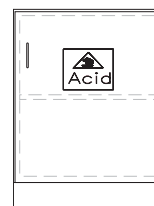

6792-15	6792-18
6792-21	6792-24

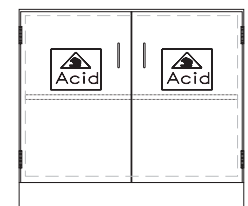

6793-30	6793-36
6793-42	6793-48

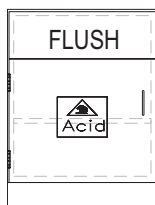

6794-15	6794-18
6794-21	6794-24

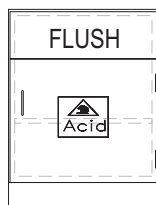

6795-15	6795-18
6795-21	6795-24

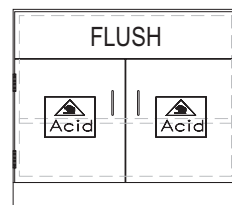

6796-30	6796-36
6796-42	6796-48

Mobile Base Cabinets - Standing Height

Last two digits of catalog number indicate width. Cabinets are 31-1/2" high and are designed for use under standing height countertops.

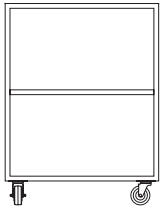
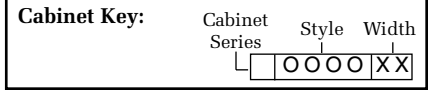

6700M-18 6700M-24

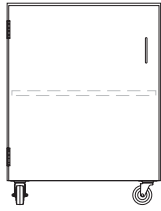

6500M-18 6500M-24

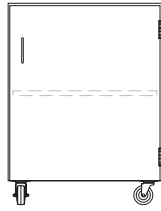

6600M-18 6600M-24

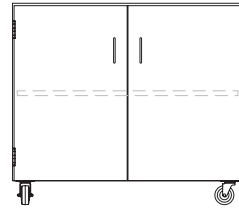

6400M-30 6400M-36

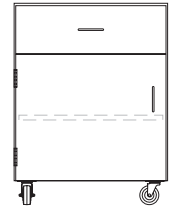

6511M-18 6511M-24

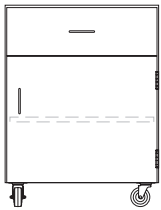

6611M-18 6611M-24

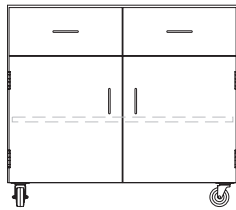

6411M-30 6411M-36

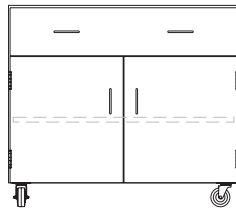

6311M-30 6311M-36

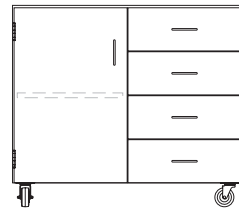

6404M-30 6404M-36

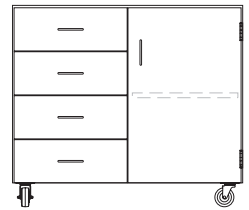

6440M-30 6440M-36

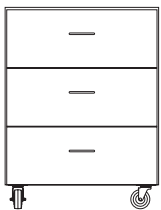

6033M-18 6033M-24

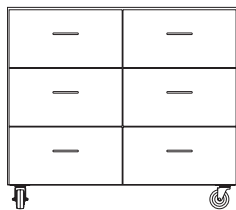

6433M-30 6433M-36

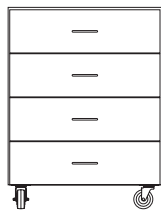

6044M-18 6044M-24

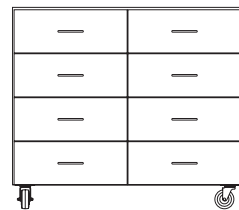

6444M-30 6444M-36

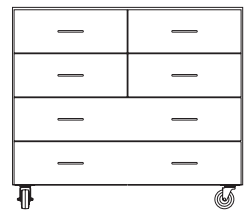

6244M-30 6244M-36

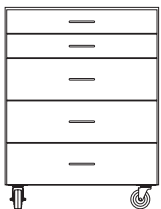

6055M-18 6055M-24

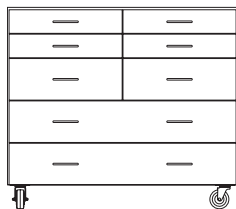

6255M-30 6255M-36

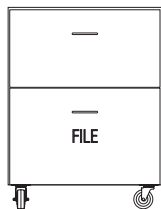

6911M-18 6911M-24

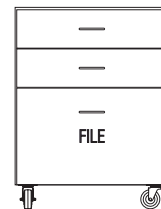

6921M-18 6921M-24

► Mobile Base Cabinets - Sitting Height

Last two digits of catalog number indicate width.
Base cabinets are 22" deep unless otherwise noted.

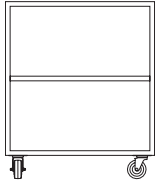
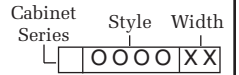
Cabinet Key:

0700M-18	0700M-24
----------	----------

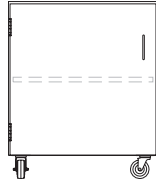

0500M-18	0500M-24
----------	----------

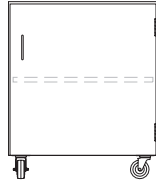

0600M-18	0600M-24
----------	----------

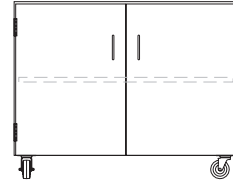

0400M-30	0400M-36
----------	----------

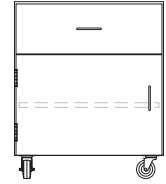

0511M-18	0511M-24
----------	----------

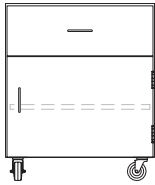

0611M-18	0611M-24
----------	----------

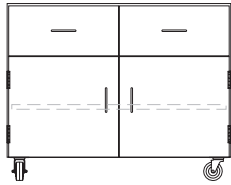

0411M-30	0411M-36
----------	----------

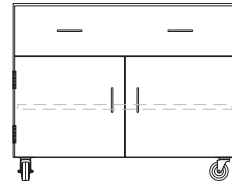

0311M-30	0311M-36
----------	----------

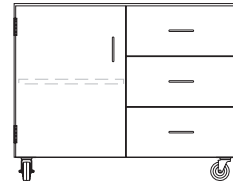

0403M-30	0403M-36
----------	----------

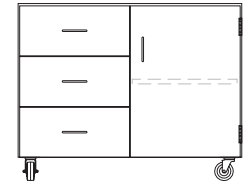

0430M-30	0430M-36
----------	----------

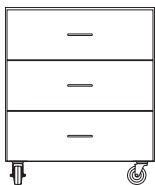

0033M-18	0033M-24
----------	----------

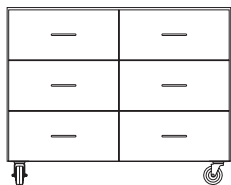

0433M-30	0433M-36
----------	----------

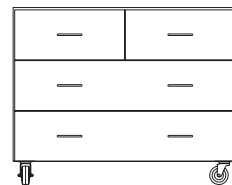

0133M-30	0133M-36
----------	----------

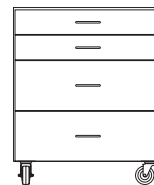

0044M-18	0044M-24
----------	----------

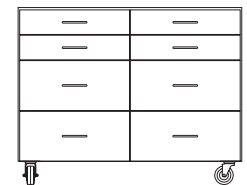

0444M-30	0444M-36
----------	----------

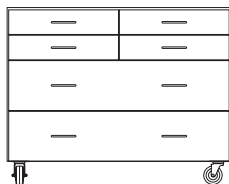

0144M-30	0144M-36
----------	----------

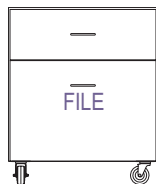

0911M-18	0911M-24
----------	----------

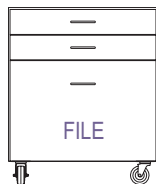

0921M-18	0921M-24
----------	----------

Wall Cabinets - 24" High, 12" Deep

Last two digits of catalog number indicate width.

Cabinet Key:

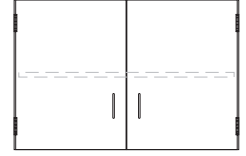
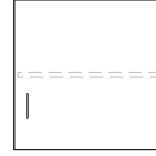
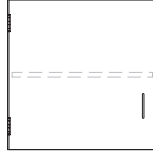
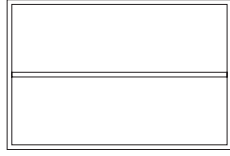
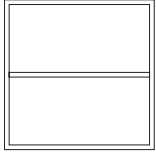
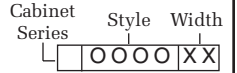

2100-15	2100-18
2100-21	2100-24

2100-30	2100-36
2100-42	2100-48

2101-15	2101-18
2101-21	2101-24

2102-15	2102-18
2102-21	2102-24

2103-30	2103-36
2103-42	2103-48

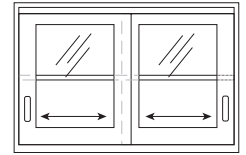
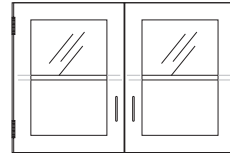
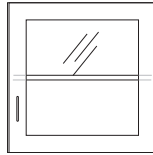
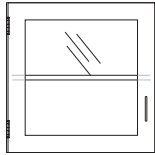
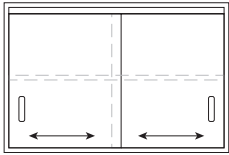

2104-30	2104-36
2104-42	2104-48

2105-15	2105-18
2105-21	2105-24

2106-15	2106-18
2106-21	2106-24

2107-30	2107-36
2107-42	2107-48

2108-30	2108-36
2108-42	2108-48

Corner Wall Cabinets

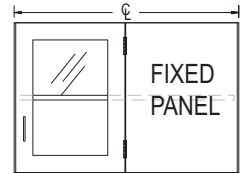
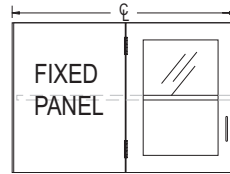
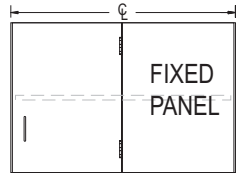
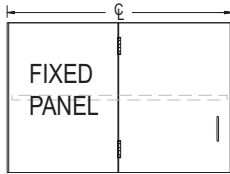
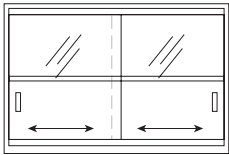

2109-30	2109-36
2109-42	2109-48

2121-30	2121-36
2121-42	2121-48

2122-30	2122-36
2122-42	2122-48

2125-30	2125-36
2125-42	2125-48

2126-30	2126-36
2126-42	2126-48

Corner Wall Cabinets

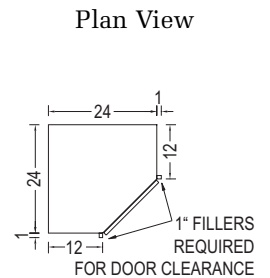
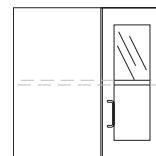
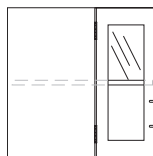
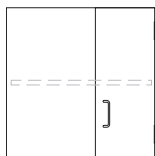
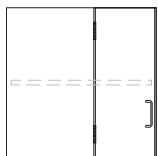

2111-24	
---------	--

2112-24	
---------	--

2115-24	
---------	--

2116-24	
---------	--

Wall Cabinets - 24" High, 16" Deep

Last two digits of catalog number indicate width.

Cabinet Key:

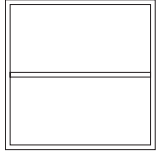
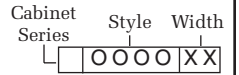

2130-15	2130-18
2130-21	2130-24

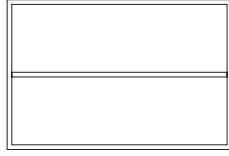

2130-30	2130-36
2130-42	2130-48

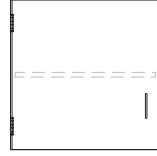

2131-15	2131-18
2131-21	2131-24

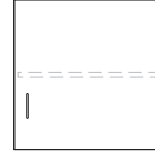

2132-15	2132-18
2132-21	2132-24

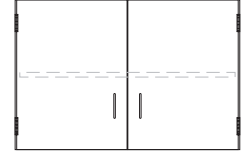

2133-30	2133-36
2133-42	2133-48

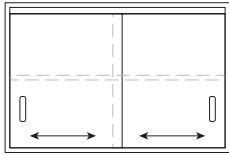

2134-30	2134-36
2134-42	2134-48

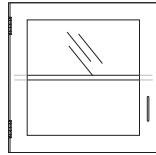

2135-15	2135-18
2135-21	2135-24

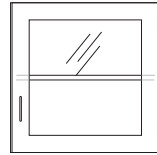

2136-15	2136-18
2136-21	2136-24

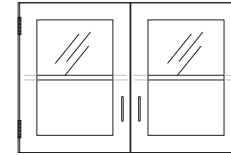

2137-30	2137-36
2137-42	2137-48

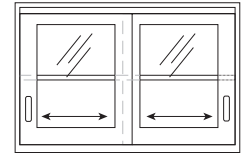

2138-30	2138-36
2138-42	2138-48

Corner Wall Cabinets

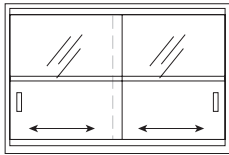

2139-30	2139-36
2139-42	2139-48

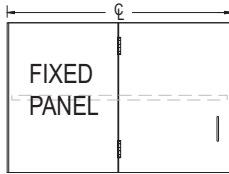

2151-30	2151-36
2151-42	2151-48

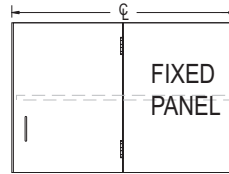

2152-30	2152-36
2152-42	2152-48

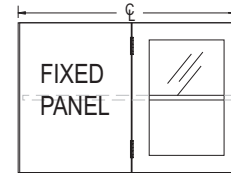

2155-30	2155-36
2155-42	2155-48

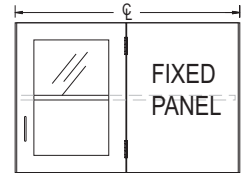

2156-30	2156-36
2156-42	2156-48

Corner Wall Cabinets

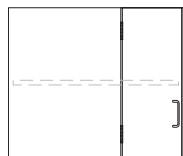

2141-28	
---------	--

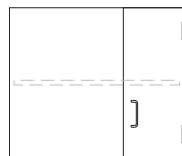

2142-28	
---------	--

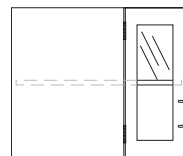

2145-28	
---------	--

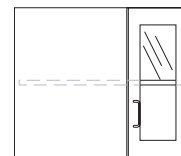

2146-28	
---------	--

Plan View

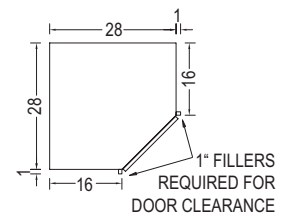

Wall Cabinets - 30" High, 12" Deep

Last two digits of catalog number indicate width.

Cabinet Key:

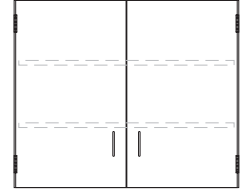
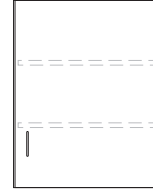
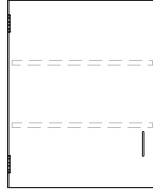
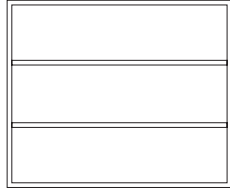
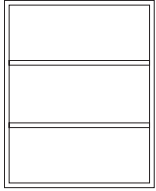
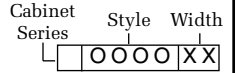

2200-15	2200-18
2200-21	2200-24

2200-30	2200-36
2200-42	2200-48

2201-15	2201-18
2201-21	2201-24

2202-15	2202-18
2202-21	2202-24

2203-30	2203-36
2203-42	2203-48

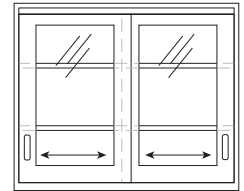
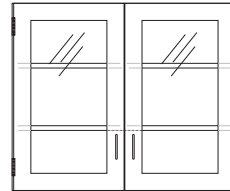
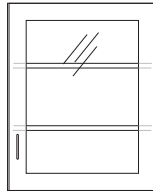
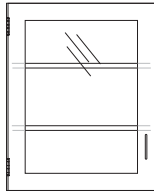
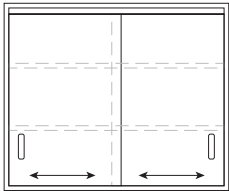

2204-30	2204-36
2204-42	2204-48

2205-15	2205-18
2205-21	2205-24

2206-15	2206-18
2206-21	2206-24

2207-30	2207-36
2207-42	2207-48

2208-30	2208-36
2208-42	2208-48

Corner Wall Cabinets

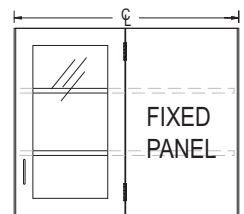
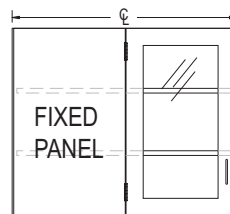
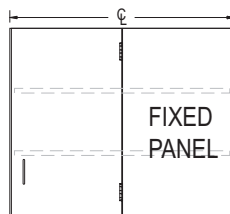
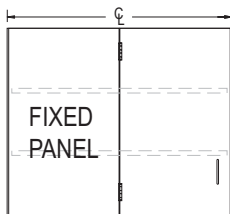
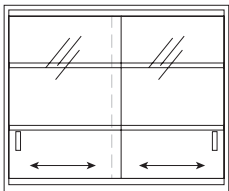

2209-30	2209-36
2209-42	2209-48

2221-30	2221-36
2221-42	2221-48

2222-30	2222-36
2222-42	2222-48

2225-30	2225-36
2225-42	2225-48

2226-30	2226-36
2226-42	2226-48

Corner Wall Cabinets

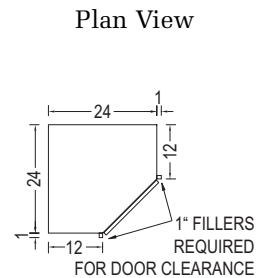
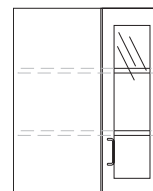
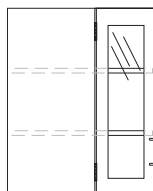
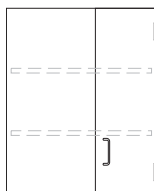
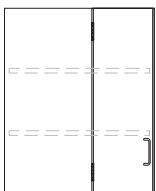

2211-24	
---------	--

2212-24	
---------	--

2215-24	
---------	--

2216-24	
---------	--

Wall Cabinets - 30" High, 16" Deep

Last two digits of catalog number indicate width.

Cabinet Key:

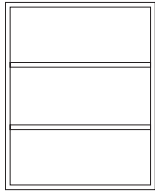
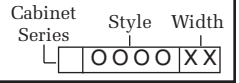

2230-15	2230-18
2230-21	2230-24

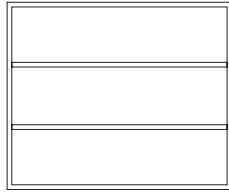

2230-30	2230-36
2230-42	2230-48

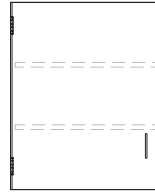

2231-15	2231-18
2231-21	2231-24

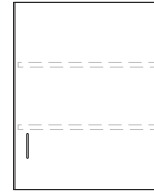

2232-15	2232-18
2232-21	2232-24

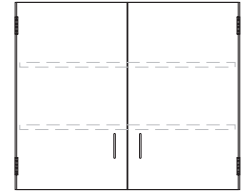

2233-30	2233-36
2233-42	2233-48

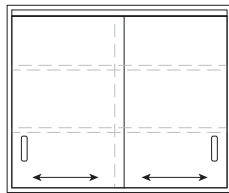

2234-30	2234-36
2234-42	2234-48

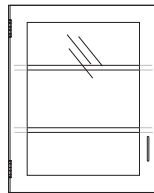

2235-15	2235-18
2235-21	2235-24

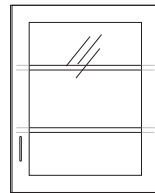

2236-15	2236-18
2236-21	2236-24

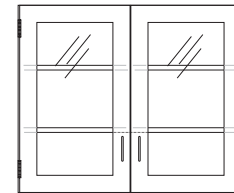

2237-30	2237-36
2237-42	2237-48

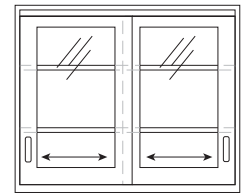

2238-30	2238-36
2238-42	2238-48

Corner Wall Cabinets

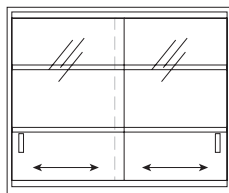

2239-30	2239-36
2239-42	2239-48

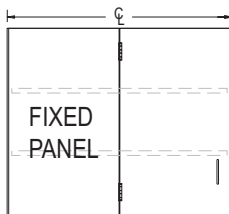

2251-30	2251-36
2251-42	2251-48

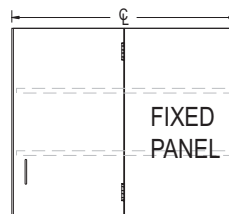

2252-30	2252-36
2252-42	2252-48

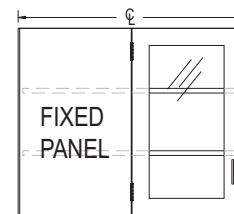

2255-30	2255-36
2255-42	2255-48

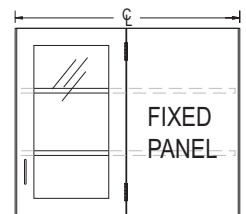

2256-30	2256-36
2256-42	2256-48

Corner Wall Cabinets

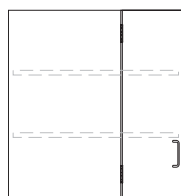

2241-28	
---------	--

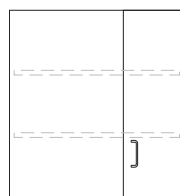

2242-28	
---------	--

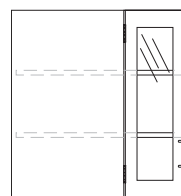

2245-28	
---------	--

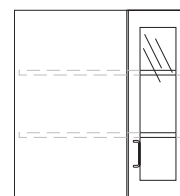

2246-28	
---------	--

Plan View

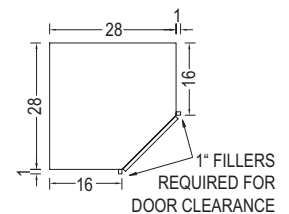

Wall Cabinets - 36" High, 12" Deep

Last two digits of catalog number indicate width.

Cabinet Key:

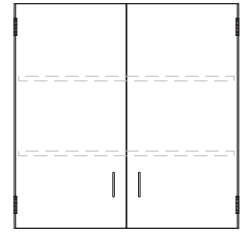
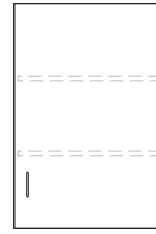
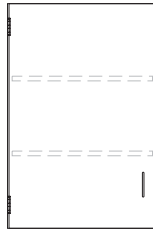
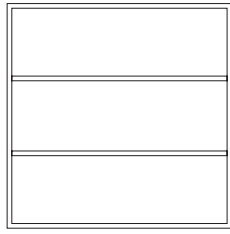
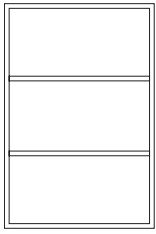
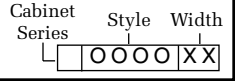

2300-15	2300-18
2300-21	2300-24

2300-30	2300-36
2300-42	2300-48

2301-15	2301-18
2301-21	2301-24

2302-15	2302-18
2302-21	2302-24

2303-30	2303-36
2303-42	2303-48

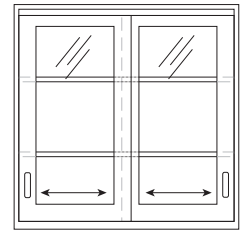
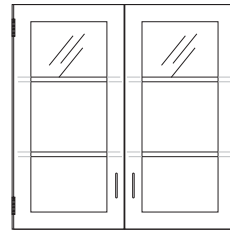
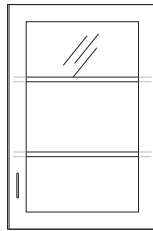
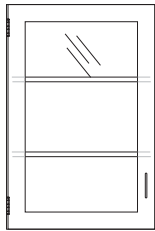
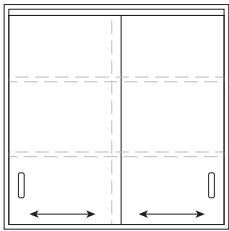

2304-30	2304-36
2304-42	2304-48

2305-15	2305-18
2305-21	2305-24

2306-15	2306-18
2306-21	2306-24

2307-30	2307-36
2307-42	2307-48

2308-30	2308-36
2308-42	2308-48

Corner Wall Cabinets

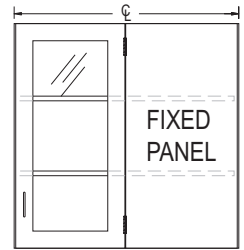
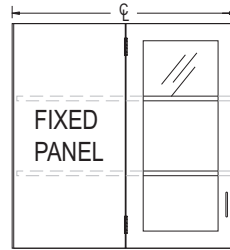
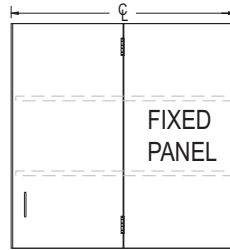
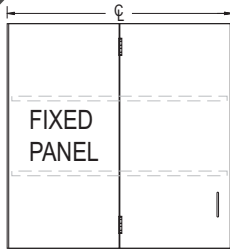
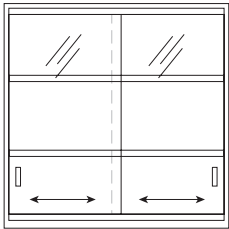

2309-30	2309-36
2309-42	2309-48

2321-30	2321-36
2321-42	2321-48

2322-30	2322-36
2322-42	2322-48

2325-30	2325-36
2325-42	2325-48

2326-30	2326-36
2326-42	2326-48

Corner Wall Cabinets

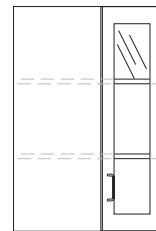
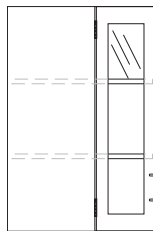
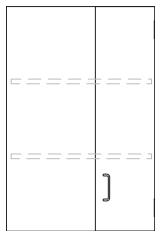
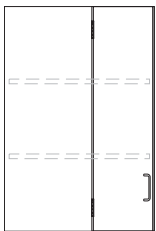

Plan View

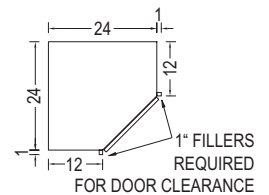

2311-24	
---------	--

2312-24	
---------	--

2315-24	
---------	--

2316-24	
---------	--

Wall Cabinets - 36" High, 16" Deep

Last two digits of catalog number indicate width.

Cabinet Key:		Cabinet Series	Style	Width
		L	O O O O	X X

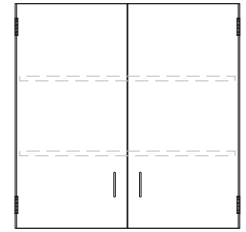
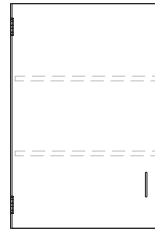
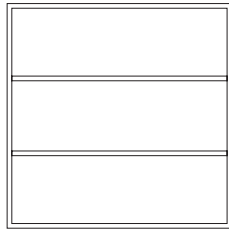
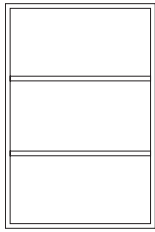

2330-15	2330-18
2330-21	2330-24

2330-30	2330-36
2330-42	2330-48

2331-15	2331-18
2331-21	2331-24

2332-15	2332-18
2332-21	2332-24

2333-30	2333-36
2333-42	2333-48

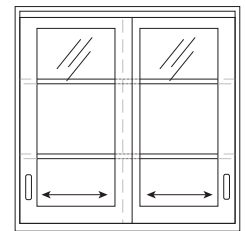
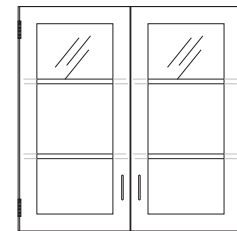
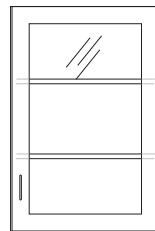
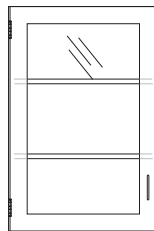
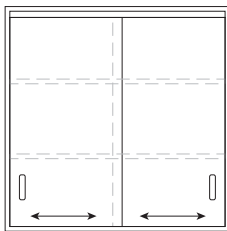

2334-30	2334-36
2334-42	2334-48

2335-15	2335-18
2335-21	2335-24

2336-15	2336-18
2336-21	2336-24

2337-30	2337-36
2337-42	2337-48

2338-30	2338-36
2338-42	2338-48

Corner Wall Cabinets

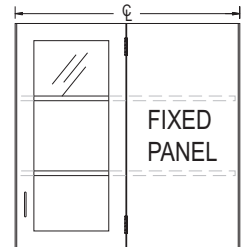
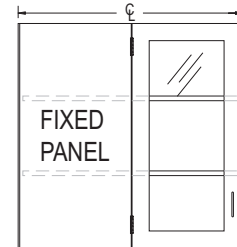
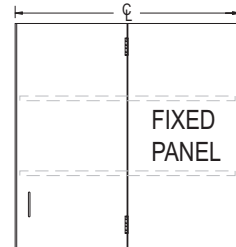
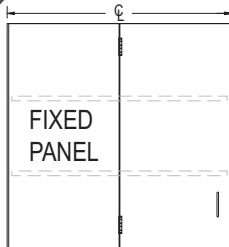
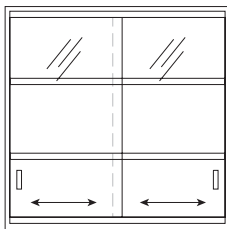

2339-30	2339-36
2339-42	2339-48

2351-30	2351-36
2351-42	2351-48

2352-30	2352-36
2352-42	2352-48

2355-30	2355-36
2355-42	2355-48

2356-30	2356-36
2356-42	2356-48

Corner Wall Cabinets

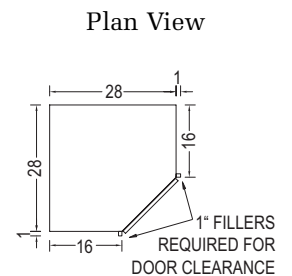
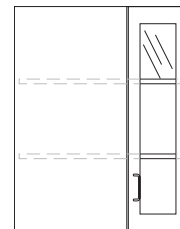
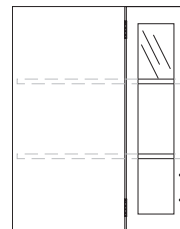
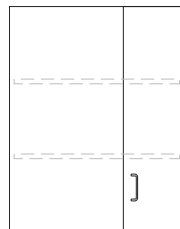
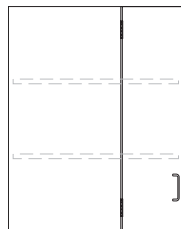

2341-28	
---------	--

2342-28	
---------	--

2345-28	
---------	--

2346-28	
---------	--

Wall Cabinets - 48" High, 12" Deep

Last two digits of catalog number indicate width.

Cabinet Key:

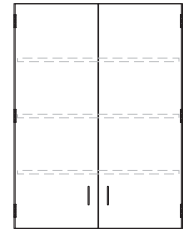
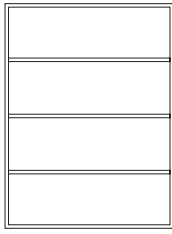
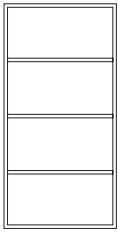
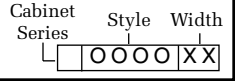

2400-15	2400-18
2400-21	2400-24

2400-30	2400-36
2400-42	2400-48

2401-15	2401-18
2401-21	2401-24

2402-15	2402-18
2402-21	2402-24

2403-30	2403-36
2403-42	2403-48

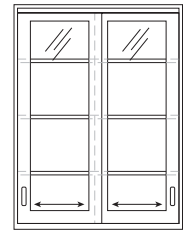
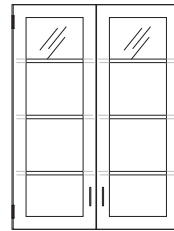
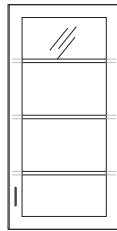
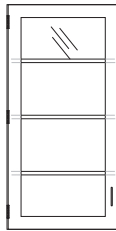
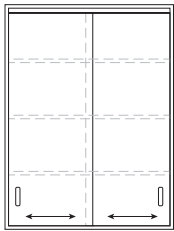

2404-30	2404-36
2404-42	2404-48

2405-15	2405-18
2405-21	2405-24

2406-15	2406-18
2406-21	2406-24

2407-30	2407-36
2407-42	2407-48

2408-30	2408-36
2408-42	2408-48

Corner Wall Cabinets

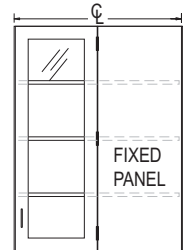
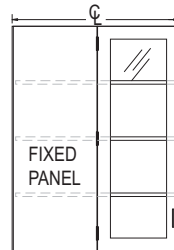
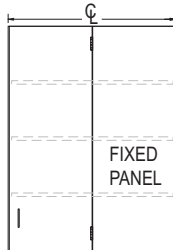
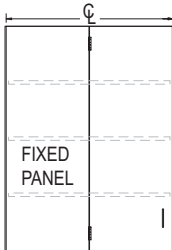
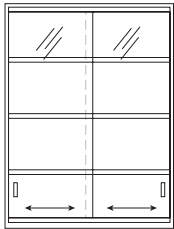

2409-30	2409-36
2409-42	2409-48

2421-30	2421-36
2421-42	2421-48

2422-30	2422-36
2422-42	2422-48

2425-30	2425-36
2425-42	2425-48

2426-30	2426-36
2426-42	2426-48

Corner Wall Cabinets

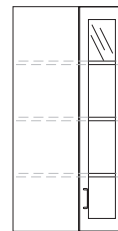
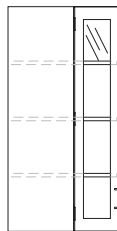

Plan View

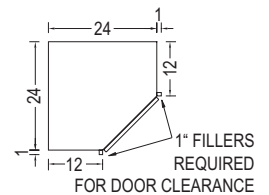

2411-24	
---------	--

2412-24	
---------	--

2415-24	
---------	--

2416-24	
---------	--

Wall Cabinets - 48" High, 16" Deep

Last two digits of catalog number indicate width.

Cabinet Key:		Cabinet Series	Style	Width
		L	O O O O	X X

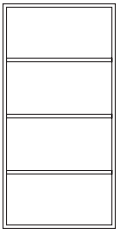

2430-15	2430-18
2430-21	2430-24



2430-30	2430-36
2430-42	2430-48



2431-15	2431-18
2431-21	2431-24



2432-15	2432-18
2432-21	2432-24

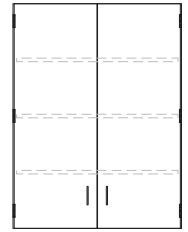

2433-30	2433-36
2433-42	2433-48

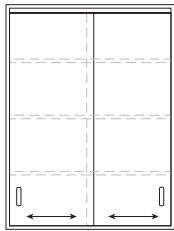

2434-30	2434-36
2434-42	2434-48

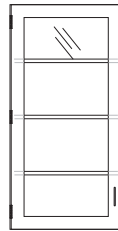

2435-15	2435-18
2435-21	2435-24

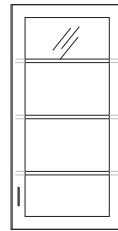

2436-15	2436-18
2436-21	2436-24

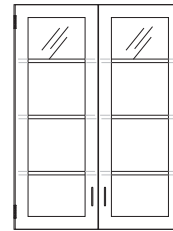

2437-30	2437-36
2437-42	2437-48

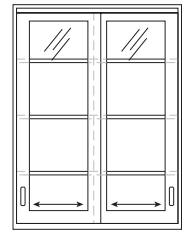

2438-30	2438-36
2438-42	2438-48

Corner Wall Cabinets

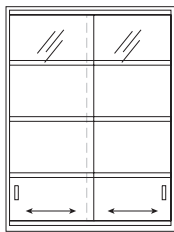

2439-30	2439-36
2439-42	2439-48

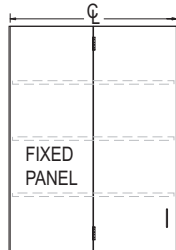

2451-30	2451-36
2451-42	2451-48

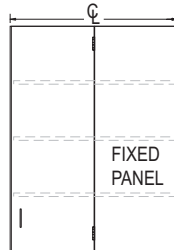

2452-30	2452-36
2452-42	2452-48

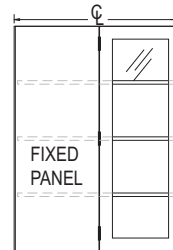

2455-30	2455-36
2455-42	2455-48

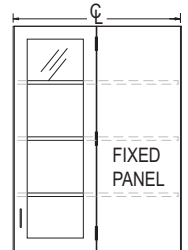

2456-30	2456-36
2456-42	2456-48

Corner Wall Cabinets

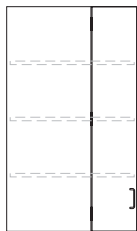

2441-28	
---------	--



2442-28	
---------	--

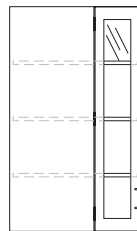

2445-28	
---------	--

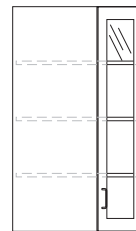

2446-28	
---------	--

Plan View

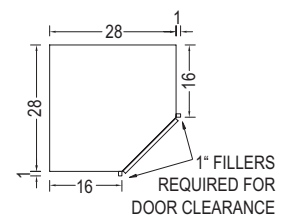

Tall Cabinets - 12" Deep

Last two digits of catalog number indicate width.

Cabinet Key:

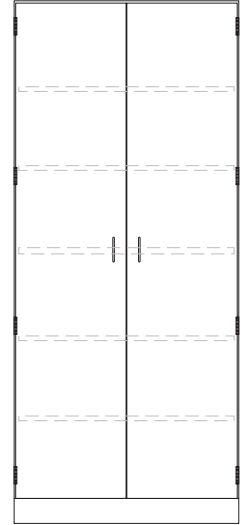
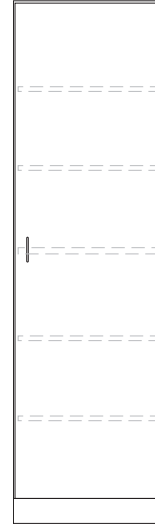
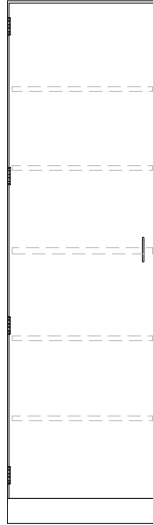
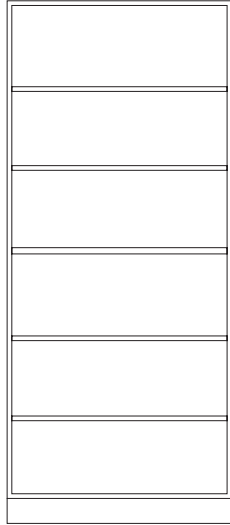
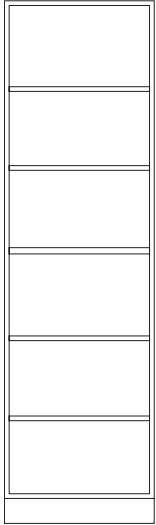
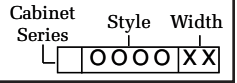

3560-15	3560-18
3560-21	3560-24

3560-30	3560-36
3560-42	3560-48

3561-15	3561-18
3561-21	3561-24

3562-15	3562-18
3562-21	3562-24

3563-30	3563-36
3563-42	3563-48

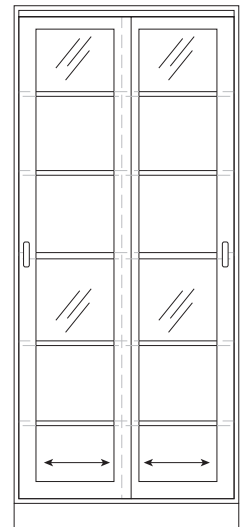
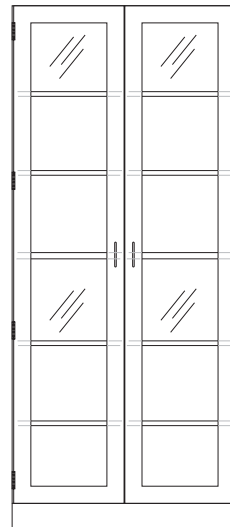
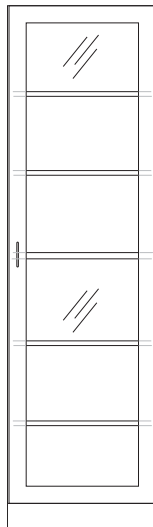
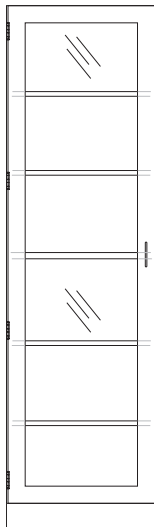
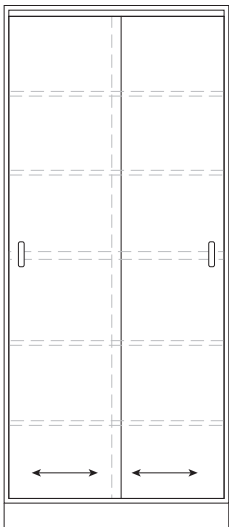

3564-30	3564-36
3564-42	3564-48

3565-15	3565-18
3565-21	3565-24

3566-15	3566-18
3566-21	3566-24

3567-30	3567-36
3567-42	3567-48

3568-30	3568-36
3568-42	3568-48

Tall Cabinets - 12" Deep

Last two digits of catalog number indicate width.

Cabinet Key:		
Cabinet Series	Style	Width
L	OOOO	XX

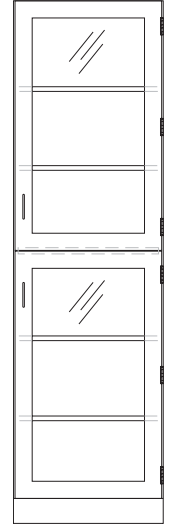
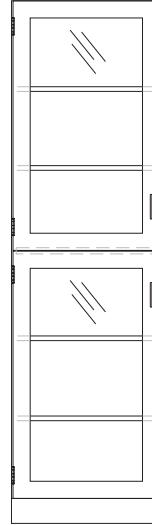
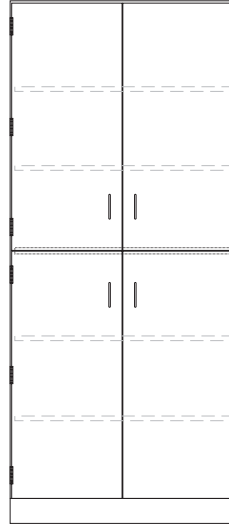
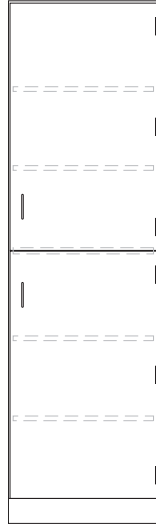
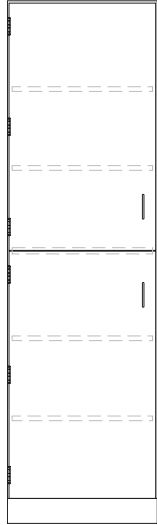

3661-15	3661-18
3661-21	3661-24

3662-30	3662-36
3662-42	3662-48

3663-30	3663-36
3663-42	3663-48

3665-15	3665-18
3665-21	3665-24

3666-15	3666-18
3666-21	3666-24

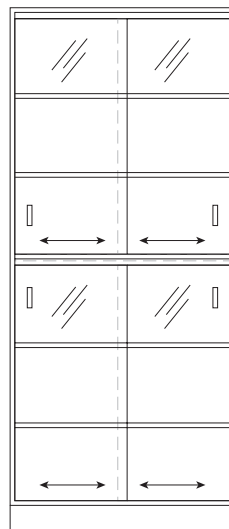
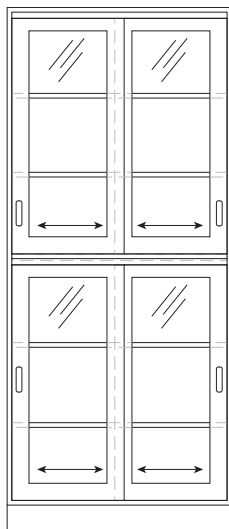
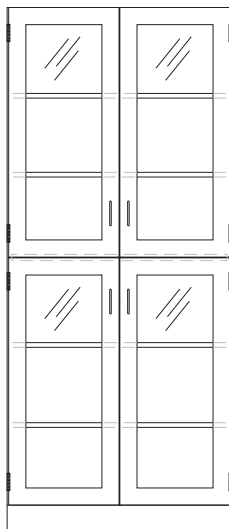

3667-30	3667-36
3667-42	3667-48

3668-30	3668-36
3668-42	3668-48

3669-30	3669-36
3669-42	3669-48

Tall Cabinets - 18" Deep

Last two digits of catalog number indicate width.

Cabinet Key:

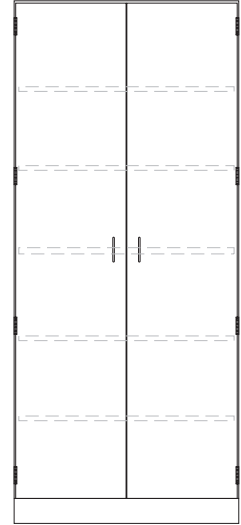
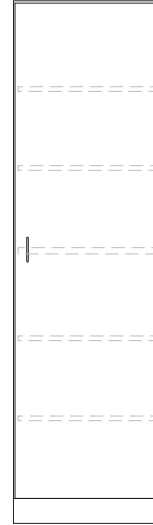
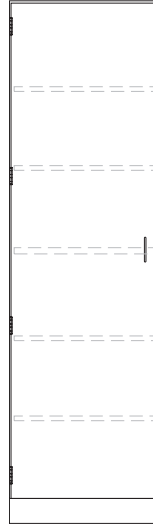
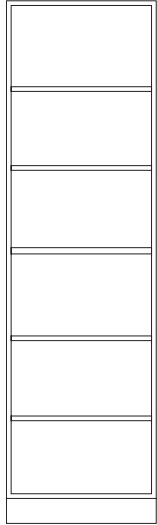
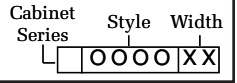

3570-15	3570-18
3570-21	3570-24

3570-30	3570-36
3570-42	3570-48

3571-15	3571-18
3571-21	3571-24

3572-15	3572-18
3572-21	3572-24

3573-30	3573-36
3573-42	3573-48

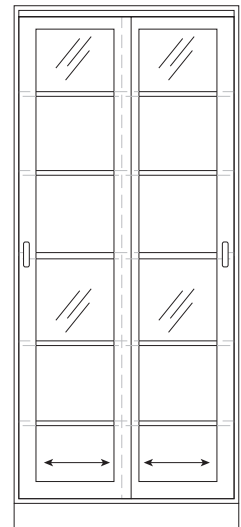
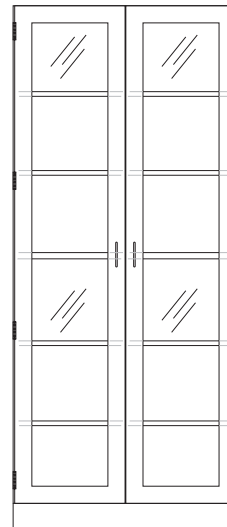
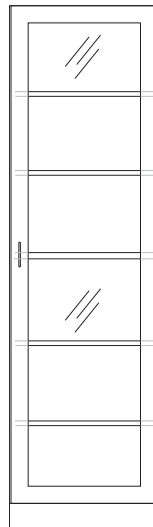
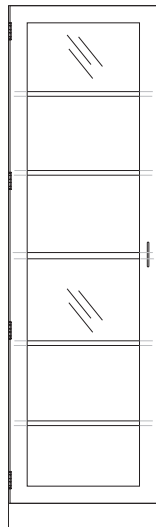
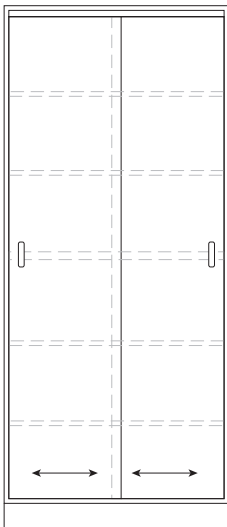

3574-30	3574-36
3574-42	3574-48

3575-15	3575-18
3575-21	3575-24

3576-15	3576-18
3576-21	3576-24

3577-30	3577-36
3577-42	3577-48

3578-30	3578-36
3578-42	3578-48

Tall Cabinets - 18" Deep

Last two digits of catalog number indicate width.

Cabinet Key:		
Cabinet Series	Style	Width
L	OOOO	XX

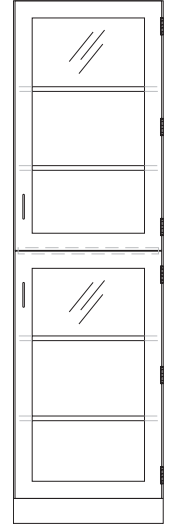
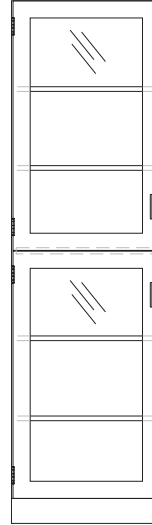
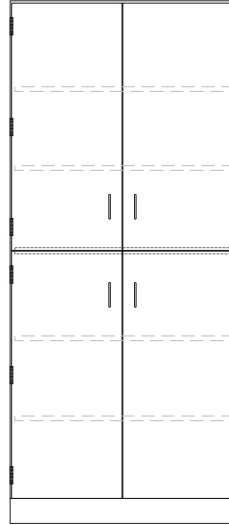
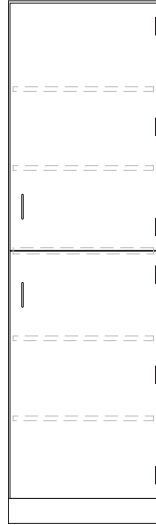
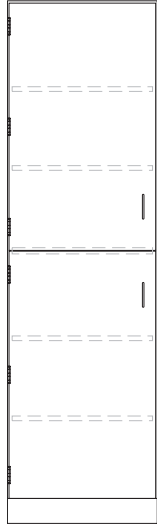

3671-15	3671-18
3671-21	3671-24

3672-30	3672-36
3672-42	3672-48

3673-30	3673-36
3673-42	3673-48

3675-15	3675-18
3675-21	3675-24

3676-15	3676-18
3676-21	3676-24

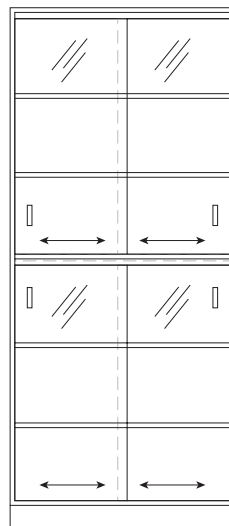
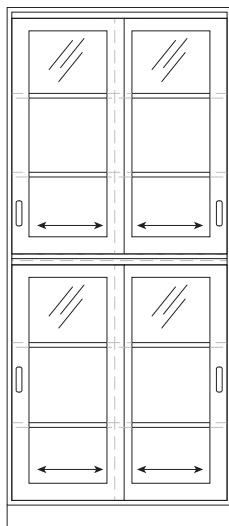
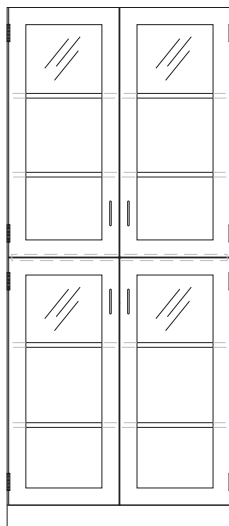

3677-30	3677-36
3677-42	3677-48

3678-30	3678-36
3678-42	3678-48

3679-30	3679-36
3679-42	3679-48

Tall Cabinets - 22" Deep

Last two digits of catalog number indicate width.

Cabinet Key:

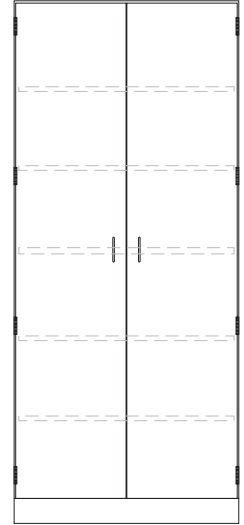
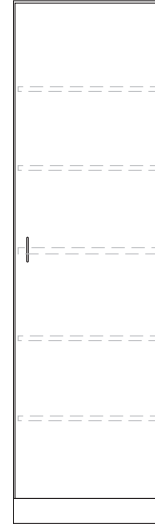
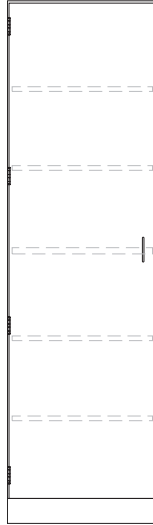
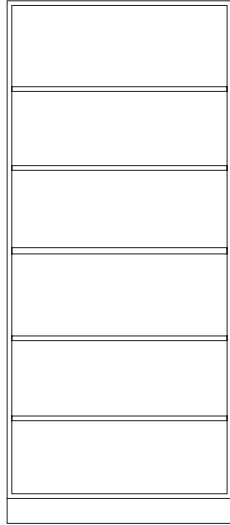
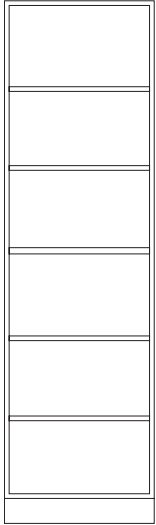
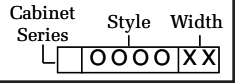

3580-15	3580-18
3580-21	3580-24

3580-30	3580-36
3580-42	3580-48

3581-15	3581-18
3581-21	3581-24

3582-15	3582-18
3582-21	3582-24

3583-30	3583-36
3583-42	3583-48

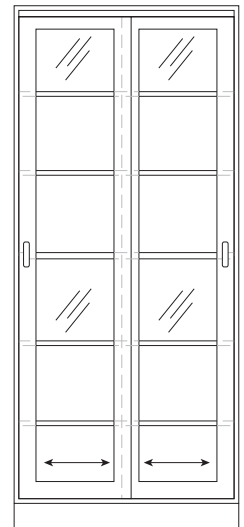
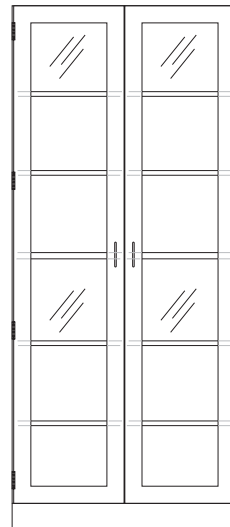
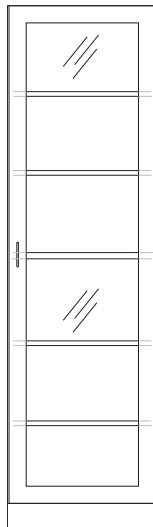
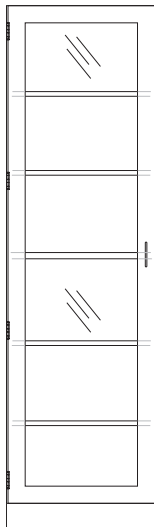
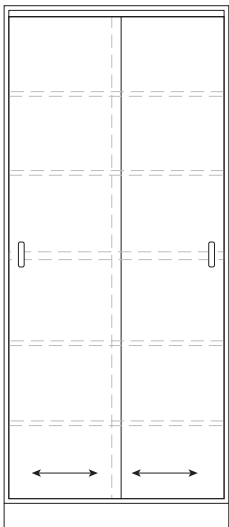

3584-30	3584-36
3584-42	3584-48

3585-15	3585-18
3585-21	3585-24

3586-15	3586-18
3586-21	3586-24

3587-30	3587-36
3587-42	3587-48

3588-30	3588-36
3588-42	3588-48

Tall Cabinets - 22" Deep

Last two digits of catalog number indicate width.

Cabinet Key:		
Cabinet Series	Style	Width
L	OOOO	XX

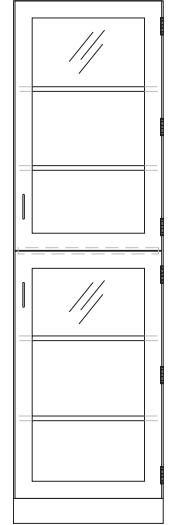
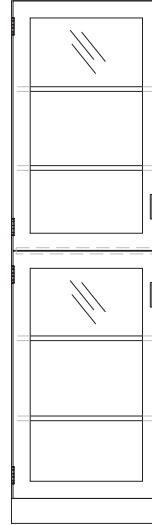
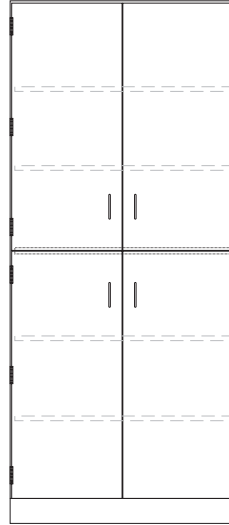
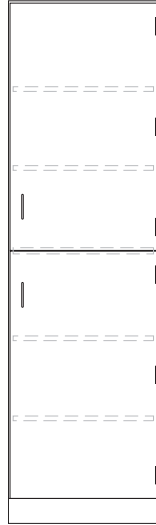
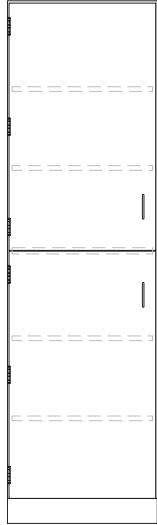

3681-15	3681-18
3681-21	3681-24

3682-30	3682-36
3682-42	3682-48

3683-30	3683-36
3683-42	3683-48

3685-15	3685-18
3685-21	3685-24

3686-15	3686-18
3686-21	3686-24

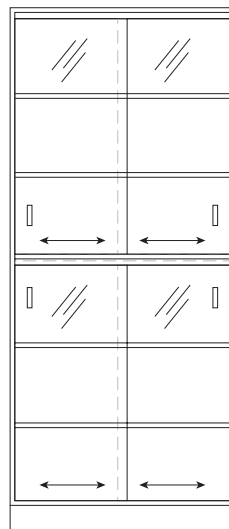
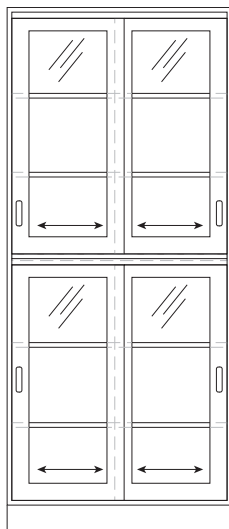
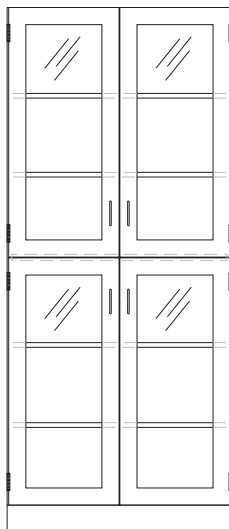

3687-30	3687-36
3687-42	3687-48

3688-30	3688-36
3688-42	3688-48

3689-30	3689-36
3689-42	3689-48

Table Frames

Last two digits of catalog number indicate width.
Work surfaces are not included.

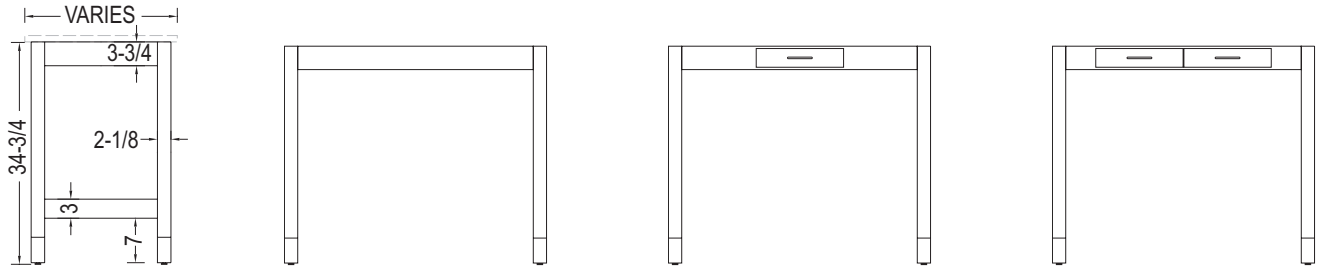
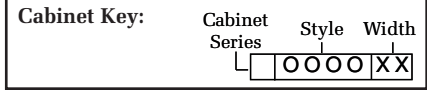

Standing Height

Depth	Width	No drawers	One drawer	Two drawers
22"	24"	4103-24	4113-24	
	30"	4103-30	4113-30	
	36"	4103-36	4113-36	
	42"	4103-42	4113-42	4123-42
	48"	4103-48		4123-48
	60"	4103-60		4123-60
	72"	4103-72		4123-72
28"	24"	4303-24	4313-24	
	30"	4303-30	4313-30	
	36"	4303-36	4313-36	
	42"	4303-42	4313-42	4323-42
	48"	4303-48		4323-48
	60"	4303-60		4323-60
	72"	4303-72		4323-72

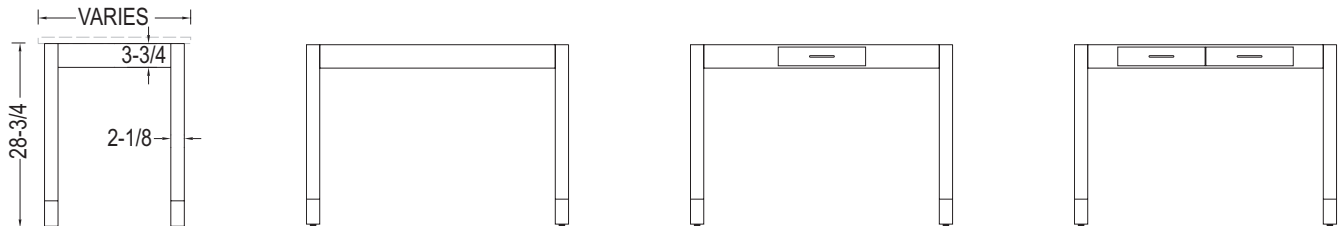

Sitting Height

Depth	Width	No drawers	One drawer	Two drawers
22"	24"	4003-24	4013-24	
	30"	4003-30	4013-30	
	36"	4003-36	4013-36	
	42"	4003-42	4013-42	4023-42
	48"	4003-48		4023-48
	60"	4003-60		4023-60
	72"	4003-72		4023-72
28"	24"	4203-24	4213-24	
	30"	4203-30	4213-30	
	36"	4203-36	4213-36	
	42"	4203-42	4213-42	4223-42
	48"	4203-48		4223-48
	60"	4203-60		4223-60
	72"	4203-72		4223-72

Table Frames

Last two digits of catalog number indicate width.
Work surfaces are not included.

Cabinet Key:			
Cabinet Series	Style	Width	
L	O O O O	X	X

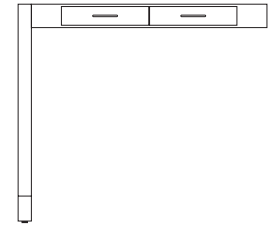
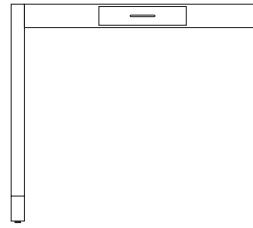
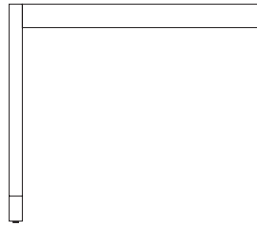
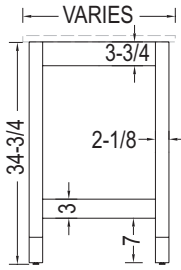

Standing Height

Depth	Width	No drawers	One drawer	Two drawers
22"	24"	4101-24	4111-24	
	30"	4101-30	4111-30	
	36"	4101-36	4111-36	
	42"	4101-42	4111-42	4121-42
	48"	4101-48		4121-48
	60"	4101-60		4121-60
	72"	4101-72		4121-72
28"	24"	4301-24	4311-24	
	30"	4301-30	4311-30	
	36"	4301-36	4311-36	
	42"	4301-42	4311-42	4321-42
	48"	4301-48		4321-48
	60"	4301-60		4321-60
	72"	4301-72		4321-72

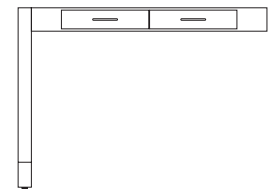
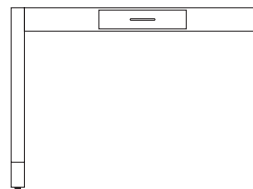
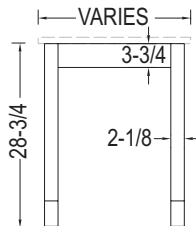

Sitting Height

Depth	Width	No drawers	One drawer	Two drawers
22"	24"	4001-24	4011-24	
	30"	4001-30	4011-30	
	36"	4001-36	4011-36	
	42"	4001-42	4011-42	4021-42
	48"	4001-48		4021-48
	60"	4001-60		4021-60
	72"	4001-72		4021-72
28"	24"	4201-24	4211-24	
	30"	4201-30	4211-30	
	36"	4201-36	4211-36	
	42"	4201-42	4211-42	4221-42
	48"	4201-48		4221-48
	60"	4201-60		4221-60
	72"	4201-72		4221-72

Table Frames

Last two digits of catalog number indicate width.
Work surfaces are not included.

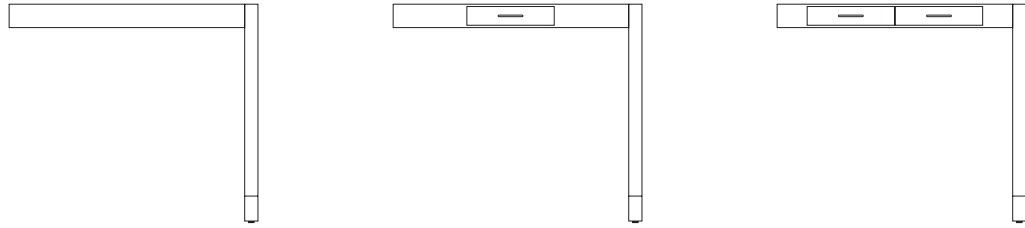
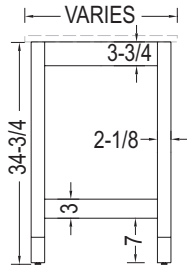

Standing Height

Depth	Width	No drawers	One drawer	Two drawers
22"	24"	4102-24	4112-24	
	30"	4102-30	4112-30	
	36"	4102-36	4112-36	
	42"	4102-42	4112-42	4122-42
	48"	4102-48		4122-48
	60"	4102-60		4122-60
	72"	4102-72		4122-72
28"	24"	4302-24	4312-24	
	30"	4302-30	4312-30	
	36"	4302-36	4312-36	
	42"	4302-42	4312-42	4322-42
	48"	4302-48		4322-48
	60"	4302-60		4322-60
	72"	4302-72		4322-72

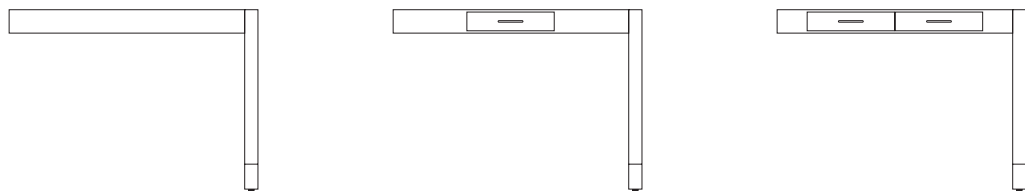
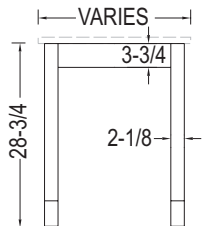

Sitting Height

Depth	Width	No drawers	One drawer	Two drawers
22"	24"	4002-24	4012-24	
	30"	4002-30	4012-30	
	36"	4002-36	4012-36	
	42"	4002-42	4012-42	4022-42
	48"	4002-48		4022-48
	60"	4002-60		4022-60
	72"	4002-72		4022-72
28"	24"	4202-24	4212-24	
	30"	4202-30	4212-30	
	36"	4202-36	4212-36	
	42"	4202-42	4212-42	4222-42
	48"	4202-48		4222-48
	60"	4202-60		4222-60
	72"	4202-72		4222-72

► Support Legs

Last two digits of catalog number indicate width.

Cabinet Key:	Cabinet Series	Style	Width
	L	0000	XX

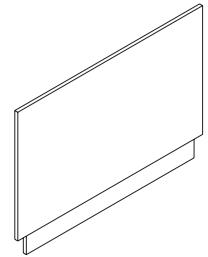
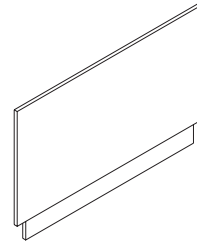
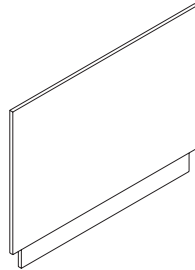

► Support Legs

Depth	Standing Height	Sitting Height	ADA Height
46"	GL36-46	GL30-46	GL33-46
52"	GL36-52	GL30-52	GL33-52
58"	GL36-58	GL30-58	GL33-58

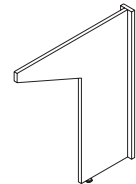
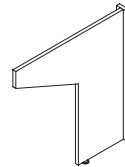
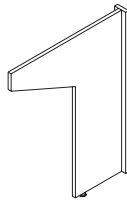

► Support Legs

Depth	Standing Height	Sitting Height	ADA Height
22"	SL36-22	SL30-22	SL33-22
23"	SL36-23	SL30-23	SL33-23
29"	SL36-29	SL30-29	SL33-29

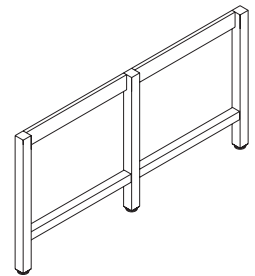
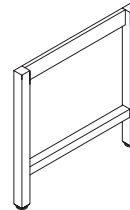
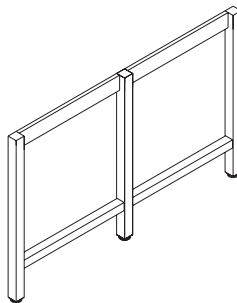
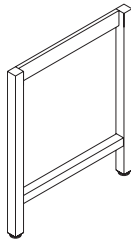

► Open Support Legs

Depth	Standing Height	Sitting Height
22"	HL36-22	HL30-22
23"	HL36-23	HL30-23
29"	HL36-29	HL30-29
35"	HL36-35	HL30-35
46"	HL36-46	HL30-46
52"	HL36-52	HL30-52
58"	HL36-58	HL30-58

► Knee Space & Support Panels

Last two digits of catalog number indicate width.

Cabinet Key:

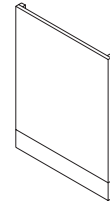
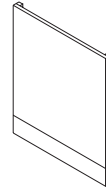
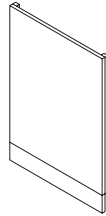
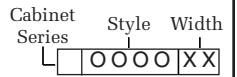

► Full Height Knee Space Panel

Width	Standing Height	Sitting Height	ADA Height
18"	K036-18	K030-18	K033-18
24"	K036-24	K030-24	K033-24
30"	K036-30	K030-30	K033-30
36"	K036-36	K030-36	K033-36
Knee Space Panel for Use with 4" Apron			
18"	K436-18	K430-18	K433-18
24"	K436-24	K430-24	K433-24
30"	K436-30	K430-30	K433-30
36"	K436-36	K430-36	K433-36
42"	K436-42	K430-42	K433-42
48"	K436-48	K430-48	K433-48
54"	K436-54	K430-54	K433-54
60"	K436-60	K430-60	K433-60
Knee Space Panel for Use with 2" Apron			
18"	K236-18	K230-18	K233-18
24"	K236-24	K230-24	K233-24
30"	K236-30	K230-30	K233-30
36"	K236-36	K230-36	K233-36
42"	K236-42	K230-42	K233-42
48"	K236-48	K230-48	K233-48
54"	K236-54	K230-54	K233-54
60"	K236-60	K230-60	K233-60

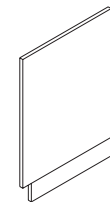
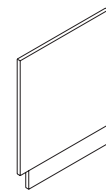
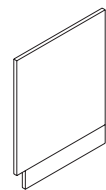

► Support Panel

Depth	Standing Height	Sitting Height	ADA Height
22"	GL36-22	GL30-22	GL33-22
23"	GL36-23	GL30-23	GL33-23
29"	GL36-29	GL30-29	GL33-29
35"	GL36-35	GL30-35	GL33-35
54"	GL36-54	GL30-54	GL33-54
60"	GL36-60	GL30-60	GL33-60

Aprons

Last two digits of catalog number indicate width.

Cabinet Key:		
Cabinet Series	Style	Width
L	OOOO	XX

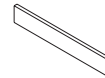

	Width			Width	
2" Front Rail	18"	R200-18	3-3/4" Front Rail	18"	R375-18
	24"	R200-24		24"	R375-24
	30"	R200-30		30"	R375-30
	36"	R200-36		36"	R375-36

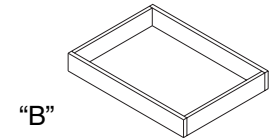
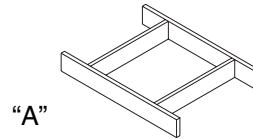
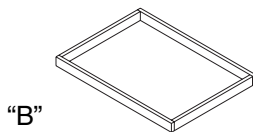
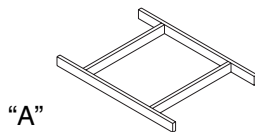

*Aprons	Width			Width	
2" High, 22" Deep	18"	ASN2-18 / BSN2-18	4" High, 22" Deep	18"	ASN4-18 / BSN4-18
	24"	ASN2-24 / BSN2-24		24"	ASN4-24 / BSN4-24
	30"	ASN2-30 / BSN2-30		30"	ASN4-30 / BSN4-30
	36"	ASN2-36 / BSN2-36		36"	ASN4-36 / BSN4-36
	42"	ASN2-42 / BSN2-42		42"	ASN4-42 / BSN4-42
	48"	ASN2-48 / BSN2-48		48"	ASN4-48 / BSN4-48
	54"	ASN2-54 / BSN2-54		54"	ASN4-54 / BSN4-54
	60"	ASN2-60 / BSN2-60		60"	ASN4-60 / BSN4-60
	Width			Width	
2" High, 28" Deep	18"	ADN2-18 / BDN2-18	4" High, 28" Deep	18"	ADN4-18 / BDN4-18
	24"	ADN2-24 / BDN2-24		24"	ADN4-24 / BDN4-24
	30"	ADN2-30 / BDN2-30		30"	ADN4-30 / BDN4-30
	36"	ADN2-36 / BDN2-36		36"	ADN4-36 / BDN4-36
	42"	ADN2-42 / BDN2-42		42"	ADN4-42 / BDN4-42
	48"	ADN2-48 / BDN2-48		48"	ADN4-48 / BDN4-48
	54"	ADN2-54 / BDN2-54		54"	ADN4-54 / BDN4-54
	60"	ADN2-60 / BDN2-60		60"	ADN4-60 / BDN4-60

*Apron part numbers beginning with "A" can be field modified. Apron part numbers beginning with "B" are box aprons, and cannot be field modified.

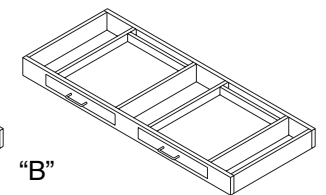
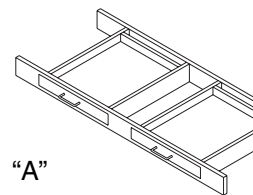
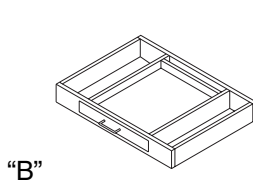
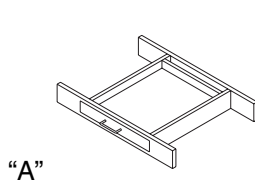

*Aprons	Width			Width	
4" High, 22" Deep					
One Drawer	24"	ASD4-24 / BSD4-24	Two Drawers	48"	ASD4-48 / BSD4-48
	30"	ASD4-30 / BSD4-30		54"	ASD4-54 / BSD4-54
	36"	ASD4-36 / BSD4-36		60"	ASD4-60 / BSD4-60
	42"	ASD4-42 / BSD4-42			

*Apron part numbers beginning with "A" can be field modified. Apron part numbers beginning with "B" are box aprons, and cannot be field modified.

► Fillers - Base Cabinet

Last two digits of catalog number indicate width.

Cabinet Key:	Cabinet Series	Style	Width
	L	0000	XX

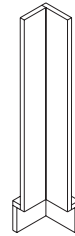

Standing Height	Width	Front w/Toekick	End (Rear)	Corner
	1"	FF36-01	RC36-01	CF36-01
	2"	FF36-02	RC36-02	CF36-02
	3"	FF36-03	RC36-03	CF36-03
	4"	FF36-04	RC36-04	CF36-04
	5"	FF36-05	RC36-05	CF36-05
	6"	FF36-06	RC36-06	CF36-06
	7"	FF36-07	RC36-07	
	8"	FF36-08	RC36-08	
	9"	FF36-09	RC36-09	
	10"	FF36-10	RC36-10	
	11"	FF36-11	RC36-11	
	12"	FF36-12	RC36-12	

Sitting Height	Width	Front w/Toekick	End (Rear)	Corner
	1"	FF30-01	RC30-01	CF30-01
	2"	FF30-02	RC30-02	CF30-02
	3"	FF30-03	RC30-03	CF30-03
	4"	FF30-04	RC30-04	CF30-04
	5"	FF30-05	RC30-05	CF30-05
	6"	FF30-06	RC30-06	CF30-06
	7"	FF30-07	RC30-07	
	8"	FF30-08	RC30-08	
	9"	FF30-09	RC30-09	
	10"	FF30-10	RC30-10	
	11"	FF30-11	RC30-11	
	12"	FF30-12	RC30-12	

ADA Height	Width	Front w/Toekick	End (Rear)	Corner
	1"	FF33-01	RC33-01	CF33-01
	2"	FF33-02	RC33-02	CF33-02
	3"	FF33-03	RC33-03	CF33-03
	4"	FF33-04	RC33-04	CF33-04
	5"	FF33-05	RC33-05	CF33-05
	6"	FF33-06	RC33-06	CF33-06
	7"	FF33-07	RC33-07	
	8"	FF33-08	RC33-08	
	9"	FF33-09	RC33-09	
	10"	FF33-10	RC33-10	
	11"	FF33-11	RC33-11	
	12"	FF33-12	RC33-12	

Fillers - Wall Cabinets

Last two digits of catalog number indicate width.

Cabinet Key:		
Cabinet Series	Style	Width
L	0000	XX

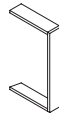

Front Fillers - 12" Deep Wall Cabinets

Width	24" High	30" High	36" High	48" High
1"	WF24-01	WF30-01	WF36-01	WF48-01
2"	WF24-02	WF30-02	WF36-02	WF48-02
3"	WF24-03	WF30-03	WF36-03	WF48-03
4"	WF24-04	WF30-04	WF36-04	WF48-04
5"	WF24-05	WF30-05	WF36-05	WF48-05
6"	WF24-06	WF30-06	WF36-06	WF48-06

Front Fillers - 16" Deep Wall Cabinets

Width	24" High	30" High	36" High	48" High
1"	DF24-01	DF30-01	DF36-01	DF48-01
2"	DF24-02	DF30-02	DF36-02	DF48-02
3"	DF24-03	DF30-03	DF36-03	DF48-03
4"	DF24-04	DF30-04	DF36-04	DF48-04
5"	DF24-05	DF30-05	DF36-05	DF48-05
6"	DF24-06	DF30-06	DF36-06	DF48-06

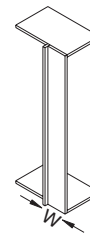
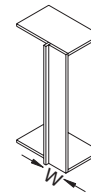
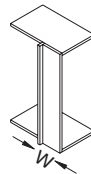
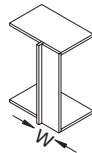

Corner Fillers - 12" Deep Wall Cabinets

Width	24" High	30" High	36" High	48" High
1"	WC24-01	WC30-01	WC36-01	WC48-01
2"	WC24-02	WC30-02	WC36-02	WC48-02
3"	WC24-03	WC30-03	WC36-03	WC48-03
4"	WC24-04	WC30-04	WC36-04	WC48-04
5"	WC24-05	WC30-05	WC36-05	WC48-05
6"	WC24-06	WC30-06	WC36-06	WC48-06

Corner Fillers - 16" Deep Wall Cabinets

Width	24" High	30" High	36" High	48" High
1"	DC24-01	DC30-01	DC36-01	DC48-01
2"	DC24-02	DC30-02	DC36-02	DC48-02
3"	DC24-03	DC30-03	DC36-03	DC48-03
4"	DC24-04	DC30-04	DC36-04	DC48-04
5"	DC24-05	DC30-05	DC36-05	DC48-05
6"	DC24-06	DC30-06	DC36-06	DC48-06

► Fillers - Tall Cabinets

Last two digits of catalog number indicate width.

Cabinet Key:	Cabinet Series	Style	Width
	L	OOOO	XX

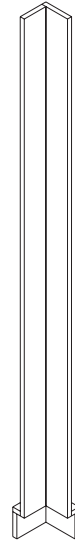

Width	Front w/Toekick	End (Rear)	Corner
1"	FF84-01	RC84-01	CF84-01
2"	FF84-02	RC84-02	CF84-02
3"	FF84-03	RC84-03	CF84-03
4"	FF84-04	RC84-04	CF84-04
5"	FF84-05	RC84-05	CF84-05
6"	FF84-06	RC84-06	CF84-06
7"	FF84-07	RC84-07	
8"	FF84-08	RC84-08	
9"	FF84-09	RC84-09	
10"	FF84-10	RC84-10	
11"	FF84-11	RC84-11	
12"	FF84-12	RC84-12	

► Shelving Systems - Fixed

Typical two-tier fixed reagent rack.

Size modifications are easily made to any of the parts below.

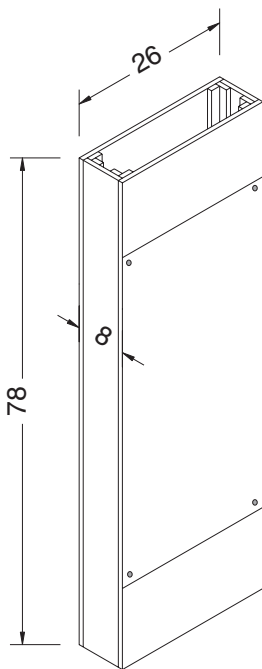
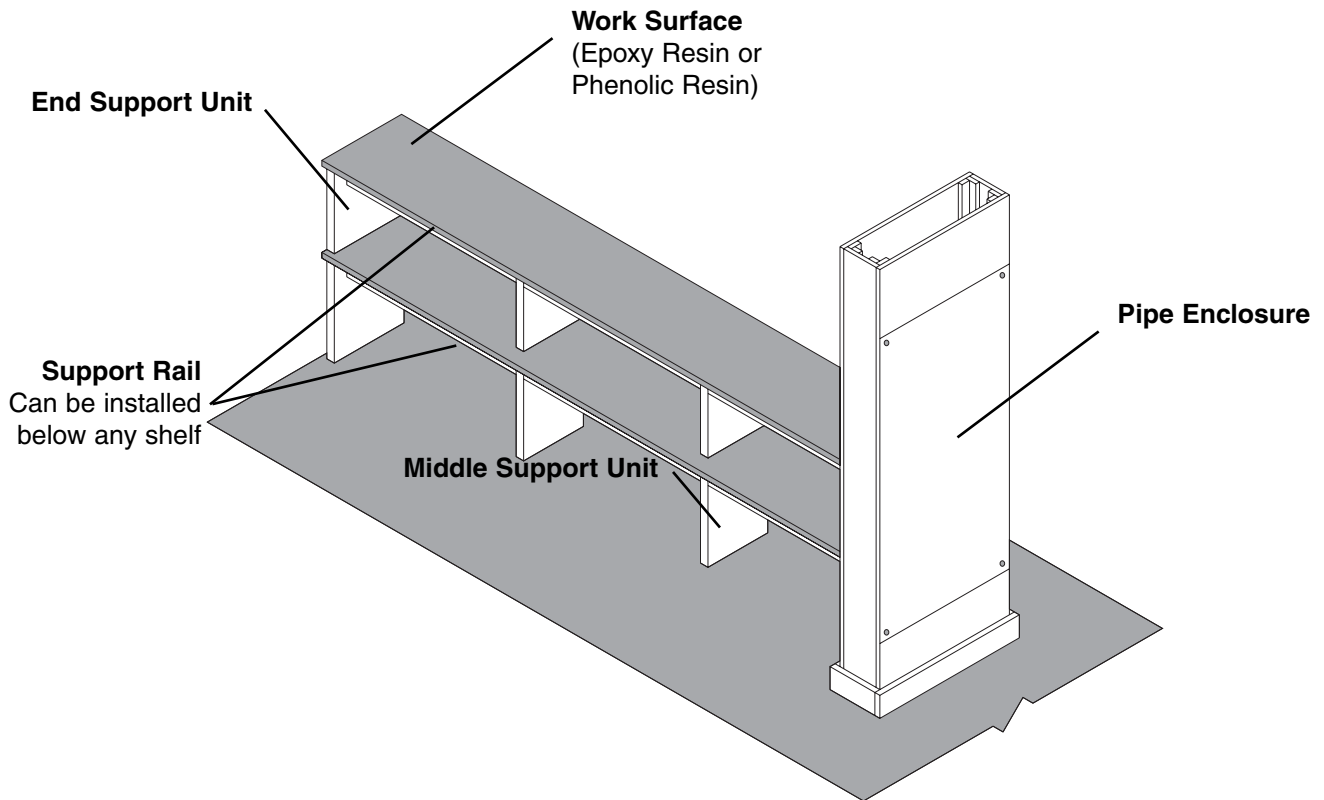

PE26-78

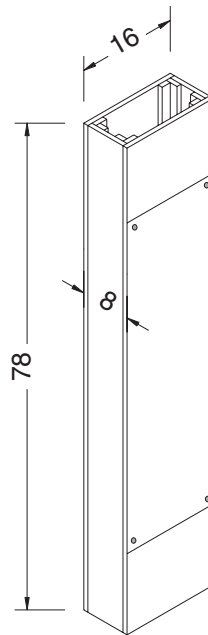

PE16-78

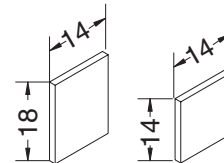

Dimensions	Part Number
End Support Unit	
14" H x 14" W x 1-1/2" Thick	RS14-14
18" H x 14" W x 1-1/2" Thick	RS14-18
Middle Support Unit	
14" H x 10" W x 1-1/2" Thick	RS10-14
18" H x 10" W x 1-1/2" Thick	RS10-18

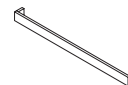

Support Rail (Specify Length)	Part Number
2" Rail	RA02-Length
3" Rail	RA03-Length

Shelving System - Adjustable

Typical two-tier adjustable reagent rack.
Size modifications are easily made to any of the parts below.

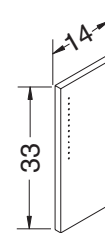
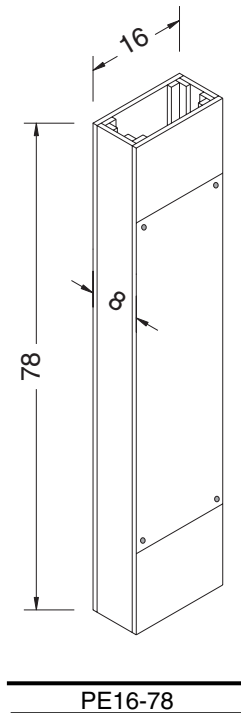
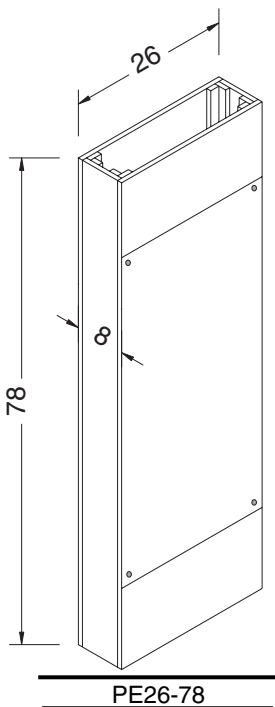
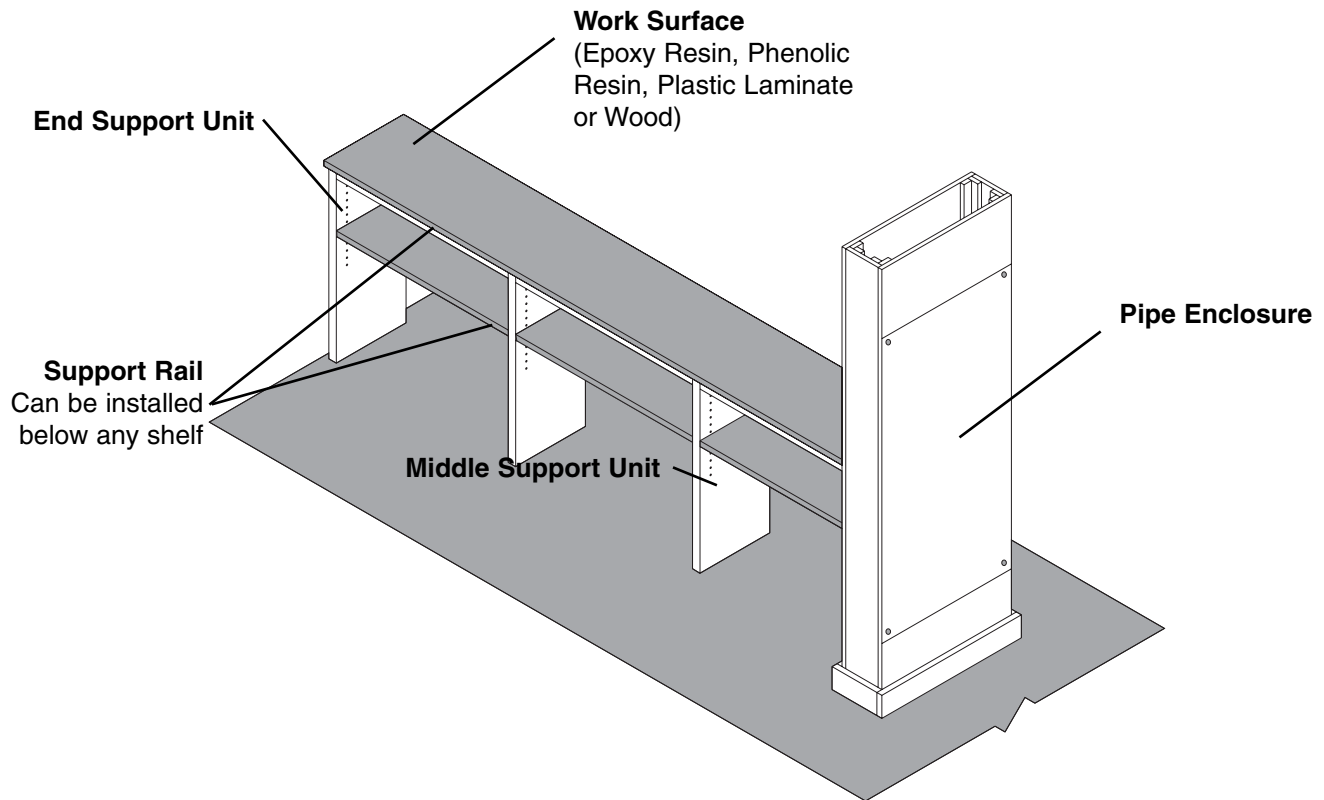

Dimensions	Part Number
End Support Unit	
33" H x 14" W x 1-1/2" Thick	AE14-33
Note: Holes punched in one side of panel	
Middle Support Unit	
33" H x 14" W x 1-1/2" Thick	AE10-33
Note: Holes punched in both sides of panel	

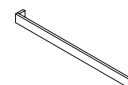

Support Rail (Specify Length)	
2" Rail	RA02-Length
3" Rail	RA03-Length

► Shelving System - Double Sided Adjustable

Typical double sided adjustable reagent rack.

Size modifications are easily made to any of the parts below.

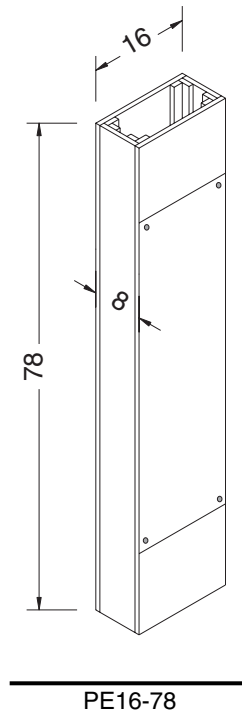
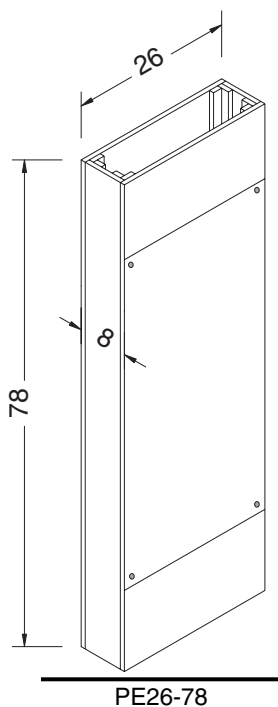
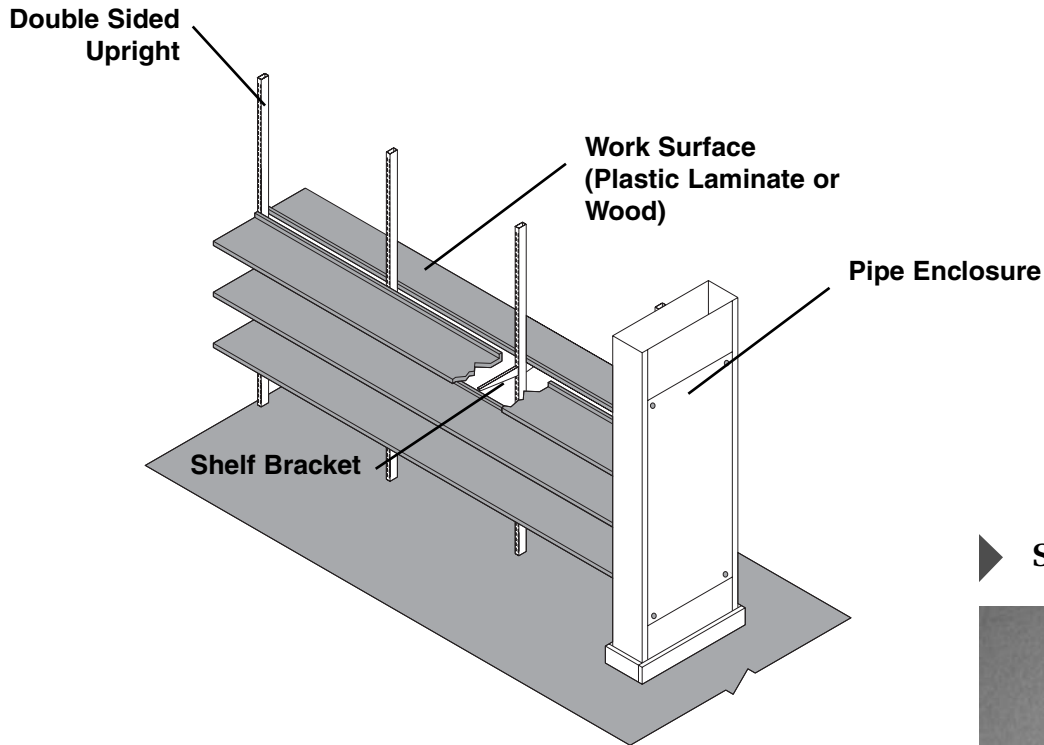

► Shelving Hardware

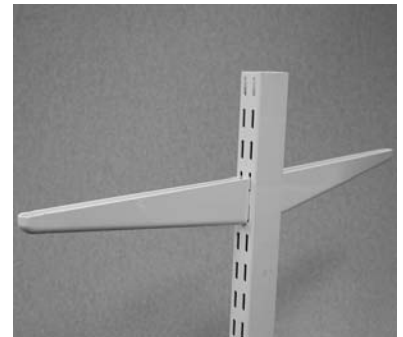

Part No.	Description
9003	12" Bracket
9967	118" x 2" x 2" Double Sided Upright



Part No.	Description
9979	Ceiling Fitting
9978	Adjustable Floor Fitting
9978M	Countertop Fitting

► Shelving System - Wall Mounted

Wall mounted shelving is an easy way to create accessible storage space either above a workstation or floor to ceiling.

► Wall Mounted Uprights

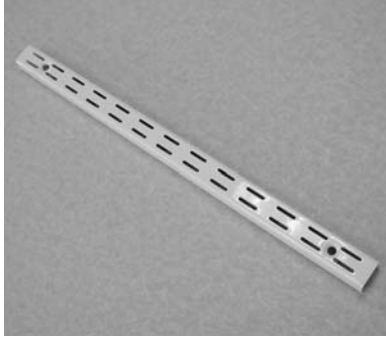

Part No.	Description
9010	6 3/4" Upright
9011	16 3/4" Upright
9012	28" Upright
9013	39 1/4" Upright
9014	48" Upright
9016	63" Upright
9018	78" Upright
9020	94 1/4" Upright

► Shelf Brackets



Part No.	Description
9001	5" Bracket
9002	7" Bracket
9002B	9" Bracket
9003	10 1/2" Bracket
9005	12 1/2" Bracket
9004	14 1/2" Bracket
9004B	14 1/2" Heavy Duty Bracket
9006	18 1/2" Heavy Duty Bracket
9021	24" Heavy Duty Bracket

► Bookend Brackets

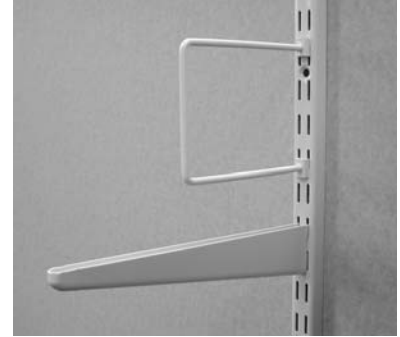

Part No.	Description
9085	6" Bookends (Pair)
9088	8" Bookends (Pair)

Note: Recommended spacing between uprights is no more than 30".

► Shelving Options

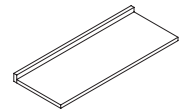
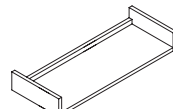
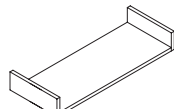
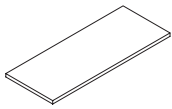

	Flat Shelf	Open Back & 4" Bookends	1" Raised Back & 4" Bookends	1" Raised Back
12" Wide				
	1224FS	1224BE	1224BB	1224RB
	1230FS	1230BE	1230BB	1230RB
	1236FS	1236BE	1236BB	1236RB
	1242FS	1242BE	1242BB	1242RB
	1248FS	1248BE	1248BB	1248RB
	1254FS	1254BE	1254BB	1254RB
	1260FS	1260BE	1260BB	1260RB
18" Wide				
	1824FS	1824BE	1824BB	1824RB
	1830FS	1830BE	1830BB	1830RB
	1836FS	1836BE	1836BB	1836RB
	1842FS	1842BE	1842BB	1842RB
	1848FS	1848BE	1848BB	1848RB
	1854FS	1854BE	1854BB	1854RB
	1860FS	1860BE	1860BB	1860RB

► Suggested Shelving Options

- 3/4" Plastic Laminate shelves with 3mm edgeband
- 3/4" Wood shelves with solid wood edgeband
- 3/4" Plastic Laminate shelves with 3mm edgeband and 4" bookends
- 3/4" Wood shelves with solid wood edgeband and 4" bookends

www.newenglandlab.com

▶ Student Science Assemblies

Assemblies shown are intended to provide an overview of basic laboratory and prep room concepts. We suggest you consult with a New England Lab representative to discuss any specific requirements or configurations.

▶ How To Configure Your Assembly

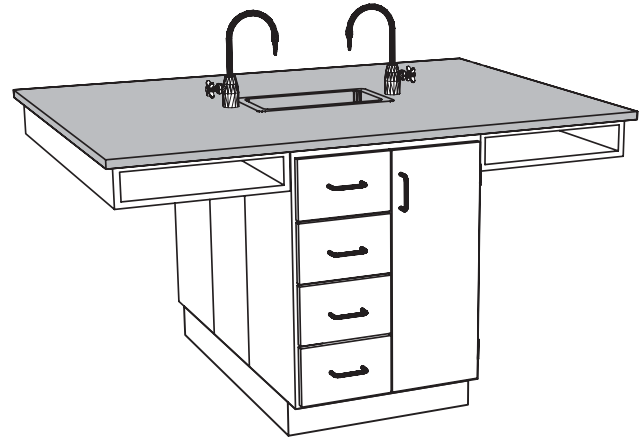
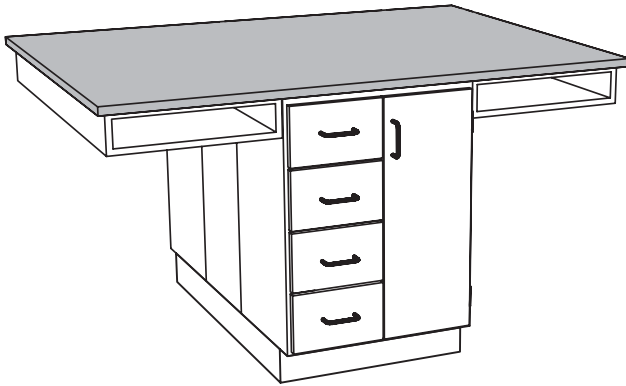

1. Choose the basic assembly that best fits your requirements (widths and depths can be customized on many assemblies).
2. Most assemblies can be specified in standing height (36"), ADA height (33") or sitting height (30").
3. Choose the appropriate casework components.
4. We offer a variety of work surfaces.
5. If required, sinks can be added. We offer a wide selection of plumbing fixtures specifically designed for laboratory environments.

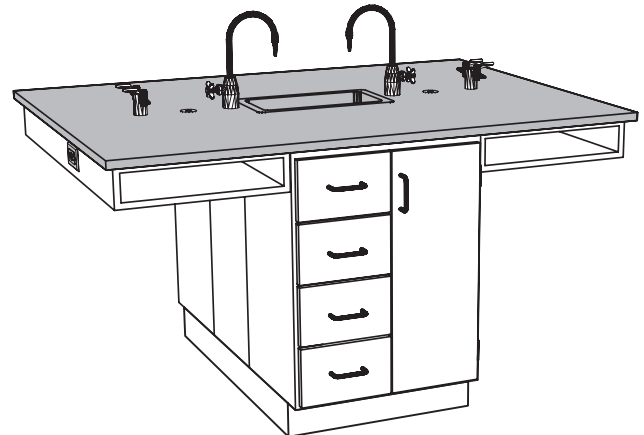
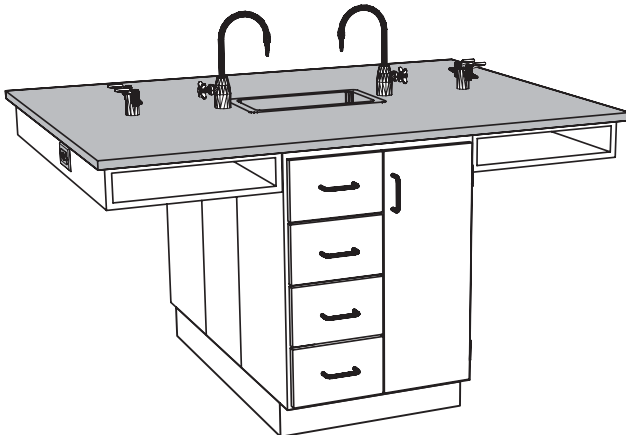

6. In addition to plumbing fixtures, electrical and data outlets can also be added.
7. Lab service turrets are also available.
8. Complete your assembly with accessories, such as apparatus rods, tote trays, etc.

▶ Student Science Assemblies

Assemblies shown are intended to provide an overview of basic laboratory and prep room concepts. We suggest you consult with a New England Lab representative to discuss any specific requirements or configurations.

▶ Two Student Workstations

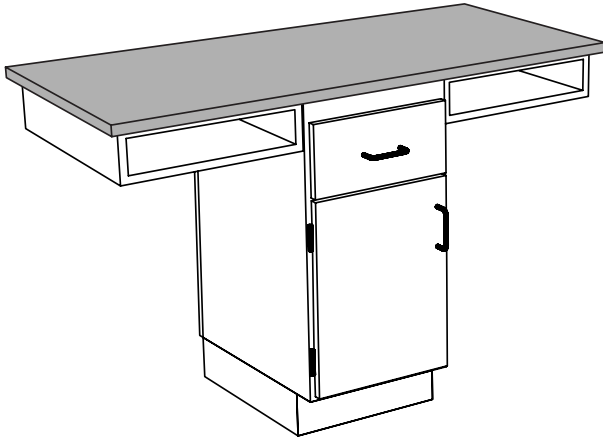

TA121 Traditional Two Student Workstation (36" High)
TA021 Traditional Two Student Workstation (30" High)
TA621 Traditional Two Student Workstation (33" High)

Standard assembly is 54" wide and can be ordered in 24" depth or 30" depth.

▶ Four Student Workstations

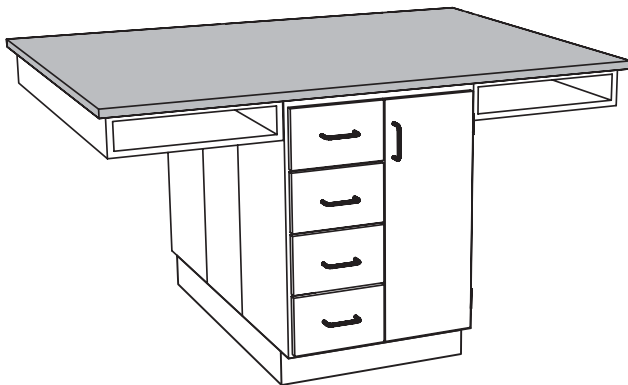

TA141 Traditional Four Student Workstation (36" High)
TA041 Traditional Four Student Workstation (30" High)
TA641 Traditional Four Student Workstation (33" High)

Standard assembly is 54" or 60" wide and 48" deep.

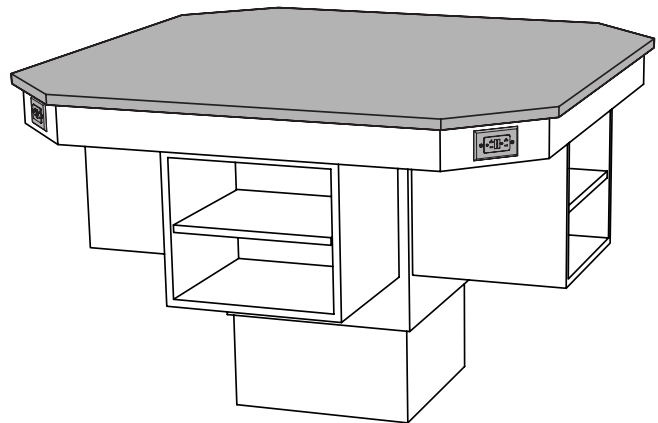

TA148 Traditional Four Student Pod (36" High)
TA048 Traditional Four Student Pod (30" High)
TA648 Traditional Four Student Pod (33" High)

Standard assembly is 56" wide and 56" deep.

▶ Student Science Assemblies

Assemblies shown are intended to provide an overview of basic laboratory and prep room concepts. We suggest you consult with a New England Lab representative to discuss any specific requirements or configurations.

▶ Four Student Peninsula Workstation

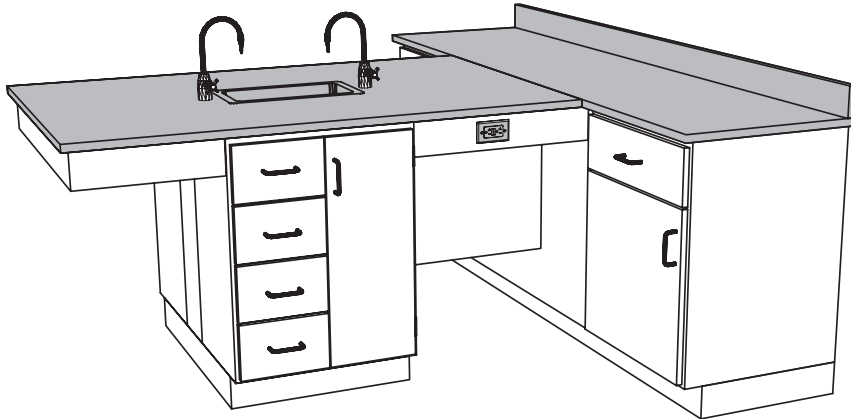

TA145 Four Student Peninsula with Wall Unit (36" High)

This assembly is available in many sizes and configurations.

▶ Six Student Workstations

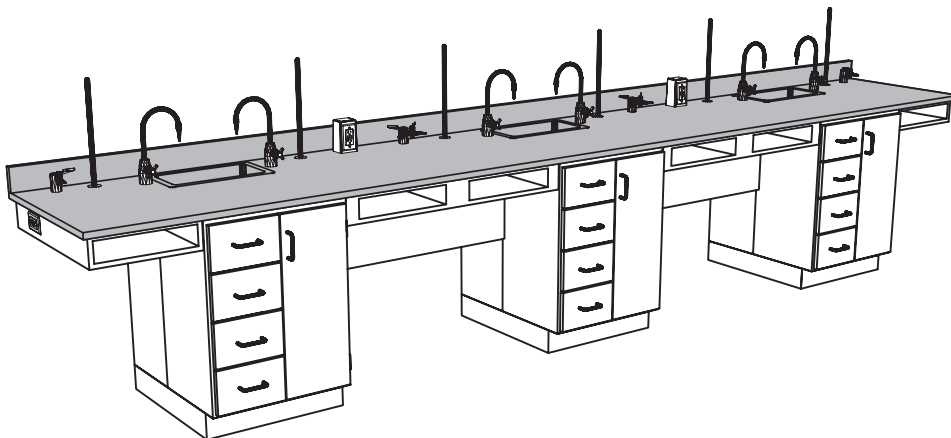

TA161 Six Student Workstation (36" High)

Standard assembly is 19'-6" wide and 30" deep.
Other sizes and configurations are available.

► Science Instructor Assemblies

Assemblies shown are intended to provide an overview of basic laboratory and prep room concepts. We suggest you consult with a New England Lab representative to discuss any specific requirements or configurations.

► Instructor's Bench



TA110 Instructor's Bench

Standard assembly is 74" wide, 30" deep, 36" high.

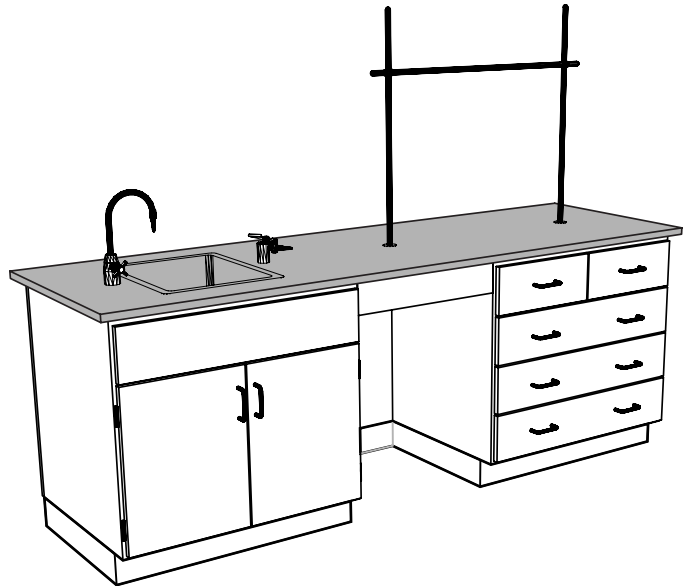

TA111 Instructor's Bench

Specific configurations and sizes are available.

► Desk Annex for Instructor's Bench

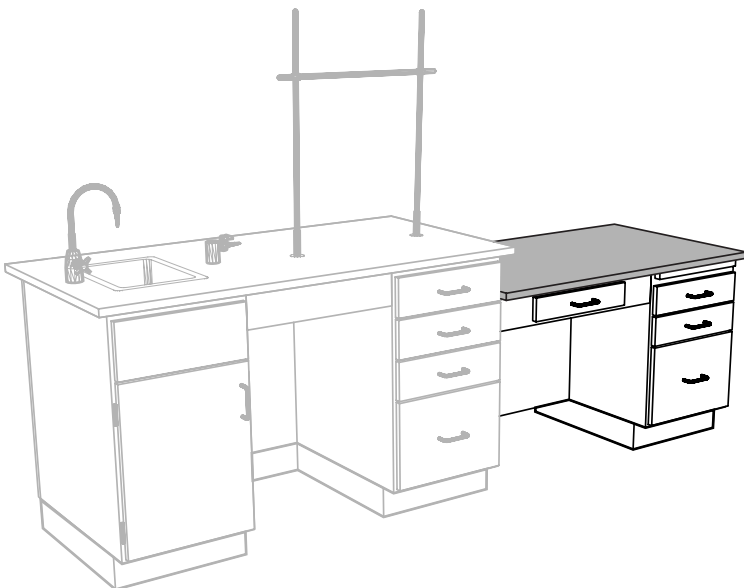

TA112 Desk Annex for Instructor's Bench

Standard assembly is 30" or 48" wide, 30" deep and 30" high.

www.newenglandlab.com