

# crafted with precision

## Cambridge Series Table Systems









# Navigate your way through our catalog

Tables are an excellent way to create a flexible furniture system. Designed with future flexibility, it can be configured and reconfigured as needed with storage and component accessories. The Cambridge Series Table System features several workstation styles, all constructed of heavy-duty welded steel. Workstations are available as stationary or mobile assemblies, as well as fixed or adjustable in height. The table system can be integrated into our furniture system or used as freestanding units. Cabinets, shelving, keyboard trays, outlets, and other accessories can be added to the workstations to meet a variety of needs.

## Colors & Finishes

Painted Steel Colors . . . . .	03
Stainless Steel Finishes . . . . .	03

BASE TABLES



The starter item when you build your component workstation.

Fixed Height H-Leg Tables . . . . .	04
Fixed Height C-Leg Tables . . . . .	05
Bolt Adjustable Height Tables . . . . .	06
Hydraulic Adjustable Height Tables . . . . .	07

## Base Table Work Surfaces

Work Surface Layout Options . . . . .	08
Work Surface Materials . . . . .	09

COMPONENTS

## Base Table Cabinets

Suspended Cabinets . . . . .	11
Cabinets on Leveling Glides. . . . .	12
Mobile Cabinets. . . . .	13

## Base Table Accessories

Casters . . . . .	14
Lower Shelving . . . . .	15-16
Modesty Panels. . . . .	17
Electrical Options . . . . .	18
Computer Accessories . . . . .	19

Look for our NEL Direct icon which signifies the products that are in our rapid ship program! (Steel: Warm Gray & Bright White, Tops: Black & Gray)





## OUTER BENCH ORGANIZATION SYSTEMS



Various add-on items for organization and storage on your adaptable workstation.

### Strut Shelving for Base Tables



Steel strut uprights are heavy duty and can be fastened to with strut hardware for a more industrial use.

Uprights, Book Stop Rails, Bookends & Electrical Assembly . . . . .	20
Flat Overhead Shelf Assembly . . . . .	21

### Slotted Shelving for Base Tables



Steel slotted uprights are medium duty and enclosed to allow for internal plumbing kits and a more aesthetic appearance.

Single Bay Frame, "Build Your Own" & Steel Shelf Assembly. . . . .	22
Double Bay Frame, "Build Your Own" & Steel Shelf Assembly . . . . .	23
Double Bay Shelf Assembly, Rear Lip & Bookends . . . . .	24
Power Strip Rail & Electrical Strip . . . . .	25

### Plumbing Kits & Fixtures for Slotted Shelving

Plumbing Kit, Service Panel Quick Connects & Needle Valves. . . . .	26
---	----

### Additional Overhead Base Tables Accessories

Task Lighting. . . . .	27
------------------------	----

### Rail System

Posts & Shelves . . . . .	28
Slatrail Accessories . . . . .	29-30

### Fixed System

Tubular Instrument Shelf. . . . .	31
-----------------------------------	----



## Color Selection Chart

			
Bright White 693226 	Cool White 601009	Warm White 691507	Warm Gray 601006 
			
Sandstone 601007	Linen 691822	Taupe 693190	Mocha 693191
			
Dove Gray 601008	Steel Gray 693185	Wine 691947	Sage Green 693173
			
Spruce Green 693183	Ice Blue 692273	Stone Blue 693186	Wedgewood Blue 691504
			
Brilliant Blue 693184	Majestic Blue 691948	Slate Blue 693657	Midnight Black 694417

## Stainless Steel Finishes

Type 304 - standard offering for its resistance to corrosives and its value.  
Type 316 - available when a higher level of corrosion resistance is needed.

\*All colors are quality controlled with micro-processor technology to ensure consistent color. Actual colors on steel products may vary slightly from the colors shown here. Please request an actual color sample prior to making a final color selection.



## TWA Series: 34-3/4" Standing Height Workstation



The TWA and TWC Series tables are strong and versatile. Their all-welded construction uses 16-gauge formed aprons, 2" square tubing, and welded bottom cross members to create a full perimeter frame. Micro adjusting levelers are standard and provide a stable work surface on uneven floors. Rear lower cross rail location is standard.

■ 4', 5', & 6' Tables support 1,000 pounds evenly distributed\*

■ Specify work surface, see page 09

■ The 8' Table supports 500 pounds evenly distributed\*

\* frame capacity includes work top and suspended accessories

Part Number	Work Surface Size	Frame Dimensions	Leg Support	Leg Type
TWA3228	36"W x 30"D	32"W x 36"H x 28"D	Levelers	Fixed
TWA4428	48"W x 30"D	44"W x 36"H x 28"D	Levelers	Fixed
TWA5628	60"W x 30"D	56"W x 36"H x 28"D	Levelers	Fixed
TWA6828	72"W x 30"D	68"W x 36"H x 28"D	Levelers	Fixed
TWA9228	96"W x 30"D	92"W x 36"H x 28"D	Levelers	Fixed
TWA3234	36"W x 36"D	32"W x 36"H x 34"D	Levelers	Fixed
TWA4434	48"W x 36"D	44"W x 36"H x 34"D	Levelers	Fixed
TWA5634	60"W x 36"D	56"W x 36"H x 34"D	Levelers	Fixed
TWA6834	72"W x 36"D	68"W x 36"H x 34"D	Levelers	Fixed
TWA9234	96"W x 36"D	92"W x 36"H x 34"D	Levelers	Fixed

Add option Code: -87 for locking swivel casters; steel frame height is shortened to accommodate casters and legs are reinforced for mobility

## TWC Series: 28-3/4" Sitting Height Workstation



Part Number	Work Surface Size	Frame Dimensions	Leg Support	Leg Type
TWC3228	36"W x 30"D	32"W x 30"H x 28"D	Levelers	Fixed
TWC4428	48"W x 30"D	44"W x 30"H x 28"D	Levelers	Fixed
TWC5628	60"W x 30"D	56"W x 30"H x 28"D	Levelers	Fixed
TWC6828	72"W x 30"D	68"W x 30"H x 28"D	Levelers	Fixed
TWC9228	96"W x 30"D	92"W x 30"H x 28"D	Levelers	Fixed
TWC3234	36"W x 36"D	32"W x 30"H x 34"D	Levelers	Fixed
TWC4434	48"W x 36"D	44"W x 30"H x 34"D	Levelers	Fixed
TWC5634	60"W x 36"D	56"W x 30"H x 34"D	Levelers	Fixed
TWC6834	72"W x 36"D	68"W x 30"H x 34"D	Levelers	Fixed
TWC9234	96"W x 36"D	92"W x 30"H x 34"D	Levelers	Fixed

Add option Code: -87 for locking swivel casters; steel frame height is shortened to accommodate casters and legs are reinforced for mobility

Images may depict products containing optional features. Work surfaces are purchased separately. See page 09 for part numbers.

\*Frame heights are nominal and are given for 1" thick counter top attached



## TEA Series: 34-3/4" Standing Height Workstation



The cantilevered design makes the TEA and TEC Series a perfect choice in applications requiring operator knee clearance beneath the work surface. Their all-welded construction uses 16-gauge formed aprons, 2" square tubing and welded bottom cross members. Micro adjusting levelers are standard and provide a stable work surface on uneven floors. Rear cross rail is required. Black plastic caps are used to finish tube ends.

■ 4', 5', & 6' Tables support 1,000 pounds evenly distributed\*

■ Specify work surface, see page 09

\* frame capacity includes work top and suspended accessories

Part Number	Work Surface Size	Frame Dimensions	Leg Support	Leg Type
TEA3228	36"W x 30"D	32"W x 36"H x 28"D	Levelers	Fixed
TEA4428	48"W x 30"D	44"W x 36"H x 28"D	Levelers	Fixed
TEA5628	60"W x 30"D	56"W x 36"H x 28"D	Levelers	Fixed
TEA6828	72"W x 30"D	68"W x 36"H x 28"D	Levelers	Fixed
TEA3234	36"W x 36"D	32"W x 36"H x 34"D	Levelers	Fixed
TEA4434	48"W x 36"D	44"W x 36"H x 34"D	Levelers	Fixed
TEA5634	60"W x 36"D	56"W x 36"H x 34"D	Levelers	Fixed
TEA6834	72"W x 36"D	68"W x 36"H x 34"D	Levelers	Fixed

Add option Code: -87 for locking swivel casters; steel frame height is shortened to accommodate casters and legs are reinforced for mobility

## TEC Series: 28-3/4" Sitting Height Workstation



Part Number	Work Surface Size	Frame Dimensions	Leg Support	Leg Type
TEC3228	36"W x 30"D	32"W x 30"H x 28"D	Levelers	Fixed
TEC4428	48"W x 30"D	44"W x 30"H x 28"D	Levelers	Fixed
TEC5628	60"W x 30"D	56"W x 30"H x 28"D	Levelers	Fixed
TEC6828	72"W x 30"D	68"W x 30"H x 28"D	Levelers	Fixed
TEC3234	36"W x 36"D	32"W x 30"H x 34"D	Levelers	Fixed
TEC4434	48"W x 36"D	44"W x 30"H x 34"D	Levelers	Fixed
TEC5634	60"W x 36"D	56"W x 30"H x 34"D	Levelers	Fixed
TEC6834	72"W x 36"D	68"W x 30"H x 34"D	Levelers	Fixed

Add option Code: -87 for locking swivel casters; steel frame height is shortened to accommodate casters and legs are reinforced for mobility

Images may depict products containing optional features. Work surfaces are purchased separately. See page 09 for part numbers.

\*Frame heights are nominal and are given for 1" thick counter top attached



## TOD Series: Adjustable Height Workstation with Levelers & Casters



The Cambridge TOD/TAD Series Tables have fully welded frames and have been designed for maximum lab adaptability. With rugged dual-bolt height adjustments which range between 30" and 39" these tables deliver the best in stability or mobility. Rear lower cross rail location is standard.

- 4', 5', & 6' Tables support 1,000 pounds evenly distributed\*
  - The 8' Table supports 500 pounds evenly distributed\*
  - Casters and levelers are interchangeable at any time. Please specify original setup
  - Specify work surface, see page 09
- \* frame capacity includes work top and suspended accessories

	Part Number	Work Surface Size	Frame Dimensions	Leg Support	Leg Type
	TOD3228	36"W x 30"D	32"W x 30"-42"H* x 28"D	Casters	Dual-bolt Adjustable
	TOD4428	48"W x 30"D	44"W x 30"-42"H* x 28"D	Casters	Dual-bolt Adjustable
	TOD5628	60"W x 30"D	56"W x 30"-42"H* x 28"D	Casters	Dual-bolt Adjustable
	TOD6828	72"W x 30"D	68"W x 30"-42"H* x 28"D	Casters	Dual-bolt Adjustable
	TOD9228	96"W x 30"D	92"W x 30"-42"H* x 28"D	Casters	Dual-bolt Adjustable
			*43"H on casters		
	TOD3234	36"W x 36"D	32"W x 30"-42"H x 34"D	Casters	Dual-bolt Adjustable
	TOD4434	48"W x 36"D	44"W x 30"-42"H x 34"D	Casters	Dual-bolt Adjustable
	TOD5634	60"W x 36"D	56"W x 30"-42"H x 34"D	Casters	Dual-bolt Adjustable
	TOD6834	72"W x 36"D	68"W x 30"-42"H x 34"D	Casters	Dual-bolt Adjustable
	TOD9234	96"W x 36"D	92"W x 30"-42"H x 34"D	Casters	Dual-bolt Adjustable

## TAD Series: Adjustable Height Workstation with Levelers Only



- Caster kit may be ordered at a future date for conversion to mobile if required. (TOD Conversion)

	Part Number	Work Surface Size	Frame Dimensions	Leg Support	Leg Type
	TAD3228	36"W x 30"D	32"W x 25"-37"H x 28"D	Levelers	Dual-bolt Adjustable
	TAD4428	48"W x 30"D	44"W x 25"-37"H x 28"D	Levelers	Dual-bolt Adjustable
	TAD5628	60"W x 30"D	56"W x 25"-37"H x 28"D	Levelers	Dual-bolt Adjustable
	TAD6828	72"W x 30"D	68"W x 25"-37"H x 28"D	Levelers	Dual-bolt Adjustable
	TAD9228	96"W x 30"D	92"W x 25"-37"H x 28"D	Levelers	Dual-bolt Adjustable
	TAD3234	36"W x 36"D	32"W x 25"-37"H x 34"D	Levelers	Dual-bolt Adjustable
	TAD4434	48"W x 36"D	44"W x 25"-37"H x 34"D	Levelers	Dual-bolt Adjustable
	TAD5634	60"W x 36"D	56"W x 25"-37"H x 34"D	Levelers	Dual-bolt Adjustable
	TAD6834	72"W x 36"D	68"W x 25"-37"H x 34"D	Levelers	Dual-bolt Adjustable
	TAD9234	96"W x 36"D	92"W x 25"-37"H x 34"D	Levelers	Dual-bolt Adjustable

Images may depict products containing optional features. Work surfaces are purchased separately. See page 09 for part numbers.

\*Frame heights are nominal and are given for 1" thick counter top attached



## TWD Series: Hydraulic Hand Crank Workstation



Designed with hydraulic leveling technology, our TWD Series enables positive height adjustment with the simple turn of a handle. Elastomer floor contacts ensure strong, steady and level operation in the most demanding applications. Note: 13" height adjustment range is standard from 30" to 43" high. TWE series features a push button electric motor.

- 4', 5', & 6' Tables support 1,000 pounds evenly distributed\*
- The 8' Table supports 500 pounds evenly distributed\*
- Specify work surface, see page 09
- \* frame capacity includes work top and suspended accessories

Part Number	Work Surface Size	Frame Dimensions	Leg Support	Leg Type
TWD3228	36"W x 30"D	32"W x 29-3/4"-42-3/4"H x 28"D	Levelers	Hydraulic Hand Crank
TWD4428	48"W x 30"D	44"W x 29-3/4"-42-3/4"H x 28"D	Levelers	Hydraulic Hand Crank
TWD5628	60"W x 30"D	56"W x 29-3/4"-42-3/4"H x 28"D	Levelers	Hydraulic Hand Crank
TWD6828	72"W x 30"D	68"W x 29-3/4"-42-3/4"H x 28"D	Levelers	Hydraulic Hand Crank
TWD3234	36"W x 36"D	32"W x 29-3/4"-42-3/4"H x 34"D	Levelers	Hydraulic Hand Crank
TWD4434	48"W x 36"D	44"W x 29-3/4"-42-3/4"H x 34"D	Levelers	Hydraulic Hand Crank
TWD5634	60"W x 36"D	56"W x 29-3/4"-42-3/4"H x 34"D	Levelers	Hydraulic Hand Crank
TWD6834	72"W x 36"D	68"W x 29-3/4"-42-3/4"H x 34"D	Levelers	Hydraulic Hand Crank

## TWE Series: Hydraulic Electric Motor Workstation



- 6' power cord

Part Number	Work Surface Size	Frame Dimensions	Leg Support	Leg Type
TWE3228	36"W x 30"D	32"W x 29-3/4"-42-3/4"H x 28"D	Levelers	Hydraulic Electric Motor
TWE4428	48"W x 30"D	44"W x 29-3/4"-42-3/4"H x 28"D	Levelers	Hydraulic Electric Motor
TWE5628	60"W x 30"D	56"W x 29-3/4"-42-3/4"H x 28"D	Levelers	Hydraulic Electric Motor
TWE6828	72"W x 30"D	68"W x 29-3/4"-42-3/4"H x 28"D	Levelers	Hydraulic Electric Motor
TWE3234	36"W x 36"D	32"W x 29-3/4"-42-3/4"H x 34"D	Levelers	Hydraulic Electric Motor
TWE4434	48"W x 36"D	44"W x 29-3/4"-42-3/4"H x 34"D	Levelers	Hydraulic Electric Motor
TWE5634	60"W x 36"D	56"W x 29-3/4"-42-3/4"H x 34"D	Levelers	Hydraulic Electric Motor
TWE6834	72"W x 36"D	68"W x 29-3/4"-42-3/4"H x 34"D	Levelers	Hydraulic Electric Motor

Images may depict products containing optional features. Work surfaces are purchased separately. See page 09 for part numbers.

\*Frame heights are nominal and are given for 1" thick counter top attached



## Work Surface Layout Options

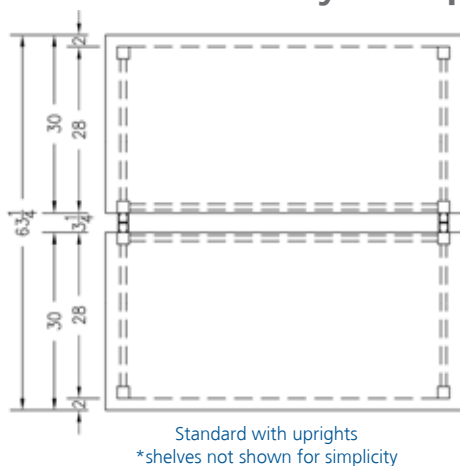

### STANDARD - 2" side overhangs, 2" front overhang, flush at rear

The standard counter top layout is designed so that shelving kits can be added or removed from the table without having to move the work top fastened to the frame. The rear of the top is secured flush with the rear of the table frame. When benches are mounted with shelf kits and are placed back to back, there will be a 3.25" gap between work surfaces, generally used as a cord pass through.

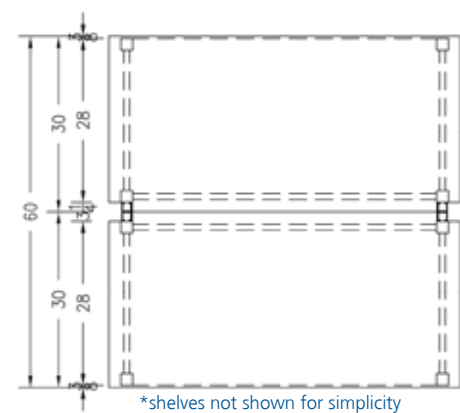
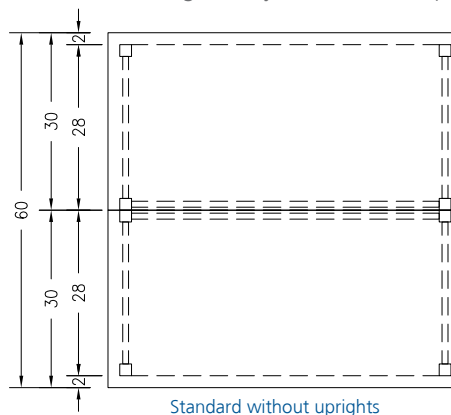

### NOTCHED - 2" side overhangs, .375" front overhang, 1.625" overhang at rear

The notched counter top layout can be selected to close the gap between back to back tables with shelving kits. This layout creates a continuous surface between uprights. We notch the corners for the shelf kit uprights and the 30" top moves back 1.625" on the frame leaving a .375" overhang at the front. The cost of notching is minimal.

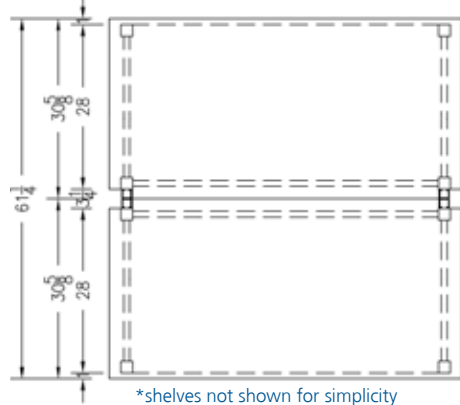

### NOTCHED & EXTENDED - 2" side overhangs, .375" front overhang, 1.625" overhang at rear

The notched and Extended counter top layout can be selected to close the gap between back to back tables and maintain the 1" overhang at the front. With this layout, we notch the corners for the shelf kit uprights and the work top is extended to 31.625" deep in order to keep the 1" overhang at the front. This selection may increase waste when optimizing material and therefore increase cost.

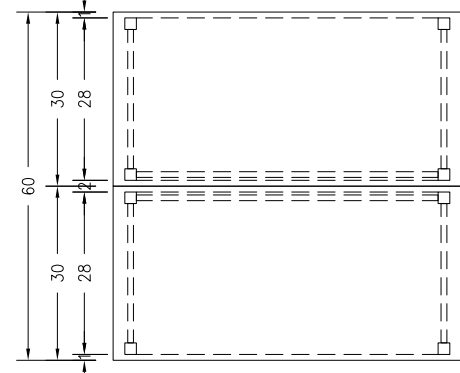

### ADJUSTED DEPTH - 2" side overhangs, 1" front overhang, 1" overhang at rear

If desired, tables without shelf kits can be set up with a 1" overhang on the front and the back. This would require removing and reinstalling the work top if shelving kits need to be added in the future.

#### \*ADJUSTED WIDTH –side overhangs can be specified .125" to 5"

Our side overhangs are sometimes adjusted to fit certain situations. For tables with casters we recommend our standard 2" overhang to allow for the caster swivel. For tables without casters we can reduce the overhang to a minimum of .125". Overhangs can be extended, but we recommend going no more than 4"-5" and these should be evaluated depending on the use of the table.







## Plastic Laminate Work Surface



Plastic laminate work surfaces are the economic choice for Cambridge Series base tables. It is constructed from medium density particle core, 0.050 high-pressure laminate, phenolic backer sheet, and a 3mm PVC edge treatment. This durable work surface is available in a wide selection of colors. Other edge treatments available.

\*ESD plastic laminate with grounding strap connection (PLE) and Fenix NTM scratch resistant self healing laminate (PLF) also available.





Part No.	Description
 PLM3036	36"W X 30"D
 PLM3048	48"W X 30"D
 PLM3060	60"W X 30"D
 PLM3072	72"W X 30"D
 PLM3096	96"W X 30"D
PLM3636	36"W X 36"D
PLM3648	48"W X 36"D
PLM3660	60"W X 36"D
PLM3672	72"W X 36"D
PLM3696	96"W X 36"D

## Epoxy Resin Work Surface



Epoxy resin work surfaces are the durable choice for Cambridge Series base tables. Epoxy resin is resistant to heat, stains, and the corrosive effects of most laboratory chemicals. The standard epoxy top is 1" black. Additional colors available.

- GRY = Gray
- DRKGRY = Graphite/Charcoal
- LGTGRY = Lunar White/Rock White
- KHK = Dark Khaki
- WHT = Brite White/Alpine White

Part No.	Description
 EPX3036	36"W X 30"D
 EPX3048	48"W X 30"D
 EPX3060	60"W X 30"D
 EPX3072	72"W X 30"D
 EPX3096	96"W X 30"D
EPX3636	36"W X 36"D
EPX3648	48"W X 36"D
EPX3660	60"W X 36"D
EPX3672	72"W X 36"D
EPX3696	96"W X 36"D





## Phenolic Resin Work Surface



Phenolic resin work surfaces are an outstanding choice to meet all of your laboratory needs. It is resistant to moisture, scratches and the corrosive effects of most laboratory chemicals. A variety of surface colors are available with a black edge/core.

\*Color-through phenolic also available.

- GRY = Silver Gray with black core
- SLTGRY = Slate Gray with black core
- WHT = White with black core

Part No.	Description
 PHN3036	36"W X 30"D
 PHN3048	48"W X 30"D
 PHN3060	60"W X 30"D
 PHN3072	72"W X 30"D
 PHN3096	96"W X 30"D
PHN3636	36"W X 36"D
PHN3648	48"W X 36"D
PHN3660	60"W X 36"D
PHN3672	72"W X 36"D
PHN3696	96"W X 36"D

## Stainless Steel Work Surface



Resistant to heat, stains and corrosives, stainless steel is easy to clean and can have a visual impact on your laboratory. It is constructed from 16-gauge type XXX stainless steel with a #4 brushed satin finish and features all metal hat channel supports. \*Work surface available with optional marine edge and backsplash.

\*Type 316 stainless steel is also available upon request.

SS4 = type 304 stainless steel

SS6 = type 316 stainless steel

Part No.	Description
SS?3036	36"W X 30"D
SS?3048	48"W X 30"D
SS?3060	60"W X 30"D
SS?3072	72"W X 30"D
SS?3096	96"W X 30"D
SS?3636	36"W X 36"D
SS?3648	48"W X 36"D
SS?3660	60"W X 36"D
SS?3672	72"W X 36"D
SS?3696	96"W X 36"D

Please contact your New England Lab representative for other sizes and custom configurations.





Suspended Cabinets



Cabinets on Leveling  
Glides



Cabinets on Casters

	PRICE	STORAGE SPACE	FLEXIBILITY ON HEIGHT ADJUSTABLE TABLES	EASE OF MOVEMENT
Suspended Cabinets	\$	★★★★★	✓	★★★★★
Cabinets on Levelers	\$\$	★★★★★	✗	★★★★★
Cabinets on Casters	\$\$\$	★★★★★	✗	★★★★★

In addition to use with the Cambridge Series tables, each type can be utilized and interchanged with Mott bench systems such as Optima, Altus and Sigma Flex systems.



## Suspended Painted Steel Cabinets



Cambridge Series base tables can accommodate a wide variety of suspended storage solutions. The 22" deep painted metal cabinets are available in three widths, two heights, and a range of drawer and door/drawer configurations. All suspended metal cabinets hang on pre-installed metal cross rails, allowing "no tool" installation and easy side-to-side relocation. All cabinets are supplied with finished backs. A wide range of colors are available from New England Lab's color chart.

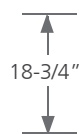

Part No.	Width
1960222-15	15"W
1160222-15	18"W
1260222-15	24"W



Part No.	Width
1960044-15	15"W
1160044-15	18"W
1260044-15	24"W



Part No.	Width
1960022-15	15"W
1160022-15	18"W
1260022-15	24"W



Part No.	Width
1960177-15	15"W
1160177-15	18"W
1260177-15	24"W



Part No.	Width
1950122-15	15"W
1150122-15	18"W
1250122-15	24"W



Part No.	Width
1950222-15	15"W
1150222-15	18"W
1250222-15	24"W



Part No.	Width
1950044-15	15"W
1150044-15	18"W
1250044-15	24"W



Part No.	Width
1950188-15	15"W
1150188-15	18"W
1250188-15	24"W



Part No.	Width
1950022-15	15"W
1150022-15	18"W
1250022-15	24"W



Part No.	Width
1950055-15	15"W
1150055-15	18"W
1250055-15	24"W

For maximum storage, wider models are available in four different widths, two heights, and a variety of drawer and door/drawer configurations. A wide range of colors are available from New England Lab's color chart.

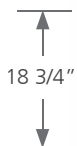

Part No.	Width
1360022-15	30"W
1460022-15	36"W
1860022-15	42"W
1560022-15	48"W



Part No.	Width
1350044-15	30"W
1450044-15	36"W
1850044-15	42"W
1550044-15	48"W



Part No.	Width
1350055-15	30"W
1450055-15	36"W
1850055-15	42"W
1550055-15	48"W



Part No.	Width
1350022-15	30"W
1450022-15	36"W
1850022-15	42"W
1550022-15	48"W

\*Cabinets are also available in wood veneer, phenolic resin and plastic laminate. Please contact your Account Representative for more information



## Painted Steel Cabinets on Glides



The Cambridge Series base tables accommodate a wide variety of storage solutions on leveling glides. The 22" deep painted metal cabinets are available in three widths, two heights, and a range of drawer and door/drawer configurations. All floor-mounted cabinets are supplied with finished tops and backs. A wide range of colors are available from New England Lab's color chart.

**PLEASE NOTE: the cabinets below fit under the following Cambridge Base Tables ONLY.**

**TWA, TEA and TOD Adjustable Height Table on Casters (set at 32"H+)**

\*standard refrigerators require 37"H tables

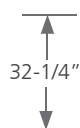

Part No.	Width
1980222-17-F2	15"W
1180222-17-F2	18"W
1280222-17-F2	24"W



Part No.	Width
1980055-17-F2	15"W
1180055-17-F2	18"W
1280055-17-F2	24"W



Part No.	Width
1980022-17-F2	15"W
1180022-17-F	18"W
1280022-17-F2	24"W



Part No.	Width
1980090-17-F2	15"W
1180090-17-F2	18"W
1280090-17-F2	24"W



Part No.	Width
1980044-17-F2	15"W
1180044-17-F2	18"W
1280044-17-F2	24"W

For maximum storage, wider models are available in four different widths, two heights, and a variety of drawer and door/drawer configurations. A wide range of colors are available from New England Lab's color chart.



Part No.	Width
1380022-17-F2	30"W
1480022-17-F2	36"W
1880022-17-F2	48"W



Part No.	Width
13800NN-17-F2	30"W
14800NN-17-F2	36"W
18800NN-17-F2	48"W

\*Cabinets are also available in wood veneer, phenolic resin and plastic laminate. Please contact your Account Representative for more information



## Painted Steel Cabinets on Casters



The Cambridge Series base tables accommodate a wide variety of mobile storage solutions. The 22" deep painted metal cabinets are available in three widths, two heights, and a range of drawer and door/drawer configurations. All mobile cabinets are supplied with finished tops and backs. A wide range of colors are available from New England Lab's color chart.

**PLEASE NOTE:** the cabinets below fit under all fixed sitting height, fixed standing height and adjustable height tables.



Part No.	Width
1920022-77-F2-H25.5	15"W
1120022-77-F2-H25.5	18"W
1220022-77-F2-H25.5	24"W



Part No.	Width
1920022-77-F2-H25.5	15"W
1120022-77-F2-H25.5	18"W
1220022-77-F2-H25.5	24"W



Part No.	Width
1920222-77-F2-H25.5	15"W
1120222-77-F2-H25.5	18"W
1220222-77-F2-H25.5	24"W



Part No.	Width
1920044-77-F2-H25.5	15"W
1120044-77-F2-H25.5	18"W
1220044-77-F2-H25.5	24"W



Part No.	Width
1980022-77-F2	15"W
1180022-77-F2	18"W
1280022-77-F2	24"W



Part No.	Width
1980100-77-F2	15"W
1180100-77-F2	18"W
1280100-77-F2	24"W



Part No.	Width
1980222-77-F2	15"W
1180222-77-F2	18"W
1280222-77-F2	24"W



Part No.	Width
1980090-77-F2	15"W
1180090-77-F2	18"W
1280090-77-F2	24"W

For maximum storage, wider models are available in three different widths, one height, and a variety of drawer and door/drawer configurations. A wide range of colors are available from New England Lab's color chart.

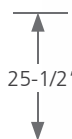

Part No.	Width
1320022-77-F2-H25.5	30"W
1420022-77-F2-H25.5	36"W
1520022-77-F2-H25.5	48"W



Part No.	Width
1320044-77-F2-H25.5	30"W
1420044-77-F2-H25.5	36"W
1520044-77-F2-H25.5	48"W

\*Cabinets are also available in wood veneer, phenolic resin and plastic laminate. Please contact your Account Representative for more information



## Locking Swivel Casters



Castors can be ordered with Cambridge Series base tables to create mobile workstations. Our standard 4" diameter by 1-1/4" thermoplastic rubber wheels provide smooth rolling on precision ball bearings. All casters are swivel type and include a dual-locking mechanism for locking both swivel and wheel. Capacity is 250 lb. per caster. Load height 5-13/32" with 4-7/6 swivel radius.

Option Part Number	Description
87	set of four casters

## Leveling Casters



Leveling casters can be ordered with most table. These casters are meant for minimal use and should always be set on the leveling pad when not moving. A red adjustment dial lifts the wheel off the ground to engage the leveling pad. Die-cast aluminum construction with ivory power-coated finish, black nylon wheel, 4" to 4-1/2" load height and max 1/2" of travel for leveling.

Option Part Number	Description
C33	set of four leveling casters



## Half Depth Lower Shelf



The lower shelf is manufactured to provide additional storage while allowing space for personnel to sit. At 1" thick, shelving depths are 12" deep on a 30" deep table and 16" deep on a 36" deep table. Center rail is required to prevent sagging.

### EPOXY SHELVES

Please specify color. Example: Gray

Work Surface Size	12" Deep Shelves on 30" Deep Tables	16" Deep Shelves on 36" Deep Tables
48"	EPX1248-HDS	EPX1648-HDS
60"	EPX1260-HDS	EPX1660-HDS
72"	EPX1272-HDS	EPX1672-HDS
96"	EPX1296-HDS	EPX1696-HDS

### WOOD SHELVES

3mm matching edgeband. Please specify grade, cut, species, and leaf match. Example: AA grade plain sliced Maple bookmatched veneer

Work Surface Size	12" Deep Shelves on 30" Deep Tables	16" Deep Shelves on 36" Deep Tables
48"	WD1248-HDS	WD1648-HDS
60"	WD1260-HDS	WD1660-HDS
72"	WD1272-HDS	WD1672-HDS
96"	WD1296-HDS	WD1696-HDS

### LAMINATE SHELVES

3mm matching edgeband if available. Please specify manufacturer, color name and number. Example: Wilsonart Black 1595-60

Work Surface Size	12" Deep Shelves on 30" Deep Tables	16" Deep Shelves on 36" Deep Tables
48"	PLM1248-HDS	PLM1648-HDS
60"	PLM1260-HDS	PLM1660-HDS
72"	PLM1272-HDS	PLM1672-HDS
96"	PLM1296-HDS	PLM1696-HDS

### PHENOLIC SHELVES

Black core beveled edge. Please specify manufacturer, phenolic grade and color name. Example: Trespa TopLab Plus Silver Grey. Available with color core.

Work Surface Size	12" Deep Shelves on 30" Deep Tables	16" Deep Shelves on 36" Deep Tables
48"	PHN1248-HDS	PHN1648-HDS
60"	PHN1260-HDS	PHN1660-HDS
72"	PHN1272-HDS	PHN1672-HDS
96"	PHN1296-HDS	PHN1696-HDS



## Full Depth Lower Shelf



The 1" thick, full depth lower shelf is manufactured for optimal storage. Center rail is required to prevent sagging.

### EPOXY SHELVES

Please specify color. Example: Gray

Work Surface Size	Shelf Size	Part Number	Work Surface Size	Shelf Size	Part Number
48" x 30"	44" x 23-3/4"	EPX3048-FDS	48" x 36"	44" x 29-3/4"	EPX3648-FDS
60" x 30"	56" x 23-3/4"	EPX3060-FDS	60" x 36"	56" x 29-3/4"	EPX3660-FDS
72" x 30"	68" x 23-3/4"	EPX3072-FDS	72" x 36"	68" x 29-3/4"	EPX3672-FDS
96" x 30"	92" x 23-3/4"	EPX3096-FDS	96" x 36"	92" x 29-3/4"	EPX3696-FDS

### WOOD SHELVES

3mm matching edgeband. Please specify grade, cut, species, and leaf match. Example: AA grade plain sliced Maple bookmatched veneer

Work Surface Size	Shelf Size	Part Number	Work Surface Size	Shelf Size	Part Number
48" x 30"	44" x 23-3/4"	WD3048-FDS	48" x 36"	44" x 23-3/4"	WD3648-FDS
60" x 30"	56" x 23-3/4"	WD3060-FDS	60" x 36"	56" x 23-3/4"	WD3660-FDS
72" x 30"	68" x 23-3/4"	WD3072-FDS	72" x 36"	68" x 23-3/4"	WD3672-FDS
96" x 30"	92" x 23-3/4"	WD3096-FDS	96" x 36"	92" x 23-3/4"	WD3696-FDS

### LAMINATE SHELVES

3mm matching edgeband if available. Please specify manufacturer, color name and number. Example: Wilsonart Black 1595-60

Work Surface Size	Shelf Size	Part Number	Work Surface Size	Shelf Size	Part Number
48" x 30"	44" x 23-3/4"	PLM3048-FDS	48" x 36"	44" x 23-3/4"	PLM3648-FDS
60" x 30"	56" x 23-3/4"	PLM3060-FDS	60" x 36"	56" x 23-3/4"	PLM3660-FDS
72" x 30"	68" x 23-3/4"	PLM3072-FDS	72" x 36"	68" x 23-3/4"	PLM3672-FDS
96" x 30"	92" x 23-3/4"	PLM3096-FDS	96" x 36"	92" x 23-3/4"	PLM3696-FDS

### PHENOLIC SHELVES

Black core beveled edge. Please specify manufacturer, phenolic grade and color name. Example: Trespa Toplab Plus Silver Grey. Available with color core.

Work Surface Size	Shelf Size	Part Number	Work Surface Size	Shelf Size	Part Number
48" x 30"	44" x 23-3/4"	PHN3048-FDS	48" x 36"	44" x 23-3/4"	PHN3648-FDS
60" x 30"	56" x 23-3/4"	PHN3060-FDS	60" x 36"	56" x 23-3/4"	PHN3660-FDS
72" x 30"	68" x 23-3/4"	PHN3072-FDS	72" x 36"	68" x 23-3/4"	PHN3672-FDS
96" x 30"	92" x 23-3/4"	PHN3096-FDS	96" x 36"	92" x 23-3/4"	PHN3696-FDS



## Modesty Panel & End Panel



Modesty panels provide privacy or hide wires and other unsightly items. Panels are sized per table type. They are manufactured at 3/4" thick and are fitted between the rear apron and the rear crossrail.

\*Specify color or wood species and finish



End panels provide privacy or just a clean look at the end of the bench. Specify right, left or both. Panels are sized per table type. End panels are manufactured at 3/4" thick and are fitted between the side apron and the side crossrail.

\*Specify color or wood species and finish

For tables and part numbers  
see pages 04-07

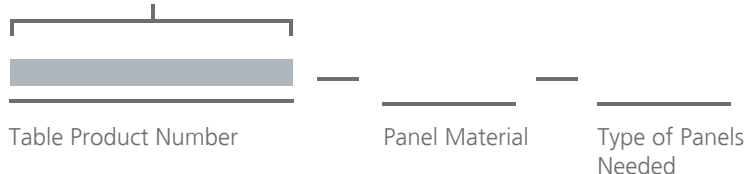

### EXAMPLE: TWA5628-WD-MPR

Standard 60" x 30" Standing Height Workstation with a modesty panel and right end panel made out of wood

PANEL MATERIAL		TYPE OF PANELS NEEDED	
WD	Wood	B	Both Left & Right End Panels
PLM	Plastic Laminate	L	Left End Panel
PHN	Phenolic	R	Right End Panel
		MP	Modesty Panel
		MPR	Modesty Panel & Right End Panel
		MPL	Modesty Panel & Left End Panel
		MPB	Modesty Panel & Both Left & Right End Panels

### Materials

**Wood:** Vertical grain cut with an 1/8" wood edgeband on all four sides. Most popular and stocked types are red oak, white oak and maple.

**Phenolic:** Solid phenolic piece with no edgeband. Stocked color is black.

**Plastic Laminate:** Plastic laminate piece with 1mm custom/matching edgebanding. Stocked colors are black with black edgebanding and a custom gray (matches Mott's Warm Gray painted steel) with matching edgeband.

For additional colors and types, please contact your New England Lab representative.



## Electrical Raceway Under Table Mount



Our standard electrical strip is 15 or 20 amperes, 125 volts with an on/off switch, circuit breaker, power indicator light and a 6' power cord. Color is grey. Mounted under the table.



### Work Surface

Size	Part No.	Description
48"	UTM0044	36" L (12) outlets
60"	UTM0056	48" L (16) outlets
72"	UTM0068	60" L (20) outlets

## Electrical Raceway Side Mount



Our standard electrical strip is 15 or 20 amperes, 125 volts with an on/off switch, circuit breaker, power indicator light and a 6' power cord. Color is grey. Mounted on the side of the table.



### Work Surface

Size	Part No.	Description
48"	SM0024	24" L 8 outlets
60"	SM0024	24" L 8 outlets
72"	SM0024	24" L 8 outlets

## Short Upright Mount



Our standard electrical strip is 15 or 20 amperes, 125 volts with an on/off switch, circuit breaker, power indicator light and a 6' power cord. Mounted on (2) 16" strut uprights.



### Work Surface

Size	Upright Part No.	Rail & Strip Part No.
48"	VTC0018	ESA0044
60"	VTC0018	ESA0056
72"	VTC0018	ESA0068

## Pedestal Outlet



WaterSaver electrical boxes are machined for both standard and ground fault receptacles, and are furnished complete with grounding screws, a 3/4" IPS mounting shank and locknut. Cast aluminum boxes are powder coated with a wrinkle black epoxy coating and matte finish.



Part No.	Description
E333WS	2 outlets



## Monitor Arm



Our standard monitor arm has a 360° swivel rotation and a dual pivot arm assembly. 6 mounting options are included. Color is silver.

Part No.	Description
1) 7000-FM	monitor arm assembly
2) 9112-S-FM	monitor arm assembly



desk edge  
mount



through-hole  
mount



wall mount



reverse wall/  
table  
upright mount



side bolt  
mount



grommet hole  
mount



## CPU Holder

1)



2)



1) The painted steel CPU holder is supplied with full extension runners to extend the CPU cabinet. Inside clear dimension of the CPU holder is 9-3/16".

2) The steel CPU holder swivels 360°, is retractable and mounts underneath most work surfaces with an easy-to-install pack. Easily adjustable to fit CPU widths from 3-3/4"W to 8-1/4"W and heights from 12"H to 20-1/2"H.

Part No.	Description
1) CPU1010	10" W
2) CPU29157	8-1/4"W

## Keyboard Tray



Our 27" wide pullout keyboard tray provides 12.5" height adjustment, 7" up and 5.5" down. Lift to desired position and release. 23" track is included.

Part No.	Description
8491-8495	slide-out tray



## Vertical Uprights - Strut System



Our vertical strut uprights are manufactured of 1-5/8" x 1-5/8" 12-gauge steel channel. Vertical uprights bolt to the rear of the workstation for infinite adjustment of accessories above the work surface (12" required below the work surface for mounting). Priced per pair.

	Part No.	Description
	VTC0036	36" Uprights
	VTC0048	48" Uprights
	VTC0060	60" Uprights

## Book Stop Rail - Strut System



Our book stop rail is manufactured of heavy gauge, formed steel and mounts to uprights at the desired height above the shelf to help retain books or a variety of other items.

	Work Surface Size	Part No.	Description
	48"	BSR0044	44" Book Stop
	60"	BSR0056	56" Book Stop
	72"	BSR0068	68" Book Stop
	96"	BSR0092	92" Book Stop

## Bookends - Strut System



Bookends are fabricated of 13-gauge steel with painted finish and are mechanically fastened to the underside of the shelf. Priced per pair.

	Part No.	Description
	OSB0012	5"H x 12"D
	OSB0018	5"H x 18"D

## Electrical Strip Assembly - Strut System



Our standard electrical strip can come as 15 or 20 amperes, 125 volts with an on/off switch, circuit breaker, power indicator light and a 6' power cord. Color is grey. Steel mounting rail is included and is adjustable on our vertical uprights.



	Work Surface Size	Description	Part No. 15A	Mounting Rail Size
	48"	36" power strip (12) Outlets	ESA0044	44"
	60"	48" power strip (16) Outlets	ESA0056	56"
	72"	60" power strip (20) Outlets	ESA0068	68"
	96"	72" power strip (24) Outlets	ESA0092	92"



## Flat Overhead Shelf Assembly - Strut System



The flat overhead shelf is manufactured to be 1" thick and includes a heavy-duty welded support frame. All shelves are infinitely adjustable on our vertical uprights. Other shelving materials are available upon request.



### Work Surface Support Frame ONLY

Size	Part No.	Frame Size
48"	OSF1244	44"W X 12"D
60"	OSF1256	56"W X 12"D
72"	OSF1268	68"W X 12"D
96"	OSF1292	92"W X 12"D

### Work Surface Support Frame ONLY

Size	Part No.	Frame Size
48"	OSF1844	44"W X 18"D
60"	OSF1856	56"W X 18"D
72"	OSF1868	68"W X 18"D
96"	OSF1892	92"W X 18"D

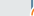
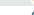
### Work Surface Size

Surface Size	Shelf Size	P-LAM Shelf Part No.	Wood Shelf Part No.	Phenolic Shelf Part No.
48"	44"W X 12"D	 PLM1244FS	WD1244FS	PHN1244FS
60"	56"W X 12"D	 PLM1256FS	WD1256FS	PHN1256FS
72"	68"W X 12"D	 PLM1268FS	WD1268FS	PHN1268FS
96"	92"W X 12"D	 PLM1292FS	WD1292FS	PHN1292FS
48"	44"W X 18"D	PLM1844FS	WD1844FS	PHN1844FS
60"	56"W X 18"D	PLM1856FS	WD1856FS	PHN1856FS
72"	68"W X 18"D	PLM1868FS	WD1868FS	PHN1868FS
96"	92"W X 18"D	PLM1892FS	WD1892FS	PHN1892FS

\*specify color and/or species and cut



## Single Bay Frame - "Build Your Own" Assembly

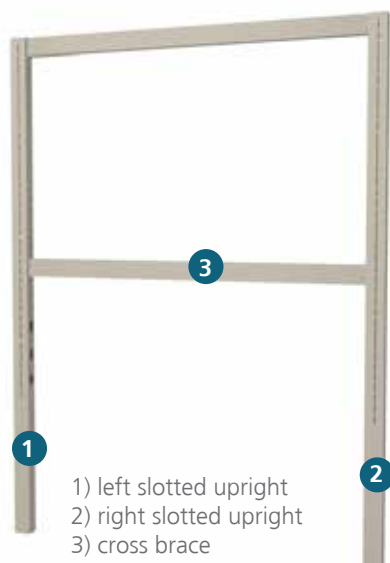

The single bay slotted uprights are for use with steel shelves only. The uprights are made from 1-5/8" x 1-5/8", 16- gauge steel tubes. The frame bolts to any standard size Cambridge base table with (4) bolts into the rear legs. Hardware included. Accessories are adjustable in 1" increments. 41-1/4"H above the work surface.

Work Surface Size	# of Holes	Quantity	Part No.	Description
36" -72"	0	1	BFPL000	left slotted upright
36" -72"	1 for data	1	BFPL001	left slotted upright
36" -72"	3 for plumbing	1	BFPL003	left slotted upright
36" -72"	0	1	BFPR000	right slotted upright
36" -72"	1 for data	1	BFPR001	right slotted upright
36" -72"	3 for plumbing	1	BFPR003	right slotted upright
36"	N/A	2	SBF1032	center cross brace
48"	N/A	2	SBF1044	center cross brace
60"	N/A	2	SBF1056	center cross brace
72"	N/A	2	SBF1068	center cross brace

## Preconfigured Slotted Upright Kit



Includes (1) pair of uprights and (1) pair of cross braces. (3) holes for plumbing services are located on left upright.

Work Surface Size	Preconfigured Kit Part No.	Height
36"	SBF0032	54"
48"	SBF0044	54"
60"	SBF0056	54"
72"	SBF0068	54"

## Single Bay Steel Shelf Assembly - Slotted System



Steel shelves for the single bay uprights are made from 20-gauge steel, formed to 1" thick and handle 40 lb./sq. ft. (up to 180 lb. maximum per shelf). The 1" high rear lip keeps items from being pushed rearward off the shelf. Uprights and cross brace not included.



Work Surface Size	Shelf Quantity	Bracket Quantity	Feature	Part No. 12" Deep	18" Deep
36"	1	1 pair	Rear Lip	???1232	???1832
48"	1	1 pair	Rear Lip	???1244	???1844
60"	1	1 pair	Rear Lip	???1256	???1856
72"	1	1 pair	Rear Lip	???1268	???1868

\*Replace ??? with  
SBS for standard bracket  
SBR for radiused bracket  
SBT for tapered bracket



## Double Bay Frame - "Build Your Own" Assembly

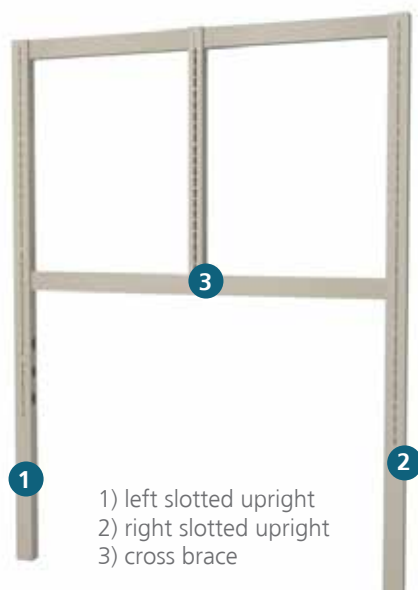

The double bay slotted uprights are divided with a center shelf support (combining the two cross braces) for use with different shelf materials. Each complete shelf tier will require (4) bookend brackets and (2) shelves. Each tier does not need to be complete if tall equipment interferes. 41-1/4"H above the work surface.

Work Surface Size	# of Holes	Quantity	Part No.	Description
48" -72"	0	1	BFPL000	left slotted upright
48" -72"	1 for data	1	BFPL001	left slotted upright
48" -72"	3 for plumbing	1	BFPL003	left slotted upright
48" -72"	0	1	BFPR000	right slotted upright
48" -72"	1 for data	1	BFPR001	right slotted upright
48" -72"	3 for plumbing	1	BFPR003	right slotted upright
48"	N/A	1	DBF1044	center cross brace
60"	N/A	1	DBF1056	center cross brace
72"	N/A	1	DBF1068	center cross brace

## Preconfigured Slotted Upright Kit



Includes (1) pair of uprights and (1) pair of cross braces with center shelf support. (3) holes for plumbing services are located on left upright.

Work Surface Size	Part No.	Height
48"	DBF0044	*54"
60"	DBF0056	*54"
72"	DBF0068	*54"

## Double Bay Steel Shelf Assembly - Slotted System



Shelves for the Double Bay uprights are made to handle 40 lb./sq. ft. up to 90 lb. maximum per shelf. The 1" high rear lip keeps items from being pushed rearward off the shelf. All steel shelves are 20-gauge and 1" thick. **Note:** for each double bay tier, order (2) shelves. Uprights and cross brace not included.

Work Surface Size	Shelf Quantity	Bracket Quantity	Feature	Part No. 12" Deep	18" Deep
48"	1	1 pair	Rear Lip	???1244	???1844
60"	1	1 pair	Rear Lip	???1256	???1856
72"	1	1 pair	Rear Lip	???1268	???1268

Standard = DBS

Radiused = DBR

Tapered = DBT

\*Replace ??? with

DBS for standard bracket

DBR for radiused bracket

DBT for tapered bracket



## Shelves for Double Bay Assembly - Slotted System



Several materials can be manufactured as shelves for the double bay frame. All shelves are adjustable in 1" increments on our vertical uprights.

\*rear shelf lips and bookend brackets ordered separately

### WOOD SHELVES

1" thick with 3mm matching edgeband. Please specify grade, cut and species.

Example: AA grade plain sliced Maple veneer. **Note:** for each double bay tier, order (2) shelves.

### LAMINATE SHELVES

1" thick with 3mm matching edgeband if available. Please specify manufacturer, color name and number. Example: Wilsonart Black 1595-60. **Note:** for each double bay tier, order (2) shelves.

### PHENOLIC SHELVES

Black core beveled edge. Please specify manufacturer, phenolic grade and color name. Example: Trespa Toplab Base Silver Grey. Color core available. **Note:** for each double bay tier, order (2) shelves.

Work Surface Size	12"d Shelf (Actual Size)	Wood Shelf Part No.	Laminate Shelf Part No.	Phenolic Shelf Part No.
48"	20.884"W x 11.938"D	WD1244-DBS	PLM1244-DBS	PHN1244-DBS
60"	26.884"W x 11.938"D	WD1256-DBS	PLM1256-DBS	PHN1256-DBS
72"	32.884"W x 11.938"D	WD1268-DBS	PLM1268-DBS	PHN1268-DBS

Work Surface Size	18"d Shelf (Actual Size)	Wood Shelf Part No.	Laminate Shelf Part No.	Phenolic Shelf Part No.
48"	20.884"W x 17.938"D	WD1844-DBS	PLM1844-DBS	PHN1844-DBS
60"	26.884"W x 17.938"D	WD1856-DBS	PLM1856-DBS	PHN1856-DBS
72"	32.884"W x 17.938"D	WD1868-DBS	PLM1868-DBS	PHN1868-DBS

## Rear Lip - Slotted System

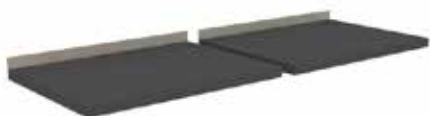

1" x 2" 18-gauge painted steel angle secured to the bottom of a wood, laminate or phenolic shelf to create a 1" high retainer at the rear. **Note:** double bay rear lips sold in pairs.

### SINGLE BAY

Work Surface Size	Part No.	Width
48"	SBB2144	39.557"
60"	SBB2156	51.557"
72"	SBB2168	63.557"

### DOUBLE BAY (PAIR)

48"	DBB2144	18.563"
60"	DBB2156	24.563"
72"	DBB2168	30.563"

## Bookends - Slotted System

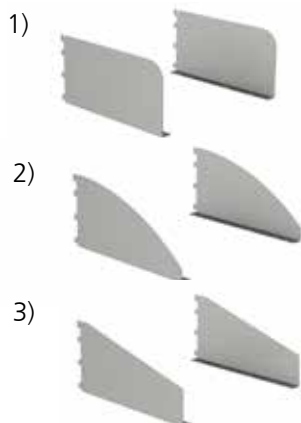

Bookend brackets are required for all shelves that are to be used with single bay or double bay slotted upright frames. 14-gauge bookend brackets. **Note:** on double bay systems, each tier requires (2) pairs of brackets.

Description	# of Pairs	12" Part No.	18" Part No.
1) Standard	1	BSB0012	BSB0018
2) Radiused	1	BSB3012	BSB3018
3) Tapered	1	BSB4012	BSB4018



## Power Strip Rail - Slotted System

### RAIL ONLY



The power strip rail is recessed flush to the back of the upright to keep raceways from protruding too far. They're adjustable in 1" increments.

**Note:** If you're also using a plumbing kit, the locations for the support rail are limited to either above or below the fixtures.

Work Surface Size	Part No.
48"	PSR1044
60"	PSR1056
72"	PSR1068

### 15A ELECTRICAL STRIP ONLY



Designed to be connected to a standard wall outlet and comes with a NEMA 5-15P plug end on a 15' black cord. Each raceway contains 15A black outlets, single circuit breaker, and a lighted on/off switch with locking transparent cover. The plugstrip is manufactured within an extruded aluminum housing.

Work Surface Size	Part No.	No. of Outlets
48"	E3162	12
60"	E4816	16
72"	E6020	20

### 20A ELECTRICAL RACEWAY ONLY



Designed for overhead connection with a twist lock plug on a 10' white cord and plastic 90 degree cord grip. Single circuit units can be ordered with a standard straight blade wall/floor plug. Each raceway contains 20A white outlets and some models have type B USB charging receptacles. Standard raceway is anodized aluminum with a removable cover.

Standard outlets are set in round cutouts while designer outlets fit in rectangular cutouts. Two circuit raceway has shared neutral and ground wires with an aluminum 90 degree cord grip and circuit breaker.

Each raceway has (3) threaded holes for attachment to the powerstrip rail. Raceway can be flipped so the cord can be used at either side of bench.

	Work Surface Size	Part No.	Qty Standard Outlets	Qty Designer Outlets	Qty USB Charging Ports	# of Circuits	NEMA Plug Type
ECONOMY	48"	PS130-38.5C-5D-10 TL	5	-	-	1	L5-20P*
	60"	PS130-50.5C-5D-10 TL	5	-	-	1	L5-20P*
	72"	PS130-62.5C-5D-10 TL	5	-	-	1	L5-20P*
STANDARD	48"	PS130-38.5C-4D1U-10 TL	-	5	2	1	L5-20P*
	60"	PS130-50.5C-4D1U-10 TL	-	5	2	1	L5-20P*
	72"	PS130-62.5C-4D1U-10 TL	-	5	2	1	L5-20P*
PREMIUM	48"	PS130-38.5C-5D1U-10 TL2	-	6	2	2	L14-20P
	60"	PS130-50.5C-5D1U-10 TL2	-	6	2	2	L14-20P
	72"	PS130-62.5C-5D1U-10 TL2	-	8	2	2	L14-20P

\*Change "TL" to "SB" on part number to get straight blade 5-20P cordset.



Add -KSR to any part number to get strain relief on the cord set.





## Standard Plumbing Kit

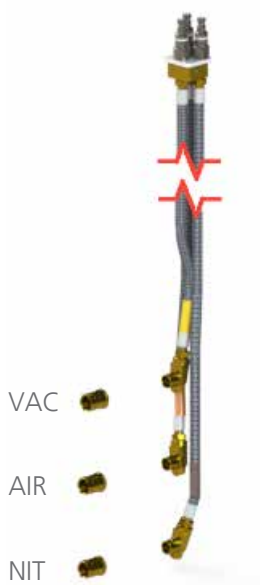

Our standard plumbing kit comes with (3) services - Vacuum, Air and Nitrogen. Services not needed would be capped and available for future use or reconfiguration. The unit includes the painted tube cap with (3) male quick connects, (3) stainless steel braided flexible hoses with soft PEX interiors, and brass RWC mounts. The kit drops into the slotted upright post from the top and each of the (3) hose ends are connected at the post with the RWC mounting nut. The plumbing kit can be used on a left or right hand post and can be easily moved for reconfiguration. Max pressure 230 PSI. Materials in contact with media are brass, PEX, rubber, FKM and a perfluoropolyether based lubricant. Kit is pressure-secured to post with a 2mm Allen screw.

\* Valves, caps and hoses to connect kit to ceiling/wall are ordered separately.

Other media services can be configured to create custom plumbing kits upon request.

### Blind White Plug



	Part No.	Description
	61997722098	plumbing kit #1
	61392792099	blind white plug

## Service Panel Quick Connects



VAC

These female quick connects get mounted into an overhead service panel or carrier to provide services to the benches with plumbing kits.



AIR



NIT

	Part No.	Description
	25980222028	VAC quick connect
	25980222021	AIR quick connect
	25980222023	NIT quick connect

## Needle Valves



VAC

Needle valves are powder coated brass and mount to the RWC nut on the plumbing kit. Secure valve with handle oriented in any position via (2) Allen screws. Standard installation handle orientation is to face the user, but can be requested at 45° or 90° angles, or adjusted on site by the user as desired. Because the valves are easily attached via 2 Allen screws and don't require a licensed plumber, we recommend only ordering this type of valve when needed for a specific technician. At larger facilities, a few of these could be kept on hand and replaced in minutes if needed for a specific individual.

\*VAC, AIR, and NIT shown, other media valves and plumbing kits are available upon request.

### Ball Valves



AIR

NIT



VAC

AIR

NIT

	Part No.	Valve Type
	61997762028	VAC needle valve
	61997882021	AIR needle valve
	61997812023	NIT needle valve
	61997782028	VAC ball valve
	61997872021	AIR ball valve
	61997822023	NIT ball valve



## Snite LED Task Light

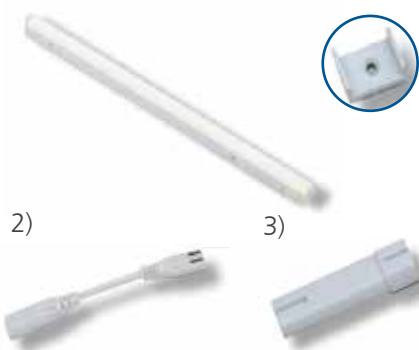

White LED light fixture with screw mounting clips included. Additional accessories listed are available. 120 volts.

Part No.	Description
1305942	12-5/16", 26 LEDs
1305943	21-5/16", 45 LEDs
1305944	22-9/16", 51 LEDs
1305945	34-3/8", 76 LEDs
1305946	46-3/16", 100 LEDs
1305947	58", 126 LEDs

### ACCESSORIES

Part No.	Description
1) 1305917	78-3/4" power cord
2) 1305926	11-13/16" connection cord
2) 1305929	19-5/8" connection cord
2) 1305932	39-3/8" connection cord
3) 1305911	direct connector
4) 1305010	magnetic mounting clips

## Koncept UCX Pro



Minimalist design and ultra-high energy efficiency aluminum task light. Magnetic/ Screw mounts included. 60° tilting motion. 50,000 hours of LED rated lifespan. Color Temperature varies from 2,700K to 5,000K. Available with a built in touchstrip dimmer. Remotely control the color and brightness settings with optional wifi module and smartphone app. Schedule the light to automatically change in intensity and light throughout the day to synchronize with circadian rhythms (biodynamic lighting).

### WIFI MODULE

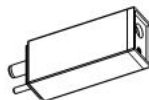

Remotely control 1+ light temperatures, brightness settings or on/off scheduling. Schedule your light to automatically change in intensity and light color throughout the day. Use the Personal Detection feature to automatically turn the light on with your set schedule (when connected to Wifi) and power off when you leave.

### OCCUPANCY SENSOR



The UCX Pro will turn off 15 minutes after you leave the room and will illuminate your space with your preferred settings upon your return.

Part No.	Description
P7-08-OCC01A	occupancy sensor
P7-08-WIFI01A	wifi module

Model No.	Length	Lumens	# of LEDs	Luminaire Wattage	System Power	Max. Chained Units
UCX-19-SIL	19.45"	760	84	8.64W	10.5W	4 units
UCX-27-SIL	26.81"	1140	126	13W	15.5W	3 units
UCX-37-SIL	36.61"	1672	182	18.7W	22.5W	2 units

## RECOMMENDED TASK LIGHT KITS FOR CAMBRIDGE SERIES TABLES

Model No.	Table Size	19.5" light qty.	27" light qty.	37" light qty.	Driver	Direct Connector qty.
UCXP48	4'	0	0	1	1 amp	0
UCXP60	5'	1	1	0	1.5 amps	1
UCXP72	6'	3	0	0	1.5 amps	2



## Novus Toolbar



(2) 17.5" high Extruded aluminum posts with a slat rail bar.

Clamp mount - edge clamp for surfaces 1/2" to 1-1/2" thick. Includes hardware and wire management clips. Additional clamp sizes up to 2-2/4" available.

\*available in grommet mount - for grommet holes up to 3" diameter. Notched base plate for wire passage. Includes hardware and wire management clips.

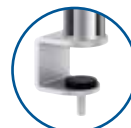

clamp mount



grommet mount

	Part No.	table size	width	surface attachment*
	NV-TB-48-CL	4'	40"	clamp mount
	NV-TB-60-CL	5'	50"	clamp mount
	NV-TB-72-CL	6'	63"	clamp mount

## Novus Reagent Shelving



(2) 33-1/4" high Extruded aluminum posts with (3) slatrails and (4) 11-7/8" deep shelves. Shelves can be easily removed for large equipment.

Grommet mount - for grommet holes up to 3" diameter. Notched base plate for wire passage. Includes hardware and wire management clips.

	Part No.	table size	width	surface attachment*
	NV-TBSH-48-DSHD	4'	40"	grommet mount
	NV-TBSH-60-DSHD	5'	50"	grommet mount
	NV-TBSH-72-DSHD	6'	63"	grommet mount

## Magnetic Strip



A Magnetic bar that attaches to the slat rail element to hold papers and etc.

Model No.	color
NV-MS-109	silver

## Multi-storage Board



Storage board that attaches to the slat rail element and holds writing instruments, paper and additional accessories.

Model No.	color
NV-MSB-99	silver



## Monitor Arms



1)

My Arm - Infinitely height adjustable 2-part articulated arm with standard mounting 75/100. Mounts screens up to 11 lb. Swiveling and tiltable with balance mechanism at front joint. 16" range.

### Model No.

### Description



1) NV-MA-CM

myarm



2) NV-LT-3

liftTEC Arm III



2)

LiftTEC Arm III - 2-part monitor supporting arm with gas spring technology for comfortable, ergonomic adjustment. Suitable for mounting standard 75/100. Can hold monitors 15-30 lb. 20 inch range.

## Technology Holders



1)

Cell phone holder - rest your cellphone in the holder in the easily attachable/detachable holder while charging or working.

### Model No.

### Description



1) NV-PHN-79

cell phone holder



2) NV-TH-89

tablet holder



2)

Tablet holder - lean your tablet onto the holder while you transfer information.

## Utensil Holders



1)

Pen holder - Round pen or writing utensil holder that easily clips into the slatrail element.

### Model No.

### Description

1) NV-PH-69

round pen holder

2) NV-PC-69

square pen cup



2)

Puraline Pen Cup - High-quality metal with powder-coated finish pen cup. Dimension = 3.4" x 3.4" x 3.3".



## Memo Holder



Powder-coated finish metal holder that can hold miscellaneous items.

Model No.	color
NV-MB-39	silver

## Puraline Multipurpose Box



High-quality metal multipurpose bin with powder-coated finish.



Model No.	color
NV-SB-49	silver

## Plexibins

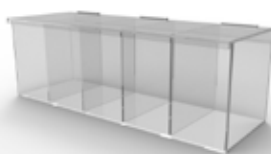

SEGMENTED PLEXIBINS

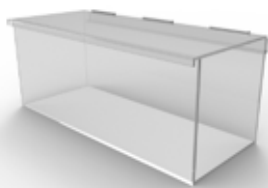

PLEXIBINS WITH LID

Segmented Plexibins - quick pick fingertip access for inventory and supplies. Individual lids safeguard inventory from splashes and cross-contamination exposure.

Plexibin Boxes with Lid - overhand lift from for easy fingertip opening and access. Plexibins of 0.25" thickness clear plexiglass.

### SEGMENTED PLEXIBINS # of Bins



Model No.	Size	# of Bins
PBS085L	8"W x 5"H x 5"D	2
PBS145L	14"W x 5"H x 5"D	4

### PLEXIBIN BOXES



Model No.	Size
PBB040404	4"W x 4"D x 4"H
PBB120404	12"W x 4"D x 4"H
PBB150606	15"W x 6"D x 6"H
PBB151212	15"W x 12"D x 12"H

## Dispensers

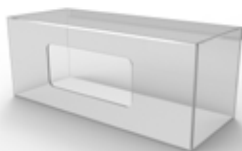

GLOVE/TISSUE DISPENSER



DOUBLE DISPENSER

Glove/Tissue Dispenser - organize glove and tissue boxes for easy dispensing. Snaps in/out of Catalyst Slatrail for ideal placement. Side load access for easy refills.

Double Dispenser for Gloves & Tissues - accepts standard glove/tissue boxes and fits all standard slatrails and panels. EZ load side openings.

### GLOVE/TISSUE DISPENSER



Model No.	Size
PBT150606	15"W x 6"D x 6"H

### DOUBLE GLOVE/TISSUE DISPENSER



Model No.	Size
PBD150612	15"W x 6"D x 12"H



# Tubular Instrument Shelf



Our heavy-duty tubular instrument shelf offers ample support for heavy equipment and easily fastens to the work surface. Standard construction is 18" high x 10" deep with a 1" plastic laminate shelf and 3 mm PVC edgebanding. Other shelving materials, heights and depths are available upon request.

\*Specify Color

Work Surface Size	Part No.	Description
48"	TTS0844	44"W x 18"H x 8"D
60"	TTS0856	56"W x 18"H x 8"D
72"	TTS0868	68"W x 18"H x 8"D
96"	TTS0894	94"W x 18"H x 8"D