

Horizontal Rods

Horizontal rods are machined from solid aluminum bar stock. Rods are cut to size, ends are rounded and each rod is polished to a satin finish. Rods are available in 1/2" and 3/4" diameter and a variety of lengths.

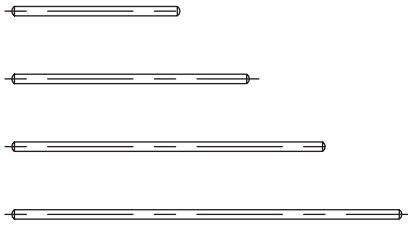

- AAP155-024** 3/4" dia. × 24" Horizontal Rod
- AAP155-036** 3/4" dia. × 36" Horizontal Rod
- AAP155-039** 3/4" dia. × 39" Horizontal Rod
- AAP155-048** 3/4" dia. × 48" Horizontal Rod

- AAP145-024** 1/2" dia. × 24" Horizontal Rod
- AAP145-036** 1/2" dia. × 36" Horizontal Rod
- AAP145-039** 1/2" dia. × 39" Horizontal Rod
- AAP145-048** 1/2" dia. × 48" Horizontal Rod

Vertical Rods

3/4" diameter vertical rods are machined with the top end rounded and the bottom end tapered to fit into a rod socket. 1/2" diameter vertical rods are machined with the top end rounded and the bottom end threaded. 1/2" rods may be used either with a threaded socket or with the AAP120 tapered adaptor and a tapered socket.

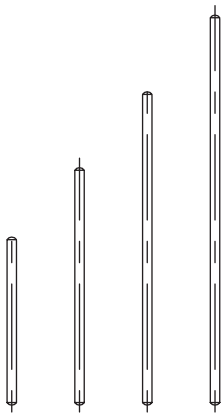

- AAP110-024** 3/4" dia. × 24" Vertical Rod (Tapered)
- AAP110-036** 3/4" dia. × 36" Vertical Rod (Tapered)
- AAP110-039** 3/4" dia. × 39" Vertical Rod (Tapered)
- AAP110-048** 3/4" dia. × 48" Vertical Rod (Tapered)

- AAP125-024** 1/2" dia. × 24" Vertical Rod (Threaded)
- AAP125-036** 1/2" dia. × 36" Vertical Rod (Threaded)
- AAP125-039** 1/2" dia. × 39" Vertical Rod (Threaded)
- AAP125-048** 1/2" dia. × 48" Vertical Rod (Threaded)

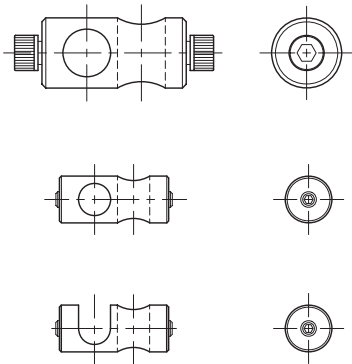

Clamps

Clamps are designed to hold vertical and horizontal rods perpendicular to each other. Clamps are adjustable and are furnished with set screws to secure clamp to rods. Clamps are machined from aluminum bar stock and polished to a satin finish.

- AAP150** Closed Style Clamp for 3/4" Diameter Rods. Clamp has two holes perpendicular to each other.
- AAP151** Closed Style Clamp for 1/2" Diameter Rods. Clamp has two holes perpendicular to each other.
- AAP153** Open Style Clamp for 1/2" Diameter Rods. Clamp has hole for vertical rod and slot for horizontal rod.

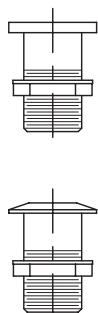

Rod Sockets

- AAP100** Aluminum rod socket with tapered bore and flat top for recess mounting in countertop.
- AAP101** Aluminum rod socket with tapered bore and radiused top for surface mounting on countertop.
- AAP103** Aluminum rod socket with 1/2" female thread and flat top for recessed mounting in countertop.
- AAP104** Aluminum rod socket with 1/2" female thread and radiused top for surface mounting on countertop.

WaterSaver manufactures a complete line of components for lattice rod assemblies. A wide variety of assemblies for installation on bench tops and in fume hoods may be constructed using these components. Components are available in a choice of materials, as follows:

Aluminum. All components are machined from solid aluminum bar stock and polished to a satin (brushed) finish.

Plastic. Flanges and clamps are molded in black nylon for strength and chemical resistance. Rods are fabricated in white fiberglass.

Stainless Steel. Stainless steel components offer superior strength and corrosion resistance for the most demanding applications. All components are machined from Type 316 stainless steel bar stock and polished to a satin finish.

The rods listed below are representative of the most commonly used sizes. Rods can be fabricated in any length up to 120".

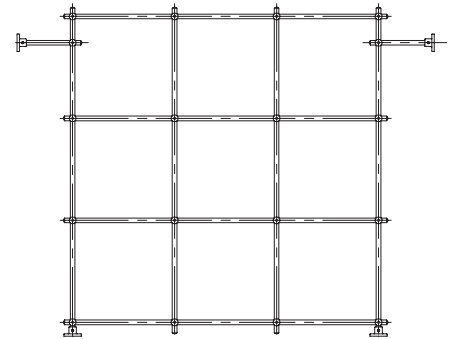

| | Aluminum | Plastic | Stainless Steel |
|--|--|--|--|
| Flanges Flange with Set Screw for 1/2" Plain Rod Flange with Thread for 1/2" Threaded Rod | AAP158 AAP158A | PAP158 | SAP158 SAP158A |
| Threaded Rods Threaded rods are typically used for vertical members and as tie rods to secure a lattice assembly to a wall or panel. 1/2" dia. × 5" Threaded Rod 1/2" dia. × 8" Threaded Rod 1/2" dia. × 10" Threaded Rod 1/2" dia. × 12" Threaded Rod 1/2" dia. × 18" Threaded Rod 1/2" dia. × 24" Threaded Rod 1/2" dia. × 36" Threaded Rod | AAP125-005 AAP125-008 AAP125-010 AAP125-012 AAP125-018 AAP125-024 AAP125-036 | | SAP125-005 SAP125-008 SAP125-010 SAP125-012 SAP125-018 SAP125-024 SAP125-036 |
| Rounded End Rods Plain end rods are typically used for vertical or horizontal members. 1/2" dia. × 5" Rod 1/2" dia. × 8" Rod 1/2" dia. × 12" Rod 1/2" dia. × 24" Rod 1/2" dia. × 36" Rod 1/2" dia. × 48" Rod 1/2" dia. × 60" Rod 1/2" dia. × 72" Rod | AAP145-005 AAP145-008 AAP145-012 AAP145-024 AAP145-036 AAP145-048 AAP145-060 AAP145-072 | PAP145-005 PAP145-008 PAP145-012 PAP145-024 PAP145-036 PAP145-048 PAP145-060 PAP145-072 | SAP145-005 SAP145-008 SAP145-012 SAP145-024 SAP145-036 SAP145-048 SAP145-060 SAP145-072 |
| Clamps Closed style clamps have two 1/2" dia. holes that are perpendicular to each other. They are typically used for securing a lattice rod assembly to a wall or panel. Open style clamps have one 1/2" dia. hole and an open slot that is perpendicular to it. These clamps are typically used to connect vertical and horizontal rods. Closed Style Clamp Open Style Clamp | AAP151 AAP153 | PAP151 PAP153 | SAP151 SAP153 |