

WIRE AND SOLID SHELVING SOLUTIONS

Super Erecta Pro,[™]
Super Adjustable Super Erecta[®]
and Super Erecta[®]

Wire/Polymer Hybrid Shelving	32-35
Easy-Adjust Shelving & Carts	36-39
Wire Shelving, Carts & Trucks.....	40-47
Casters & Accessories for Wire Shelving	48-62
Solid Shelving & Accessories	64-66
Light-Duty Wire Shelving & Accessories	67
Heavy-Duty Solid Shelving & Accessories	68-69

Proven.

Genuine Metro Super Erecta®
The industry standard — innovated and reinnovated.



Super Erecta®
The original
wire shelving
system.

Super Adjustable
Super Erecta™

Shelves adjust with a flip of the release!

NEW

Super Erecta Pro™

Durable & cleanable.
The original — reinnovated.



Progress.

Super Erecta Pro™
Durable & cleanable.
The original — reinnovated.



Epoxy coated Super Erecta-style frames with removable polymer shelf mats.

Stays cleaner between cleanings.

Polymer shelf mats and Metroseal 3 epoxy coated shelf frames and posts have built-in Microban® antimicrobial product protection.



*Microban® antimicrobial product protection helps keep shelves "cleaner between cleanings" by inhibiting the growth of bacteria, mold and mildew that cause odors and stains on the shelf surface. MICROBAN® and the MICROBAN® symbol are registered trademarks of the Microban Products Company, Huntersville, NC.

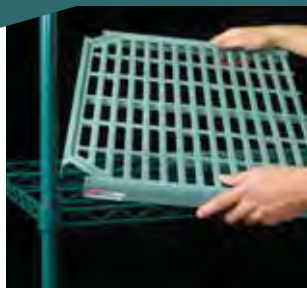

Easy to clean.

Lift-off mats can be easily removed and washed by hand or in a wash machine.

Prolonged durability.

Polymer shelf mats withstand daily abuse from containers and sharp edges. Robust design provides the strength and rigidity of Super Erecta...holds up to 800 lbs. (363kg) per shelf.



Interchangeable.

Super Erecta Pro shelves can be configured with traditional shelf and accessory options on the same unit for maximum flexibility.

Super Erecta Pro™ Shelving — 10.80



Super Erecta Pro™ Shelves

Packaging: Shelves are priced individually and packaged no more than 4 per carton except 60" (1524mm) and 72" (1829mm) lengths which are packaged no more than 2 per carton. Plastic split sleeves are included with each shelf.

Nominal Width/Length		Approx. Pkd. Wt.		Cat. No. Super Erecta Pro Metroseal 3
(in.)	(mm)	(lbs.)	(kg)	
18x24	457x610	6.0	2.7	PR1824NK3
18x30	457x760	7.8	3.5	PR1830NK3
18x36	457x914	9.5	4.2	PR1836NK3
18x42	457x1060	11.3	5.0	PR1842NK3
18x48	457x1219	13.0	5.8	PR1848NK3
18x54	457x1372	14.8	6.6	PR1854NK3
18x60	457x1524	16.5	7.4	PR1860NK3
18x72	457x1829	19.8	8.8	PR1872NK3
21x24	530x610	8.0	3.6	PR2124NK3
21x30	530x760	9.5	4.2	PR2130NK3
21x36	530x914	11.3	5.0	PR2136NK3
21x42	530x1060	12.5	5.6	PR2142NK3
21x48	530x1219	14.3	6.4	PR2148NK3
21x54	530x1372	16.5	7.4	PR2154NK3
21x60	530x1524	18.3	8.1	PR2160NK3
21x72	530x1829	21.5	9.6	PR2172NK3
24x24	610x610	9.5	4.2	PR2424NK3
24x30	610x760	11.3	5.0	PR2430NK3
24x36	610x914	13.0	5.8	PR2436NK3
24x42	610x1060	14.0	6.3	PR2442NK3
24x48	610x1219	15.5	6.9	PR2448NK3
24x54	610x1372	18.3	8.1	PR2454NK3
24x60	610x1524	20.0	8.9	PR2460NK3
24x72	610x1829	23.3	10.4	PR2472NK3

Note: Each Super Erecta Pro™ shelf up to and including 48" (1219mm) long have a maximum weight capacity of 800 lbs. (363kg) evenly distributed. Shelves longer than 48" (1219mm) have a maximum weight capacity of 600 lbs. (363kg) evenly distributed.

Super Erecta with Metroseal 3™ — Standard Shelves

Nominal Width/Length		Approx. Pkd. Wt.		Cat. No. Super Adjustable Metroseal 3	Cat. No. Super Erecta Metroseal 3	Approx. Pkd. Wt.		Cat. No. Dunnage Shelf Metroseal 3
(in.)	(mm)	(lbs.)	(kg)			(lbs.)	(kg)	
18x24	457x610	7	3.2	A1824NK3	1824NK3	14	6.3	1824DRK3
18x30	457x760	8	3.6	A1830NK3	1830NK3	18	8.1	1830DRK3
18x36	457x914	9.5	4.3	A1836NK3	1836NK3	21	9.4	1836DRK3
18x42	457x1060	11	5.0	A1842NK3	1842NK3			—
18x48	457x1219	12	5.4	A1848NK3	1848NK3	28	12.6	1848DRK3
18x54	457x1372	14.5	6.6	A1854NK3	1854NK3			—
18x60	457x1524	17	7.7	A1860NK3	1860NK3	34	15.3	1860DRK3
18x72	457x1829	20	9.1	A1872NK3	1872NK3			—
21x24	530x610	8	3.6	A2124NK3	2124NK3			—
21x30	530x760	9	4.1	A2130NK3	2130NK3			—
21x36	530x914	11	5.0	A2136NK3	2136NK3			—
21x42	530x1060	12	5.4	A2142NK3	2142NK3			—
21x48	530x1219	14	6.4	A2148NK3	2148NK3			—
21x54	530x1372	16	7.3	A2154NK3	2154NK3			—
21x60	530x1524	18	8.2	A2160NK3	2160NK3			—
21x72	530x1829	24	10.9	A2172NK3	2172NK3			—
24x24	610x610	9	4.1	A2424NK3	2424NK3	16	7.2	2424DRK3
24x30	610x760	11	5.0	A2430NK3	2430NK3	20	9.0	2430DRK3
24x36	610x914	13	5.9	A2436NK3	2436NK3	24	10.8	2436DRK3
24x42	610x1060	15	6.8	A2442NK3	2442NK3			—
24x48	610x1219	16	7.3	A2448NK3	2448NK3	30	13.5	2448DRK3
24x54	610x1372	19	8.6	A2454NK3	2454NK3			—
24x60	610x1524	21	9.5	A2460NK3	2460NK3	37	16.6	2460DRK3
24x72	610x1829	26	11.8	A2472NK3	2472NK3			—

Super Erecta Pro shelves are also compatible on the same shelving units with the following Super Erecta items:

- Solid Shelves page 65
- Cantilever Shelves page 45
- SmartWall G3 page 72
- Post Type Wall Mounts page 79
- Direct Mount Shelf Supports page 80
- Three sided frames page 55
- Enclosure Panels page 54
- Security Units page 99
- Top Track page 92
- qwikTRAK page 90



Actual Dimensions: Width: Add 1/4" (6mm) to nominal size. Length: Subtract 1/4" (6mm) from nominal size.

Super Erecta Pro™ Shelving — 10.80

SiteSelect™ Posts

Stationary Super Erecta SiteSelect posts are fitted with adjustable leveling bolts to compensate for uneven surfaces. Mobile posts come without leveling bolt assembly to accommodate stem casters. Special length posts are available. See page 48 for stem caster options.



Stationary						Mobile					
Height		Approx. Pkd. Wt.		Cat. No.	Cat. No.	Height		Approx. Pkd. Wt.		Cat. No.	Cat. No.
(in.)	(mm)	(lbs.)	(kg)	Metroseal 3	Stainless	(in.)	(mm)	(lbs.)	(kg)	Metroseal 3	Stainless
14 ¹ / ₂	370	1	0.5	13PK3	13PS	13 ³ / ₄	349	1	0.5	13UPK3	13UPS
34 ¹ / ₂	875	2	0.9	33PK3	33PS	33 ³ / ₄	857	2	0.9	33UPK3	33UPS
54 ⁹ / ₁₆	1385	3	1.4	54PK3	54PS	53 ¹³ / ₁₆	1366	3	1.4	54UPK3	54UPS
62 ⁹ / ₁₆	1590	3 ¹ / ₂	1.6	63PK3	63PS	61 ¹³ / ₁₆	1570	3 ¹ / ₂	1.6	63UPK3	63UPS
74 ⁵ / ₈	1895	4	1.8	74PK3	74PS	69 ³ / ₄	1772	3.8	1.7	70UPK3	—
86 ⁵ / ₈	2200	5	2.3	86PK3	86PS	73 ⁷ / ₈	1876	4	1.8	74UPK3	74UPS
						85 ⁷ / ₈	2181	5	2.3	86UPK3	86UPS

Accessories — 10.81

Note: These accessories are designed to attach to a Super Erecta Pro Shelf. Accessories for basic Super Erecta wire shelves can be found on pages 53-60. For a complete list of compatible accessories for Super Erecta Pro shelves, please refer to spec sheet 10.81 for more information.

“S” Hooks

Eliminates the need for adjacent posts.

Two required for each storage level.

Cat. No. **Q9995Z**

Universal Divider

- Corrosion proof

Nominal Length		Fits Shelf Depth		Approx. Pkd. Wt.		Cat. No.
(in.)	(mm)	(in.)	(mm)	(lbs.)	(kg)	
18	457	18", 21"	(457, 530mm)	1.3	0.6	MUD18-8
24	610	24"	(610mm)	1.6	0.7	MUD24-8

Shelf-to-Shelf Divider

- Connects between two shelves
- Corrosion proof

Nominal Height		Compatible with Shelf Depths		Approx. Pkd. Wt.		Cat. No.
(in.)	(mm)	(in.)	(mm)	(lbs.)	(kg)	
16	406	18, 21	457, 530	2.3	1.0	MD18-16
20	508	18, 21	457, 530	2.5	1.1	MD18-20
24	610	18, 21	457, 530	3.8	1.7	MD18-24
16	406	24	610	2.8	1.2	MD24-16
20	508	24	610	3.0	1.3	MD24-20
24	610	24	610	4.4	2.0	MD24-24

Color Shelf Marker

- 6" (152mm) Length
- Fits Super Erecta Pro Shelf
- Attach easily to shelf to identify contents stored.

Color	Length		Approx. Pkd. Wt.		Cat. No.
	(in.)	(mm)	(lbs.)	(kg)	
Blue	6	152	0.05	0.02	CSM6-BQ
Green	6	152	0.05	0.02	CSM6-GQ
Red	6	152	0.05	0.02	CSM6-RQ
Tan	6	152	0.05	0.02	CSM6-TQ
White	6	152	0.05	0.02	CSM6-WQ
Yellow	6	152	0.05	0.02	CSM6-YQ
Gray	6	152	0.05	0.02	CSM6-GRQ



Label Holders

- Fits Super Erecta Pro Shelf
- Plastic holders snap into place to accommodate 1" (25mm) tall adhesive label.

Cat. No. **Q04LH**



Reclaim Wasted Space.



Super Adjustable™
Super Erecta® Shelving

Adjust and add shelves quickly and easily to reclaim wasted space.



Super Erecta

Easy “no-tool”
shelf adjustment

1" (25mm)
spacing minimizes
dead space

Efficient use of space
allows more storage
levels to be added.

**Storage efficiency
can increase
by 25% or more**



Super Adjustable
Super Erecta



SUPER ADJUSTABLE SUPER ERECTA® SHELVING

Super Adjustable Wire Shelves — 10.01a 10.10a

Packaging: Wire shelves are priced individually and packaged no more than 4 per carton except 60" (1524mm) and 72" (1829mm) lengths and 30" (760mm) and 36" (914mm) widths, which are packaged no more than 2 per carton. Plastic sleeves and wedges are included with each shelf.

Width/Length (in.) (mm)	Approx. Pkd. Wt. (lbs.) (kg)	Cat. No. Chrome	Cat. No. Metroseal 3 with Microban®	Cat. No. Stainless
14x24 355x610	6 2.7	A1424NC	A1424NK3	A1424NS
14x30 355x760	7 3.2	A1430NC	A1430NK3	A1430NS
14x36 355x914	8 3.6	A1436NC	A1436NK3	A1436NS
14x42 355x1066	9 1/2 4.3	A1442NC	A1442NK3	A1442NS
14x48 355x1219	10 1/2 4.7	A1448NC	A1448NK3	A1448NS
14x60 355x1524	14 6.3	A1460NC	A1460NK3	A1460NS
14x72 355x1825	17 7.7	A1472NC	A1472NK3	A1472NS
18x24 457x610	7 3.2	A1824NC	A1824NK3	A1824NS
18x30 457x760	8 3.6	A1830NC	A1830NK3	A1830NS
18x36 457x914	9 1/2 4.3	A1836NC	A1836NK3	A1836NS
18x42 457x1066	11 5.0	A1842NC	A1842NK3	A1842NS
18x48 457x1219	12 5.4	A1848NC	A1848NK3	A1848NS
18x54 457x1370	14 1/2 6.6	A1854NC	A1854NK3	A1854NS
18x60 457x1524	17 7.7	A1860NC	A1860NK3	A1860NS
18x72 457x1829	20 9.1	A1872NC	A1872NK3	A1872NS
21x24 530x610	8 3.6	A2124NC	A2124NK3	A2124NS
21x30 530x760	9 4.1	A2130NC	A2130NK3	A2130NS
21x36 530x914	11 5.0	A2136NC	A2136NK3	A2136NS
21x42 530x1066	12 5.4	A2142NC	A2142NK3	A2142NS
21x48 530x1219	14 6.4	A2148NC	A2148NK3	A2148NS
21x54 530x1370	16 7.3	A2154NC	A2154NK3	A2154NS
21x60 530x1524	18 8.2	A2160NC	A2160NK3	A2160NS
21x72 530x1829	24 10.9	A2172NC	A2172NK3	A2172NS
24x24 610x610	9 4.1	A2424NC	A2424NK3	A2424NS
24x30 610x760	11 5.0	A2430NC	A2430NK3	A2430NS
24x36 610x914	13 5.9	A2436NC	A2436NK3	A2436NS
24x42 610x1066	15 6.8	A2442NC	A2442NK3	A2442NS
24x48 610x1219	16 7.3	A2448NC	A2448NK3	A2448NS
24x54 610x1370	18 8.6	A2454NC	A2454NK3	A2454NS
24x60 610x1524	21 9.5	A2460NC	A2460NK3	A2460NS
24x72 610x1829	26 11.8	A2472NC	A2472NK3	A2472NS
30x36 760x914	15 6.8	A3036NC		A3036NS
30x48 760x1219	21 9.5	A3048NC		A3048NS
30x60 760x1524	26 1/2 11.8	A3060NC		A3060NS
30x72 760x1829	31 14.0	A3072NC		A3072NS
36x36 910x914	18 8.2	A3636NC		A3636NS
36x48 910x1219	23 10.4	A3648NC		A3648NS
36x60 910x1524	29 13.1	A3660NC		A3660NS
36x72 910x1829	34 1/2 15.4	A3672NC		A3672NS

Note: For availability of Super Adjustable Shelving not listed above, contact your Metro representative.

SiteSelect™ Posts — 10.01a 10.10a

Stationary Super Erecta® SiteSelect posts are fitted with adjustable leveling bolts to compensate for uneven surfaces. Mobile posts come without leveling bolt assembly to accommodate stem casters. Special length posts are available.†

STATIONARY					MOBILE			
Height* (in.) (mm)	Approx. Pkd. Wt. (lbs.) (kg)	Cat. No. Chrome	Cat. No. Metroseal 3 with Microban®	Cat. No. Stainless**	Approx. Pkd. Wt. (lbs.) (kg)	Cat. No. Plated	Cat. No. Metroseal 3 with Microban®	Cat. No. Stainless
7 1/2 191	1/2 0.3	7P						
14 1/2 370	1 0.5	13P	13PK3	13PS	1 0.5	13UP	13UPK3	13UPS
27 1/2 699	1 3/4 0.75	27P		27PS	1 3/4 0.75	27UP		27UPS
34 1/2 875	2 0.9	33P	33PK3	33PS	2 0.9	33UP	33UPK3	33UPS
54 9/16 1385	3 1.4	54P	54PK3	54PS	3 1.4	54UP	54UPK3	54UPS
62 9/16 1590	3 1/2 1.6	63P	63PK3	63PS	3 1/2 1.6	63UP	63UPK3	63UPS
74 5/8 1895	4 1.8	74P	74PK3	74PS	3 3/4 1.7		70UPK3	
86 5/8 2200	5 2.3	86P	86PK3	86PS	4 1.8	74UP	74UPK3	74UPS
96 5/8 2454	5 1/2 2.5	***96P			4.5 2.0	86UP	86UPK3	86UPS

*Height includes leveling bolt and cap.

**Stainless stationary post includes stainless leveling bolt.

***96P should not be used on units less than 24" (610mm) deep. Consult Metro Engineering for alternate recommendations.

†Note: Special length posts are available, priced at next higher length plus a cutting charge.

Post lengths to be specified as cut to a round number, ie: 74P cut to 69" (1753mm) . . . This will result in an overall post height with adjustment of 69 3/8" (1762mm) to 69 5/8" (1775mm).

*MICROBAN® and the MICROBAN® symbol are registered trademarks of the Microban Products Company, Huntersville, NC. Indicates antimicrobial product.



Shelving Starter and Add-On Units

Save time and money by eliminating adjacent posts and replacing with "S" hooks.

- Starter Units consist of four posts and indicated number of Super Adjustable Super Erecta shelves.
- Add-On Units consist of two posts, indicated number of shelves, and two "S" Hooks per shelf, for attaching shelf to adjacent unit.



Replacement "S" Hook
2 are required for each storage level.
Cat. No. **9995Z**

For additional wire shelves, order from page 37.

Add-on units with "S" hooks can only be attached to shelves supported by two or more posts.



Security "S" Hook
2 are required for each storage level.
Chrome. Cat. No. **H9995C**
Bag of 2
Black. Cat. No. **H9995B**
Bag of 2

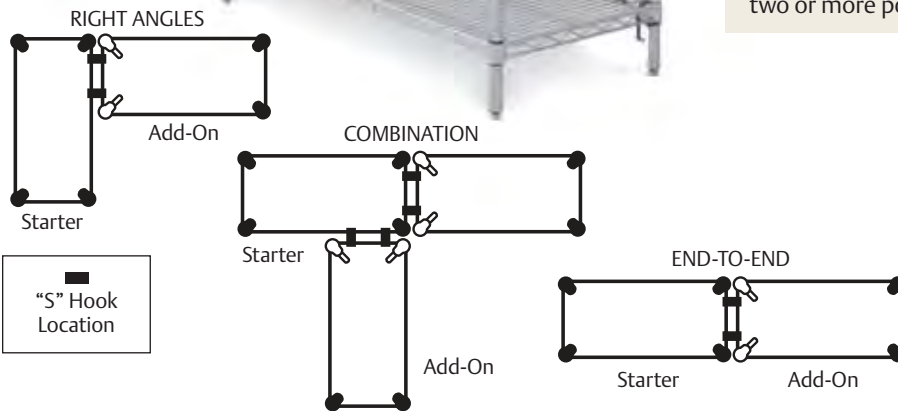

Indicates antimicrobial product.

Shelving Starter and Add-On Units — Easy Order Guide

	Chrome-Plated						Metroseal 3 with Microban®												
	5 Shelves 74" (1880mm) Posts (74P)		18" (457mm) Wide		21" (530mm) Wide		24" (610mm) Wide		5 Shelves 74" (1880mm) Posts (74PK3)		18" (457mm) Wide		21" (530mm) Wide		24" (610mm) Wide				
	Starter	Add-On	Starter	Add-On	Starter	Add-On	Starter	Add-On	Starter	Add-On	Starter	Add-On	Starter	Add-On	Starter	Add-On			
24" (610mm)	5A317C	5AA317C	5A417C	5AA417C	5A517C	5AA517C	5A317K3	5AA317K3	5A417K3	5AA417K3	5A517K3	5AA517K3	5A317K3	5AA317K3	5A417K3	5AA417K3	5A517K3	5AA517K3	
Long	Wt. lbs. (kg)	51 (23)	43 (20)	57 (26)	48 (22)	62 (28)	53 (24)	51 (23)	43 (20)	57 (26)	48 (22)	62 (28)	53 (24)	51 (23)	43 (20)	57 (26)	48 (22)	62 (28)	53 (24)
30" (760mm)	5A327C	5AA327C	5A427C	5AA427C	5A527C	5AA527C	5A327K3	5AA327K3	5A427K3	5AA427K3	5A527K3	5AA527K3	5A327K3	5AA327K3	5A427K3	5AA427K3	5A527K3	5AA527K3	
Long	Wt. lbs. (kg)	58 (26)	50 (23)	64 (29)	56 (25)	71 (32)	62 (28)	58 (26)	50 (23)	64 (29)	56 (25)	71 (32)	62 (28)	58 (26)	50 (23)	64 (29)	56 (25)	71 (32)	62 (28)
36" (914mm)	5A337C	5AA337C	5A437C	5AA437C	5A537C	5AA537C	5A337K3	5AA337K3	5A437K3	5AA437K3	5A537K3	5AA537K3	5A337K3	5AA337K3	5A437K3	5AA437K3	5A537K3	5AA537K3	
Long	Wt. lbs. (kg)	65 (29)	57 (26)	73 (33)	65 (29)	81 (37)	73 (33)	65 (29)	57 (26)	73 (33)	65 (29)	81 (37)	73 (33)	65 (29)	57 (26)	73 (33)	65 (29)	81 (37)	73 (33)
42" (1066mm)	5A347C	5AA347C	5A447C	5AA447C	5A547C	5AA547C	5A347K3	5AA347K3	5A447K3	5AA447K3	5A547K3	5AA547K3	5A347K3	5AA347K3	5A447K3	5AA447K3	5A547K3	5AA547K3	
Long	Wt. lbs. (kg)	70 (32)	62 (28)	81 (37)	73 (33)	89 (40)	81 (37)	70 (32)	62 (28)	81 (37)	73 (33)	89 (40)	81 (37)	70 (32)	62 (28)	81 (37)	73 (33)	89 (40)	81 (37)
48" (1219mm)	5A357C	5AA357C	5A457C	5AA457C	5A557C	5AA557C	5A357K3	5AA357K3	5A457K3	5AA457K3	5A557K3	5AA557K3	5A357K3	5AA357K3	5A457K3	5AA457K3	5A557K3	5AA557K3	
Long	Wt. lbs. (kg)	78 (35)	70 (32)	88 (40)	80 (36)	98 (44)	90 (41)	78 (35)	70 (32)	88 (40)	80 (36)	98 (44)	90 (41)	78 (35)	70 (32)	88 (40)	80 (36)	98 (44)	90 (41)
60" (1524mm)	5A367C	5AA367C	5A467C	5AA467C	5A567C	5AA567C	5A367K3	5AA367K3	5A467K3	5AA467K3	5A567K3	5AA567K3	5A367K3	5AA367K3	5A467K3	5AA467K3	5A567K3	5AA567K3	
Long	Wt. lbs. (kg)	102 (46)	93 (42)	109 (49)	101 (46)	122 (55)	113 (51)	102 (46)	93 (42)	109 (49)	101 (46)	122 (55)	113 (51)	102 (46)	93 (42)	109 (49)	101 (46)	122 (55)	113 (51)
72" (1829mm)	5A377C	5AA377C	5A477C	5AA477C	5A577C	5AA577C	5A377K3	5AA377K3	5A477K3	5AA477K3	5A577K3	5AA577K3	5A377K3	5AA377K3	5A477K3	5AA477K3	5A577K3	5AA577K3	
Long	Wt. lbs. (kg)	117 (53)	108 (49)	122 (55)	113 (51)	149 (68)	141 (64)	117 (53)	108 (49)	122 (55)	113 (51)	149 (68)	141 (64)	117 (53)	108 (49)	122 (55)	113 (51)	149 (68)	141 (64)

Super Adjustable Super Erecta® Stem Caster Carts — **11.01a**

- Four- and five-tier models available.
- Consists of Super Adjustable Super Erecta wire shelves.
- 5" (127mm) resilient rubber or polyurethane casters with donut bumpers.
- Super Adjustable Super Erecta shelves allow for quick and easy adjustability.
- Open-wire shelf design minimizes dust and increases air circulation and visibility.
- Strong and versatile. (See Metro Fact below)
- For additional storage levels, Super Adjustable shelves may be added as desired. (See page 37.)



Super Adjustable Super Erecta® Wire Stem Caster Cart

Metro Fact:
Carts with polyurethane casters are designed to hold up to 900 lbs. (408kg). Carts with rubber casters can hold up to 600 lbs. (272kg) of evenly distributed weight. Heavier weight loads should be stored as low as possible on cart for safe maneuverability.



Lift the release at each corner to adjust Super Adjustable shelves at 1" (25mm) increments in seconds.

Use a solid shelf on the lowest levels to protect contents on the bottom of the cart from debris and dripping. (See page 65).

4-Tier Models

With Chrome Shelves and Chrome-Plated Posts
63" (1600mm) Posts — Overall Height 69" (1753mm)

Shelf Width/Length (in.)	Shelf Width/Length (mm)	Approx. Pkd. Wt. (lbs.)	Approx. Pkd. Wt. (kg)	Catalog Number with Casters	
				Two Swivel Two Brake Resilient Rubber Casters	Two Swivel Two Brake Polyurethane Casters
18x36	457x914	60	27	A336BC	A336EC
18x48	457x1219	72	32	A356BC	A356EC
18x60	457x1524	88	40	A366BC	A366EC
21x36	530x914	69	31	A436BC	A436EC
21x48	530x1219	81	36	A456BC	A456EC
21x60	530x1524	98	44	A466BC	A466EC
24x36	610x914	76	34	A536BC	A536EC
24x48	610x1219	92	41	A556BC	A556EC
24x60	610x1524	112	51	A566BC	A566EC

5-Tier Models

With Chrome Shelves and Chrome-Plated Posts
63" (1600mm) Posts — Overall Height 69" (1753mm)

Shelf Width/Length (in.)	Shelf Width/Length (mm)	Approx. Pkd. Wt. (lbs.)	Approx. Pkd. Wt. (kg)	Catalog Number with Casters	
				Two Swivel Two Brake Resilient Rubber Casters	Two Swivel Two Brake Polyurethane Casters
18x36	457x914	60	27	5A336BC	5A336EC
18x48	457x1219	72	32	5A356BC	5A356EC
18x60	457x1524	88	40	5A366BC	5A366EC
21x36	530x914	69	31	5A436BC	5A436EC
21x48	530x1219	81	36	5A456BC	5A456EC
21x60	530x1524	98	44	5A466BC	5A466EC
24x36	610x914	76	34	5A536BC	5A536EC
24x48	610x1219	92	41	5A556BC	5A556EC
24x60	610x1524	112	51	5A566BC	5A566EC

Genuine Quality.

Genuine Metro!

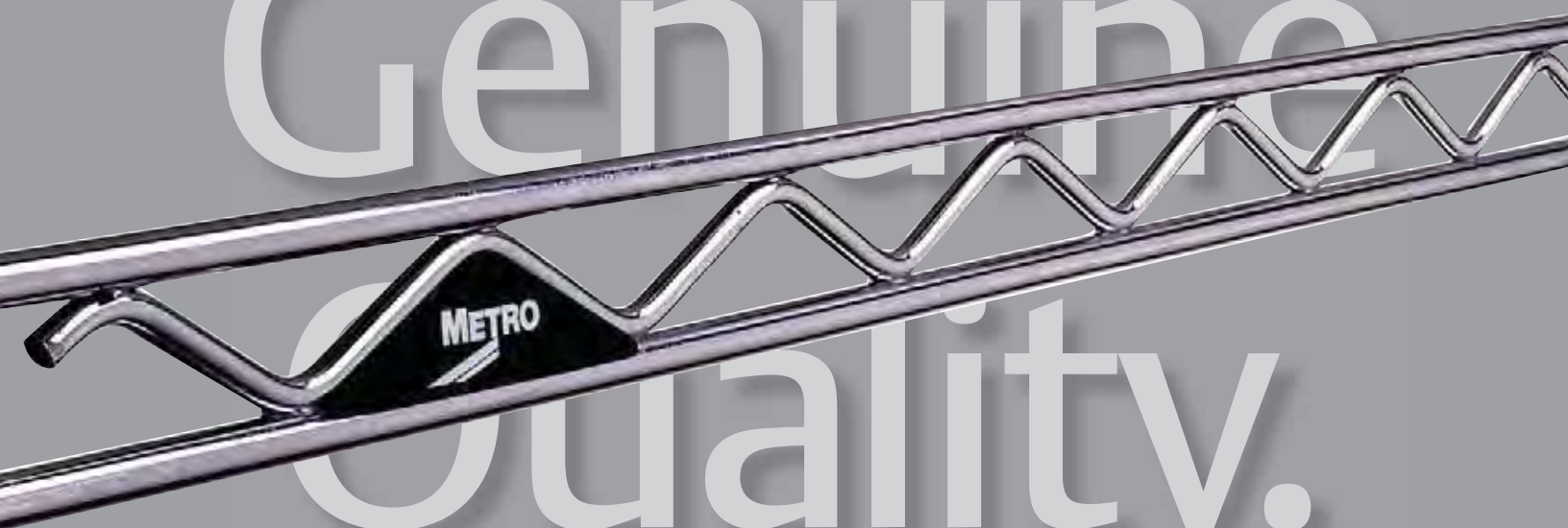

Super Erecta® Shelving System The original wire storage system.

A storage system that defines the extent of space, Super Erecta's revolutionary concept was fresh and innovative from its start — nearly 30 years ago. It has continued to evolve, with nearly 100 highly specialized accessories, aimed at meeting the diversity of today's challenges.

- Adjustable: Shelves can be repositioned at precise 1" (25mm) increments along the length of the numbered posts.
- Unique Design: Open-wire design minimizes dust accumulation, allows a free circulation of air, and greater visibility of stored items.
- Mobile: Full choice of caster types available for mobile applications.



Metro Fact:

Genuine Metro!

Metro created the original post-based shelving unit in 1965. Still today, Metro Super Erecta Shelving is recognized worldwide as the most popular commercial shelving system ever.

Strong to the Finish.

Shelving Finishes Guide



Wire & Solid

Type 304 Polished Stainless Steel

Addresses the most aggressive applications and environments. All-stainless solid and wire options exist for high temperature automated cart wash and autoclave applications.



Metroseal 3™ Epoxy

Corrosion resistant finish for wet or high humidity environments with a 12 year warranty against rust and corrosion. Microban antimicrobial is built into the finish to keep the product “cleaner between cleanings”.



Chrome Plating

The “real” nickel-chrome finish for dry, low humidity environments. Metro’s durable chrome finish includes a protective lacquer coat.



Brite

Economical, chromate finish for dry, low humidity environments. Metro’s Brite finish provides the look of chrome and includes a protective lacquer coat.



Standard Epoxy and Designer Finishes

A pleasing aesthetic and basic protection for dry environments.



Shelving Post Guide

Standard Stationary Post with adjustable leveling foot. Stainless models also feature a stainless leveling foot. Use Foot Plates for greater stability.

Standard Stem Caster Mobile Post accepts a Metro stem caster. Use these for the majority of standard duty transport and movable storage applications.

Cart Wash and Autoclave Applications

Swaged stainless post has a fastened aluminum post cap and is specifically designed to withstand high temperatures. See page 48 for part numbers.

Heavy Duty Transport

Staked post attaches to a dolly truck to address abusive transport applications. The reinforced connection between the base receptacle and post provides a more secure connection to the dolly truck. See page 50 for part numbers.

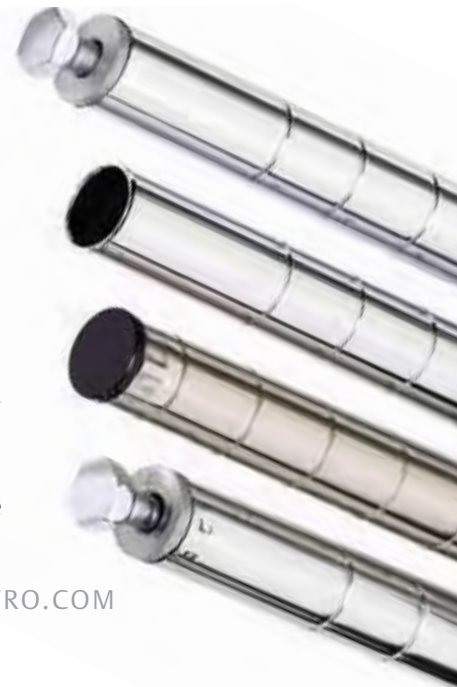



Wire Shelves — 10.01a 10.10a

Packaging: Wire shelves are priced individually and packaged no more than 4 per carton except 60" (1524mm) and 72" (1829mm) lengths and 30" (760mm) and 36" (914mm) widths, which are packaged no more than 2 per carton. Plastic sleeves and wedges are included with each shelf.

Width/Length (in.)	Width/Length (mm)	Approx. Pkd. Wt. (lbs.)	Pkd. Wt. (kg)	Cat. No. Super Erecta Brite	Cat. No. Chrome	Cat. No. Metroseal 3 with Microban®	Cat. No. Stainless
14x24	355x610	6	2.7	1424BR	1424NC	1424NK3	1424NS
14x30	355x760	7	3.2	1430BR	1430NC	1430NK3	1430NS
14x36	355x914	8	3.6	1436BR	1436NC	1436NK3	1436NS
14x42	355x1066	9½	4.3	1442BR	1442NC	1442NK3	1442NS
14x48	355x1219	10½	4.7	1448BR	1448NC	1448NK3	1448NS
14x60	355x1524	14	6.3	1460BR	1460NC	1460NK3	1460NS
14x72	355x1829	17	7.7	1472BR	1472NC	1472NK3	1472NS
18x18	457x457	6	2.7	N/A	1818NC	N/A	N/A
18x24	457x610	7	3.2	1824BR	1824NC	1824NK3	1824NS
18x30	457x760	8	3.6	1830BR	1830NC	1830NK3	1830NS
18x36	457x914	9½	4.3	1836BR	1836NC	1836NK3	1836NS
18x42	457x1066	11	5.0	1842BR	1842NC	1842NK3	1842NS
18x48	457x1219	12	5.4	1848BR	1848NC	1848NK3	1848NS
18x54	457x1370	14½	6.6	1854BR	1854NC	1854NK3	1854NS
18x60	457x1524	17	7.7	1860BR	1860NC	1860NK3	1860NS
18x72	457x1829	20	9.1	1872BR	1872NC	1872NK3	1872NS
21x24	530x610	8	3.6	2124BR	2124NC	2124NK3	2124NS
21x30	530x760	9	4.1	2130BR	2130NC	2130NK3	2130NS
21x36	530x914	11	5.0	2136BR	2136NC	2136NK3	2136NS
21x42	530x1066	12	5.4	2142BR	2142NC	2142NK3	2142NS
21x48	530x1219	14	6.4	2148BR	2148NC	2148NK3	2148NS
21x54	530x1370	16	7.3	2154BR	2154NC	2154NK3	2154NS
21x60	530x1524	18	8.2	2160BR	2160NC	2160NK3	2160NS
21x72	530x1829	24	10.9	2172BR	2172NC	2172NK3	2172NS
24x24	610x610	9	4.1	2424BR	2424NC	2424NK3	2424NS
24x30	610x760	11	5.0	2430BR	2430NC	2430NK3	2430NS
24x36	610x914	13	5.9	2436BR	2436NC	2436NK3	2436NS
24x42	610x1066	15	6.8	2442BR	2442NC	2442NK3	2442NS
24x48	610x1219	16	7.3	2448BR	2448NC	2448NK3	2448NS
24x54	610x1370	19	8.6	2454BR	2454NC	2454NK3	2454NS
24x60	610x1524	21	9.5	2460BR	2460NC	2460NK3	2460NS
24x72	610x1829	26	11.8	2472BR	2472NC	2472NK3	2472NS
30x36	760x914	15	6.8		3036NC	3036NK3	3036NS
30x48	760x1219	21	9.5		3048NC	3048NK3	3048NS
30x60	760x1524	26½	11.8		3060NC	3060NK3	3060NS
30x72	760x1829	31	14.0		3072NC	3072NK3	3072NS
36x36	910x914	18	8.2		3636NC	3636NK3	3636NS
36x48	910x1219	23	10.4		3648NC	3648NK3	3648NS
36x60	910x1524	29	13.1		3660NC	3660NK3	3660NS
36x72	910x1829	34½	15.4		3672NC	3672NK3	3672NS

Note: With 14" (355mm) shelving, foot plates must be used on freestanding units; on mobile units, maximum post height is 54" (1370mm). It is not recommended to use 14" (355mm) shelving with posts higher than 74" (1880mm).
Note: The actual length of the shelves is 1/8" (3.2mm) shorter than the nominal dimension shown. The actual depth of the shelves is 1/8" (3.2mm) greater than the nominal dimension shown.
Note: Metroseal 3 is not cart-washable.
Note: Super Erecta wire shelves up to 24" (610mm) deep and 48" (1219mm) long can hold up to 800 lbs. (363kg) per shelf evenly distributed. Shelves up to 24" deep and longer than 48" (1219mm) can hold up to 600 lbs. (272kg) per shelf evenly distributed.
Note: 30" and 36" (760 and 910mm) deep Super Erecta wire shelves up to 48" (1219mm) long can hold up to 600 lbs. (272kg) per shelf evenly distributed. 30" and 36" (760 and 910mm) deep Super Erecta wire shelves longer than 48" (1219mm) can hold up to 400 lbs. (182kg) per shelf evenly distributed.

SiteSelect™ Posts

— 10.01a 10.10a

Stationary Super Erecta® SiteSelect posts are fitted with adjustable leveling bolts to compensate for uneven surfaces. Mobile posts come without leveling bolt assembly to accommodate stem casters. Special length posts are available. †

STATIONARY						MOBILE				
Height* (in.)	Height* (mm)	Approx. Pkd. Wt. (lbs.)	Pkd. Wt. (kg)	Cat. No. Chrome	Cat. No. Metroseal 3 with Microban®	Approx. Pkd. Wt. (lbs.)	Cat. No. Plated	Cat. No. Metroseal 3 with Microban®	Cat. No. Stainless	
7½	191	½	0.3	7P		1	0.5	13UP	13UPK3	13UPS
14½	370	1	0.5	13P	13PK3	1¾	0.75	27UP		27UPS
27½	699	1¾	0.75	27P		2	0.9	33UP	33UPK3	33UPS
34½	875	2	0.9	33P	33PK3	3	1.4	54UP	54UPK3	54UPS
54¾/16	1385	3	1.4	54P	54PK3	3½	1.6	63UP	63UPK3	63UPS
62¾/16	1590	3½	1.6	63P	63PK3	3¾	1.7		70UPK3	
74¾/8	1895	4	1.8	74P	74PK3	4	1.8	74UP	74UPK3	74UPS
86¾/8	2200	5	2.3	86P	86PK3	4.5	2.0	86UP	86UPK3	86UPS
96¾/8	2454	5½	2.5	***96P						

*Height includes leveling bolt and cap.
 **Stainless stationary post includes stainless leveling bolt.
 ***96P should not be used on units less than 24" (610mm) deep. Consult Metro Engineering for alternate recommendations.
 †Note: Special length posts are available, priced at next higher length plus a cutting charge. Post lengths to be specified as cut to a round number, ie: 74P cut to 69" (1753mm) . . . This will result in an overall post height with adjustment of 69¾" (1762mm) to 69¾" (1775mm).
 Casters for mobile applications can be found on pages 48 & 49.

Indicates antimicrobial product.

Designer Color Shelving — 10.14

Available in a wide spectrum of colors that complement any decor.

Width/Length (in.) (mm)	Approx. Pkd. Wt. (lbs.) (kg)	STANDARD COLORS			DESIGNER COLORS			
		Cat. No. Black	Cat. No. White	Cat. No. Smoked Glass	Cat. No. Flame	Cat. No. Designer Colors*		
14x24	355x610	6	2.7	1424NBL	1424NW	1424N-DSG	1442NF	1424N-D
14x30	355x760	7	3.2	1430NBL	1430NW	1430N-DSG	1430NF	1430N-D
14x36	355x914	8	3.6	1436NBL	1436NW	1436N-DSG	1436NF	1436N-D
14x42	355x1066	9 1/2	4.3	1442NBL	1442NW	1442N-DSG	1442NF	1442N-D
14x48	355x1219	10 1/2	4.7	1448NBL	1448NW	1448N-DSG	1448NF	1448N-D
14x60	355x1524	14	6.3	1460NBL	1460NW	1460N-DSG	1460NF	1460N-D
14x72	355x1829	17	7.7	1472NBL	1472NW	1472N-DSG	1472NF	1472N-D
18x18	457x457	6	2.7	1818NBL	1818NW	1818N-DSG	1818NF	1818N-D
18x24	457x610	7	3.2	1824NBL	1824NW	1824N-DSG	1824NF	1824N-D
18x30	457x760	8	3.6	1830NBL	1830NW	1830N-DSG	1830NF	1830N-D
18x36	457x914	9 1/2	4.3	1836NBL	1836NW	1836N-DSG	1836NF	1836N-D
18x42	457x1066	11	5.0	1842NBL	1842NW	1842N-DSG	1842NF	1842N-D
18x48	457x1219	12	5.4	1848NBL	1848NW	1848N-DSG	1848NF	1848N-D
18x54	457x1370	14 1/2	6.6	1854NBL	1854NW	1854N-DSG	1854NF	1854N-D
18x60	457x1524	17	7.7	1860NBL	1860NW	1860N-DSG	1860NF	1860N-D
18x72	457x1829	20	9.1	1872NBL	1872NW	1872N-DSG	1872NF	1872N-D
21x24	530x610	8	3.6	2124NBL	2124NW	2124N-DSG	2124NF	2124N-D
21x30	530x760	9	4.1	2130NBL	2130NW	2130N-DSG	2130NF	2130N-D
21x36	530x914	11	5.0	2136NBL	2136NW	2136N-DSG	2136NF	2136N-D
21x42	530x1066	12	5.4	2142NBL	2142NW	2142N-DSG	2142NF	2142N-D
21x48	530x1219	14	6.4	2148NBL	2148NW	2148N-DSG	2148NF	2148N-D
21x54	530x1370	16	7.3	2154NBL	2154NW	2154N-DSG	2154NF	2154N-D
21x60	530x1524	18	8.2	2160NBL	2160NW	2160N-DSG	2160NF	2160N-D
21x72	530x1829	24	10.9	2172NBL	2172NW	2172N-DSG	2172NF	2172N-D
24x24	610x610	9	4.1	2424NBL	2424NW	2424N-DSG	2424NF	2424N-D
24x30	610x760	11	5.0	2430NBL	2430NW	2430N-DSG	2430NF	2430N-D
24x36	610x914	13	5.9	2436NBL	2436NW	2436N-DSG	2436NF	2436N-D
24x42	610x1066	15	6.8	2442NBL	2442NW	2442N-DSG	2442NF	2442N-D
24x48	610x1219	16	7.3	2448NBL	2448NW	2448N-DSG	2448NF	2448N-D
24x54	610x1370	19	8.6	2454NBL	2454NW	2454N-DSG	2454NF	2454N-D
24x60	610x1524	21	9.5	2460NBL	2460NW	2460N-DSG	2460NF	2460N-D
24x72	610x1829	26	11.8	2472NBL	2472NW	2472N-DSG	2472NF	2472N-D

Note: White epoxy Super Erecta shelves come with white split sleeves.
 Note: All Black, Smoked Glass and Designer Super Erecta shelves come with black split sleeves.
 Note: Black shelving is NSF listed. White, Smoked Glass, and Designer Colors are not NSF listed.

Posts — 10.14

Height* (in.) (mm)	Approx. Pkd. Wt. (lbs.) (kg)	STATIONARY					MOBILE (FOR STEM CASTERS)								
		Cat. No. Black	Cat. No. White	Cat. No. Smoked Glass	Cat. No. Flame	Cat.No. Designer Colors*	Cat. No. Black	Cat. No. White	Cat. No. Smoked Glass	Cat. No. Flame	Cat. No. Designer Colors*				
7 1/2	191	1/2	0.3	7PBL	7PW	7P-DSG	7PF	7P-D							
14 1/2	370	1	0.5	13PBL	13PW	13P-DSG	13PF	13P-D							
27 1/2	699	1 3/4	0.75	27PBL	27PW	27P-DSG	27PF	27P-D	1 3/4	0.75	27UPBL	27UPW	27UP-DSG	27UPF	27UP-D
34 1/2	875	2	0.9	33PBL	33PW	33P-DSG	33PF	33P-D	2	0.9	33UPBL	33UPW	33UP-DSG	33UPF	33UP-D
54 9/16	1385	3	1.4	54PBL	54PW	54P-DSG	54PF	54P-D	3	1.4	54UPBL	54UPW	54UP-DSG	54UPF	54UP-D
62 9/16	1590	3 1/2	1.6	63PBL	63PW	63P-DSG	63PF	63P-D	3 1/2	1.6	63UPBL	63UPW	63UP-DSG	63UPF	63UP-D
74 5/8	1895	4	1.8	74PBL	74PW	74P-DSG	74PF	74P-D	4	1.8	74UPBL	74UPW	74UP-DSG	74UPF	74UP-D
86 5/8	2200	5	2.3	86PBL	86PW	86P-DSG	86PF	86P-D	4.5	2.0	86UPBL	86UPW	86UP-DSG	86UPF	86UP-D

Standard Colors				Designer Colors*			
Black	White	Smoked Glass	Flame (F)	Black Matte (BM)	Hunter Green (HG)	Copper Hammertone (CH)	Silver Hammertone (SH)

*For Designer Colors: BM, HG, CH, SH
 *To order a Designer Color, add the appropriate color suffix to the desired catalog numbers above.
 Example: 18" x 36" (457 x 914mm) Hunter Green Shelf = 1836N-DHG
 74" (1880mm) stationary Hunter Green Post = 74P-DHG.



Post Boot

Post Boots with *Microban® Product Protection — **10.06** Patent Pending. Seals out moisture and protects the post from corrosion in areas where floors are mopped regularly. Easily slips over the bottom 5" (127mm) of

a stationary post. Built-in Microban antimicrobial. Use with standard leveling bolt or foot plates. Bags of 4. Cat. No. **9982GR-4**



Post Clamp

Post Clamps — **10.06** Joins units together for maximum strength. Zinc-plated. Cat. No. **9994Z**

Black. Cat. No. **9994BL**



Aluminum Split Sleeve

Aluminum Split Sleeves — **10.06** For high temperature, over the road, or conductive applications. Zinc or stainless steel retainer rings available to secure shelf. One bag required per shelf; 4 pairs per bag.



Foot Plate

Foot Plates — **10.06** Use to bolt units to the floor, or when a broader, more stable foot is desired. Zinc. Cat. No. **9993Z**

Stainless Steel. Cat. No. **9993S**

Black. Cat. No. **9993BL**



Black Split Sleeve



White Split Sleeve

Replacement Plastic Split Sleeves — **10.06** One bag required per shelf; 4 pairs per bag.

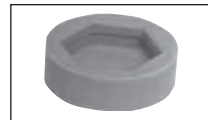

Glide

Glides — **10.06** Smooth polymer cover fits over leveling bolt to protect floors. Cat. No. **9991P**

	Cat. No.
Black Plastic Split Sleeves	9985
White Plastic Split Sleeves	9985W

Note: White post caps and white split sleeves are standard with white designer shelving only.



Decorative Leveling Foot

Decorative Leveling Foot — **10.06** Decorative alternative for post. Compensates for uneven surfaces. Chrome. Cat. No. **HDFC**

Black. Cat. No. **HDFB**



Replacement Super Adjustable Kit

Replacement Super Adjustable Kit Package includes 4 wedges, 4 sleeves, and 4 corner releases. Cat. No. **SAKITA2**



Basket Shelf (Posts sold separately, see page 42)

Basket Shelf — **10.04** 3 1/2" (89mm) deep basket with 400 lb. (182kg) weight capacity. Ideal for containing and displaying smaller items.

Size (in.)	Size (mm)	Cat. No.	
		Chrome	Black
14x36	355x914	—	DD3448A
14x48	355x1219	—	DD3448B
18x36	457x914	CC9744A	CC9744C
18x48	457x1219	CC9744	CC9744B

*MICROBAN® and the MICROBAN® symbol are registered trademarks of the Microban Products Company, Huntersville, NC.



Super Erecta® Convenience Pak™ — 10.03

- Providing a complete shelving unit in a single box, Convenience Pak shelving is the easy-to-order alternative to separate shelving components.
- Available in Super Erecta Brite, chrome and Metroseal 3 finishes.



Unassembled Convenience Pak™
Each pack includes four shelves with split sleeves and four split posts with leveling feet.



Convenience Pak unit in Chrome finish

Width/Length/Height (in./mm)		Approx. Pkd. Wt. (lbs./kg)		Cat. No. Super Erecta Brite	Cat. No. Chrome	Cat. No. Metroseal 3 with Microban®
18x36x74 1/2	457x914x1890	51	23	EZ1836BR-4	EZ1836NC-4	EZ1836NK3-4
18x48x74 1/2	457x1219x1890	63	28.5	EZ1848BR-4	EZ1848NC-4	EZ1848NK3-4
18x60x74 1/2	457x1524x1890	82	37	EZ1860BR-4	EZ1860NC-4	EZ1860NK3-4
24x36x74 1/2	610x914x1890	66	30	EZ2436BR-4	EZ2436NC-4	EZ2436NK3-4
24x48x74 1/2	610x1219x1890	76	34.5	EZ2448BR-4	EZ2448NC-4	EZ2448NK3-4
24x60x74 1/2	610x1524x1890	102	46	EZ2460BR-4	EZ2460NC-4	EZ2460NK3-4



Heavy-Duty Dunnage Shelves — 10.45

Enhance the weight-bearing capacity of your system.

- 36" (914mm) shelf holds 1,600 pounds (725kg) (uniformly distributed); 48" (1219mm) shelves carry up to 1,300 pounds (590kg); 60" (1524mm) shelves bear up to 1,000 pounds (453kg).
- Removable wire mat: 5/16" (7.9mm) diameter wire.
- Support frames: 1" (25mm) square tubing lifts off for easy cleaning.

Width/Length (in./mm)		Approx. Pkd. Wt. (lbs./kg)		Cat. No. Chrome	Cat. No. Metroseal 3 with Microban®	Cat. No. Stainless
18x24	457x610	14	6.3	1824DRC	1824DRK3	—
18x30	457x760	18	8.1	1830DRC	1830DRK3	—
18x36	457x914	21	9.4	1836DRC	1836DRK3	1836DRS
18x48	457x1219	28	12.6	1848DRC	1848DRK3	1848DRS
18x60	457x1524	34	15.3	1860DRC	1860DRK3	1860DRS
24x24	610x610	16	7.2	2424DRC	2424DRK3	—
24x30	610x760	20	9.0	2430DRC	2430DRK3	—
24x36	610x914	24	10.8	2436DRC	2436DRK3	2436DRS
24x48	610x1219	30	13.5	2448DRC	2448DRK3	2448DRS
24x60	610x1524	37	16.6	2460DRC	2460DRK3	2460DRS

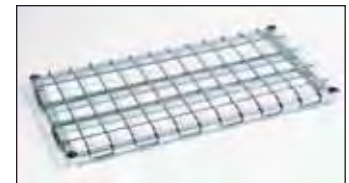

Dunnage Shelf



Important: In stationary shelving, stability decreases as the ratio of height to width increases and when heavier loads are placed on upper shelves. Shelving stability is attained by keeping units as wide and low as possible, and placing heavy loads low on the shelving unit.

Cantilever Shelves — 10.06

Adds convenient space above a storage unit. Drop mat design creates a retaining ledge around the entire 12" (305mm) deep shelf. Remember to order rear posts taller than front posts to accommodate these shelves.

Length (in./mm)	Approx. Pkd. Wt. Each (lbs./kg)	Cat. No. Chrome	Cat. No. Black	Cat. No. White	Cat. No. Smoked Glass
24 610	4 1/2 2.0	1224CSNC	1224CSNBL	1224CSNW	1224CSN-DSG
30 750	5 2.3	1230CSNC	1230CSNBL	1230CSNW	1230CSN-DSG
36 914	5 3/4 2.6	1236CSNC	1236CSNBL	1236CSNW	1236CSN-DSG
42 1066	6 3/4 3.1	1242CSNC	1242CSNBL	1242CSNW	1242CSN-DSG
48 1219	7 3/4 3.5	1248CSNC	1248CSNBL	1248CSNW	1248CSN-DSG
60 1524	9 1/2 4.3	1260CSNC	1260CSNBL	1260CSNW	1260CSN-DSG



Cantilever Shelves



Indicates antimicrobial product.



Wire Stem Caster Cart

Stem Caster Carts — Wire — **11.01**

Open-wire shelf design minimizes dust and increases air circulation and visibility. Casters included. 63" (1600mm) Posts — Overall Height 67⁷/₈" (1724mm)

Shelf Width/Length (in.) (mm)	Approx. Pkd. Wt. (lbs.) (kg)	Super Erecta Brite Finish		Chrome Finish	
		Two Swivel Two Brake Resilient Rubber Casters	Two Swivel Two Brake Polyurethane Casters	Two Swivel Two Brake Resilient Rubber Casters	Two Swivel Two Brake Polyurethane Casters
18x36 457x914	60 27	N336BBR	N336EBR	N336BC	N336EC
18x48 457x1219	72 32	N356BBR	N356EBR	N356BC	N356EC
18x60 457x1524	88 40	N366BBR	N366EBR	N366BC	N366EC
21x36 530x914	69 31	N436BBR	N436EBR	N436BC	N436EC
21x48 530x1219	81 36	N456BBR	N456EBR	N456BC	N456EC
21x60 530x1524	98 44	N466BBR	N466EBR	N466BC	N466EC
24x36 610x914	76 34	N536BBR	N536EBR	N536BC	N536EC
24x48 610x1219	92 41	N556BBR	N556EBR	N556BC	N556EC
24x60 610x1524	112 51	N566BBR	N566EBR	N566BC	N566EC



Solid Stem Caster with galvanized shelves

Stem Caster Carts — Solid — **11.10**

- Consist of four shelves, posts, plastic split sleeves, donut bumpers and 5" (127mm) poly casters (2 swivel; 2 brake).
- Strong and versatile
- Solid Shelf Stem Caster Carts feature a 1/8" (3mm) raised "ship's edge" around perimeter of shelves to help contain spillage.

With Four Galvanized Flat Shelves and Chrome-Plated Posts
63" (1600mm) Posts — Overall Height 67⁷/₈" (1724mm)

Shelf Width/Length (in.) (mm)	Approx. Pkd. Wt. (lbs.) (kg)	Cat. No.
24x36 610x914	100 45	F536EG
24x48 610x1219	124 56	F556EG
24x60 610x1524	152 69	F566EG



Basket Cart

Two-Shelf Basket Cart

Each 3¹/₂" (89mm) deep basket keeps items secure. Customize a basket cart from the following components:

- Page 42 — Mobile posts
- Page 44 — Basket shelves
- Page 48 — Casters

Super Erecta Trucks — With Super Erecta Chrome Wire Shelves — **11.25**
63" (1600mm) Plated Posts and Aluminum Dolly

Consists of four shelves, posts, plastic split sleeves, donut bumpers and 5" (127mm), resilient rubber or poly casters as designated.

Shelf Width/Length (in.) (mm)	Approx. Pkd. Wt. (lbs.) (kg)	Catalog Number with Casters		
		Two B5DN Two B5DNB	Two B5P Two B5PB	Two 6P Set BL6P
24x36 610x914	96 43	N536JC	N536LC	N536MC
24x48 610x1219	118 53	N556JC	N556LC	N556MC
24x60 610x1524	142 64	N566JC	N566LC	N566MC

Overall heights: JC, LC models — 68⁷/₁₆" (1739mm), MC models — 70¹/₁₆" (1800mm).

- JC models: Standard swivel plate casters, two with brake; resilient rubber tread.
- LC models: Standard swivel plate casters, two with brake; polyurethane tread.
- MC models: Larger plate casters; two swivel; one swivel/brake set; polyurethane tread.

Metro Tip:
In applications where thresholds are frequently encountered, Metro Super Erecta Trucks provide durability and increased stability.



Super Erecta Wire Truck

Slanted Shelf Trucks and Carts — **31.05**

Shelves slope backwards 2" (51mm) to keep items from falling during transport. Standard-duty carts have four poly stem casters. Heavy-duty trucks are dolly mounted.

Width/Length (in.) (mm)	Height (in.) (mm)	No. Shelves	Casters	Description	Approx. Pkd. Wt. (lbs.) (kg)	Cat. No.
24x36 610x914	62 ¹ / ₁₆ 1577	3	2-BL6P, 2-6P	Heavy-Duty	140 63	AST35MC
24x48 610x1219	62 ¹ / ₁₆ 1577	3	2-BL6P, 2-6P	Heavy-Duty	162 72.4	AST55MC
24x60 610x1524	62 ¹ / ₁₆ 1577	3	2-BL6P, 2-6P	Heavy-Duty	187 84.1	AST65MC
24x36 610x914	59 ⁷ / ₈ 1521	3	4-Poly Casters	Standard-Duty	105 47.2	AST35DC
24x48 610x1219	59 ⁷ / ₈ 1521	3	4-Poly Casters	Standard-Duty	125 56.2	AST55DC
24x60 610x1524	59 ⁷ / ₈ 1521	3	4-Poly Casters	Standard-Duty	150 67.5	AST65DC

Additional Slanted Shelves

Width/Length (in.) (mm)	Approx. Pkd. Wt. (lbs.) (kg)	Cat. No. Chrome
24x36 610x914	13 6	SLT2436NC
24x48 610x1219	17 8	SLT2448NC
24x60 610x1524	22 10	SLT2460NC

Handles — **11.40**

Use on corresponding width Super Erecta units to provide additional maneuverability to dolly carts or stem caster carts. Split sleeves included for attaching to cart.

Length (in.) (mm)	Push Handles		Extended Handles	
	Cat. No. Chrome	Cat. No. Stainless	Cat. No. Chrome	Cat. No. Stainless
14 355	PH14NC	PH14NS	EH14NC	EH14NS
18 457	PH18NC	PH18NS	EH18NC	EH18NS
21 530	PH21NC	PH21NS	EH21NC	EH21NS
24 610	PH24NC	PH24NS	EH24NC	EH24NS
30 760	PH30NC		EH30NC	
36 914	PH36NC		EH36NC	

Note: Handles fit unit widths only. Extended handles add 6" (152.4mm) to length of unit.



Push Handle



Extended Handle



Standard-Duty Slanted Shelf Cart



5M



5MB

Rigid stem casters are often ordered two per unit for improved tracking and handling. Rigid caster channels are provided with each two rigid stem casters at no charge.

Stem Casters — 11.20

Use with Super Erecta posts and shelves (see pages 37 and 42) to create a mobile shelving unit to meet your special needs. Stem casters are shipped with donut bumper at no additional charge.

Wheel Diameter (in.) (mm)	Face (in.) (mm)	Load Rating (lbs.) (kg)	Type	Wheel Tread	Approx. Pkd. Wt. (lbs.) (kg)	Cat. No.
4 102	1/2 12	125 56	Stem/Swivel	Resilient	1 1/2 .6	4LD
5 127	1/2 12	125 56	Stem/Swivel	Resilient	2 .9	5LD
5 127	1/4 32	200 90	Stem/Swivel	Resilient	2 1/2 1.1	5M
5 127	1/4 32	200 90	Stem/Brake	Resilient	2 3/8 1.2	5MB
5 127	1/4 32	200 90	Stem/Rigid	Resilient	3 1/2 1.5	5MR
5 127	1/4 32	250 111	Stem/Swivel	High Modulus Donut	2 1/2 1.1	5MDA
5 127	1/4 32	250 111	Stem/Brake	High Modulus Donut	2 3/8 1.17	5MDBA
5 127	1/4 32	250 111	Stem/Rigid	High Modulus Donut	2 3/8 1.08	5MDRA
5 127	1/4 32	300 135	Stem/Swivel	Polyurethane	2 1/8 .94	5MP
5 127	1/4 32	300 135	Stem/Brake	Polyurethane	2 1/4 1	5MPB
5 127	1/4 32	300 135	Stem/Rigid	Polyurethane	2 .9	5MPR
6 152	1/4 32	300 135	Stem/Swivel	Polyurethane	2 1/4 1.08	6MP
6 152	1/4 32	300 135	Stem/Brake	Polyurethane	2 1/2 .94	6MPB
6 152	1/4 32	300 135	Stem/Rigid	Polyurethane	2 1/4 1	6MPR

- Note 1: Rigid casters are held in position by a connecting channel. When ordering rigid casters, shelf width must be known.
- Note 2: Load Height for all 5M and 5MP casters — 6 3/32" ± 1/16" (155 ± 1.5mm).
- Note 3: Load Height for 4LD caster — 4 5/8" ± 1/16" (118 ± 1.5mm).
- Note 4: Load Height for 5LD caster — 5 5/8" ± 1/16" (143 ± 1.5mm).
- Note 5: Brakes are foot-operated.

Polymer Casters — 11.20

Innovative polymer stem casters offer corrosion resistance and enhanced durability. Appropriate for all medium-duty mobile applications. Donut bumpers included.

- All-polymer horn, stainless steel axle and hardware.
- 5" (127mm) diameter polyurethane wheel, sleeve-style axle bearing and an optional toe-operated brake mechanism.



5PC



5PCB

Wheel Tread	Type	Face (in.) (mm)	Load Rating (lbs.) (kg)	Approx. Pkd. Wt. (lbs.) (kg)	Temp Range (continuous)	Cat. No.	Cat. No. Antimicrobial
Polyurethane	Swivel	1 1/4 32	300 135	2 .9	-20°F to 120°F	5PC	5PCM
Polyurethane	Brake	1 1/4 32	300 135	2 .9	-20°F to 120°F	5PCB	5PCBM
Polyurethane	Rigid	1 1/4 32	300 135	2 .9	-20°F to 120°F	5PCR	

Note 1: Rigid casters are held in place by a connecting channel. When ordering, shelf depth must be provided.

Stainless Steel Cart-Washable Stem Casters — 11.20

Stem casters are shipped with donut bumpers at no extra charge.



5MDGSA

Wheel Diameter (in.) (mm)	Face (in.) (mm)	Load Rating (lbs.) (kg)	Type	Wheel Tread	Approx. Pkd. Wt. (lbs.) (kg)	Cat. No.
5 127	1/4 32	250 111	Swivel	High Modulus	2 1/2 1.1	5MDGSA
5 127	1/4 32	250 111	Brake	High Modulus Donut	2 3/8 1.17	5MDBGSA
5 127	1/4 32	250 111	Rigid	High Modulus Donut	2 3/8 1.08	5MDRGSA
5 127	1/4 32	300 135	Swivel	Polyurethane	2 1/8 .94	5MPGSA
5 127	1/4 32	300 135	Brake	Polyurethane	2 1/4 1	5MPBGSA
5 127	1/4 32	300 135	Rigid	Polyurethane	2 .9	5MPRGSA

- Note 1: Rigid casters are held in position by a connecting channel. When ordering rigid casters, shelf width must be known.
- Note 2: Load Height for all 5MD and 5MP casters — 6 3/32" ± 1/16" (155 ± 1.5mm).
- Note 3: All casters are grease sealed with zerk fittings in swivel and axle.
- Note 4: Brakes are foot-operated.

Indicates antimicrobial product.

High-temperature Autoclave Stem Casters



5MHTPB



5MHTNB

Type	Wheel Tread	Load Rating (lbs.) (kg)	Approx. Pkd. Wt. (lbs.) (kg)	Cat. No.
Swivel	Hi-temp Phenolic	300 135	2 1/5 1.0	5MHTP
Brake	Hi-temp Phenolic	300 135	2 4/5 1.3	5MHTPB
Swivel	Hi-temp Nylon	300 135	2 2/5 1.1	5MHTN
Brake	Hi-temp Nylon	300 135	3 1.4	5MHTNB

Note: Casters are temperature rated for up to 300°F (149°C).

See page 42 for posts for Stem Casters.

Swedged Posts — For cart washable and autoclave applications

Each Type 304 stainless post has an aluminum cap swedged into the top of the post. For use with standard stem casters.



Swedged Post

Description	Dimensions (in.) (mm)	Cat. No.
Stem Caster Post	33 875	33UPS-SW
Stem Caster Post	54 1370	54UPS-SW
Stem Caster Post	63 1600	63UPS-SW

Donut Bumpers — 11.40

Diameter (in.) (mm)		Height (lbs.) (kg)		Cat. No.
3 1/2	89	3/4	19	9992DB*
5 1/2	140	1 3/16	21	9992N

*Included with each Super Erecta stem caster as noted on previous page.



Donut Bumper

Decorative Casters — 10.06

- Black nylon housing with non-marking polymer tread.
- 2 1/2" (63mm) models have threaded stem and attach to stationary shelving posts.
- 4" (100mm) casters include threaded insert for use with mobile posts.



HDC5B HDC5BB

Type	Diameter (in.) (mm)		Fits Post Type	Cat. No.
Swivel/Brake	2 1/2	63	Stationary	HDC3BB
Swivel	4	100	Mobile	HDC5B
Swivel/Brake	4	100	Mobile	HDC5BB

Castors shipped with post inserts (as shown left) for adaptability to mobile posts.

The following information is to assist you in the selection of the appropriate caster for your specific application. Remember, the selection of the proper caster is determined by the load requirements, the operating environment, and other special conditions.

Wheel Material	Resistance to Oil & Grease	Rollability	Floor Protection	Noise
Resilient Rubber	Low	Fair	Good	Low
Neoprene	High	Good	Good	Low
Polyurethane	High	Good	Good	Moderate
High Modulus Rubber	High	Good	Good	Low
Conductive	Low	Fair	Good	Low

Caster Tips:

1. The total weight of the equipment and its load should not exceed three times the load rating per caster.
2. Given the same wheel material, the larger the wheel diameter, the greater the load capacity and the better the rollability.
3. Caster mounting patterns affect maneuverability and steering of the equipment.
4. Plate casters generally have wheels of larger diameter and can usually carry more weight and take more abuse than stem casters.
5. Ball bearings and roller bearings in the wheel generally perform better and carry more weight than engineered plastic bearings or sintered metal bearings. Metro stem casters in the 5MP and the 5MDA series have ball bearings in the swivel and the wheel. Most plate casters have ball bearings in the swivel and ball or roller bearings in the wheel.
6. Wheel tread shapes are generally flat, rounded or tapered. Tapered wheels, like donut-shaped wheels, tend to roll more easily. High-modulus donut wheels offer resiliency and mobility, reduce noise, and absorb shock on uneven or rough floors.

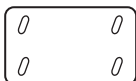

For maneuverability, use 4 swivel casters.

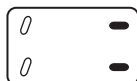

For steering control use 2 swivel and 2 rigid casters.

Additional stem and plate casters, in various sizes, are available.

Made-To-Order Truck Dollies (Aluminum)* — 11.37

Select the desired dolly size from chart below and combine with desired plate casters found on page 23 to make your corresponding size Super Erecta unit mobile. For example: D1824NCB, four #B5DN = one 18"x24" (457x610mm) aluminum dolly frame with four 5" (127mm) plate swivel casters.



Dolly Frame

Metro Fact:

Metro dolly frames and stock truck dollies add 3 1/8" (78mm) to the length of the unit and 3 3/8" (87mm) to the unit width.

Stainless steel frames and staked posts are recommended for heavy-duty applications.

Truck Dolly Frames

Shelf Width/Length (in.)	Shelf Width/Length (mm)	ALUMINUM		STAINLESS	
		Cat. No. with Corner Bumper	Cat. No. with Wraparound Bumper	Cat. No. with Corner Bumper	Cat. No. with Wraparound Bumper
18x24	457x610	D1824NCB	D1824NP	D1824SCB	D1824SP
18x30	457x760	D1830NCB	D1830NP	D1830SCB	D1830SP
18x36	457x914	D1836NCB	D1836NP	D1836SCB	D1836SP
18x42	457x1066	D1842NCB	D1842NP	D1842SCB	D1842SP
18x48	457x1219	D1848NCB	D1848NP	D1848SCB	D1848SP
18x60	457x1524	D1860NCB	D1860NP	D1860SCB	D1860SP
18x72	457x1825	D1872NCB	D1872NP	D1872SCB	D1872SP
21x24	530x610	D2124NCB	D2124NP	D2124SCB	D2124SP
21x30	530x760	D2130NCB	D2130NP	D2130SCB	D2130SP
21x36	530x914	D2136NCB	D2136NP	D2136SCB	D2136SP
21x42	530x1066	D2142NCB	D2142NP	D2142SCB	D2142SP
21x48	530x1219	D2148NCB	D2148NP	D2148SCB	D2148SP
21x60	530x1524	D2160NCB	D2160NP	D2160SCB	D2160SP
21x72	530x1825	D2172NCB	D2172NP	D2172SCB	D2172SP
24x24	610x610	D2424NCB	D2424NP	D2424SCB	D2424SP
24x30	610x760	D2430NCB	D2430NP	D2430SCB	D2430SP
24x36	610x914	D2436NCB	D2436NP	D2436SCB	D2436SP
24x42	610x1066	D2442NCB	D2442NP	D2442SCB	D2442SP
24x48	610x1219	D2448NCB	D2448NP	D2448SCB	D2448SP
24x60	610x1524	D2460NCB	D2460NP	D2460SCB	D2460SP
24x72	610x1825	D2472NCB	D2472NP	D2472SCB	D2472SP

Note 1: Replacement wraparound bumper kits are available. See your Metro representative for details.
 Note 2: "Made To Order Dollies" are non-returnable.
 Note 3: Maximum load capacity for dollies is 1,000 lbs. (454kg), depending on caster selection.

Stock Truck Dollies — 11.36

These are aluminum dollies with a single catalog number for frame and casters with wraparound bumper. Use with Super Erecta Shelving and posts to create mobile carts for higher weight capacities. See specific plate caster load ratings (page 51) to determine appropriate stock truck dolly.

Shelf Width/Length (in.)	Shelf Width/Length (mm)	Casters	Cat. No.	Shelf Width/Length (in.)	Shelf Width/Length (mm)	Casters	Cat. No.
24x36	610x914	Two B5DN/Two B5DNB	D53JN	24x48	610x1219	Two 8P/Two BL8P	D55PN
24x48	610x1219	Two B5DN/Two B5DNB	D55JN	24x60	610x1524	Two 8P/Two BL8P	D56PN
24x60	610x1524	Two B5DN/Two B5DNB	D56JN	24x48	610x1219	Two C8DA/Two C8DSL*	D55PSLN
24x36	610x914	Two 6P/Two BL6P	D53MN	24x60	610x1524	Two C8DA/Two C8DSL*	D56PSLN
24x48	610x1219	Two 6P/Two BL6P	D55MN				
24x60	610x1524	Two 6P/Two BL6P	D56MN				

*Swivel Lock.
 Note: Replacement wraparound bumper kits are available. See your Metro representative for details.



Stock Dolly



Staked Post

Staked Posts — For use with Truck Dollies

Each post connects to a truck dolly through the stem receptacle. The stem receptacles are staked into the bottom of these posts to ensure a durable connection in abusive applications.

Height* (in.)	Height* (mm)	Approx. Pkd. Wt. (lbs.)	Approx. Pkd. Wt. (kg)	Cat. No. Chrome	Cat. No. Stainless
54 9/16	1385	3	1.4	54P-STKD	54PS-STKD
62 9/16	1590	3 1/2	1.6	63P-STKD	63PS-STKD
74 5/8	1895	4	1.8	74P-STKD	74PS-STKD

*Height includes leveling bolt and cap.

Pitched Aluminum Dust Cover — 11.37

For "Made-To-Order" dollies, these covers act as a barrier between the floor and the bottom shelf of cart for cleanliness. These covers are factory-assembled and must be ordered with desired dolly frame.

Width/Length (in.)	Width/Length (mm)	Approx. Pkd. Wt. (lbs.)	Approx. Pkd. Wt. (kg)	Cat. No.
24x36	610x914	7	3.2	DCT2436N
24x42	610x1066	7	3.2	DCT2442N
24x48	610x1219	8	3.6	DCT2448N
24x60	610x1524	8	3.6	DCT2460N
24x72	610x1825	8	3.6	DCT2472N



Pitched Aluminum Dust Cover

Plate Casters — 11.37

Use in conjunction with Metro “Made-To-Order” truck dollies to assemble a mobile base appropriate for your needs.

Diameter (in.)	(mm)	Wheel Face (in.)	(mm)	Load Rating (lbs.)	(kg)	Load Weight Each (lbs.)	(kg)	Type	Wheel Tread	Cat. No.
5	125	1 3/8	35	225	101	2 1/8	.99	Swivel	Donut Neoprene	B5DN
5	125	1 3/8	35	225	101	2 1/4	1	Brake	Donut Neoprene	B5DNB
5	125	1 3/8	35	225	101	2	.9	Rigid	Donut Neoprene	B5DNR
5	125	1 1/4	31	300	135	2 1/8	.99	Swivel	Polyurethane	B5P
5	125	1 1/4	31	300	135	2 1/4	1	Brake	Polyurethane	B5PB
5	125	1 1/4	31	300	135	2	.9	Rigid	Polyurethane	B5PR
5	125	2	51	500	225	8	3.6	Swivel	Polyurethane	C5P
5	125	2	51	500	225	8 1/4	3.7	Brake	Polyurethane	C5PB
5	125	2	51	500	225	8	3.63	Rigid	Polyurethane	C5PR
6	152	2	51	400	181	8	3.63	Swivel	Hi-Modulus Donut	C6DA
6	152	2	51	400	181	8	3.63	Swivel/Brake	Hi-Modulus Donut	C6DBA
6	152	2	51	400	181	8	3.63	Rigid	Hi-Modulus Donut	C6DRA
6	152	2	51	400	181	8	3.63	Swivel/Lock	Hi-Modulus Donut	C6DSL A
8	203	2	51	450	204	9	4.08	Swivel	Hi-Modulus Donut	C8DA
8	203	2	51	450	204	9	4.08	Swivel/Brake	Hi-Modulus Donut	C8DBA
8	203	2	51	450	204	9	4.08	Rigid	Hi-Modulus Donut	C8DRA
8	203	2	51	450	204	9	4.08	Swivel/Lock	Hi-Modulus Donut	C8DSL A
6	150	2	51	500	225	4 3/4	2.1	Swivel	Polyurethane	C6P
6	150	2	51	500	225	4 7/8	2.2	Brake	Polyurethane	C6PB
6	150	2	51	500	225	3 1/2	1.6	Rigid	Polyurethane	C6PR
6	150	2	51	500	225	5	2.3	Swivel/Lock	Polyurethane	C6PS/L-LH
8	200	2	51	700	315	5 3/4	2.6	Swivel	Polyurethane	C8P
8	200	2	51	700	315	5 7/8	2.65	Brake	Polyurethane	C8PB
8	200	2	51	700	315	4 1/2	2	Rigid	Polyurethane	C8PR
8	200	2	51	700	315	6	2.7	Swivel/Lock	Polyurethane	C8PS/L-LH

Note 1: Brakes are foot-operated.

Note 2: 8" (200mm) casters should not be used on units less than 21" (530mm) wide.

Note 3: Swivel lock casters are set diagonally on the left-hand sides when dolly mounted.

Load Heights: B5 Series — 6 1/4" (159mm) C5 Series — 6 1/2" (165mm) 6P Series — 7 7/8" (200mm)
 (±1/16") (±1.6mm) C6 Series — 7 1/2" (190mm) 8P Series — 9 13/16" (249mm)
 C8 Series — 9 1/2" (241mm)



B5DNB with Wheel Brake



B5P Polyurethane

Stainless Steel Cart-Washable Plate Casters — 11.37

Wheel Diameter (in.)	(mm)	Face (in.)	(mm)	Load Rating (lbs.)	(kg)	Weight Each (lbs.)	(kg)	Type	Wheel Tread	Cat. No.
5	125	1 1/4	31	300	135	2 1/8	.99	Swivel	Polyurethane	B5PGSA
5	125	1 1/4	31	300	135	2 1/4	1	Brake	Polyurethane	B5PBGSA
5	125	1 1/4	31	300	135	2	.9	Rigid	Polyurethane	B5PRGSA
6	150	1 1/2	38	600	270	4 3/4	2.1	Swivel	Polyurethane	C6PGSA
6	150	1 1/2	38	600	270	4 7/8	2.2	Brake	Polyurethane	C6PBGSA
6	150	1 1/2	38	600	270	3 1/2	1.6	Rigid	Polyurethane	C6PRGSA
8	200	1 1/2	38	800	360	5 3/4	2.6	Swivel	Polyurethane	C8PGSA
8	200	1 1/2	38	800	360	5 7/8	2.65	Brake	Polyurethane	C8PBGSA
8	200	1 1/2	38	800	360	4 1/2	2	Rigid	Polyurethane	C8PRGSA

See above notes for important specification information.



B5PGSA

Dolly Adaptor Kits

When ordering a new dolly frame for use with MetroMax iQ, include Mounting Bolt Kit

DMK-2X

(one per dolly frame) on order.

See page 49 for additional specifications and appropriate parameters for all types of Metro casters.

General Guidelines for Metro Carts Used in Over-the-Road Applications

For applications where carts are loaded on to or off of trucks for transportation, and/or where thresholds exceeding 3/8" in height are repeatedly encountered:

- A dolly is recommended for maximum useful life.
- Casters of at least 6" diameter are recommended. Consideration should be given to the shock absorbing ability of the caster wheel, but selection will need to be based upon the specifics of the application.
- Aluminum split sleeves and staked posts should be used.

- Weight load should be limited to approximately 750 lbs. depending on the specifics of the application.

Consult your Metro representative with the details of the Over-the-Road application. Each application is unique, and the preceding points are intended only as general guidelines.

Brake Lock/Swivel Lock Combination Casters — 11.70

Patented, foot-operated design enables a single pair of casters to serve as swivel, rigid or brake casters. Conveniently positioned on the dolly, not on the wheels, the downward pressure pedals prevent scuffing of shoes.



Brake Lock/Swivel Lock combination casters

- **How It Works**
Brake lock/swivel lock caster sets are operated by two separate foot pedals. One pedal locks the two wheels in a rigid position or releases them to swivel; the other pedal engages and releases brakes on the same two wheels.
- **Convenient**
Pedals are on the dolly, not the wheels, making operation more convenient. Downward pressure on the pedals save shoes from scuffing.
- **Casters**
Long wearing polyurethane. Resists abrasion. Non-marking, shock absorbing. Wheels are available in 6" (152mm) and 8" (203mm) size.
- **Recommended Caster Selection**
Two swivel casters at one end and brake/swivel lock set at the other end. Other caster combinations can be used, however, including brake/swivel lock sets at both ends. Wraparound bumper recommended.

Type	Wheel Diameter (in.) (mm)		Face (in.) (mm)		For Use With	Load Rating (lbs.) (kg)		Weight (lbs.) (kg)		Cat. No.
*Brake/Lock	6	152	2	51	24" (610mm) Deep Dolly and 6P Caster	600	272	7 ¹ / ₄	3.3	BL6P24
*Brake/Lock	8	203	2	51	24" (610mm) Deep Dolly and 8P Caster	600	272	9	4.1	BL8P24
Swivel	6	152	2	51	BL6P24 Brake/Lock Set	600	272	5 ¹ / ₄	2.3	6P
Rigid	6	152	2	51	6P Swivel Caster	600	272	5	2.26	6PR
Swivel	8	203	2	51	BL8P24 Brake/Lock Set	600	272	6 ¹ / ₂	2.9	8P
Rigid	8	203	2	51	8P Swivel Caster	600	272	6	2.7	8PR

*Above part numbers include the brake/lock mechanism with two casters. Order dolly separately (see page 28). In addition order either two 6P or two 8P casters. Example: (1) D2436NP and (1) BL6P24 or (1) BL8P24 and two 6P or two 8P.



Tow Bar Assembly

Tow Bar Assembly — 11.70

Attaches to underside of dolly to facilitate transport of dolly carts in tandem. Must be factory assembled and ordered with desired dolly frame (see page 50).

Length (in.) (mm)	Cat. No.
48 1219	TBA48

Note: "C" plate caster must be used with Tow Bar Assembly. Tow Bar Assembly for use with 24" (610mm) units only.

Note: Number of carts to be towed, weight on carts, and towing route affect operation of tow bar assembly. **Before ordering, contact your Metro representative.**

Tow Bar Assembly not appropriate for use with Brake Lock/Swivel Lock system.



Push Handle

Handles — 11.40

Use on corresponding width Super Erecta units to provide additional maneuverability to dolly carts or stem caster carts. Split sleeves included for attaching to cart.

Length (in.) (mm)	Cat. No. Chrome	Push Handles		Extended Handles	
		Cat. No. Stainless	Cat. No. Chrome	Cat. No. Stainless	Cat. No. Stainless
14 355	PH14NC	PH14NS	EH14NC		EH14NS
18 457	PH18NC	PH18NS	EH18NC		EH18NS
21 530	PH21NC	PH21NS	EH21NC		EH21NS
24 610	PH24NC	PH24NS	EH24NC		EH24NS
30 760	PH30NC			EH30NC	
36 914	PH36NC			EH36NC	

Note: Handles fit unit widths only. Extended handles add 6" (152.4mm) to length of unit.



Extended Handle

Shelf Dividers for Super Erecta Shelves — 10.04

Keep shelf contents orderly with these 8" (203mm) high, pressure-fit dividers.

Shelf Width (in.)	Shelf Width (mm)	Approx. Pkd. Wt. (lbs.)	Approx. Pkd. Wt. (kg)	Cat. No. Plated	Cat. No. Black	Cat. No. White	Cat. No. Smoked Glass	Cat. No. Metroseal 3 with Microban®	Cat. No. Stainless	Cat. No. Designer Colors
14	355	1.8	0.8	DD14C	DD14BL	DD14W	DD14-DSG	DD14K3	DD14S	DD14-D
18	457	2.25	1.0	DD18C	DD18BL	DD18W	DD18-DSG	DD18K3	DD18S	DD18-D
21	530	2.5	1.1	DD21C	DD21BL	DD21W	DD21-DSG	DD21K3	DD21S	DD21-D
24	610	2.75	1.3	DD24C	DD24BL	DD24W	DD24-DSG	DD24K3	DD24S	DD24-D
30	760	3.25	1.5	DD30C	DD30BL	DD30W	DD30-DSG		DD30S	
36	914	3.75	1.7	DD36C	DD36BL	DD36W	DD36-DSG		DD36S	

Universal 8" (203mm) Shelf Dividers — Light Duty — 9.25

Each divider includes a panel and two clips to connect to any Super Erecta or Super Adjustable wire self. Corrosion proof.

Nominal Length (in.)	Nominal Length (mm)	Fits Shelf Depth	Approx. Pkd. Wt. (lbs.)	Approx. Pkd. Wt. (kg)	Cat. No.
18	457	18", 21" (457, 530mm)	1.3	0.6	MUD18-8
24	610	24" (610mm)	1.6	0.7	MUD24-8

Shelf-to-Shelf Dividers — 9.25

Full height dividers efficiently compartmentalize the space between two shelves. Corrosion proof. Compatible with Super Erecta and Super Adjustable wire shelves.

Fits Shelf Depth (in.)	Fits Shelf Depth (mm)	Nominal Depth (in.)	Nominal Depth (mm)	Approx. Pkd. Wt. (lbs.)	Approx. Pkd. Wt. (kg)	Cat. No.
18, 21	457, 530	16	406	2.3	1.0	MD18-16
18, 21	457, 530	20	508	2.5	1.1	MD18-20
18, 21	457, 530	24	610	3.8	1.7	MD18-24
24	610	16	406	2.8	1.2	MD24-16
24	610	20	508	3.0	1.3	MD24-20
24	610	24	610	4.4	2.0	MD24-24

*Note: -16 parts have three panels, -20 parts have four panels, -24 parts have five panels.

Shelf Ledges — Side and Back — 10.04

For stationary or mobile installations, ledges prevent items from protruding or falling from shelves.

1" (25mm) High Ledges

Length (in.)	Length (mm)	Approx. Pkd. Wt. (lbs.)	Approx. Pkd. Wt. (kg)	Cat. No. Plated	Cat. No. Black	Cat. No. White	Cat. No. Smoked Glass	Cat. No. Stainless	Cat. No. Designer Colors
14	355	0.58	0.25	L14N-1C	L14N-1BL	L14N-1W	L14N-1-DSG	L14N-1S	L14N-1-D
18	457	0.75	0.33	L18N-1C	L18N-1BL	L18N-1W	L18N-1-DSG	L18N-1S	L18N-1-D
21	530	0.75	0.33	L21N-1C	L21N-1BL	L21N-1W	L21N-1-DSG	L21N-1S	L21N-1-D
24	610	1.0	0.45	L24N-1C	L24N-1BL	L24N-1W	L24N-1-DSG	L24N-1S	L24N-1-D
30	760	2.0	0.9	L30N-1C	L30N-1BL	L30N-1W	L30N-1-DSG	L30N-1S	L30N-1-D
36	914	2.5	1.13	L36N-1C	L36N-1BL	L36N-1W	L36N-1-DSG	L36N-1S	L36N-1-D
42	1066	2.75	1.25	L42N-1C	L42N-1BL	L42N-1W	L42N-1-DSG	L42N-1S	L42N-1-D
48	1219	3.5	1.58	L48N-1C	L48N-1BL	L48N-1W	L48N-1-DSG	L48N-1S	L48N-1-D
54	1370	4.4	1.65	L54N-1C	L54N-1BL	L54N-1W	L54N-1-DSG	L54N-1S	L54N-1-D
60	1524	3.75	1.68	L60N-1C	L60N-1BL	L60N-1W	L60N-1-DSG	L60N-1S	L60N-1-D
72	1828	4.0	1.81	L72N-1C	L72N-1BL	L72N-1W	L72N-1-DSG	L72N-1S	L72N-1-D

Note: Actual ledge length is approximately 1" (25mm) shorter than nominal shelf length/width.

4" (100mm) High Stackable Ledges

Shelf Width (in.)	Shelf Width (mm)	Approx. Pkd. Wt. (lbs.)	Approx. Pkd. Wt. (kg)	Cat. No. Plated	Cat. No. Black	Cat. No. White	Cat. No. Smoked Glass	Cat. No. Metroseal 3 with Microban®	Cat. No. Stainless	Cat. No. Designer Colors
14	355	0.83	0.36	L14N-4C	L14N-4BL	L14N-4W	L14N-4-DSG	L14N-4K3	L14N-4S	L14N-4-D
18	457	1.5	0.68	L18N-4C	L18N-4BL	L18N-4W	L18N-4-DSG	L18N-4K3	L18N-4S	L18N-4-D
21	530	1.75	0.71	L21N-4C	L21N-4BL	L21N-4W	L21N-4-DSG	L21N-4K3	L21N-4S	L21N-4-D
24	610	2.0	0.9	L24N-4C	L24N-4BL	L24N-4W	L24N-4-DSG	L24N-4K3	L24N-4S	L24N-4-D
30	760	2.25	1.03	L30N-4C	L30N-4BL	L30N-4W	L30N-4-DSG	L30N-4K3	L30N-4S	L30N-4-D
36	914	2.75	1.25	L36N-4C	L36N-4BL	L36N-4W	L36N-4-DSG	L36N-4K3	L36N-4S	L36N-4-D
42	1066	3.25	1.48	L42N-4C	L42N-4BL	L42N-4W	L42N-4-DSG	L42N-4K3	L42N-4S	L42N-4-D
48	1219	3.75	1.68	L48N-4C	L48N-4BL	L48N-4W	L48N-4-DSG	L48N-4K3	L48N-4S	L48N-4-D
54	1370	3.8	1.73	L54N-4C	L54N-4BL	L54N-4W	L54N-4-DSG	L54N-4K3	L54N-4S	L54N-4-D
60	1524	4.0	1.81	L60N-4C	L60N-4BL	L60N-4W	L60N-4-DSG	L60N-4K3	L60N-4S	L60N-4-D
72	1828	5.0	2.25	L72N-4C	L72N-4BL	L72N-4W	L72N-4-DSG	L72N-4K3	L72N-4S	L72N-4-D

Note: Actual ledge length is approximately 1" (25mm) shorter than nominal shelf length/width.

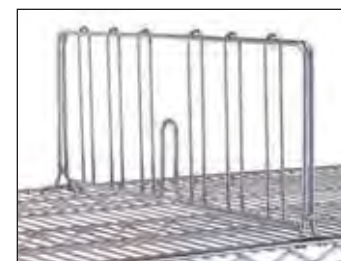

Shelf Divider for Super Erecta Shelves



Universal Shelf Divider

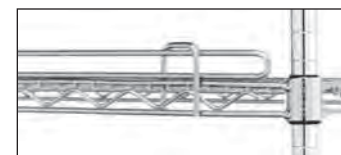

1" (25mm) Ledge



4" (102mm) Ledge

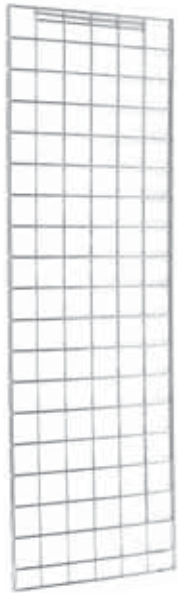

Enclosure Panel

Enclosure Panels — 10.04 10.30

An efficient way to enclose space for stationary or mobile applications.

- Can be used with Super Erecta® and Super Adjustable wire shelving, and Super Erecta solid shelving.
- Appropriate mounting hardware supplied with each panel.

Width/Height		For Nominal Post Height		Grid Opening		Weight		Cat. No. Chrome	Cat. No. Stainless
(in.)	(mm)	(in.)	(mm)	(in.)	(mm)	(lbs.)	(kg)		
12 ³ / ₈ x50 ³ / ₄	313x1289	54	1370	2 ⁷ / ₈ x3 ⁵ / ₈	73x92	3	1.4	EP35C	EP35S
12 ³ / ₈ x59 ³ / ₄	313x1518	63	1600	2 ⁷ / ₈ x3 ⁵ / ₈	73x92	4	1.8	EP36C	EP36S
12 ³ / ₈ x70 ¹ / ₂	313x1791	74	1880	2 ⁷ / ₈ x3 ⁵ / ₈	73x92	6	2.7	EP37C	
18 ³ / ₈ x50 ³ / ₄	464x1289	54	1370	3 ³ / ₈ x3 ⁵ / ₈	86x92	5	2.3	EP55C	EP55S
18 ³ / ₈ x59 ³ / ₄	464x1518	63	1600	3 ³ / ₈ x3 ⁵ / ₈	86x92	6	2.7	EP56C	EP56S
18 ³ / ₈ x70 ¹ / ₂	464x1791	74	1800	3 ³ / ₈ x3 ⁵ / ₈	86x92	7	3.2	EP57C	

All panels are 7/8" (22mm) deep.

Note: Units with a solid shelf in the top position require the use of a three-sided double snake frame (see page 55) directly below it.

Ordering Guide for Enclosure Panels

Super Erecta and Super Adjustable Wire Shelving Units Super Erecta Solid Shelving Units

Ends — Panels required for each end according to shelf width, as follows:

Nominal Post Height (in.) (mm)	18" (457mm) Nominal Shelf Width	21" (530mm) Nominal Shelf Width	24" (610mm) Nominal Shelf Width	30" (760mm) Nominal Shelf Width	36" (914mm) Nominal Shelf Width
54 1370	(1) EP35	(1) EP35	(1) EP55	(2) EP35	(1) EP35 (1) EP55
63 1600	(1) EP36	(1) EP36	(1) EP56	(2) EP36	(1) EP36 (1) EP56
74 1880	(1) EP37	(1) EP37	(1) EP57	(2) EP37	(1) EP37 (1) EP57

Backs — Requires multiple panels in quantities shown for specific length shelf:

For Wire Shelves:

Nominal Post Height (in.) (mm)	30" (760mm) Nominal Shelf Length	36" (914mm) Nominal Shelf Length	42" (1066mm) Nominal Shelf Length	48" (1219mm) Nominal Shelf Length	54" (1370mm) Nominal Shelf Length	60" (1524mm) Nominal Shelf Length	72" (1825mm) Nominal Shelf Length
54 1370	(2) EP35	(1) EP35 (1) EP55	(2) EP55	(2) EP35 (1) EP55	(1) EP35 (2) EP55	(3) EP55	(1) EP35 (3) EP55
63 1600	(2) EP36	(1) EP36 (1) EP56	(2) EP56	(2) EP36 (1) EP56	(1) EP36 (2) EP56	(3) EP56	(1) EP36 (3) EP56
74 1880	(2) EP37	(1) EP37 (1) EP57	(2) EP57	(2) EP37 (1) EP57	(1) EP37 (2) EP57	(3) EP57	(1) EP37 (3) EP57

For Solid Shelves*:

Nominal Post Height (in.) (mm)	30" (760mm) Nominal Shelf Length	36" (914mm) Nominal Shelf Length	42" (1066mm) Nominal Shelf Length	48" (1219mm) Nominal Shelf Length	54" (1370mm) Nominal Shelf Length	60" (1524mm) Nominal Shelf Length	72" (1825mm) Nominal Shelf Length
54 1370	(1) EP55	(2) EP35	(1) EP35 (1) EP55	(2) EP55	N/A	(1) EP35	N/A
63 1600	(1) EP56	(2) EP36	(1) EP36 (1) EP56	(2) EP56	N/A	(1) EP36	N/A
74 1880	(1) EP57	(2) EP37	(2) EP37 (1) EP57	(2) EP57	N/A	(1) EP37	N/A

*Note: Units with a solid shelf in the top position require the use of a three-sided double snake frame (see page 55) directly below it.



Super Adjustable Super Erecta Cart with Enclosure Panels



Mounting Kit for Enclosure Panel

Replacement Mounting Kit for Enclosure Panel

Cat. No. 9970EPZ

Rods and Tabs — 10.04

Form side and back enclosures for a shelving unit. Can also serve as uniform dividers within unit by passing through shelves from top to bottom. Recommended spacing: every 6" (150mm) to 12" (305mm), depending upon shelf contents.

Rods

Min. Post Height (in.)	Rod Length		Approx. Pkd. Wt.		Cat. No. Plated	Cat. No. Stainless
	(in.)	(mm)	(lbs.)	(kg)		
54	52	1320	1	0.5	R52C	R52S
63	61	1549	1	0.5	R61C	R61S
74	72	1830	1 1/4	0.6	R72C	R72S
86	84	2135	1 1/2	0.7	R84C	R84S

Tabs

Rods are shipped with 4 tabs per rod.

Additional Tabs —
Bag of 12
Cat. No. **9084Z**



Rod with Tab in place

Three-Sided Double Snake Frames — 10.04

Provide additional support or access to floor with these sturdy square snake frames. Plated finish.

Width/Length		Approx. Pkd. Wt.		Cat. No. Plated
(in.)	(mm)	(lbs.)	(kg)	
18x24	457x610	5	2.3	SF31N3C
18x30	457x760	6	2.7	SF32N3C
18x36	457x914	6 1/2	2.7	SF33N3C
18x42	457x1066	7	3.2	SF34N3C
18x48	457x1219	7 3/4	3.5	SF35N3C
18x60	457x1524	8	3.6	SF36N3C
18x72	457x1829	9	4.1	SF37N3C
21x24	530x610	5	2.3	SF41N3C
21x30	530x760	6	2.7	SF42N3C
21x36	530x914	6 1/2	2.7	SF43N3C
21x42	530x1066	7	3.2	SF44N3C
21x48	530x1219	8	3.6	SF45N3C
21x60	530x1524	8 1/2	3.8	SF46N3C
21x72	530x1829	10	4.5	SF47N3C
24x24	610x610	6	2.7	SF51N3C
24x30	610x760	7	3.2	SF52N3C
24x36	610x914	7 1/2	3.4	SF53N3C
24x42	610x1066	8	3.6	SF54N3C
24x48	610x1219	9	4.1	SF55N3C
24x60	610x1524	10	4.5	SF56N3C
24x72	610x1829	11	5.0	SF57N3C



Three-sided Double Snake Frame

Hanger Rails — 10.05

Convenient rail fits on posts along the width or length of the unit. Optional hooks can hang from rail at any point.

Length† (in.)	(mm)	Approx. Pkd. Wt. (lbs.)	(kg)	Cat. No.				
				Chrome	Black	White	Smoked Glass	Designer Colors
14	355	1	.45	H114C	H114B	H114W	H114-DSG	H114-D
18	457	1 1/4	.57	H118C	H118B	H118W	H118-DSG	H118-D
24	610	1 1/2	.68	H124C	H124B	H124W	H124-DSG	H124-D
30	760	1 1/2	.68	H130C	H130B	H130W	H130-DSG	H130-D
36	914	2	.90	H136C	H136B	H136W	H136-DSG	H136-D
48	1219	2 1/2	1.13	H148C	H148B	H148W	H148-DSG	H148-D

†14", 18" and 24" (355, 457 and 610mm) sizes fit shelf width (depth). 30", 36" and 48" (760, 914 and 1219mm) sizes fit shelf length.



Hanger Rail



Decorator Shelf Inlays

Decorator Shelf Inlays — 10.06

Hardboard mats prevent small items from falling through wire shelves. Fit between posts and level with top of shelf edge. Reversible, black and white. Packed individually.

Width/Length (in.) (mm)		Cat. No.
14x36	355x914	1436BWI
14x48	355x1219	1448BWI
18x24	457x610	1824BWI
18x36	457x914	1836BWI
18x48	457x1219	1848BWI
24x24	610x610	2424BWI
24x36	610x914	2436BWI
24x48	610x1219	2448BWI



Clear Shelf Inlays

Clear Shelf Inlays — 10.06

Nearly invisible plastic mat retains open-wire look of shelves and allows light penetration. Sold in packages of 4.

Width/Length (in.) (mm)		Cat. No.
14x36	355x914	1436CI-4
14x48	355x1219	1448CI-4
14x60	355x1524	1460CI-4
18x36	457x914	1836CI-4
18x48	457x1219	1848CI-4
18x60	457x1524	1860CI-4

Width/Length (in.) (mm)		Cat. No.
21x36	530x914	2136CI-4
21x48	530x1219	2148CI-4
21x60	530x1524	2160CI-4
24x36	610x914	2436CI-4
24x48	610x1219	2448CI-4
24x60	610x1524	2460CI-4

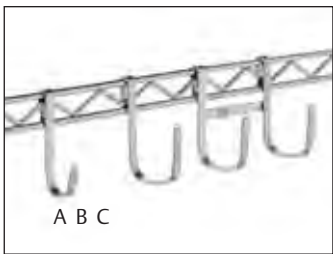

Snap-on Hooks

Snap-On Hooks — 10.05

Multi-purpose hooks in three styles attach to hanger rails, mounting rails or shelves for instant access.

Description	Height (in.) (mm)	Cat. No. Chrome	Cat. No. Black
Style A — Small	3 ⁷ / ₁₆ 90	HK23C	HK23B
Style B — Large	3 ⁷ / ₁₆ 90	HK25C	HK25B
Style C — Double	3 ⁷ / ₁₆ 90	HK26C	

Garment Hanger Tube with Brackets — 10.05

Hanger tubes attach easily under Super Erecta shelves for hanging garments. Available in 18", 21" and 24" (457, 530 and 610mm) widths and in same length as shelves.



Garment Hanger Tube with Brackets

Tube Length (in.) (mm)	Approx. Pkd. Wt. (lbs.) (kg)	Shelf Width 18" (457mm)	Shelf Width 21" (530mm)	Shelf Width 24" (610mm)
24 610	2 ¹ / ₂ 1.1	AT2418NC	AT2421NC	AT2424NC
30 760	2 ¹ / ₂ 1.1	AT3018NC	AT3021NC	AT3024NC
36 914	3 1.4	AT3618NC	AT3621NC	AT3624NC
42 1066	3 ¹ / ₂ 1.6	AT4218NC	AT4221NC	AT4224NC
48 1219	3 ¹ / ₂ 1.6	AT4818NC	AT4821NC	AT4824NC
60 1524	4 1.8	AT6018NC	AT6021NC	AT6024NC
72 1828	4 ¹ / ₂ 2.0	AT7218NC	AT7221NC	AT7224NC

Tray Slides — 10.04

Free up shelves for more efficient use of space. Available in chrome and Metroseal 3 finish. 22³/₄" H. (578mm).

Width		Overall Depth		Slide Profile		On Center Slide Spacing		Fits Shelf Width		Approx. Weight/Pair		Cat. No. Chrome	Cat. No. Metroseal 3 with Microban®
(in.)	(mm)	(in.)	(mm)	(in.)	(mm)	(in.)	(mm)	(in.)	(mm)	(lbs.)	(kg)		
14 ⁵ / ₈	371	2 ¹ / ₄	56	1 ¹ / ₂	37	1 ¹ / ₂	37	18	457	9 ¹ / ₂	4.3	15SNC	15SNK3
20	508	2 ¹ / ₄	56	1 ¹ / ₂	37	1 ¹ / ₂	37	24	610	11	5.0	20SNC	20SNK3



Tray Slides

Super Erecta® Slide System — 10.04

A super space-saving solution. Using Super Erecta® wire units 21" or 24" (530 and 610mm) wide, tote boxes and this innovative slide system, you have the flexibility to create a custom configuration that can be positioned quickly on new or existing units without the use of tools. Finish is nickel-chrome wire with clear protective coating.

Outside Slide Dimensions Height/Width/Length		Fits Shelf Width	Adaptable Boxes	Approx. Pkd. Wt.		Cat. No.	
(in.)	(mm)			(in.)	(mm)		(lbs.)
10 ¹ / ₄ x20 ³ / ₈ x21 ⁵ / ₈	256x510x537	24	610	TB/MTB93030 TB/MTB93060 TB/MTB93080	4 ³ / ₄	2.1	SS2NC
10 ¹ / ₄ x14x17 ¹ / ₈	256x355x430	21	530	TB/MTB92035 TB/MTB92060 TB/MTB92080	3 ¹ / ₂	1.5	SS3NC
10 ¹ / ₄ x25 ¹ / ₈ x17 ¹ / ₈	256x630x430	21	530	TB/MTB93030* TB/MTB93060* TB/MTB93080*	4	1.8	SS4NC

*Fits SS4NC with box turned sideways.

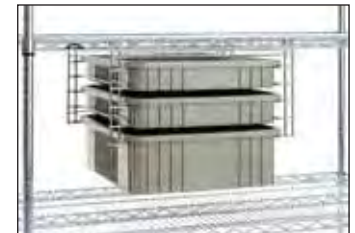

Super Erecta Slide System in place on shelf (Tote box sold separately)

Adjustable Undershelf Slides — 10.04

These slides can be spaced to fit any width container or tote box.

Item	Approx. Pkd. Wt.		Cat. No. (pair)
	(lbs.)	(kg)	
For 18" (457mm) wide shelf	1	0.4	US18NA
*For 21" (530mm) wide shelf	1	0.4	US21NA
For 24" (610mm) wide shelf	1	0.4	US24NA

*Not adaptable to 24" (610mm) long shelf.



Adjustable Undershelf Slide

File Basket — 10.05

The convenient place to keep files and papers.

- Measures 2⁵/₈" W. x 12³/₄" L. x 8³/₄" H. (67mm W. x 324mm L. x 222mm H.).
- Large enough to hold standard-size file folders.
- Attaches easily.

Width/Length		Height		Approx. Pkd. Wt.		Cat. No.
(in.)	(mm)	(in.)	(mm)	(lbs.)	(kg)	
2 ⁵ / ₈ x12 ³ / ₄	63x330	8 ³ / ₄	228	2.1	1.0	PH1239C



File Basket



Indicates antimicrobial product.



Large Display/Storage Basket

Storage Baskets — 10.05

Generous-sized baskets attach in seconds to hanger rail or shelves.

Width/Length/Depth (in.)	Width/Length/Depth (mm)	Approx. Pkd. Wt.		Cat. No. Plated	Cat. No. Black	Cat. No. White	Cat. No. Smoked Glass	Cat. No. Designer Colors
		(lbs.)	(kg)					
13 ³ / ₈ x5x7	345x127x180	8 ¹ / ₂	4	H209C	H209B	H209W	H209-DSG	H209-D
17 ³ / ₈ x7 ¹ / ₂ x5	440x190x127	7	3	H210C	H210B	H210W	H210-DSG	H210-D
17 ³ / ₈ x7 ¹ / ₂ x10	440x190x255	11	5	H212C	H212B	H212W	H212-DSG	H212-D

Swing Hanger — 10.05

Attaches to post to provide convenient storage for hanging items. Red epoxy finish.

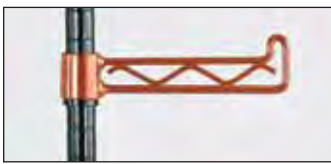

Swing Hanger

Arm Length (in.)	Arm Length (mm)	Weight Capacity		Cat. No.
		(lbs.)	(kg)	
6 ¹ / ₄	160	20	9	H110R

Extension Display Hanger — 10.05

Snaps on Super Erecta Shelf hanger rails and shelf frames. Accepts standard carded merchandise.



Extension Display Hanger

Length (in.)	Length (mm)	Approx. Pkd. Wt.		Finish/Color*	Cat. No.
		(lbs.)	(kg)		
6	152	.25	.1	Chrome	HHK6C
6	152	.25	.1	Black	HHK6B
8	203	.25	.1	Chrome	HHK8C
8	203	.25	.1	Black	HHK8B

*White, smoked glass and designer colors also available. Allow 4-6 week lead time.



Color Identification Tubes

Color Identification Tubes — 10.05

Provide color-coded organization to shelf contents. Tubes slip onto posts.

Length (in.)	Length (mm)	Diameter		Approx. Pkd. Wt.	Color	Cat. No.	
		Inside (in.)	Outside (mm)				
8	200	1 ¹ / ₁₆	27	5 ⁵ / ₈	2.5	Yellow	CIT8Y
8	200	1 ¹ / ₁₆	27	1 ³ / ₁₆	30	Flame	CIT8F
8	200	1 ¹ / ₁₆	27	1 ³ / ₁₆	30	Black	CIT8BL
8	200	1 ¹ / ₁₆	27	1 ³ / ₁₆	30	Gray	CIT8G
8	200	1 ¹ / ₁₆	27	1 ³ / ₁₆	30	White	CIT8W

Color Shelf Marker — 10.05

Color code for effective organization. Snaps securely to the front edge of Super Erecta and Super Adjustable Super Erecta Wire Shelving.

Shelf Marker Size		Color	Cat. No.
(in.)	(mm)		
6x1 ¹ / ₄	152x32	Blue	CSM6-B
6x1 ¹ / ₄	152x32	Green	CSM6-G
6x1 ¹ / ₄	152x32	Red	CSM6-R
6x1 ¹ / ₄	152x32	Tan	CSM6-T

Shelf Marker Size		Color	Cat. No.
(in.)	(mm)		
6x1 ¹ / ₄	152x32	White	CSM6-W
6x1 ¹ / ₄	152x32	Yellow	CSM6-Y
6x1 ¹ / ₄	152x32	Gray	CSM6-GR



Color Shelf Markers



CSM6-B



CSM6-G



CSM6-R



CSM6-T



CSM6-W



CSM6-Y



CSM6-GR

Label Holders

It's easy to identify shelf contents with these snap-on plastic holders, available in four styles and a variety of sizes. Labels not included.

1¹/₄" (32mm) Label Holders — 10.05

Gray. Holds most commercial labels. Available in a variety of lengths.

Label Size		Fits Shelf Length		Cat. No.
(in.)	(mm)	(in.)	(mm)	
3x1 ¹ / ₄	75x32	All		9990P
13x1 ¹ / ₄	330x32	18	457	9990P1
19x1 ¹ / ₄	480x32	24	610	9990P2
25x1 ¹ / ₄	635x32	30	760	9990P30
31x1 ¹ / ₄	725x32	36	914	9990P3
43x1 ¹ / ₄	1090x32	48	1219	9990P4
55x1 ¹ / ₄	1395x32	60	1520	9990P5

For Cantilever Shelves, use 3" (75mm) label holder only.



1¹/₄" (32mm) Label Holder

Clear Label Holders — 10.05

Clear plastic allows decorator colors to show through. Holds most commercial 1¹/₄" (32mm) labels.

Label Size		Fits Shelf Length		Cat. No.
(in.)	(mm)	(in.)	(mm)	
3x1 ¹ / ₄	75x32	All		9990CL
13x1 ¹ / ₄	330x32	18	457	9990CL1
19x1 ¹ / ₄	480x32	24	610	9990CL2
25x1 ¹ / ₄	635x32	30	760	9990CL30
31x1 ¹ / ₄	725x32	36	914	9990CL3
43x1 ¹ / ₄	1090x32	48	1219	9990CL4
55x1 ¹ / ₄	1395x32	60	1520	9990CL5

For Cantilever Shelves, use 3" (75mm) label holder only.

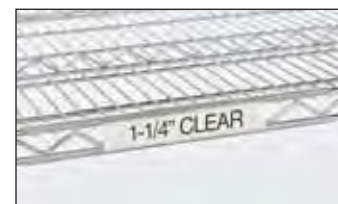

Clear Label Holder

Slanted Label Holders — 10.05

Gray solid plastic holder puts 1¹/₄" (32mm) labels on slant for easier viewing.

Label Size		Fits Shelf Length		Cat. No.
(in.)	(mm)	(in.)	(mm)	
3x1 ¹ / ₄	75x32	All		9990SL
13x1 ¹ / ₄	330x32	18	457	9990SL1
19x1 ¹ / ₄	480x32	24	610	9990SL2
25x1 ¹ / ₄	635x32	30	760	9990SL30
31x1 ¹ / ₄	725x32	36	914	9990SL3
43x1 ¹ / ₄	1090x32	48	1219	9990SL4
55x1 ¹ / ₄	1395x32	60	1520	9990SL5

For Cantilever Shelves, use 3" (75mm) label holder only.



Slanted Label Holder

Metro Bins — 10.08

Convenient way to organize and identify small items.

- Hopper-front design allows for easy access and clear visibility
- Lightweight, durable polypropylene and polyethylene bins have molded front slots to accept labels.
- For application specific totes refer to index.

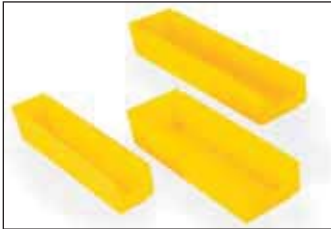

Shelf Bins — Nesting

Shelf Bins — Nesting

These bins are sized to work on the two most popular shelf widths 18" (457mm) and 24" (610mm) for efficient handling and exchange.



Supply Bins — Stacking

Outside Dimensions Width/Length/Height (in.)	Outside Dimensions Width/Length/Height (mm)	Approx. Pkd.23 Wt./Ctn. (lbs.) (kg)		Bin Carton Quantity	Color	Bin Cat. No.	Divider Cat. No.	Divider Carton Quantity
11 ⁵ / ₈ x4 ¹ / ₈ x4	295x105x102	9	4.1	24	Yellow	MB30120Y	MB40120	24
11 ⁵ / ₈ x6 ¹ / ₈ x4	295x168x102	7	3.2	12	Yellow	MB30130Y	MB40130	24
17 ⁷ / ₈ x4 ¹ / ₈ x4	454x105x102	7	3.2	12	Yellow	MB30128Y	MB40120	24
17 ⁷ / ₈ x6 ⁵ / ₈ x4	454x168x102	9	4.1	12	Yellow	MB30138Y	MB40130	24
17 ⁷ / ₈ x11 ¹ / ₈ x4	454x283x102	15	6.8	12	Yellow	MB30178Y	MB40170	24
23 ⁵ / ₈ x4 ¹ / ₈ x4	600x105x102	11	4.9	12	Yellow	MB30124Y	MB40120	24
23 ⁵ / ₈ x6 ⁵ / ₈ x4	600x168x102	8	3.6	6	Yellow	MB30164Y	MB40130	24
23 ⁵ / ₈ x11 ¹ / ₈ x4	600x283x102	11	4.9	6	Yellow	MB30174Y	MB40170	24

Note: Bins are available in carton quantities only. Bins above are priced per each but must be ordered in multiples of carton quantity. (For example: MB30138Y is available in quantities of 12, 24, 36. List price refers to the price of 1 bin.) Dividers are available in carton quantities only. Dividers are sold by the carton and priced by the carton. (For example: 1 MB40120 = 24 dividers, the list price is for 24 dividers.)



MB30265B

Supply Bins — Stacking

Stackable design maximizes vertical storage efficiency. Reinforced design adds strength and prevents spreading.

Outside Dimensions Width/Length/Height (in.)	Outside Dimensions Width/Length/Height (mm)	Approx. Pkd. Wt./Ctn. (lbs.) (kg)		Bin Carton Quantity	Color	Bin Cat. No.	Divider Cat. No.	Divider Carton Quantity
10 ⁷ / ₈ x5 ¹ / ₂ x5	276x140x127	10	4.5	12	Blue	MB30230B	MB40230	6
10 ⁷ / ₈ x11x5	276x279x127	10	4.5	6	Blue	MB30235B	MB40230	6
14 ³ / ₄ x5 ¹ / ₂ x5	375x140x127	13	5.9	12	Blue	MB30234B	N/A	
14 ³ / ₄ x8 ¹ / ₄ x7	375x210x178	24	10.9	12	Blue	MB30240B	MB40245	6
14 ³ / ₄ x16 ¹ / ₂ x7	375x419x178	21	9.5	6	Blue	MB30250B	MB40245	6
18x8 ¹ / ₄ x9	457x210x229	17	7.7	6	Blue	MB30265B*	MB40265	6
20x12 ³ / ₈ x6	508x314x203	9	4.1	3	Blue	MB30281B*	N/A	
20x18 ³ / ₈ x12	508x467x305	7	3.2	1	Blue	MB30283B*	N/A	
8x20 ¹ / ₂ x7	205x521x178	21	9.5	6	Tan	MB30348T†		

*MB30265B, MB30281B, MB30283B are not designed for use with hanging rail system. †Includes two dividers.

Note: MB30234B, MB30281B, MB30283B — no dividers available.

Bins feature a full-width hanger lip that is designed for use with hanging systems.

Bins are available in carton quantities only. Bins above are priced per each but must be ordered in multiples of carton quantity.

(For example: MB30235B is available in quantities of 6, 12, 18. List price refers to the price of 1 bin.)

Dividers are available in carton quantities only. Dividers are sold by the carton and priced by the carton.

(For example: 1 MB40230 = 6 dividers, the list price is for 6 dividers.)



MB30283B



MB34240G

Bulk Supply Tub — Nesting

Ruggedly constructed, perfect for storing large bulky items.

Outside Dimensions Width/Length/Height (in.)	Outside Dimensions Width/Length/Height (mm)	Approx. Pkd. Wt./Ctn. (lbs.) (kg)		Carton Quantity	Bin Color	Cat. No.
24 ¹ / ₂ x19x9 ¹ / ₂	622x483x241	20	9.1	6	Gray	MB34240G

Note: Bins are available in carton quantities only. Bins above are priced per each but must be ordered in multiples of carton quantity. (For example: MB34240G is available in quantities of 6, 12, 18 etc. List price refers to the price of 1 bin.)

Shelving and Cart Covers — 11.80

Opaque Solid Fabric Covers

Protect contents from dust and other airborne contaminants.

- Deter pilferage: Allow units to be loaded prior to transport.
- Available in:
 - Uncoated White (100% knitted polyester)
 - Coated White (waterproof vinyl-nylon)
 - Uncoated Mariner Blue (200 denier nylon)
 - Coated Mariner Blue (waterproof vinyl-nylon)
- Choice of Velcro® or zipper closures.

Catalog numbers shown are for white cover. Add "MB" suffix to order Mariner Blue (i.e. 21X48X54UCMB)



21X48X54UCMB
(shown in Mariner Blue)

Length/Height (in.)	Length/Height (mm)	White Nylon Uncoated		White Vinyl Coated	
		Zippered Closure Cat. No.	Price	Zippered Closure Cat. No.	Velcro Closure Cat. No.
FOR SHELF TRUCKS & CARTS 18" (457mm) DEEP					
36x54	914x1370	18X36X54UC		18X36X54C	18X36X54VC
36x62	914x1550	18X36X62UC		18X36X62C	18X36X62VC
48x54	1219x1370	18X48X54UC		18X48X54C	18X48X54VC
48x62	1219x1550	18X48X62UC		18X48X62C	18X48X62VC
60x54	1524x1370	18X60X54UC		18X60X54C	18X60X54VC
60x62	1524x1550	18X60X62UC		18X60X62C	18X60X62VC
FOR SHELF TRUCKS & CARTS 21" (530mm) DEEP					
48x54	1219x1370		21X48X54VUC	21X48X54C	21X48X54VC
48x62	1219x1550		21X48X62VUC	21X48X62C	21X48X62VC
48x74	1219x1850		21X48X74VUC	21X48X74C	21X48X74VC
60x54	1524x1370		21X60X54VUC	21X60X54C	21X60X54VC
60x62	1524x1550		21X60X62VUC	21X60X62C	21X60X62VC
60x74	1524x1850		21X60X74VUC	21X60X74C	21X60X74VC
FOR SHELF TRUCKS & CARTS 24" (610mm) DEEP					
36x54	914x1370		24X36X54VUC	24X36X54C	24X36X54VC
36x62	914x1550		24X36X62VUC	24X36X62C	24X36X62VC
36x74	914x1850		24X36X74VUC	24X36X74C	24X36X74VC
48x54	1219x1370		24X48X54VUC	24X48X54C	24X48X54VC
48x62	1219x1550		24X48X62VUC	24X48X62C	24X48X62VC
48x74	1219x1850		24X48X74VUC	24X48X74C	24X48X74VC
60x54	1524x1370		24X60X54VUC	24X60X54C	24X60X54VC
60x62	1524x1550		24X60X62VUC	24X60X62C	24X60X62VC
60x74	1524x1850		24X60X74VUC	24X60X74C	24X60X74VC
72x54	1825x1370		24X72X54VUC	24X72X54C	24X72X54VC
72x62	1825x1550		24X72X62VUC	24X72X62C	24X72X62VC
72x74	1825x1850		24X72X74VUC	24X72X74C	24X72X74VC

*Cart covers are non-returnable.

Note: 86" (2185mm) high covers, in 24" (610mm) depth, available by special order.

Clear Vinyl Cart Covers

- Allows visual access while protecting shelf contents from dust and other airborne contaminants.
- Vinyl construction with Velcro closures.
- Available for 18x36" (457x914mm) shelving.

Length/Height (in.)	Length/Height (mm)	Cat. No.
36x32	914x889	GWVC41
36x52	914x1320	GWVC62



Clear Vinyl
Cart Cover

✓ Indicates antimicrobial product.



Keyboard Tray

Keyboard Tray — 10.06

Attaches to all Metro wire shelves, 36" (914mm) length or longer. Mouse Tray adapts to left or right of Keyboard Tray. Flip-top compartment provides convenient storage. Constructed of durable high-impact polystyrene. Assembles easily.

- Hardware included for attachment to Metro wire shelves; template provided for attachment to solid desk surfaces.
- Keyboard Tray Dimensions: 22" L. (559mm) x 15 1/2" W. (394mm).
- Dimension with Mouse Tray fully extended: 29 1/2" L. (749mm) x 15 1/2" W. (394mm).

Cat. No. **CKS1522BL**
List Price 80.00 each



Wire Management Clip

Wire Management Clip — 10.06

Keeps wires and cables neatly organized both horizontally and vertically. Easily snaps over the edge of any Super Erecta wire or qwikSLOT shelf. Black epoxy finish.

Width		Length		Approx. Pkd. Wt.		Cat. No.
(in.)	(mm)	(in.)	(mm)	(lbs.)	(kg)	
2	51	2	51	.5	.25	CWM



Power Strip

Power Strip — 10.06

- Mounts quickly and easily to either a Super Erecta or qwikSLOT post.
- Includes a 15 foot (4572mm) long cord.
- Mounting brackets and hardware included.
- UL/CSA approved.
- 15 Amp Circuit Breaker.
- Illuminated Power Switch. 15A/125VAC.60Hz/1875 W.
- Gray/blue finish.
- 14/3 SJT Molded Power Supply Cord.

Width		Length		Approx. Pkd. Wt.		Cat. No.
(in.)	(mm)	(in.)	(mm)	(lbs.)	(kg)	
1 1/2	38	48	1219	6	2.72	CPS48



Surface Mount Swing Arm for Flat Monitor — 10.06

Cat. No. **LTFMA**

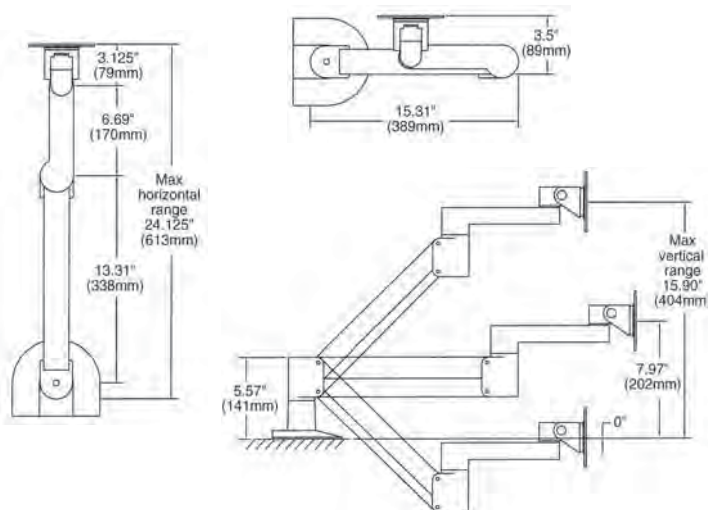



Call today!

1.800.992.1776

A customer service representative is standing by to assist you.



Not in the USA? Look on the back cover of your catalog for the contact information you need.

“Thank you for calling Metro, how can we help you?”